

UNITED STATES  
DEPARTMENT OF THE INTERIOR  
GEOLOGICAL SURVEY30-245-21496  
J. LEASE DESIGNATION AND SERIAL NO.

14-20-603-5034

6. IF INDIAN, ALLOTTEE OR TRIBE NAME

Navajo Tribe

7. UNIT AGREEMENT NAME

8. FARM OR LEASE NAME

Navajo Tribal "U"

9. WELL NO.

25

10. FIELD AND POOL, OR WILDCAT

Tecito Dome Penn. "D" CRT

11. SEC., T., R., M., OR BLK.  
AND SURVEY OR AREASE/4 NE/4 Section 22,  
T-26-N, R-13-W

12. COUNTY OR PARISH

San Juan

13. STATE

New Mexico

1a. TYPE OF WORK

DRILL ☒DEEPEN ☐PLUG BACK ☐

b. TYPE OF WELL

OIL  
WELL ☒GAS  
WELL ☐

OTHER

SINGLE  
ZONE ☒MULTIPLE  
ZONE ☐

2. NAME OF OPERATOR

AMOCO PRODUCTION COMPANY

3. ADDRESS OF OPERATOR

501 Airport Drive, Farmington, New Mexico 87401

4. LOCATION OF WELL (Report location clearly and in accordance with any State requirements.)\*

At surface

1980' F&amp;L &amp; 510' F&amp;L, Section 22, T-26N, R-13W

At proposed prod. zone

Same

14. DISTANCE IN MILES AND DIRECTION FROM NEAREST TOWN OR POST OFFICE\*

22 miles south of Shiprock, New Mexico

15. DISTANCE FROM PROPOSED\*

LOCATION TO NEAREST

PROPERTY OR LEASE LINE, FT.

(Also to nearest drlg. unit line, if any)

510'

16. NO. OF ACRES IN LEASE

2544.50

17. NO. OF ACRES ASSIGNED

TO THIS WELL

160 (Joint with "U" No. 17)

18. DISTANCE FROM PROPOSED LOCATION\*

TO NEAREST WELL, DRILLING, COMPLETED,  
OR APPLIED FOR, ON THIS LEASE, FT.

1370'

19. PROPOSED DEPTH

6600'

20. ROTARY OR CABLE TOOLS

Rotary

21. ELEVATIONS (Show whether DF, RT, GR, etc.)

5702' ungraced GL

22. APPROX. DATE WORK WILL START\*

May 1974

23.

## PROPOSED CASING AND CEMENTING PROGRAM

| SIZE OF HOLE | SIZE OF CASING | WEIGHT PER FOOT | SETTING DEPTH | QUANTITY OF CEMENT |
|--------------|----------------|-----------------|---------------|--------------------|
| 17-1/4"      | 13-3/8"        | 48#             | 100'          | 125 sx             |
| 12-1/4"      | 9-5/8"         | 32.3#           | 1500'         | 575 sx             |
| 8-3/4"       | 7"             | 20# & 23#       | 6600'         | 250 sx             |

## TIGHT HOLE

Amoco Production Company proposes to drill the subject well to test the Pennsylvanian Formation. Intermediate casing will be set across the Morrison water zones. The well will then be drilled through the Pennsylvanian and completion designed from open hole logs. A copy of all logs will be furnished to your office upon completion. A copy of the Location Plat is attached.

This well will be drilled as a "Tight Hole" and all information is strictly confidential until released by Amoco Production Company.

IN ABOVE SPACE DESCRIBE PROPOSED PROGRAM: If proposal is to deepen or plug back, give data on present productive zone and proposed new productive zone. If proposal is to drill or deepen directionally, give pertinent data on subsurface locations and measured and true vertical depths. Give blowout preventer program, if any.

24.

SIGNED

TITLE

Area Superintendent

DATE

May 17, 1974

(This space for Federal or State office use)

PERMIT NO.

APPROVAL DATE

APPROVED BY

TITLE

CONDITIONS OF APPROVAL, IF ANY:

RECEIVED

MAY 20 1974

DATE

U. S. GEOLOGICAL SURVEY  
FARMINGTON, N. M.

## Instructions

**General:** This form is designed for submitting proposals to perform certain well operations, as indicated, on all types of lands and leases for appropriate action by either a Federal or a State agency, or both, pursuant to applicable Federal and/or State laws and regulations. Any necessary special instructions concerning the use of this form and the number of copies to be submitted, particularly with regard to local, area, or regional procedures and practices, either are shown below or will be issued by, or may be obtained from, the local Federal and/or State office.

**Item 1:** If the proposal is to redrill to the same reservoir at a different subsurface location or to a new reservoir, use this form with appropriate notations. Consult applicable State or Federal regulations concerning subsequent work proposals or reports on the well.

**Item 4:** If there are no applicable State requirements, locations on Federal or Indian land should be described in accordance with Federal requirements. Consult local State or Federal office for specific instructions.

**Item 14:** Needed only when location of well cannot readily be found by road from the land or lease description. A plat, or plats, separate or on this reverse side, showing the roads to, and the surveyed location of, the well, and any other required information, should be furnished when required by Federal or State agency offices.

**Items 15 and 18:** If well is to be, or has been directionally drilled, give distances for subsurface location of hole in any present or objective production zone.

**Item 22:** Consult applicable Federal or State regulations, or appropriate officials, concerning approval of the proposal before operations are started.

**NEW MEXICO OIL CONSERVATION COMMISSION  
WELL LOCATION AND ACREAGE DEDICATION PLAT**

Form C-102  
Supersedes C-128  
Effective 1-1-65

All distances must be from the outer boundaries of the Section.

|   |   |                        |                                 |  |                       |
|---|---|------------------------|---------------------------------|--|-----------------------|
| Operator<br><b>Amoco Production Company</b>   |   |                        | Lease<br><b>Navajo Tribal U</b> |  | Well No.<br><b>25</b> |
| Unit Letter<br><b>H</b>   | Section<br><b>22</b>                    | Township<br><b>26N</b> | Range<br><b>18W</b>             | County<br><b>San Juan</b>                  |                       |
| Actual Footage Location of Well:<br><b>1980</b> feet from the <b>North</b> line and <b>510</b> feet from the <b>East</b> line |   |                        |                                 |  |                       |
| Ground Level Elev.<br><b>5702 Est.</b>  | Producing Formation<br><b>Penn. "D"</b> |                        | Pool<br><b>Tacito Dome</b>      | Dedicated Acreage:<br><b>160 Jt.</b> Acres |                       |

1. Outline the acreage dedicated to the subject well by colored pencil or hachure marks on the plat below.
2. If more than one lease is dedicated to the well, outline each and identify the ownership thereof (both as to working interest and royalty).
3. If more than one lease of different ownership is dedicated to the well, have the interests of all owners been consolidated by communitization, unitization, force-pooling, etc?

☐ Yes ☐ No If answer is "yes," type of consolidation

**CONFIDENTIAL**

If answer is "no," list the owners and tract descriptions which have actually been consolidated. (Use reverse side of this form if necessary.)

No allowable will be assigned to the well until all interests have been consolidated (by communitization, unitization, forced-pooling, or otherwise) or until a non-standard unit, eliminating such interests, has been approved by the Commission.

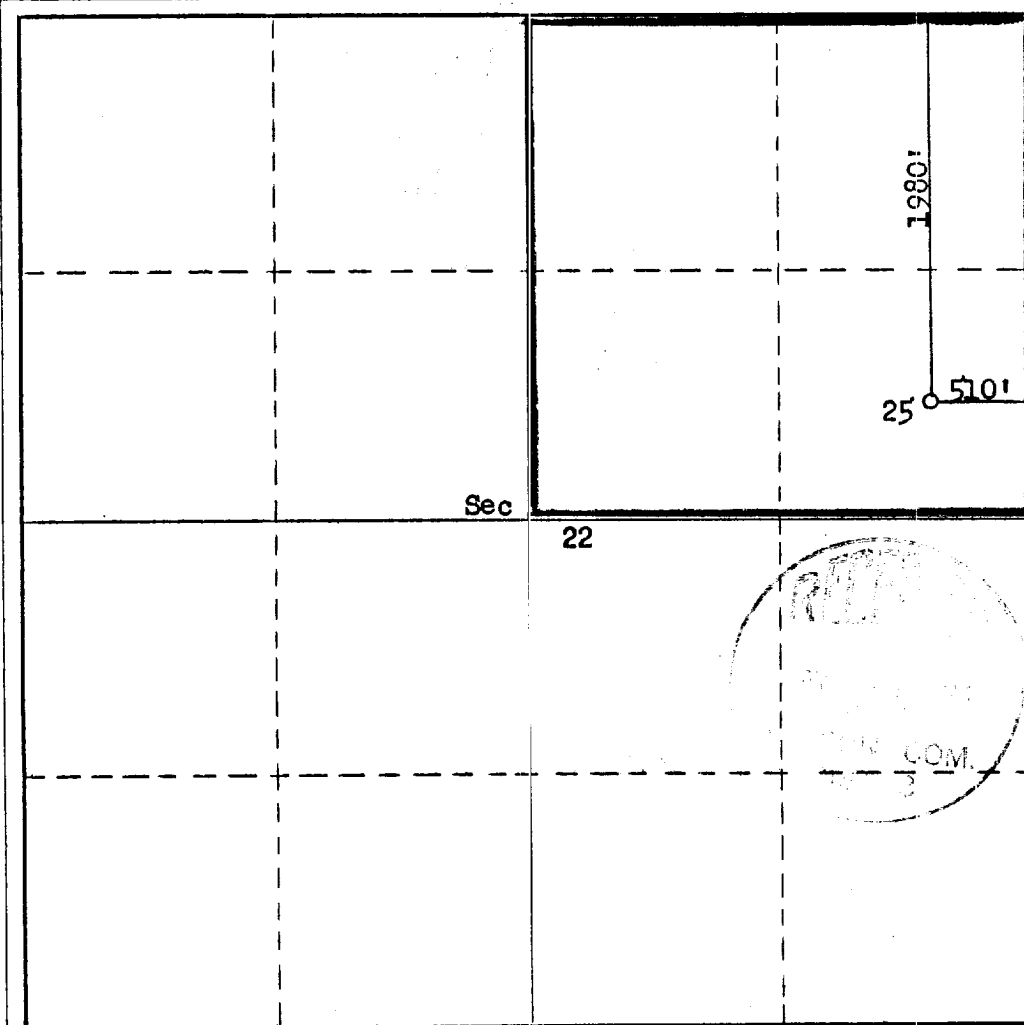

**CERTIFICATION**

I hereby certify that the information contained herein is true and complete to the best of my knowledge and belief.

Name

**L. O. Speer, Jr.**

Position

**Area Superintendent**

Company

**AMOCO PRODUCTION COMPANY**

Date

**May 17, 1974**

I hereby certify that the well location shown on this plat was plotted from field notes of actual surveys made by me or under my supervision, and that the same is true and correct to the best of my knowledge and belief.

Date Surveyed

**May 9, 1974**

Registered Professional Engineer and/or Land Surveyor

**Fred B. Kern, Jr.**

Certificate No.

**3950**

0 330 660 990 1320 1650 1980 2310 2640 2000 1500 1000 500 0

DEVELOPMENT PLAN FOR SURFACE USE  
NAVAJO TRIBAL "U" NO. 25  
SAN JUAN COUNTY, NEW MEXICO

TIGHT HOLE - CONFIDENTIAL

Amoco Production Company proposes to drill the subject well with rotary tools on a graded location as shown on the attachments. The location is in accordance with NMOCC Order R-2758. Established roads exist in the area and only 150 feet of new road will need to be constructed. Archeological clearance to drill this well has been obtained from the proper authorities. Clearance to perform work on this location has been obtained from the Navajo Tribe.

No airstrips or field camps will be built and none exist nearby. There are no trees in the area and therefore no timber damage will result. Vegetation in the area is extremely sparse and consists primarily of tumbleweed. As the well is located in the middle of an active oil field, Amoco has previously completed a water source well. All water for drilling operations will come from this well. Upon completion of the subject well the location will be thoroughly cleaned and the reserve pit backfilled. If the well is productive the flowline for this well will be laid to a test point near Well "U" No. 9. The electric power line will require only a short 300' drop off of an existing powerline.

CONFIDENTIAL



CONFIDENTIAL

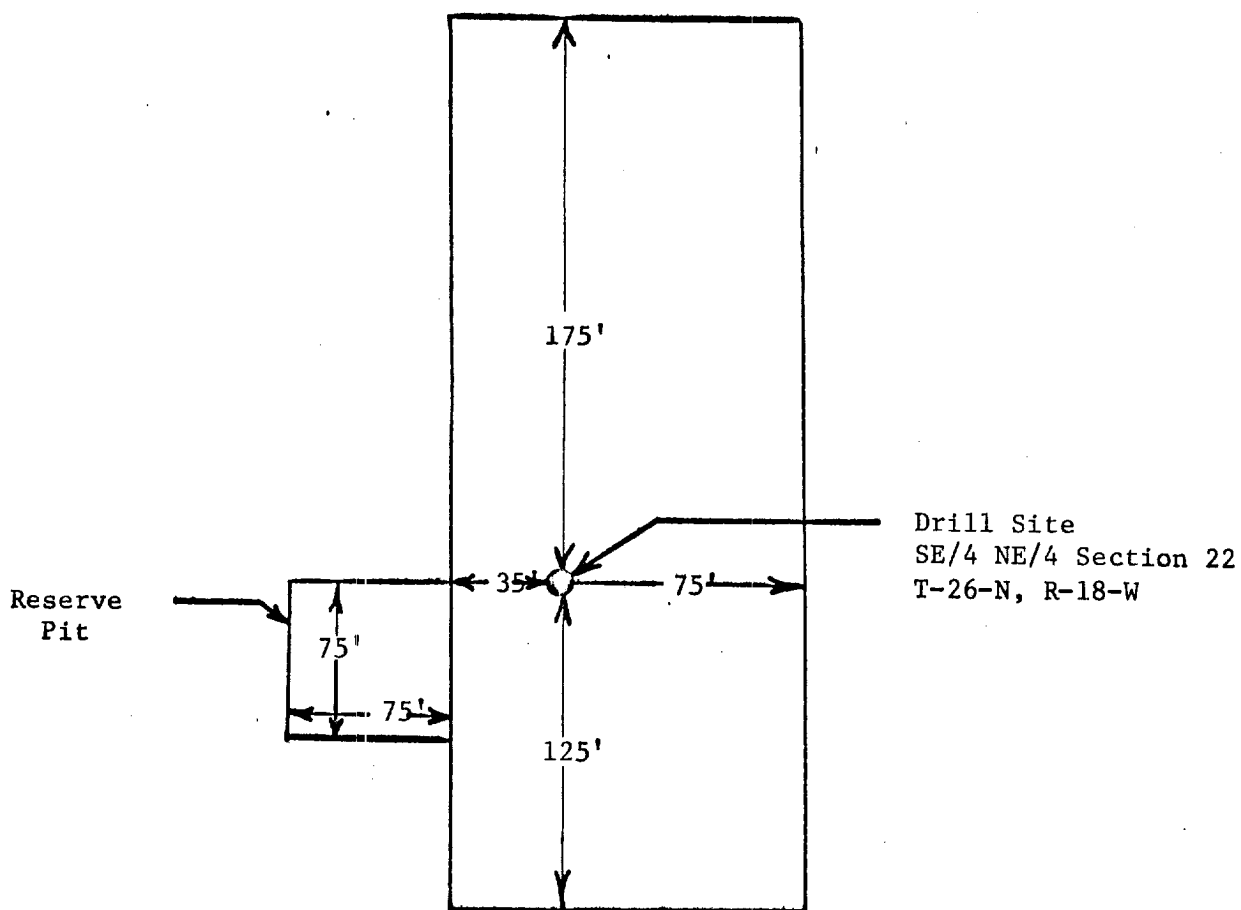
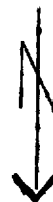

Amoco Production Company

SCALE: None

DRILLING LOCATION DIAGRAM  
NAVAJO TRIBAL "U" NO. 25 - TOCITO DOME FIELD

DRG. 74-JWC-0517  
NO.

