

District I  
P.O. Box 1980, Hobbs, NM

District II  
P.O. Drawer DD, Artesia, NM 88221

District III  
1000 Rio Brazos Rd, Aztec, NM 87410

State of New Mexico  
Energy, Minerals and Natural Resources Department

OIL CONSERVATION DIVISION

2040 South Pacheco Street  
Santa Fe, New Mexico 87505

SUBMIT 1 COPY TO  
APPROPRIATE  
DISTRICT OFFICE  
AND 1 COPY TO  
SANTA FE OFFICE

*Long & Fast*  
**DEPUTY OIL & GAS INSPECTOR**

FEB 08 1999

**PIT REMEDIATION AND CLOSURE REPORT**

**RECEIVED**  
NOV 12 1998

**Operator:** PNM Gas Services ( Cross Timbers ) **Telephone:** 324-3761

**Address:** 603 W. Elm Street Farmington, NM 87401

**Facility or Well Name:** Gallegos #13

**Location:** Unit P Sec 35 T 26 N R 11 W County San Juan

**Pit Type:** Separator ☐ Dehydrator ☒ Other \_\_\_\_\_

**Land Type:** BLM ☐ State ☐ Fee ☐ Other Navajo

**Pit Location:** Pit dimensions: length 18 ' width 18 ' depth 3 '

(Attach diagram) **Reference:** wellhead ☒ other \_\_\_\_\_

**Footage from reference:** 46'

**Direction from reference:** 32 Degrees ☐ East ☒ North ☒ of ☒ West ☐ South ☐

**Depth to Ground Water:**  
(Vertical distance from contaminants to seasonal high water elevation of ground water)

Less than 50 feet	(20 points)	
50 feet to 99 feet	(10 points)	
Greater than 100 feet	( 0 points)	<u>10</u>

**Wellhead Protection Area:**  
(Less than 200 feet from a private domestic water source, or; less than 1,000 feet from all other water sources)

Yes	(20 points)	
No	( 0 points)	<u>0</u>

**Distance to Surface Water:**  
(Horizontal distance to perennial lakes, ponds, rivers, streams, creeks, irrigation canals and ditches)

Less than 200 feet	(20 points)	
200 feet to 1,000 feet	(10 points)	
Greater than 1,000 feet	( 0 points)	<u>0</u>

**RANKING SCORE (TOTAL POINTS):** 10

Gallegos #13

Date Remediation Started: 6/10/98

Date Completed: 6/10/98

Remediation Method: Excavation ☒

Approx. Cubic Yard 123

(Check all appropriate sections)

Landfarmed ☒

Amount Landfarmed (cubic yds) 123

Other

Remediation Location:

Onsite ☒

Offsite

(i.e., landfarmed onsite, name and location of offsite facility)

RECEIVED  
NOV 12 1998

Backfill Material Location:

OIL CON. DIV.  
DIST. 3

General Description of Remedial Action:

Excavated contaminated soil to a pit size of 26' X 32' X 4' and landfarmed soil onsite within a bermed area at a depth of 6" to 12". Soil was aerated by disking/plowing until soil met regulatory levels.\*\*\*Hard sandstone rock encountered at 4'. See attached risk analysis and lab analysis form.Ground Water Encountered: No ☒ Yes ☐ DepthFinal Pit Closure  
Sampling:

Sample Location Bottom of excavation.

(if multiple samples, attach sample result and diagram of sample locations and depths.)

Sample depth 4'

Sample date 6/11/98 Sample time 7:25:00 AM

Sample Results

Benzene (ppm) 0.9700

Total BTEX (ppm) 87.0700 \*\*\*

Field headspace (ppm)

TPH (ppm) 310.00 Method 8015A

Vertical Extent (ft) Risk Analysis form attached Yes ☒ No ☐

Ground Water Sample:

Yes ☐No ☒

(If yes, see attached Groundwater Site Summary Report)

I HEREBY CERTIFY THAT THE INFORMATION ABOVE IS TRUE AND COMPLETE TO THE BEST OF MY KNOWLEDGE AND MY BELIEF

DATE October 29, 1998

SIGNATURE

*Maureen Gannon*PRINTED NAME Maureen Gannon  
AND TITLE Project Manager



**Environmental Services**

---

Well Name:	Gallegos #13
Well Legals:	Unit P, Sec 35, T26N, R11W
Pit Type:	Dehydrator
Horizontal Distance to Surface Water:	Greater than 1,000 feet
Groundwater Depth:	50 feet to 99 feet

---

**RISK ANALYSIS**

PNM requests closure of their former pit on the Gallegos #13 well site using a limited risk analysis based on the following conditions:

1. Groundwater is estimated to be at a depth of 60 feet based upon the elevation of the site and the elevation of the nearest "listed" or "named" river. (Reference: Huerfano Trading Post NW, NM topographic map.)
2. The site is not located within 200 feet of a domestic water well and is not within 1,000 feet of any other water source.
3. PNM excavated 123 cubic yards of soil from the former pit. Subsurface lateral contamination has been remediated (see attached analytical results). Source removal minimizes the possibility of surface water contamination.
4. Hard sandstone rock was encountered at 4 feet below ground surface. Bedrock/sandstone provides a barrier between remaining contamination and groundwater. Vertical migration through bedrock or sandstone to groundwater is unlikely.
5. PNM excavated and performed remediation to the maximum depth and horizontal extent practicable.

PNM believes their former pit on the Gallegos #13 well site poses minimal threat to groundwater, human health and the environment based upon our past experience in excavating over 800 pits.

Gallegos #13  
Sec. 35 T26N R11W Unit A  
Cross Timbers

Site Drawing

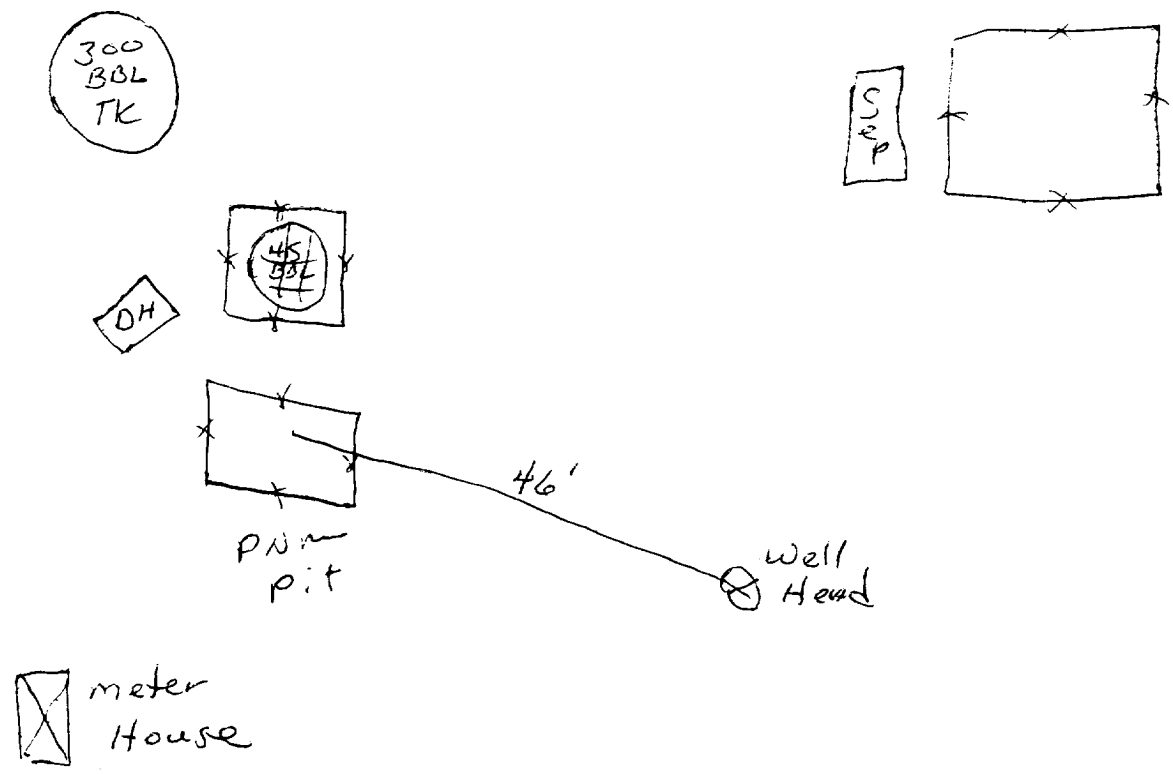

OFF: (505) 325-5667



LAB: (505) 325-1556

**On Site Technologies, LTD.**

**Date:** 17-Jun-98

---

**CLIENT:** PNM - Public Service Company of NM

**Project:** Gallegos 13

**Lab Order:** 9806046

## **CASE NARRATIVE**

---

Samples were analyzed using the methods outlined in the following references:

Test Methods for Evaluating Solid Waste, Physical/Chemical Methods, SW846, 3rd Edition

All method blanks, laboratory spikes, and/or matrix spikes met quality assurance objectives.

OFF: (505) 325-5667

# ON SITE

TECHNOLOGIES, LTD.

LAB: (505) 325-1556

**ANALYTICAL REPORT**

Date: 17-Jun-98

<b>Client:</b>	PNM - Public Service Company of NM	<b>Client Sample Info:</b>	Gallegos 13
<b>Work Order:</b>	9806046	<b>Client Sample ID:</b>	9806110725; Bottom
<b>Lab ID:</b>	9806046-01A	<b>Matrix:</b>	SOIL
<b>Project:</b>	Gallegos 13	<b>Collection Date:</b>	6/11/98 7:25:00 AM
		<b>COC Record:</b>	5230

Parameter	Result	PQL	Qual	Units	DF	Date Analyzed
<b>DIESEL RANGE ORGANICS</b>		<b>SW8015</b>				Analyst: HR
T/R Hydrocarbons: C10-C28	310	25		mg/Kg	1	6/16/98
<b>BTEX</b>		<b>SW8020A</b>				Analyst: DC
Benzene	970	500		µg/Kg	500	6/14/98
Toluene	24000	1000		µg/Kg	500	6/14/98
Ethylbenzene	7100	500		µg/Kg	500	6/14/98
m,p-Xylene	44000	1000		µg/Kg	500	6/14/98
o-Xylene	11000	500		µg/Kg	500	6/14/98

87010  
87.07

<b>Qualifiers:</b>	PQL - Practical Quantitation Limit	S - Spike Recovery outside accepted recovery limits
	ND - Not Detected at Practical Quantitation Limit	R - RPD outside accepted recovery limits
	J - Analyte detected below Practical Quantitation Limit	E - Value above quantitation range
	B - Analyte detected in the associated Method Blank	Surr: - Surrogate

1 of 1

P.O. BOX 2606 • FARMINGTON, NM 87499

OFF: (505) 325-5667



LAB: (505) 325-1556

## ANALYTICAL REPORT

Date: 17-Jun-98

<b>Client:</b>	PNM - Public Service Company of NM	<b>Client Sample Info:</b>	Gallegos 13
<b>Work Order:</b>	9806046	<b>Client Sample ID:</b>	9806110735; Walls
<b>Lab ID:</b>	9806046-02A	<b>Matrix:</b>	SOIL
<b>Project:</b>	Gallegos 13	<b>Collection Date:</b>	6/11/98 7:35:00 AM
		<b>COC Record:</b>	5230

Parameter	Result	PQL	Qual	Units	DF	Date Analyzed
<b>DIESEL RANGE ORGANICS</b>		<b>SW8015</b>				Analyst: HR
T/R Hydrocarbons: C10-C28	ND	25		mg/Kg	1	6/16/98
<b>BTEX</b>		<b>SW8020A</b>				Analyst: DC
Benzene	ND	1		µg/Kg	1	6/14/98
Toluene	ND	2		µg/Kg	1	6/14/98
Ethylbenzene	ND	1		µg/Kg	1	6/14/98
m,p-Xylene	5.6	2		µg/Kg	1	6/14/98
o-Xylene	2.9	1		µg/Kg	1	6/14/98

<b>Qualifiers:</b>	PQL - Practical Quantitation Limit	S - Spike Recovery outside accepted recovery limits
	ND - Not Detected at Practical Quantitation Limit	R - RPD outside accepted recovery limits
	J - Analyte detected below Practical Quantitation Limit	E - Value above quantitation range
	B - Analyte detected in the associated Method Blank	Surr: - Surrogate

1 of 1

P.O. BOX 2606 • FARMINGTON, NM 87499

- TECHNOLOGY BLENDING INDUSTRY WITH THE ENVIRONMENT -

Gallegos #13

7/2/98

Cross Timbers

Sec. 35, 16N, 11W, P

Land Farm:

124 yards

13.7	15.2	φ
4.8	1.9	φ

⊗

9807020800

2"-12" depth

Soil vapor head space = 56.7 ppm



OFF: (505) 325-5667



LAB: (505) 325-1556

**On Site Technologies, LTD.**

**Date:** 10-Jul-98

---

**CLIENT:** PNM - Public Service Company of NM  
**Project:** Landfarms  
**Lab Order:** 9807007

---

**CASE NARRATIVE**

Samples were analyzed using the methods outlined in the following references:

Test Methods for Evaluating Solid Waste, Physical/Chemical Methods, SW846, 3rd Edition

All method blanks, laboratory spikes, and/or matrix spikes met quality assurance objectives.

OFF: (505) 325-5667



LAB: (505) 325-1556

## ANALYTICAL REPORT

Date: 10-Jul-98

<b>Client:</b>	PNM - Public Service Company of NM	<b>Client Sample Info:</b>	Gallegos #13
<b>Work Order:</b>	9807007	<b>Client Sample ID:</b>	9807020800; 6pt. Comp
<b>Lab ID:</b>	9807007-02A	<b>Matrix:</b>	SOIL
<b>Project:</b>	Landfarms	<b>Collection Date:</b>	7/2/98 8:00:00 AM
		<b>COC Record:</b>	7310

Parameter	Result	PQL	Qual	Units	DF	Date Analyzed
<b>DIESEL RANGE ORGANICS</b>		<b>SW8015</b>				Analyst: HR
T/R Hydrocarbons: C10-C28	82	25		mg/Kg	1	7/8/98

**Qualifiers:**

- PQL - Practical Quantitation Limit
- ND - Not Detected at Practical Quantitation Limit
- J - Analyte detected below Practical Quantitation Limit
- B - Analyte detected in the associated Method Blank

- S - Spike Recovery outside accepted recovery limits
- R - RPD outside accepted recovery limits
- E - Value above quantitation range
- Surr: - Surrogate

1 of 1

P.O. BOX 2606 • FARMINGTON, NM 87499

- SERVING THE PETROLEUM INDUSTRY WITH THE ENVIRONMENT -