

OIL CONSERVATION COMMISSION
Arroyo DISTRICT

OIL CONSERVATION COMMISSION
BOX 2088
SANTA FE, NEW MEXICO

DATE May 17, 1976

RE: Proposed MC _____
Proposed DHC _____
Proposed NSL ✓ _____
Proposed SWD _____
Proposed WFX _____
Proposed PMX _____

Jim Kapteina

Gentlemen:

I have examined the application dated May 12, 1976
for the Kirby Exploration Co. Grigsby #1 C-9-26N-13W
Operator Lease and Well No. Unit, S-T-R

and my recommendations are as follows:

Approve

Yours very truly,

AR Kendrick

3E COMPANY, INC.

Engineering • Energy • Exploration

P. O. Box 190 —:— 505/327-4020

FARMINGTON, NEW MEXICO 87401

May 12, 1976

New Mexico Oil Conservation Commission
P.O. Box 2088
Santa Fe, New Mexico 87501

Attention: Secretary - Director

RE: Non-standard locations
Kirby Exploration Company
Armour Federal #1
1350' FWL & 980' FNL
Sec 4 - 26N - 13W
Grigsby #1
1350' FWL & 980' FNL
Sec 9 - 26N - 13W
WAW Picture Cliff Extension



Gentlemen:

By means of this letter we wish to request administrative approval for the non-standard locations of the captioned wells. The two wells are inside the 130' requirement distance from the quarter - quarter section line in their respective sections.

The Armour Federal #1 and the Grigsby #1 were originally staked as normal locations. However, the wells are on land that is part of the Navajo Indian Irrigation Project. The Bureau of Indian Affairs (see enclosed letter) requested that the locations be moved to the present sites so as to cause the least amount of interference with the proposed sprinkling activities in the area. The attached map shows that the Bureau of Indian Affairs plans to run their main water supply line along the quarter - quarter section lines and route their sprinkler systems perpendicular to this main supply line. If the wells are located close to the supply line then they will not interfere with the sprinklers.

All offsetting lease holders (see attached map) have been notified by certified mail. Since these wells are within spacing regulations concerning outer boundaries of the lease, we do not feel that approval of these locations will cause any harm to offsetting lease holders.

Should further information be required, please advise.

Yours very truly,

William T. Jones

W. T. Jones

WTJ:kj

Enclosure

cc: A. R. Kendrick, Aztec

NEW MEXICO OIL CONSERVATION COMMISSION
WELL LOCATION AND ACREAGE DEDICATION PLAT

Form C-102
Supersedes C-128
Effective 1-1-65

All distances must be from the outer boundaries of the Section.

Operator Kirby Exploration		Lease Grigsby		Well No. 1
Unit Letter C	Section 9	Township 26N	Range 13W	County San Juan
Actual Footage Location of Well: 980 feet from the North line and 1350 feet from the West line				
Ground Level Elev. 6262	Producing Formation Picture Cliff	Pool WAW Extension	Dedicated Acreage: 160 Acres	

1. Outline the acreage dedicated to the subject well by colored pencil or hachure marks on the plat below.
2. If more than one lease is dedicated to the well, outline each and identify the ownership thereof (both as to working interest and royalty).
3. If more than one lease of different ownership is dedicated to the well, have the interests of all owners been consolidated by communitization, unitization, force-pooling, etc?

☐ Yes ☐ No If answer is "yes," type of consolidation _____

If answer is "no," list the owners and tract descriptions which have actually been consolidated. (Use reverse side of this form if necessary.) _____

No allowable will be assigned to the well until all interests have been consolidated (by communitization, unitization, forced-pooling, or otherwise) or until a non-standard unit, eliminating such interests, has been approved by the Commission.

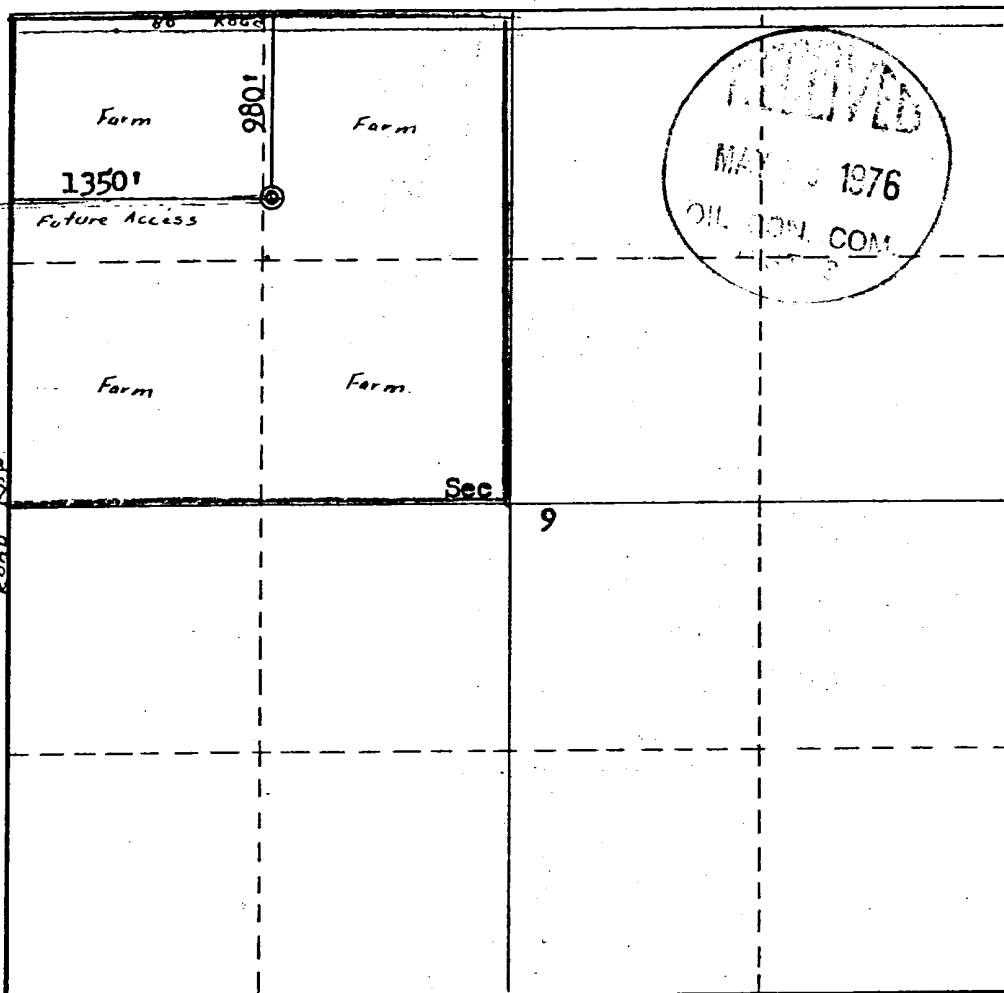

CERTIFICATION

I hereby certify that the information contained herein is true and complete to the best of my knowledge and belief.

W. T. Jones

Name

Agent

Position

Kirby Exploration Co: . . .

Company

5-7-76

Date

William T. Jones

I hereby certify that the well location shown on this plat was plotted from field notes of actual surveys made by me or under my supervision, and that the same is true and correct to the best of my knowledge and belief.

Date Surveyed

May 7, 1976

Registered Professional Engineer and/or Land Surveyor

Fred B. Kerr Jr.

Certificate No.

3950

0 330 660 990 1320 1650 1980 2310 2640 2000 1500 1000 500 0



IN REPLY REFER TO:

UNITED STATES
DEPARTMENT OF THE INTERIOR

RESOURCES
Irrigation (NIIP)

BUREAU OF INDIAN AFFAIRS
NAVAJO INDIAN IRRIGATION PROJECT
P. O. Box 2157
Farmington, New Mexico 87401

May 5, 1976

Mr. A. R. Kendrick
New Mexico State Oil
Conservation Commission
1000 Rio Brazos Road
Aztec, New Mexico 87410

Dear Mr. Kendrick:

The Navajo Indian Irrigation Project is now being developed as an all-sprinkler irrigation project.

In order to cause the least amount of interference with sprinkling activities it is necessary to locate some oil and gas wells at locations other than standard.

Within the Navajo Indian Irrigation Project area, we are working with the oil and gas companies in an effort to locate wells so that they will have the least amount of interference with farming activities and also with oil and gas operations. Therefore, we will appreciate your cooperation in approving these non-standard locations wherever possible.

Thank you for your cooperation in this matter.

Sincerely yours,

J. H. Christensen
Project Engineer

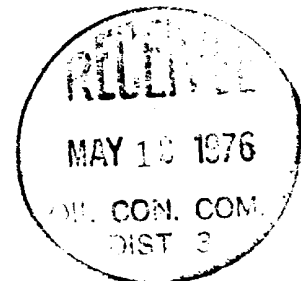

VICINITY MAP
SUPPORT DATA
APPLICATION for Non Standard
LOCATIONS, Grigsby #1,
ARMOUR Federal #1
Kirby Exploration Company

