

UNITED STATES
DEPARTMENT OF THE INTERIOR
GEOLOGICAL SURVEY

30-045-22309
5. LEASE DESIGNATION AND SERIAL NO.
NM23472
NM22046

APPLICATION FOR PERMIT TO DRILL, DEEPEN, OR PLUG BACK

6. IF INDIAN, ALLOTTEE OR TRIBE NAME

7. UNIT AGREEMENT NAME

8. FARM OR LEASE NAME

Chaco

9. WELL NO.

1

10. FIELD AND POOL, OR WILDCAT

Wildcat - *Richard Cliffs*

11. SEC., T., R., M., OR BLK.
AND SURVEY OR AREA

Sec. 18, T26N, R12W

12. COUNTY OR PARISH 13. STATE

San Juan N.M.

1a. TYPE OF WORK

DRILL ☒

DEEPEN ☐

PLUG BACK ☐

b. TYPE OF WELL

OIL
WELL ☐

GAS
WELL ☒

OTHER

SINGLE
ZONE ☒

MULTIPLE
ZONE ☐

2. NAME OF OPERATOR

J. Gregory Merrion and Robert L. Bayless

3. ADDRESS OF OPERATOR

P.O. Box 1541, Farmington, New Mexico 87401

4. LOCATION OF WELL (Report location clearly and in accordance with any State requirements.)*

At surface

1826 FNL and 1826 NWL

At proposed prod. zone

Same

14. DISTANCE IN MILES AND DIRECTION FROM NEAREST TOWN OR POST OFFICE*

15. DISTANCE FROM PROPOSED*

LOCATION TO NEAREST
PROPERTY OR LEASE LINE, FT.
(Also to nearest drlg. unit line, if any)

16. NO. OF ACRES IN LEASE

17. NO. OF ACRES ASSIGNED
TO THIS WELL

156.43

18. DISTANCE FROM PROPOSED LOCATION*
TO NEAREST WELL, DRILLING, COMPLETED,
OR APPLIED FOR, ON THIS LEASE, FT.

19. PROPOSED DEPTH

1400

20. ROTARY OR CABLE TOOLS

Rotary

21. ELEVATIONS (Show whether DF, RT, GR, etc.)

5989 GL

22. APPROX. DATE WORK WILL START*

January 15, 1977

23. PROPOSED CASING AND CEMENTING PROGRAM

SIZE OF HOLE	SIZE OF CASING	WEIGHT PER FOOT	SETTING DEPTH	QUANTITY OF CEMENT
7-7/8	5-1/2	15.5	30	10 Sax
4-3/4	2-7/8	6.4	1350	100 Sax

Will drill 7-7/8" hole to 30 ft. and set 30 ft. of 5-1/2", 15.5 lb. casing with 10 sax cement. Will drill 4-3/4" hole to 1350 ft. and run logs. If appears productive, will run 1350 ft. of 2-7/8", 6.4 lb., J-55 casing and cement with 100 sax. Will perforate and stimulate as required.

DEC 29 1976

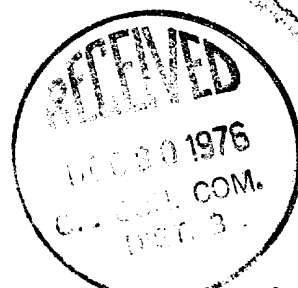

Gas not dedicated

IN ABOVE SPACE DESCRIBE PROPOSED PROGRAM: If proposal is to deepen or plug back, give data on present productive zone and proposed new productive zone. If proposal is to drill or deepen directionally, give pertinent data on subsurface locations and measured and true vertical depths. Give blowout preventer program, if any.

24.

SIGNED

Robert L. Bayless

TITLE

Co-Owner

DATE

12-15-76

(This space for Federal or State office use)

PERMIT NO.

APPROVAL DATE

APPROVED BY

TITLE

DATE

CONDITIONS OF APPROVAL, IF ANY:

allap

*See Instructions On Reverse Side

NEW MEXICO OIL CONSERVATION COMMISSION
WELL LOCATION AND ACREAGE DEDICATION PLAT

Form C-102
Supersedes C-128
Effective 1-1-65

All distances must be from the outer boundaries of the Section.

Operator Merrion & Bayless		Lease Chaco		Well No. 1
Unit Letter F	Section 18	Township 26 North	Range 12 West	County San Juan
Actual Footage Location of Well:				
1826 feet from the North line and		1826 feet from the West line		
Ground Level Elev. 5989	Producing Formation Pictured Cliffs	Pool Wildcat	Dedicated Acreage: 156.43 Acres	

1. Outline the acreage dedicated to the subject well by colored pencil or hachure marks on the plat below.
2. If more than one lease is dedicated to the well, outline each and identify the ownership thereof (both as to working interest and royalty).
3. If more than one lease of different ownership is dedicated to the well, have the interests of all owners been consolidated by communitization, unitization, force-pooling, etc?

☒ Yes ☐ No If answer is "yes," type of consolidation Communitization

If answer is "no," list the owners and tract descriptions which have actually been consolidated. (Use reverse side of this form if necessary.)

No allowable will be assigned to the well until all interests have been consolidated (by communitization, unitization, forced-pooling, or otherwise) or until a non-standard unit, eliminating such interests, has been approved by the Commission.

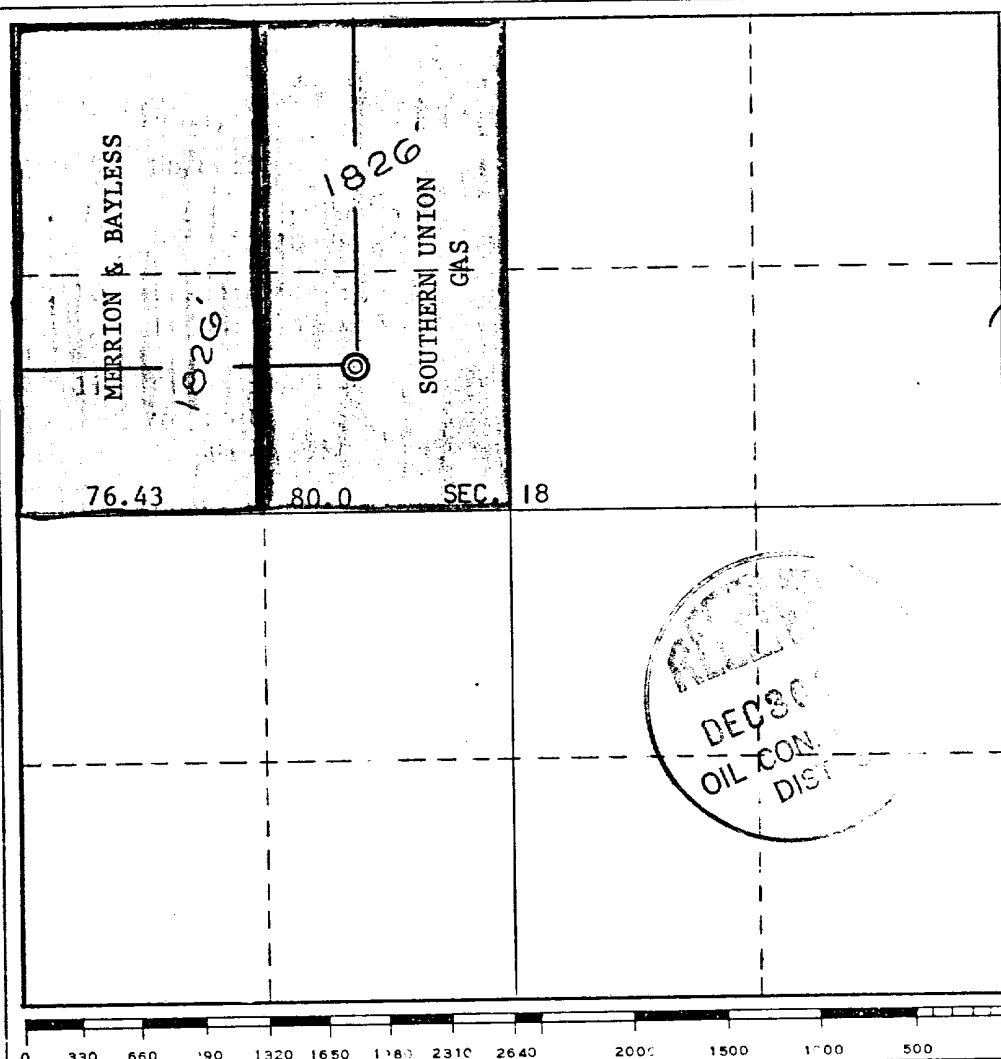

CERTIFICATION

I hereby certify that the information contained herein is true and complete to the best of my knowledge and belief.

Name
Robert L. Bayless
Position
Co-Owner

Company
Merrion & Bayless

Date
December 15, 1976

I hereby certify that the well location shown on this plat was plotted from field notes of actual surveys made by me or under my supervision, and that the same is true and correct to the best of my knowledge and belief.

Date Surveyed
December 12, 1976

Registered Professional Engineer and/or Land Survey

E. V. Echhawk

Certificate No. **3602**
E.V. Echhawk LS

NTL-6 REQUIREMENTS

CHACO #1

Section 18, T26N, R12W
San Juan County, New Mexico

- 1 & 2. A topographical map is attached showing location of drill site and access roads to location. The terrain is relatively flat and no new roads will be built. A drive-in truck-mounted drilling rig will be used and will be driven in to the location with our road work.
3. Wells within one mile radius are shown on the topographical map.
4. There are no existing or proposed facilities.
5. Water will be hauled from the San Juan River by truck.
6. No construction materials will be used.
7. Drill cuttings will be placed in a pit and covered when dry and location will be cleaned after work on well is completed.
8. No ancillary facilities.
9. Well site layout attached.
10. Restoration of drillsite -- pits will be filled and leveled and area reseeded to BLM specifications.
11. Other information: the drillsite is fairly level, arid land with very little vegetation. There is no other surface use or facilities existent. An archeological survey statement will be furnished.
12. Operator representative:

Robert L. Bayless
P.O. Box 1541
Farmington, New Mexico 87401
Office Phone: 325-5093
Res. Phone: 325-8985

13. Certification:

I hereby certify that I, or persons under by direct supervision, have inspected the proposed drillsite and access route; that I am familiar with the conditions which presently exist; that the statements made in this plan are, to the best of my knowledge, true and correct; and, that the work associated with the operations proposed herein will be performed by MERRION & BAYLESS and its contractors and subcontractors in conformity with this plan and the terms and conditions under which it is approved.

12-27-76
Date

Robert L. Bayless
Name and Title

LOCATION AND EQUIPMENT LAY-OUT

MERRION & BAYLESS
Chaco #1
Section 18, T26N, R12W

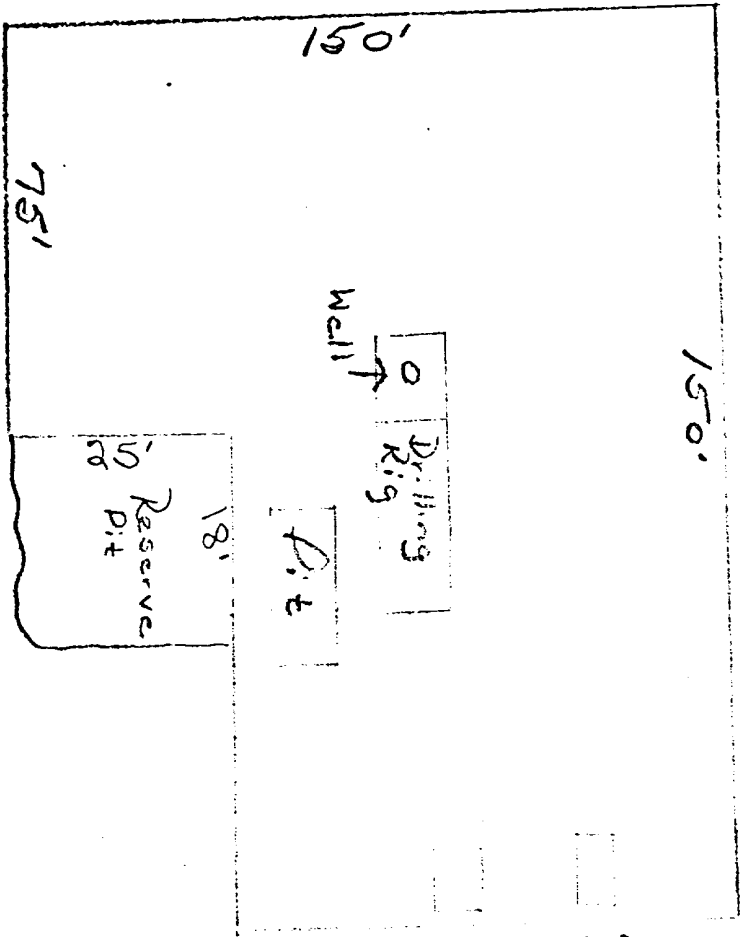

Latrine
2' x 4' x 4' deep

Burn Pit
8' x 12' x 4' deep

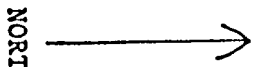

NO LOCATION LEVELING
WORK DONE - DRIVE-IN
TRUCK RIG USED.

