

Distribution: 0+5 (BLM); 1-Well File

Form 3150-3
(November 1983)
(formerly 9-331C)

SUBMIT IN TRIPLICATE*
(Other instructions on
reverse side)

Form approved.
Budget Bureau No. 1004-0136
Expires August 31, 1985

UNITED STATES
DEPARTMENT OF THE INTERIOR
BUREAU OF LAND MANAGEMENT

RECEIVED
BLM

APPLICATION FOR PERMIT TO DRILL, DEEPEN, OR PLUG BACK

1a. TYPE OF WORK

DRILL ☐

DEEPEN ☐

b. TYPE OF WELL

OIL
WELL ☐

GAS
WELL ☒

OTHER

SINGLE
ZONE ☐

MULTIPLE
ZONE ☐

2. NAME OF OPERATOR

Merrion Oil & Gas Corporation

3. ADDRESS OF OPERATOR

P. O. Box 840, Farmington, New Mexico 87499

4. LOCATION OF WELL (Report location clearly and in accordance with any State requirements.)*
At surface

1190' FSL & 1850' FWL
At proposed prod. zone

14. DISTANCE IN MILES AND DIRECTION FROM NEAREST TOWN OR POST OFFICE*

10. DISTANCE FROM PROPOSED*

LOCATION TO NEAREST
PROPERTY OR LEASE LINE, FT.
(Also to nearest drig. unit line, if any)

16. NO. OF ACRES IN LEASE

320

17. NO. OF ACRES ASSIGNED
TO THIS WELL

160

18. DISTANCE FROM PROPOSED LOCATION*
TO NEAREST WELL, DRILLING, COMPLETED,
OR APPLIED FOR, ON THIS LEASE, FT.

19. PROPOSED DEPTH

20. ROTARY OR CABLE TOOLS

21. ELEVATIONS (Show whether DF, RT, GR, etc.)

6065' GL

22. APPROX. DATE WORK WILL START*

23. PROPOSED CASING AND CEMENTING PROGRAM

SIZE OF HOLE	SIZE OF CASING	WEIGHT PER FOOT	SETTING DEPTH	QUANTITY OF CEMENT

Attached for your approval is a procedure to test the well in the Farmington Sand, and if unproductive, to plug the well out. This supersedes the sundry notice dated 10/11/91 to plug the well without testing additional sands.

RECEIVED

OCT 15 1992

OIL CON. 1
DIST. 3

IN ABOVE SPACE DESCRIBE PROPOSED PROGRAM: If proposal is to deepen or plug back, give data on present productive zone and proposed new productive zone. If proposal is to drill or deepen directionally, give pertinent data on subsurface locations and measured and true vertical depths. Give blowout preventer program, if any.

24.

SIGNED

George F. Sharpe

TITLE Petroleum Engineer

DATE 10/05/92

(This space for Federal or State office use)

PERMIT NO.

APPROVAL DATE

APPROVED

APPROVED BY

TITLE

DATE OCT 14 1992

CONDITIONS OF APPROVAL, IF ANY:

AREA MANAGER

*See Instructions On Reverse Side

NMOCD

Title 18 U.S.C. Section 1001, makes it a crime for any person knowingly and willfully to make to any department or agency of the United States any false, fictitious or fraudulent statements or representations as to any matter within its jurisdiction.

Submit to Appropriate
District Office
State Lease - 4 copies
Fee Lease - 3 copies

State of New Mexico
Energy, Minerals and Natural Resources Department

Form C-102
Revised 1-1-89

OIL CONSERVATION DIVISION

P.O. Box 2088
Santa Fe, New Mexico 87504-2088

DISTRICT I
P.O. Box 1980, Hobbs, NM 88240

DISTRICT II
P.O. Drawer DD, Artesia, NM 88210

DISTRICT III
1000 Rio Brazos Rd., Aztec, NM 87410

WELL LOCATION AND ACREAGE DEDICATION PLAT

All Distances must be from the outer boundaries of the section

Operator Merrion Oil & Gas Corporation			Lease Frew Federal		Well No. 13
Unit Letter N	Section 29	Township 26N	Range 12W	County San Juan	
Actual Footage Location of Well: 1190 feet from the South line and 1850 feet from the West line					
Ground level Elev. 6065"		Producing Formation Farmington Sand	Pool Bisti	Dedicated Acreage: 160 Acres	

1. Outline the acreage dedicated to the subject well by colored pencil or hatchure marks on the plat below.
2. If more than one lease is dedicated to the well, outline each and identify the ownership thereof (both as to working interest and royalty).
3. If more than one lease of different ownership is dedicated to the well, have the interest of all owners been consolidated by communitization, unitization, force-pooling, etc.?
☐ Yes ☐ No If answer is "yes" type of consolidation _____
If answer is "no" list the owners and tract descriptions which have actually been consolidated. (Use reverse side of this form if necessary). _____
No allowable will be assigned to the well until all interests have been consolidated (by communitization, unitization, forced-pooling, or otherwise) or until a non-standard unit, eliminating such interest, has been approved by the Division.

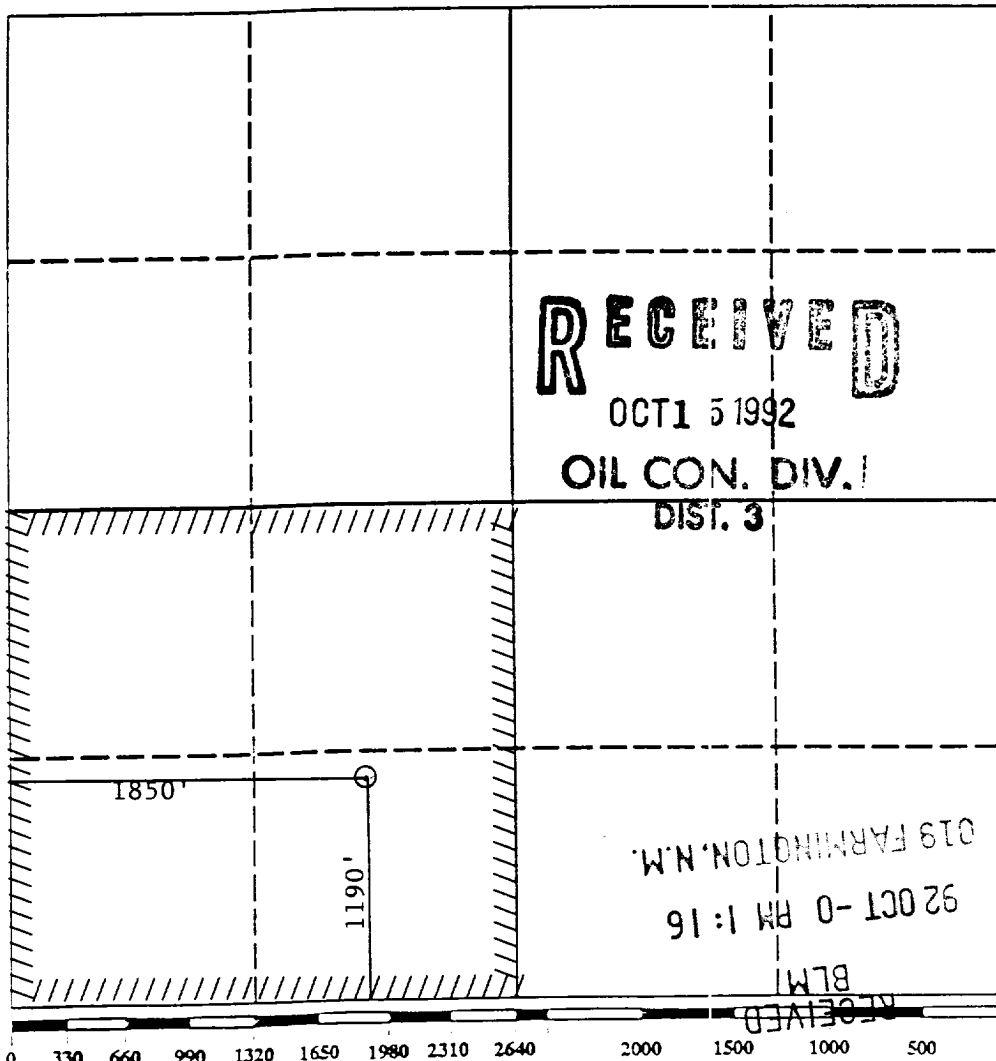

OPERATOR CERTIFICATION

I hereby certify that the information contained herein is true and complete to the best of my knowledge and belief.

Signature

Printed Name

George F. Sharpe

Position

Petroleum Engineer

Company

Merrion Oil & Gas Corporation

Date

10/05/92

SURVEYOR CERTIFICATION

I hereby certify that the well location shown on this plat was plotted from field notes of actual surveys made by me or under my supervision, and that the same is true and correct to the best of my knowledge and belief.

Date Surveyed

Signature & Seal of
Professional Surveyor

Certificate No.

MERRION OIL & GAS CORPORATION

FREW FEDERAL #13
Farmington Sand Recompletion Procedure

Location: 1190' FSL 1850' FWL Elevation: 6065' G.L.
 Sec 29, 26N, 12W
 San Juan County, N.M.

Prepared By: George F. Sharpe Date 10-2-92

- 1) MIRU. POOH w/ 1 1/4" tbg. RIH w/ 2 7/8" RBP and set @ \pm 700'. POOH w/ tbg.
- 2) RU Wireline. Perforate Farmington sand 592-602' w/ 4SPF per density neutron log. RD Wireline.
- 3) Swab well in and test through orifice tester. Catch fluid sample. Spot acid and break down if necessary.
- 4) If productive, RDMOL. Turn well to production.
- 5) If not productive, retrieve RBP and set @ 500'.
- 6) RU Wireline. Perforate Farmington Sand 340-48' and 460-72' w/ 4SPF per density neutron log.
- 7) Swab well in and test, catch fluid sample.
- 8) If productive, RDMOL. Turn well to production.
- 9) If not productive, retrieve RBP. Plug out well by filling hole w/ \pm 30 sx neat cmt.
- 10) Cut off csg. Install P&A marker. Reclaim location.

Approved _____ Date _____

RECEIVED
B&M

WELLBORE SCHEMATIC

MKM 4/12/90

LOCATION: 1190' FSL & 1850' FWL
Section 29, T26N, R12W
San Juan County, New Mexico

ELEVATION: 6065' GL

PROPOSAL:

Test Farmington Sand

340'-48'
460'-72'
592'-602'

TOPS

Pictured Cliffs	1066'
Fruitland	730'
Farmington	520'

PBTD: 1190'

TD: 1230'

2-7/8" Capacity: .00592 Bbls/Ft
.0332 Ft³/Ft

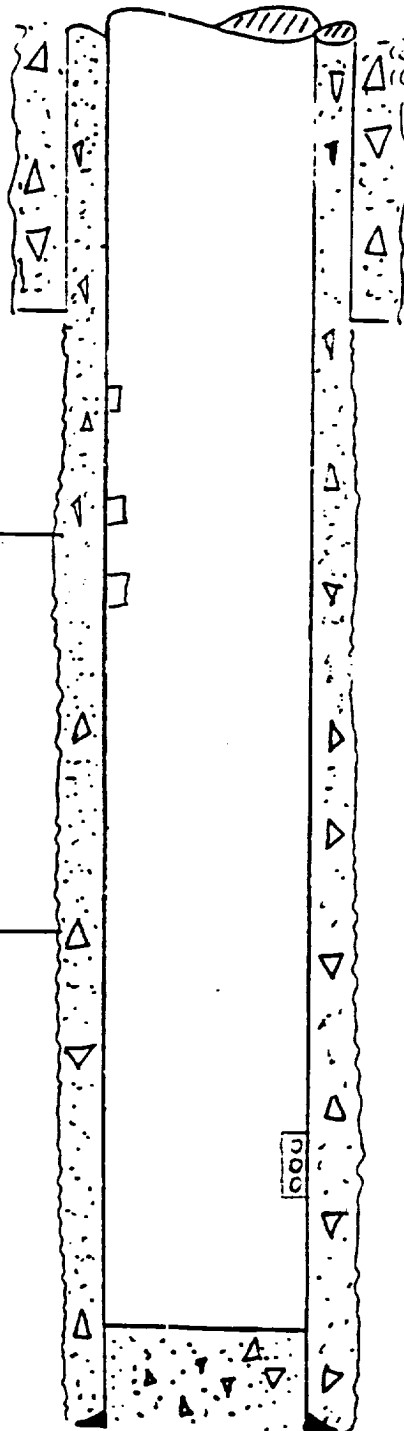

9-7/8" hole

7", 20#, K-55, R-3, ST&C
casing at 43'
Cement with 35 sx Class "B"
3% CaCl₂

Perf Pictured Cliffs 1074'-84'
with 2 JSPF
Foam frac with 20,000# 10/20 sand

4-3/4" Hole
2-7/8", 6.50#, J-55, R-2, EUE
casing at 1218'.
Cement with 75 sx Lodense follow
with 50 sx Clas "B" with 3% CaCl.

TOC @ Surface