

NO. OF COPIES RECEIVED	6
DISTRIBUTION	
SANTA FE	1
FILE	1
U.S.G.S.	2
LAND OFFICE	1
OPERATOR	1

NEW MEXICO OIL CONSERVATION COMMISSION

30-045-22961
Form C-101
Revised 1-1-65

5A. Indicate Type of Lease	
STATE <input checked="" type="checkbox"/>	FEE <input type="checkbox"/>
5. State Oil & Gas Lease No.	
E - 9224	

APPLICATION FOR PERMIT TO DRILL, DEEPEN, OR PLUG BACK

1a. Type of Work		7. Unit Agreement Name	
b. Type of Well OIL WELL <input type="checkbox"/> GAS WELL <input checked="" type="checkbox"/> OTHER <input type="checkbox"/>		8. Farm or Lease Name	
DRILL <input checked="" type="checkbox"/> DEEPEN <input type="checkbox"/> PLUG BACK <input type="checkbox"/>		State Com	
2. Name of Operator		9. Well No.	
Mesa Petroleum Co.		47	
3. Address of Operator		10. Field and Pool, or Wildcat	
Box 2009, Amarillo, Texas 79105		Blanco Mesa Verde-PC	
4. Location of Well		12. County	
UNIT LETTER L LOCATED 1760 FEET FROM THE South LINE		San Juan	
AND 835 FEET FROM THE West LINE OF SEC. 2 TWP. 27N RGE. 8W NMPM			
19. Proposed Depth		19A. Formation	
4900		Mesa Verde-P.C.	
20. Rotary or C.T.		Rotary	
21. Elevations (Show whether DF, RT, etc.)		22. Approx. Date Work will start	
5951 G.L.		April 15, 1978	
21A. Kind & Status Plug. Bond		21B. Drilling Contractor	
State wide		Young Drlg.	

23. PROPOSED CASING AND CEMENT PROGRAM

SIZE OF HOLE	SIZE OF CASING	WEIGHT PER FOOT	SETTING DEPTH	SACKS OF CEMENT	EST. TOP
12 1/4	8 5/8	24	200	250	Surf.
7 7/8	5 1/2	15.5	4900	425	1900

Dr1. 12 1/4 hole to 200'. Run and set 8 5/8 surf pipe as above. Install and test 10" 900 series blow out preventer prior to drlg from under surface.

Dr1 7 7/8 hole to 4900' using mud with following properties: wt. 9.0, vis. 35, w.l. 15[±].

Run open hole logs to determine if well is commercial. If so, run and cement 5 1/2" csg. as above. If noncommercial, well will be plug according to state regulations.

No abnormal pressures or temperatures or hazardous gases are expected.

Gas is dedicated.

APPROVED FOR DEED
DRILLING

EXPIRES 6-19-78

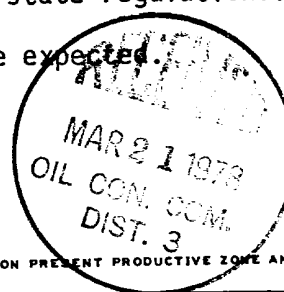

IN ABOVE SPACE DESCRIBE PROPOSED PROGRAM; IF PROPOSAL IS TO DEEPEN OR PLUG BACK, GIVE DATA ON PRESENT PRODUCTIVE ZONE AND PROPOSED NEW PRODUCTIVE ZONE. GIVE BLOWOUT PREVENTER PROGRAM, IF ANY.

I hereby certify that the information above is true and complete to the best of my knowledge and belief.

Signed John Alexander Title Agent Date March 20, 1978
(This space for State Use)

APPROVED BY AR. Lendrick TITLE SUPERVISOR DIST. 45 DATE MAR 21 1978

CONDITIONS OF APPROVAL, IF ANY:

NEW MEXICO OIL CONSERVATION COMMISSION
WELL LOCATION AND ACREAGE DEDICATION PLAT

Form C-102
Supersedes C-128
Effective 1-1-65

All distances must be from the outer boundaries of the Section.

Operator Mesa Petroleum Company			Lease State Com		Well No. 47
Unit Letter L	Section 2	Township 27N	Range 8W	County San Juan	
Actual Footage Location of Well: 1760 feet from the South line and 835 feet from the West line					
Ground Level Elev. 5951	Producing Formation Pictured Cliffs - MV	Pool South Blanco PC Blanco Mesa Verde PC Est.		Dedicated Acreage: <input checked="" type="checkbox"/> P.C. 160, MV320 Acres	

1. Outline the acreage dedicated to the subject well by colored pencil or hachure marks on the plat below.

2. If more than one lease is dedicated to the well, outline each and identify the ownership thereof (both as to working interest and royalty).

3. If more than one lease of different ownership is dedicated to the well, have the interests of all owners been consolidated by communitization, unitization, force-pooling, etc?

☐ Yes ☐ No If answer is "yes," type of consolidation _____

If answer is "no," list the owners and tract descriptions which have actually been consolidated. (Use reverse side of this form if necessary.) _____

No allowable will be assigned to the well until all interests have been consolidated (by communitization, unitization, forced-pooling, or otherwise) or until a non-standard unit, eliminating such interests, has been approved by the Commission.

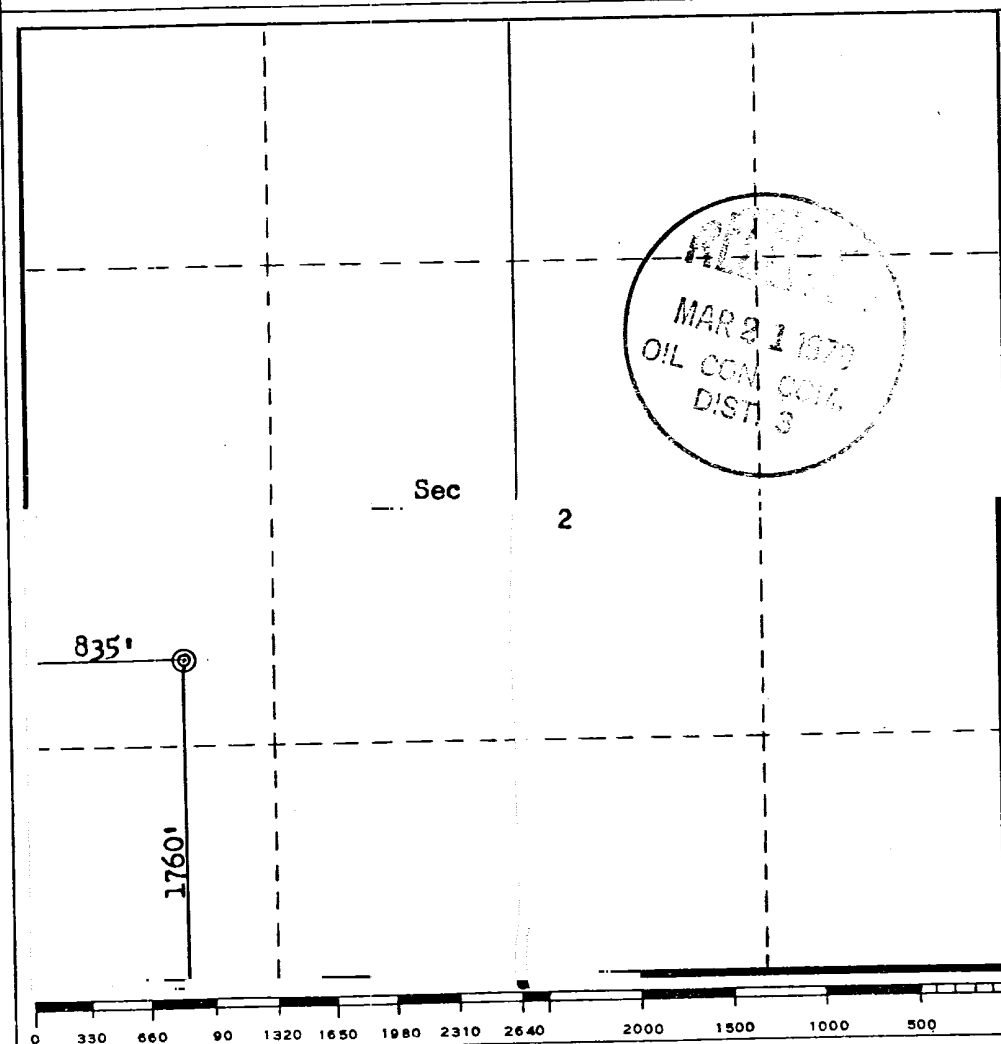

CERTIFICATION

I hereby certify that the information contained herein is true and complete to the best of my knowledge and belief.

John Alexander
Name
Agent

Position
Mesa Petroleum Company

Company
March 20, 1978

Date

I hereby certify that the well location shown on this plat was plotted from field notes of actual surveys made by me or under my supervision, and that the same is true and correct to the best of my knowledge and belief.

Date Surveyed
March 13, 1978

Registered Professional Engineer and/or Land Surveyor

Fred B. Kerr Jr.
Fred B. Kerr Jr.

Certificate No.
3950