

submitted in lieu of Form 3160-5

UNITED STATES
DEPARTMENT OF THE INTERIOR
BUREAU OF LAND MANAGEMENT

Sundry Notices and Reports on Wells

1. Type of Well
GAS

2. Name of Operator
MERIDIAN OIL

3. Address & Phone No. of Operator
PO Box 4289, Farmington, NM 87499 (505) 326-9700

4. Location of Well, Footage, Sec., T, R, M
2240'FSL, 845'FWL, Sec.6, T-26-N, R-8-W, NMPM

5. Lease Number
SF-078433
6. If Indian, All. or
Tribe Name
Navajo
7. Unit Agreement Name
8. Well Name & Number
Navajo Indian #6A
9. API Well No.
30-045-23264
10. Field and Pool
Basin Fruitland Coal
11. County and State
San Juan Co, NM

12. CHECK APPROPRIATE BOX TO INDICATE NATURE OF NOTICE, REPORT, OTHER DATA

Type of Submission

Type of Action

<input type="checkbox"/> Notice of Intent	<input type="checkbox"/> Abandonment	<input type="checkbox"/> Change of Plans
<input checked="" type="checkbox"/> Subsequent Report	<input checked="" type="checkbox"/> Recompletion	<input type="checkbox"/> New Construction
<input type="checkbox"/> Final Abandonment	<input checked="" type="checkbox"/> Plugging Back	<input type="checkbox"/> Non-Routine Fracturing
	<input type="checkbox"/> Casing Repair	<input type="checkbox"/> Water Shut off
	<input type="checkbox"/> Altering Casing	<input type="checkbox"/> Conversion to Injection
	<input type="checkbox"/> Other -	

13. Describe Proposed or Completed Operations

2-22-95 MIRU. ND WH. NU BOP. TOO H w/138 jts 2 3/8" tbg. TIH w/5 1/2" gauge ring to 4160'. RD. TIH w/5 1/2" cmt retainer, set @ 4148'. PT tbg to 3000 psi, OK. Load backside w/1% KCl wtr. PT csg to 500 psi, OK. Sqz Mesaverde perms below cmt retainer w/80 sx Class "B" cmt. Displaced w/15 bbl wtr. Pump 5 sx Class "B" cmt on top of cmt retainer. Sqz pressure 900 psi. TOO H to 4118'. Spot 50 bbl 9.5 vis mud. TOO H. Roll hole w/55 bbl 1% KCl wtr. TOO H. Ran CBL-CCL-GR @ 150-2200', TOC @ 200'. TIH w/CIBP, set @ 2000'. RD. TIH w/5 1/2" pkr, set @ 65'. PT 5 1/2" csg to 3000 psi/15 min, OK. Release pkr, TOO H. Perf Fruitland Coal @ 1782-1895' w/94 holes. RD. Prepare to frac.

2-23-95 Frac Fruitland Coal w/122,000# 20/40 Arizona sd, 435 bbl 30# linear gel, 851,000 SCF N2. SI for gel break. CO after frac.

2-24-95 Blow well & CO.

2-25-95 Blow well & CO. RU, ran after frac log @ 1500-2000'. TIH to 2000'. Blow well. Land 59 jts 2 3/8" 4.7# J-55 EUE 8RD tbg @ 1810'. ND BOP. NU WH. RD. Rig released.

14. I hereby certify that the foregoing is true and correct.

Signed [Signature] Title Regulatory Affairs Date 2/27/95

(This space for Federal or State Office use)

APPROVED BY _____ Title _____ Date _____

CONDITION OF APPROVAL, if any:

ACCEPTED FOR RECORD

MAR 02 1995

FARMINGTON DISTRICT OFFICE

2V [Signature]

submitted in lieu of Form 3160-5

UNITED STATES
DEPARTMENT OF THE INTERIOR
BUREAU OF LAND MANAGEMENT

RECEIVED
BLM

Sundry Notices and Reports on Well 070 FARMINGTON, NM JUN -6 AM 9:42

1. Type of Well
GAS

2. Name of Operator
MERIDIAN OIL

3. Address & Phone No. of Operator
PO Box 4289, Farmington, NM 87499 (505) 326-9700

4. Location of Well, Footage, Sec., T, R, M
2240' FSL, 845' FWL Sec. 6, T-26-N, R-8-W, NMPM

5. Lease Number
SF-078433

6. If Indian, All. or Tribe Name
Navajo

7. Unit Agreement Name

8. Well Name & Number
Navajo Indian #6A

9. API Well No.
30-045-

10. Field and Pool
Basin Fruitland Coal

11. County and State
San Juan Co, NM

12. CHECK APPROPRIATE BOX TO INDICATE NATURE OF NOTICE, REPORT, OTHER DATA

Type of Submission	Type of Action
<input checked="" type="checkbox"/> Notice of Intent	<input type="checkbox"/> Abandonment
<input type="checkbox"/> Subsequent Report	<input checked="" type="checkbox"/> Recompletion
<input type="checkbox"/> Final Abandonment	<input type="checkbox"/> Plugging Back
	<input type="checkbox"/> Casing Repair
	<input type="checkbox"/> Altering Casing
	<input type="checkbox"/> Other -
	<input type="checkbox"/> Change of Plans
	<input type="checkbox"/> New Construction
	<input type="checkbox"/> Non-Routine Fracturing
	<input type="checkbox"/> Water Shut off
	<input type="checkbox"/> Conversion to Injection

13. Describe Proposed or Completed Operations

It is intended to recomplete this well from the Blanco Mesa Verde to the Basin Fruitland Coal per the attached procedure.

SEE ATTACHED FOR
CONDITIONS OF APPROVAL

RECEIVED
JUN 16 1994
OIL & GAS DIV.
DIST. 3

14. I hereby certify that the foregoing is true and correct.

Signed Dan Bradfield (MP) Title Regulatory Affairs Date 6/3/94

(This space for Federal or State Office use)
APPROVED BY _____ Title _____
CONDITION OF APPROVAL, if any:

APPROVED
JUN 23 1994
J. M. [Signature]
DIST. 3

NMOCD

RECEIVED
JAN 11 1964
U.S. DEPT. OF JUSTICE

100-441111
JAN 11 1964
U.S. DEPT. OF JUSTICE

NEW MEXICO OIL CONSERVATION COMMISSION
WELL LOCATION AND ACREAGE DEDICATION PLAT

Form O-111
Superseded (1-1-61)
Effective 1-1-61

All distances must be from the outer boundaries of the Section

Operator Meridian Oil Inc.		Lease NAVAJO INDIAN BLM		Well No. 6-A
Unit Letter L	Section 6	Township 26 NORTH	Range 8 WEST	County SAN JUAN
Actual Footage Location of Well: 2240 feet from the SOUTH line and 845 feet from 070-FARMINGTON, NM line				
Ground Level Elev. 6112	Producing Formation Fruitland Coal	Pool Basin	Dedicated Acreage: 323.03	

1. Outline the acreage dedicated to the subject well by colored pencil or hatchure marks on the plat below.
2. If more than one lease is dedicated to the well, outline each and identify the ownership thereof (both as to working interest and royalty).
3. If more than one lease of different ownership is dedicated to the well, have the interests of all owners been consolidated by communitization, unitization, force-pooling, etc?

☒ Yes ☐ No If answer is "yes," type of consolidation Communitization Agreement

If answer is "no," list the owners and tract descriptions which have actually been consolidated. (Use reverse side of this form if necessary.)

No allowable will be assigned to the well until all interests have been consolidated (by communitization, unitization, forced-pooling, or otherwise) or until a non-standard unit, eliminating such interests, has been approved by the Commission.

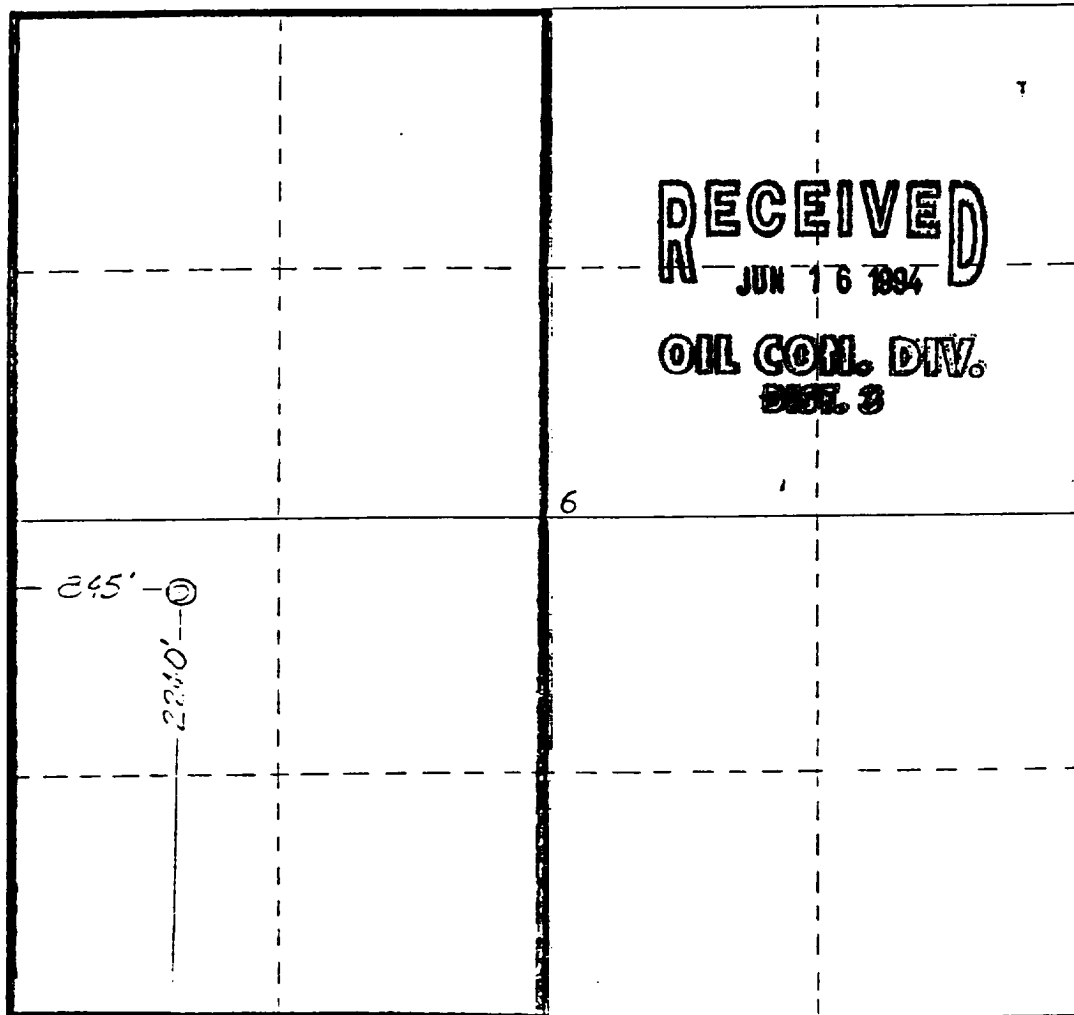

CERTIFICATION

I hereby certify that the information contained herein is true and complete to the best of my knowledge and belief.

Peggy Bradfield
Name

Peggy Bradfield

Position

Regulatory Representative

Company

Meridian Oil Inc.

Date

6-3-94

I hereby certify that the well shown on this plat was located from notes of actual survey made by me under my commission, and that the is true and correct to the best of my knowledge and belief.

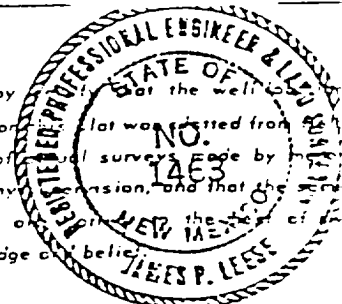

Date Surveyed

18 September 1978

Registered Professional Engineer

Land Surveyor

James P. Leese
James P. Leese

Certificate No.

1463

0 230 660 190 1320 1650 1980 2310 2640 2000 1500 1000 500 0

Navajo Indian #6A FRTC
FRTC RECOMPLETION
L 6 26 8
San Juan County, N.M.

1. Comply to all NMOCB, BLM, & MOI rules & regulations. MOL and RU completion rig. NU 6" 900 series BOP W/offset rams, flow tee and stripping head. NU blooie line and 2-7/8" relief line.
2. Set blanking plug S.N. @ 4205' in 2-3/8" tbg & pressure test tbg to 3000 psi. TOH w/138 Jts 2-3/8" tbg @ 4237'.
3. Run 5-1/2" gauge ring on sand line to 4151' (50' above top MV perf). TIH w/5-1/2" cmt ret on tested 2-3/8" tbg & set @ 4151'. Establish rate & sq MV perfs w/79 sx C1 "B" cmt. This will fill MV perfs & 5-1/2" csg to 4151' w/100% excess cmt.
4. Sting out of cmt ret & spot 4 sx cmt on top ret. Spot hole w/ 51 bbl mud: 15# sodium bentonite w/non-fermenting polymer, 8.4# gal weight, & 40 qs vis or greater. W/tbg @ 2000' roll hole w/1% KCL water. TOH.
5. Run CBL from 2200' to top of cmt & correlate to open hole density log. Set top drillable BP @ 2000' on wireline & top w/2 sx sand.
6. Run 5-1/2" pkr on 2 jts 2-3/8" tbg to protect wellhead & pressure test 5-1/2" csg to 3000# for 15 min.
7. Spot and fill 3 - 400 bbl. frac tanks with 2% KCL water. Filter all water to 25 microns. Two tanks are for gel & one tank for breakdown water. Usable gel water required for frac is 434 bbls.
8. Perf FRTC w/2 spf @ 1895'-86', 1876'-50', 1794'-82'. Total 94 holes. Perforate using 3-1/8" hollow steel carrier guns loaded w/Owen HSC 13 gm. charges phased at 180 degrees & 2 spf. Avg. perf dia. = 0.48". Average penetration is 18" in Berea.
9. TIH with 5-1/2" pkr on 2-3/8" tbg & set @ 1600'. Breakdown perfs & attempt to ball off w/2500 gal. 15% HCL acid & 235-7/8" 1.3 sp gr RCN perf balls. (1 gal/1000 corrosion inhibitor). Lower pkr to 1900' to knock off perf balls. TOH.
10. W/ 5-1/2" pkr set 2 jts into well on 2-7/8" slimhole tbg to protect wellhead, fracture treat FRTC down 5-1/2" csg with 59,000 gals. of 70 quality foam using 30# gel as the base fluid & 120,000# 20/40 Arizona sand. Pump at 45 BPM. Monitor bottomhole and surface treating pressures, rate, foam quality, & sand concentration with computer van. Sand to be tagged with 0.4 mCi/1000# Ir-192 tracer. Max. pressure is 3000 psi and estimated treating pressure is 2500 psi. Treat per the following schedule:

NAVAGO INDIAN #6A - FRTC RECOMPLETION

Page 2

<u>Stage</u>	<u>Foam Vol.</u> <u>(Gals.)</u>	<u>Gel Vol.</u> <u>(Gals.)</u>	<u>Sand Vol.</u> <u>(lbs.)</u>
Pad	15,000	4,500	----
1.0 ppg	10,000	3,000	10,000
2.0 ppg	10,000	3,000	20,000
3.0 ppg	10,000	3,000	30,000
4.0 ppg	10,000	3,000	40,000
5.0 ppg	4,000	1,200	20,000
Flush	<u>(1,700)</u>	<u>(510)</u>	
Totals	59,000	17,700	120,000#

Shut well in after frac for six hours to allow the gel to break.
Treat frac fluid with the following additives per 1000 gallons:

* 30# LGC8	(Gel)
* 3.0 gal. AQF2	(Non-ionic Surfactant)
* 1.0# GVW3	(Enzyme Breaker)
* 1.0# B-5	(Breaker)

11. Open well through choke manifold and monitor flow. Flow @ 20 bbl/hr, or less if sand is observed. Take pitot gauges when possible.
12. TIH w/notched collar on 2-3/8" tbq & C.O. to 2000'. Monitor gas and water returns and take pitot gauges when possible.
13. When wellbore is sufficiently clean, TOH and run after frac gamma-ray log from 2000'-1500'.
14. TIH with 2-3/8" tbq with standard seating nipple one joint off bottom and again cleanout to 2000'. When wellbore is sufficiently clean, land tbq at 1800'KB. Take final water and gas samples & rates.
15. Repair or replace any bad wellhead valves and connections. ND BOP and NU wellhead & tree. Rig down & release rig.

Approve: _____

J. A. Howieson

VENDORS:

Wireline:	Blue Jet	325-5584
Fracturing:	Western	327-6222
RA Tagging:	Pro-Technics	326-7133

PMP

Pertinent Data Sheet - NAVAJO INDIAN #6A MV

Location: 2240' FSL 845' FWL SEC. 6 T26N R08W, SAN JUAN COUNTY, N.M.

Field: Blanco Mesaverde

Elevation: 6126' TD: 4714'
14' KB PBTD: 4672'

Prop#: 072031300

Lease: Federal SF-078433

DP#: 51494A

GWI: 100.0%

NRI: 86.01%

Completed: 2-8-79

Initial Potential:

AOF =1314 MCF/D, Q=740 MCF/D, SICP=602 PSI

Casing Record:

Hole Size	Csq. Size	Wt. & Grade	Depth Set	Cement	Top/Cmt
12-1/4"	8-5/8"	24# K-55	226'	190 sx	Circ. Cmt
7-7/8"	5-1/2"	15.5# K-55	4709'	300 sx	3100' - CBL
		DV Tool @	2065'	500 sx	Circ 20 BBL CMT

Tubing Record: 2-3/8" 4.7# J-55 4237' 138 Jts
S.N. @ 4205'

Formation Tops:

Ojo Alamo	1040'
Kirtland	1220'
Fruitland	1340'
Pictured Cliffs	1890'
Point Lookout	4196'

Logging Record: Induction, Density, CBL

Stimulation: Perf MV w/30 holes 4201'-4500' & fraced w/60,000# sand in slk water.

Workover History: None

Production History: MV 1st delivered on 9-21-79. Cumulative=235 psi. Current Capacity= 0 MCF/D. 4-94: Swabbed well in - logged off again rapidly. Tbg=170 psi. Csg=430 psi. Bradenhead=0 psi. Line=190 psi. Well is equipped with a piston lift system - can not get piston to run.

Pipeline: EPNG

PMP

NAVAJO INDIAN #6A MV

UNIT L SECTION 6 T26N R8W
SAN JUAN COUNTY, NEW MEXICO

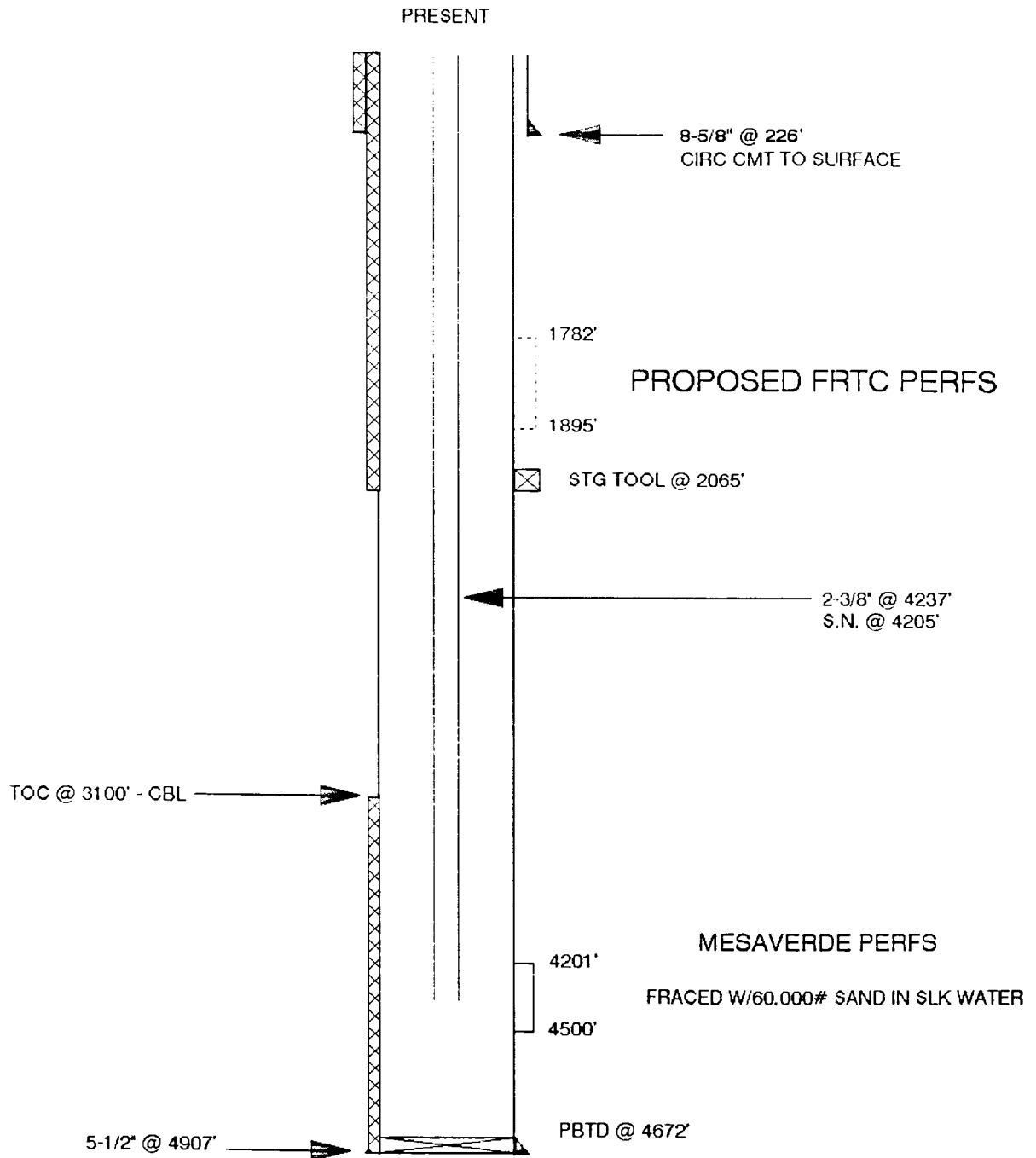

NAVAJO INDIAN #6A MV

UNIT L SECTION 6 T26N R8W
SAN JUAN COUNTY, NEW MEXICO

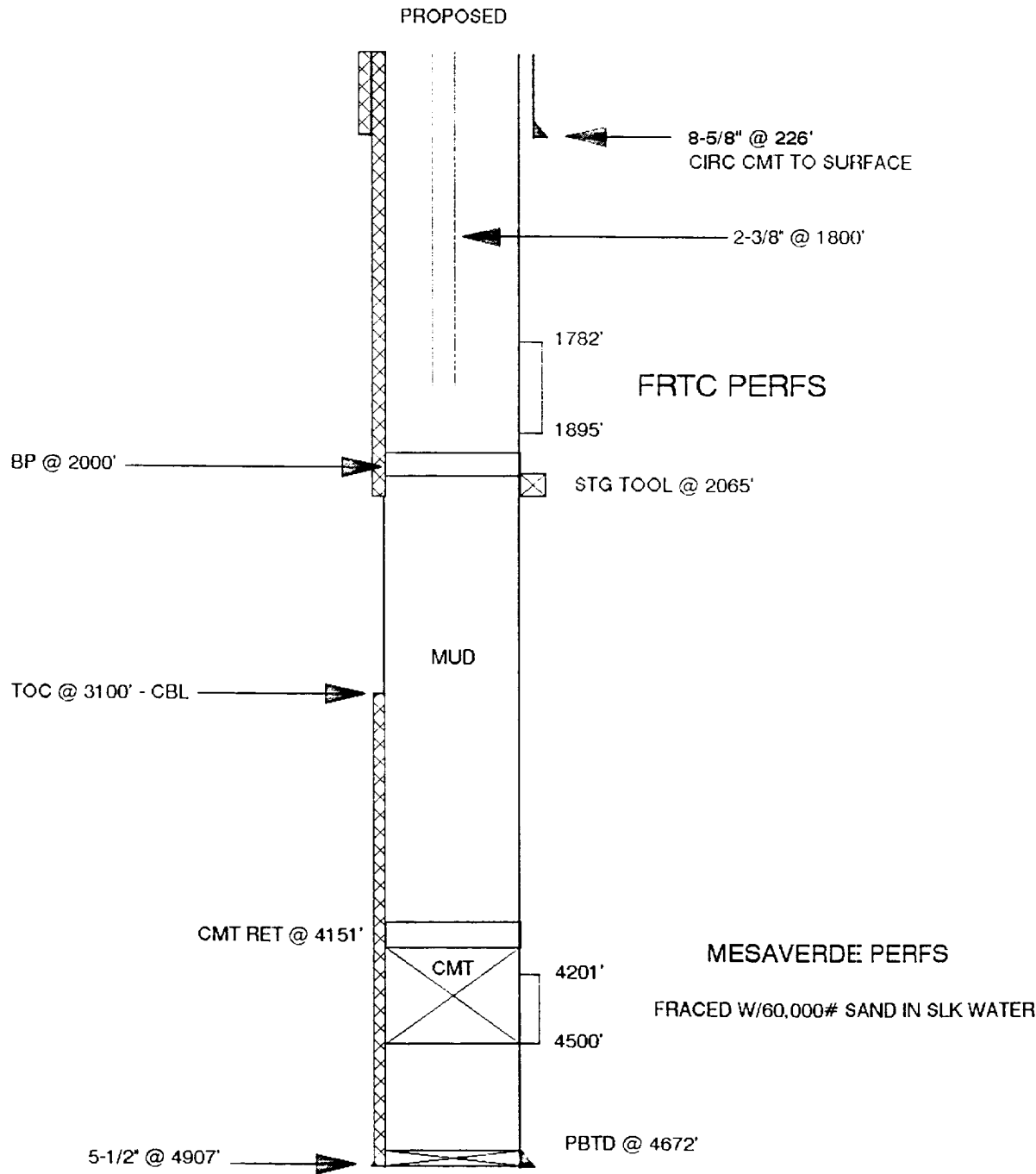

4/14/73 0

INDUC 1900

3:4

2:40

2.3

2.3

3

INDUC

1900

2:40

01800

01900

NAVJO

INDIAN

3

2015

6

23

3

DENSITY 2015

5

6

01800

4

2

2

1

5

3

10 P.C.

01900

01016

02016

02016

02016

IN REPLY REFER TO:
(07337)

UNITED STATES DEPARTMENT OF THE INTERIOR

BUREAU OF LAND MANAGEMENT
FARMINGTON DISTRICT OFFICE
1235 La Plaza Highway
Farmington, New Mexico 87401

Attachment to Notice of

Re: *Plug Back*

Well: *GA Navajo Indian*

CONDITIONS OF APPROVAL

. Mike Flaniken with the Farmington Office is to be notified at least 24 hours before the *plug Back* operations commence (505) 599-8907.

. The following modifications to your *plug back* program are to be made (when applicable):

- 1.) *Place a cement plug from 3504' to 3404' inside the casing plus 50 linear feet excess cement. (Top of Mesavide 23454')*

Office Hours: 7:45 a.m. to 4:30 p.m.