

UNITED STATES
DEPARTMENT OF THE INTERIOR
GEOLOGICAL SURVEY

APPLICATION FOR PERMIT TO DRILL, DEEPEN, OR PLUG BACK

1a. TYPE OF WORK

DRILL ☒DEEPEN ☐PLUG BACK ☐

b. TYPE OF WELL

OIL
WELL ☐GAS
WELL ☒

OTHER

SINGLE
ZONE ☒MULTIPLE
ZONE ☐

2. NAME OF OPERATOR

~~AAA Operating Company~~

3. ADDRESS OF OPERATOR

1808 Campbell Centre Dallas, Texas 75206

4. LOCATION OF WELL (Report location clearly and in accordance with any State requirements.)*

At surface

1110' FSL & 990" FEL Section 11-27N-8W

At proposed prod. zone

14. DISTANCE IN MILES AND DIRECTION FROM NEAREST TOWN OR POST OFFICE*

15 Miles South

15. DISTANCE FROM PROPOSED*

LOCATION TO NEAREST
PROPERTY OR LEASE LINE, FT.
(Also to nearest drlg. unit line, if any)

18. DISTANCE FROM PROPOSED LOCATION*

TO NEAREST WELL, DRILLING, COMPLETED,
OR APPLIED FOR, ON THIS LEASE, FT.

16. NO. OF ACRES IN LEASE

19. PROPOSED DEPTH

4000'

17. NO. OF ACRES ASSIGNED
TO THIS WELL

160

20. ROTARY OR CABLE TOOLS

Rotary

21. ELEVATIONS (Show whether DF, RT, GR, etc.)

6618' GR

22. APPROX. DATE WORK WILL START*

Immediately

23. PROPOSED CASING AND CEMENTING PROGRAM

SIZE OF HOLE	SIZE OF CASING	WEIGHT PER FOOT	SETTING DEPTH	QUANTITY OF CEMENT
12-3/4	8-5/8	24.0	150	100 sx.
6-3/4	4-1/2	9.5	4000	500 sx.

Selectively perforate and sandwater fracture the Chacra formation.

A 3000 psi WP and 6000 psi test double gate preventer equipped with
blind and pipe rams will be used for blow out prevention on this well.

This gas is dedicated.

SE/4 of Section 11 is dedicated to this well.

IN ABOVE SPACE DESCRIBE PROPOSED PROGRAM: If proposal is to deepen or plug back, give data on present productive zone and proposed new productive zone. If proposal is to drill or deepen directionally, give pertinent data on subsurface locations and measured and true vertical depths. Give blowout preventer program, if any.

24.

SIGNED

PCVg

TITLE

owner

DATE

4-6-79

(This space for Federal or State office use)

PERMIT NO.

APPROVAL DATE

APPROVED BY

TITLE

CONDITIONS OF APPROVAL, IF ANY:

ok Frank

*See Instructions On Reverse Side

YMMOCC

5. LEASE DESIGNATION AND SERIAL NO.

SF 078476

6. IF INDIAN, ALLOTTEE OR TRIBE NAME

7. UNIT AGREEMENT NAME

8. FARM OR LEASE NAME

Federal J

9. WELL NO.

10. FIELD AND POOL, OR WILDCAT

Largo Chacra

11. SEC., T., R., M., OR BLK.
AND SURVEY OR AREA

Sec. 11-27N-8W

12. COUNTY OR PARISH

San Juan

13. STATE

N.M.

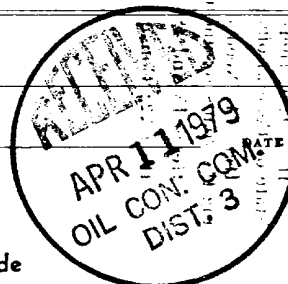
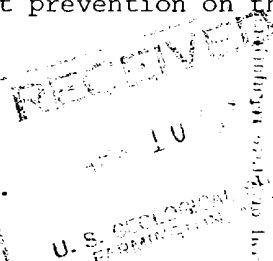

All distances must be from the outer boundaries of the Section.

Operator <i>WAAA Oil & Gas Company</i>		Lease FEDERAL "J"		Well No. <i>202</i>
Unit Letter F	Section 11	Township 27N	Range 8W	County San Juan
Actual Footage Location of Well: 1110 feet from the South line and 990 feet from the East line				
Ground Level Elev. 6518	Producing Formation Chacra	Pool <i>Largo</i>	Dedicated Acreage: 160 Acres	

1. Outline the acreage dedicated to the subject well by colored pencil or hatchure marks on the plat below.
2. If more than one lease is dedicated to the well, outline each and identify the ownership thereof (both as to working interest and royalty).
3. If more than one lease of different ownership is dedicated to the well, have the interests of all owners been consolidated by communitization, unitization, force-pooling, etc?

☐ Yes ☐ No If answer is "yes," type of consolidation _____

If answer is "no," list the owners and tract descriptions which have actually been consolidated. (Use reverse side of this form if necessary.) _____

No allowable will be assigned to the well until all interests have been consolidated (by communitization, unitization, forced-pooling, or otherwise) or until a non-standard unit, eliminating such interests, has been approved by the Commission.

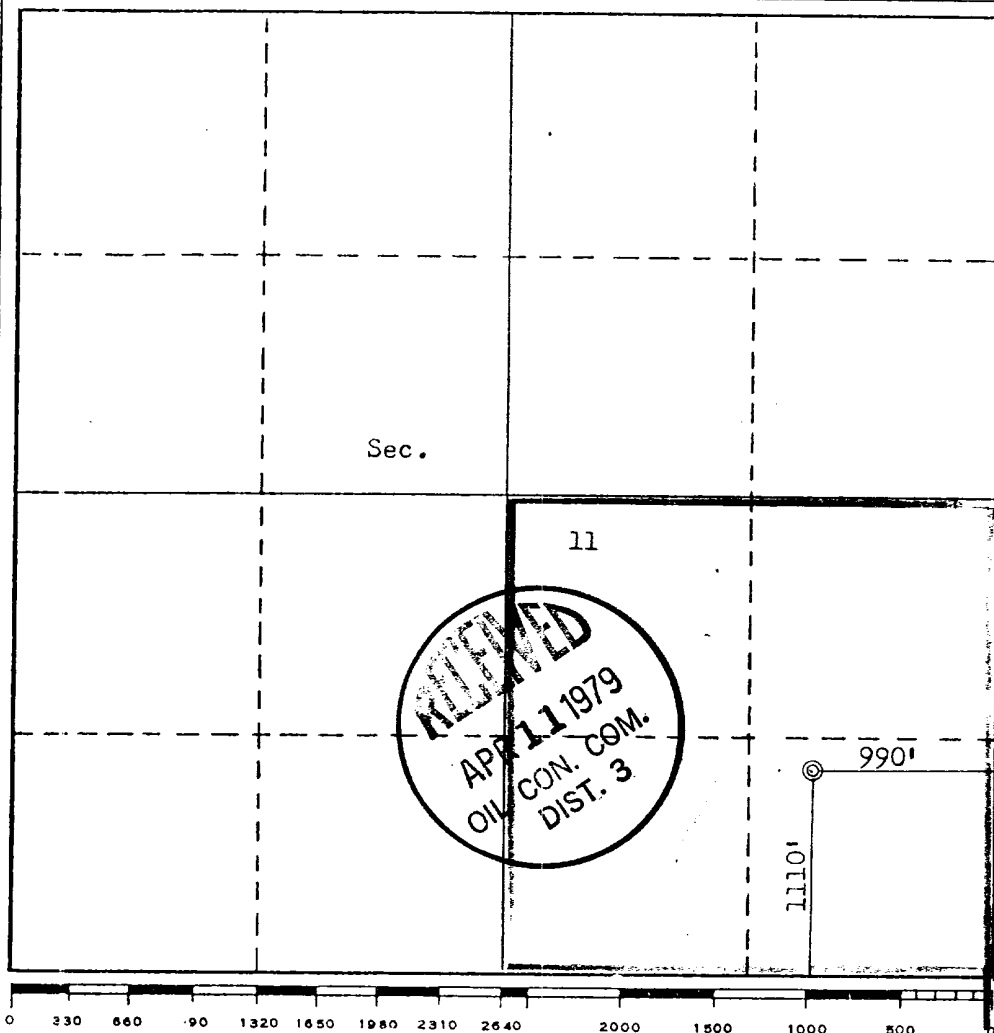

CERTIFICATION

I hereby certify that the information contained herein is true and complete to the best of my knowledge and belief.

Name

Position

Company

Date

I hereby certify that the well location shown on this plat was plotted from field notes of actual surveys made by me or under my supervision, and that the same is true and correct to the best of my knowledge and belief.

Date Surveyed

Registered Professional Engineer and/or Land Surveyor

Certification No.

3950

OPERATIONS PLAN
Federal J 1-C

I. Location:

II. Field: Largo Chacra

Elevation: 6618' GR

Geology:

A. Formation Tops:	Ojo Alamo	1020'
	Kirkland	2200'
	Picture Cliffs	2950'
	Lewis	3070'
	Chacra	3920'
	TOTAL DEPTH	4000'

B. Logging Program: IES and GR - NDL

C. Coring Program: None

D. Natural Gauges: Will record all gauges in daily drilling report.

III. Drilling:

A. Mud Program: Mud from surface to TD.

IV. Materials:

A. Casing Program:	<u>Hole Size</u>	<u>Depth</u>	<u>Casing Size</u>	<u>Weight</u>
	12-3/4"	150'	8-5/8"	23#
	6-3/4"	4000'	4-1/2"	9.5#

B. Float Equipment: 8-5/8" surface casing - Larkin guide shoe.

C. Tubing: 4000' of 1 1/4" I.J. with B & R seating nipple on bottom of string.

D. Wellhead Equipment: Casing head rector type "R" Nom 8" Body x 8-5/8" od.
Female.

V. Cementing:

8-5/8" surface casing - use 85 sx and circulate to surface.

4-1/2" production casing - use 372 sx and circulate to surface.

TYPICAL B.O.P. INSTALLATION

for Chacra Well

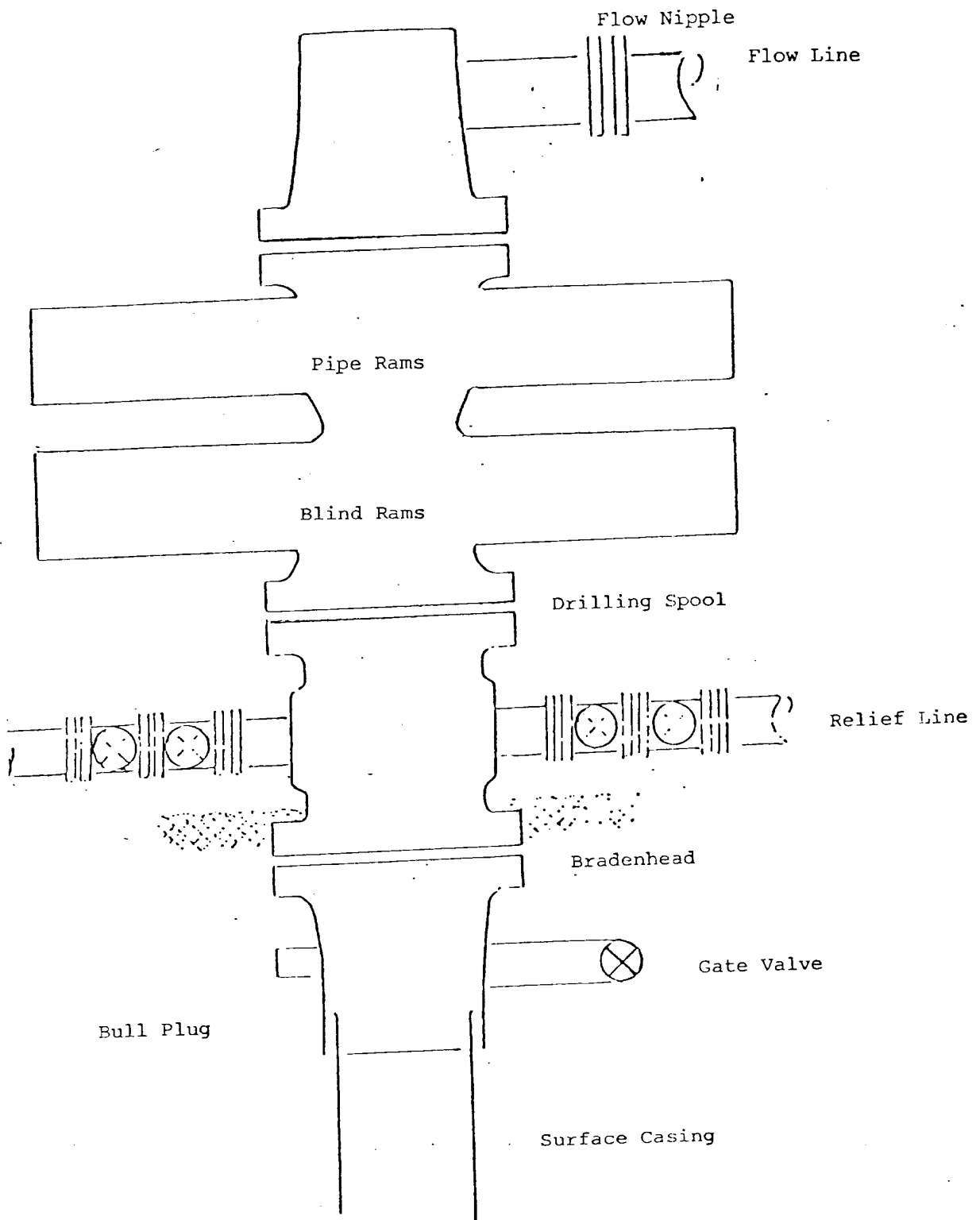

Series 900 Double Gate BOP, rated at 3000 psi Working Pressure. When gas drilling operations begin a Shaffer type 50 or equivalent rotating head is installed on top of the flow nipple and the flow line is converted into a blowie line.

Typical Location Plat for Mesaverde and Chacra wells

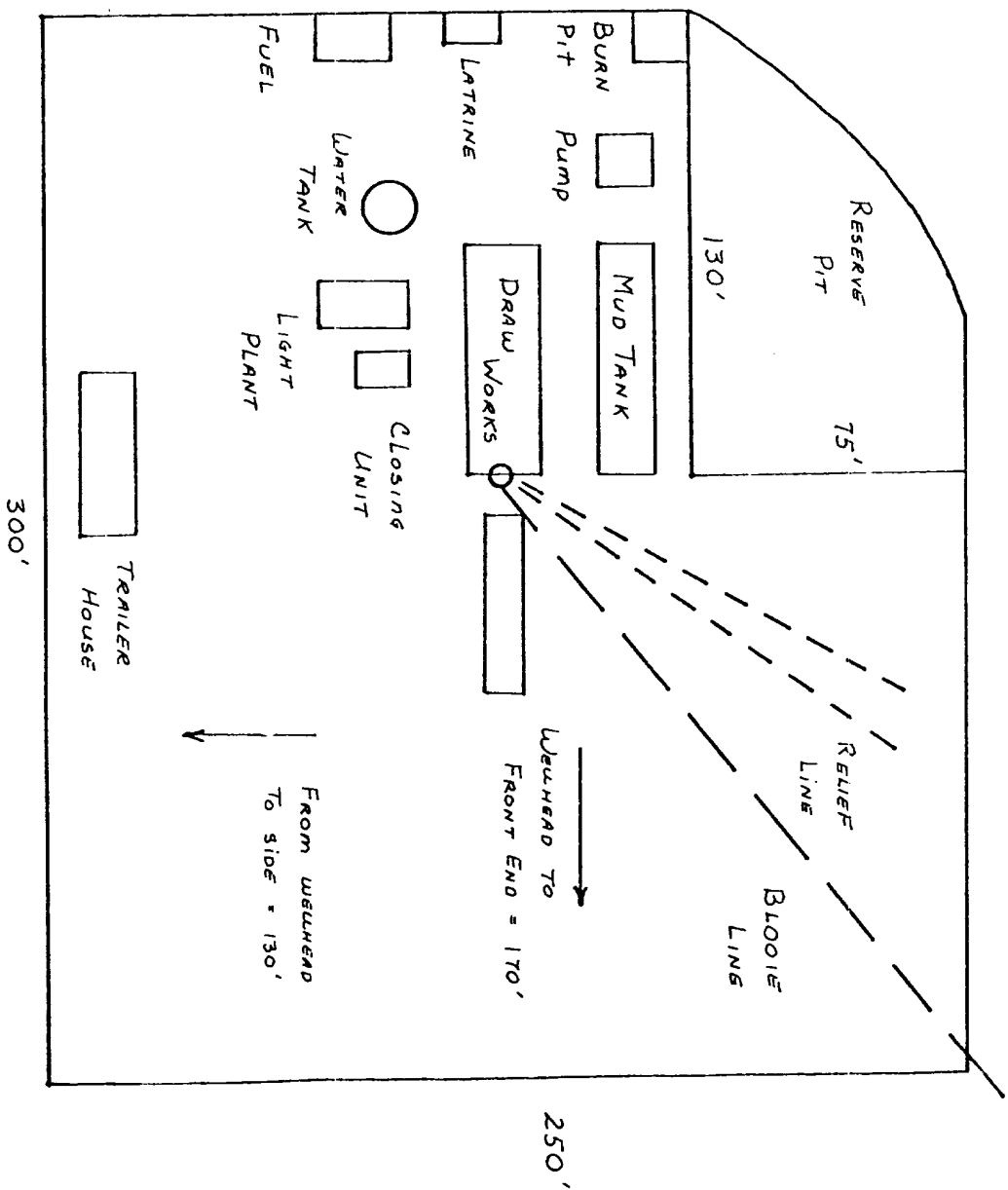

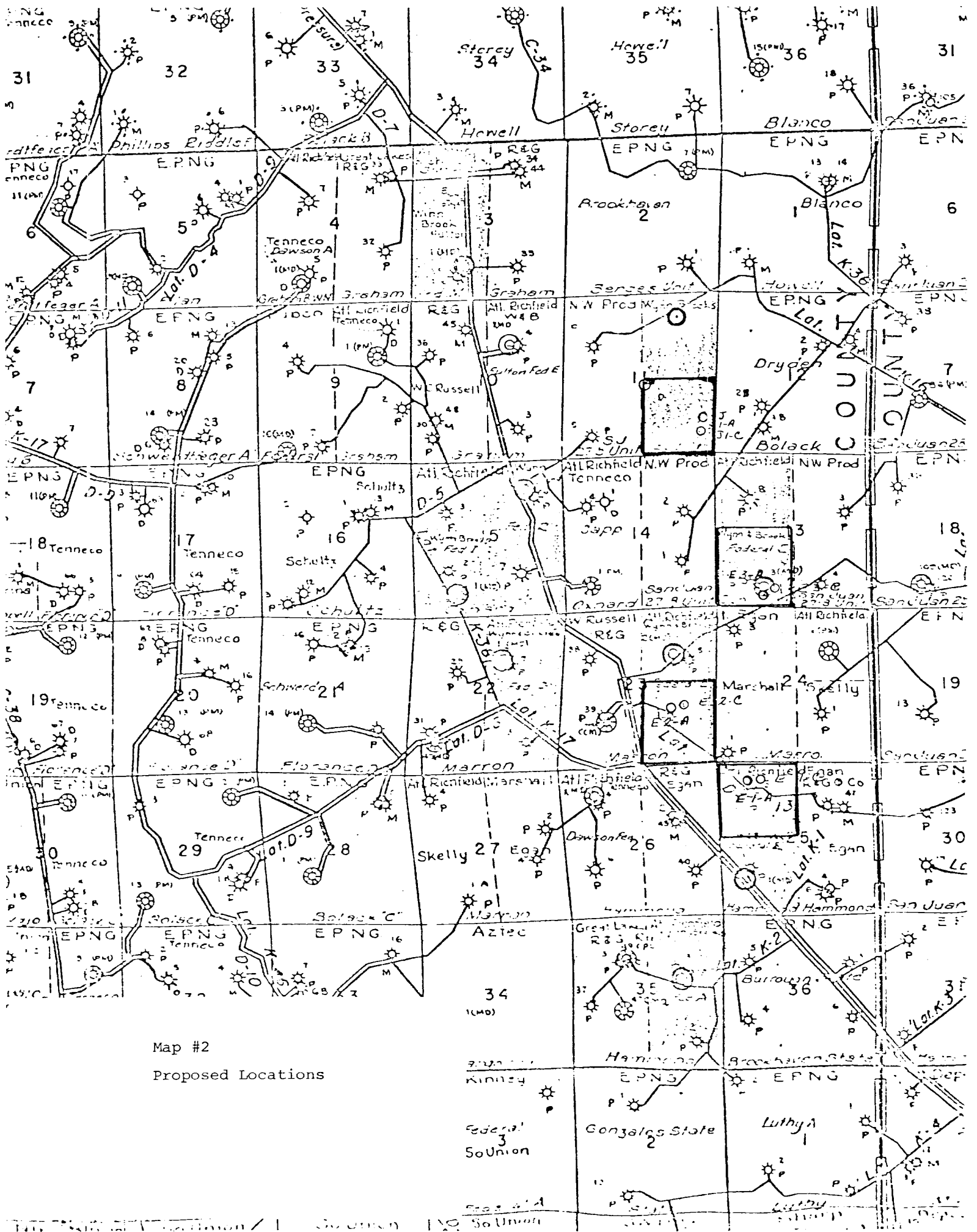

Law Offices of
R. E. Wynn

Suite 1808
Campbell Centre
Dallas, Texas 75206

Multi-Point Surface Use Plan

Federal J 1-C

1. Existing Road - Please refer to Map No. 1 which shows the existing roads. New roads which will be required have been marked on this map. All existing and new roads will be properly maintained during the duration of this project.
 2. Planned Access Roads - Please refer to Map No. 1. The grade of the access roads will be consistent with that of the local terrain. The road surface will not exceed twenty feet (20') in width. Upon completion of the project, the access road will be adequately drained to control soil erosion. Drainage facilities may include ditches, water bars, culverts or any other measure deemed necessary by trained Company personnel to insure proper drainage. Gates and/or cattleguards will be installed if necessary.
 3. Location of Existing Wells-Please refer to Map No. 2.
 4. Location of Tank Batteries, Production Facilities, and Production Gathering Service Lines - Please refer to Maps No. 1 and No. 2. Map No. 2 shows the existing gas gathering lines. Map No. 1 shows the existing roads and new proposed access roads. All known production facilities are shown on these two maps.
 5. Location and Type of Water Supply - Water for the proposed project will be obtained from a water hole located at Largo Federal Canyon Well.
 6. Source of Construction Materials - No additional materials will be required to build either the access road or the proposed location.
-

7. Methods of Handling Waste Materials - All garbage and trash materials will be put into a burn pit shown on the attached Location Plat No. 1. When clean-up operations are begun on the proposed project, the burn pit with its refuse will be buried to a depth of at least three feet (3'). A latrine, the location of which is also shown on Plat No. 1 will be provided for human waste. If large amounts of liquids are left in the reserve pit after completion of the project, the pit will be fenced until the liquids have had adequate time to dry. The location clean-up will not take place until such time as the reserve pit can be properly covered over to prevent run-off from carrying any of these materials into the watershed. No earthen pit will be located on natural drainages; all earthen pits will be so constructed as to prevent leakage from occurring.
8. Ancillary Facilities - No camps or airstrips will be associated with this project.
9. Wellsite Layout - Please refer to the attached Plat No. 1.
10. Plans for Restoration of the Surface - After completion of the proposed project, the location will be cleaned and leveled. The location will be left in such a condition that will enable reseeding operations to be carried out. Seed Mixture #2 will be used. The reseeding operation will be performed during the time period set forth by the regulatory body. The location production equipment will be painted green (Federal Standard #595-34127).
11. Other Information - The terrain is high mesa overlooking Largo Canyon flat plateau surface with mostly grass cover. No wildlife seen on site.
-

12. Operator's Representative - R. C. Wynn, 1808 Campbell Centre,
Dallas, Texas 75206

13. Certification -

I hereby certify that I, or persons under my direct supervision, have inspected the proposed drillsite and access route; that I am familiar with the conditions which presently exist; that the statements made in this plan are, to the best of my knowledge, true and correct; and, that the work associated with the operations proposed herein will be performed by R. C. Wynn and his contractors and sub-contractors in conformity with this plan and the terms and conditions under which it is approved.

April 6, 1979

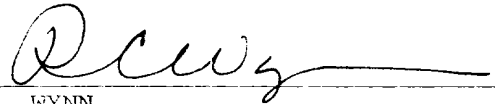
A handwritten signature in cursive script, appearing to read 'RCW', followed by a horizontal line extending to the right.

R. C. WYNN

RCW/pw

UNITED STATES
DEPARTMENT OF THE INTERIOR
GEOLOGICAL SURVEY

SUBMIT IN TRIPPLICATE*
(Other instructions on re-
verse side)

Form approved.
Budget Bureau No. 42-R1424.

SUNDRY NOTICES AND REPORTS ON WELLS

(Do not use this form for proposals to drill or to deepen or plug back to a different reservoir.
Use "APPLICATION FOR PERMIT—" for such proposals.)

1. OIL WELL <input type="checkbox"/> GAS WELL <input checked="" type="checkbox"/> OTHER	5. LEASE DESIGNATION AND SERIAL NO. SF. 078476
2. NAME OF OPERATOR AAA Operating Company, Inc.	6. IF INDIAN, ALLOTTEE OR TRIBE NAME
3. ADDRESS OF OPERATOR 1808 Campbell Centre, Dallas, Texas 75206	7. UNIT AGREEMENT NAME
4. LOCATION OF WELL (Report location clearly and in accordance with any State requirements.* See also space 17 below.) At surface 1110' FSL and 990' FEL	8. FARM OR LEASE NAME Federal J
14. PERMIT NO.	9. WELL NO. 2
15. ELEVATIONS (Show whether DF, RT, GR, etc.) 6618 GR	10. FIELD AND POOL, OR WILDCAT Largo Chacra
	11. SEC., T., R., M., OR BLK. AND SURVEY OR AREA Section 11-27N-8W
	12. COUNTY OR PARISH San Juan
	13. STATE New Mexico

16. Check Appropriate Box To Indicate Nature of Notice, Report, or Other Data

NOTICE OF INTENTION TO:

TEST WATER SHUT-OFF <input type="checkbox"/>	PULL OR ALTER CASING <input type="checkbox"/>
FRACTURE TREAT <input type="checkbox"/>	MULTIPLE COMPLETE <input type="checkbox"/>
SHOOT OR ACIDIZE <input type="checkbox"/>	ABANDON* <input type="checkbox"/>
REPAIR WELL <input type="checkbox"/>	CHANGE PLANS <input type="checkbox"/>
(Other) Operator & Name Change	<input checked="" type="checkbox"/>

SUBSEQUENT REPORT OF:

WATER SHUT-OFF <input type="checkbox"/>	REPAIRING WELL <input type="checkbox"/>
FRACTURE TREATMENT <input type="checkbox"/>	ALTERING CASING <input type="checkbox"/>
SHOOTING OR ACIDIZING <input type="checkbox"/>	ABANDONMENT* <input type="checkbox"/>
(Other) <input type="checkbox"/>	

(NOTE: Report results of multiple completion on Well Completion or Recompletion Report and Log form.)

17. DESCRIBE PROPOSED OR COMPLETED OPERATIONS (Clearly state all pertinent details, and give pertinent dates, including estimated date of starting any proposed work. If well is directionally drilled, give subsurface locations and measured and true vertical depths for all markers and zones pertinent to this work.)*

Change Operator from R. C. Wynn
to AAA Operating Company, Inc.

Change well name from: Federal J 1-C
to Federal J 2



18. I hereby certify that the foregoing is true and correct

SIGNED

TITLE

President

DATE

4-13-79

(This space for Federal or State office use)

APPROVED BY

TITLE

DATE

CONDITIONS OF APPROVAL, IF ANY:

Wynn

*See Instructions on Reverse Side