

UNITED STATES  
DEPARTMENT OF THE INTERIOR  
GEOLOGICAL SURVEY

## APPLICATION FOR PERMIT TO DRILL, DEEPEN, OR PLUG BACK

## 1a. TYPE OF WORK

DRILL ☒DEEPEN ☐PLUG BACK ☐

## b. TYPE OF WELL

OIL  
WELL ☐GAS  
WELL ☒

OTHER

SINGLE  
ZONE ☐MULTIPLE  
ZONE ☐

## 2. NAME OF OPERATOR

Jerome P. McHugh

## 3. ADDRESS OF OPERATOR

Box 234, Farmington, NM 87401

## 4. LOCATION OF WELL (Report location clearly and in accordance with any State requirements.)\*

At surface

1450' FNL - 1850' FEL

At proposed prod. zone

## 14. DISTANCE IN MILES AND DIRECTION FROM NEAREST TOWN OR POST OFFICE\*

20 miles south of Farmington, NM

## 15. DISTANCE FROM PROPOSED\*

LOCATION TO NEAREST  
PROPERTY OR LEASE LINE, FT.  
(Also to nearest drlg. unit line, if any)

1450'

## 18. DISTANCE FROM PROPOSED LOCATION\*

TO NEAREST WELL, DRILLING, COMPLETED,  
OR APPLIED FOR, ON THIS LEASE, FT.

1050'

## 16. NO. OF ACRES IN LEASE

640

## 19. PROPOSED DEPTH

1250'

17. NO. OF ACRES ASSIGNED  
TO THIS WELL

160

## 20. ROTARY OR CABLE TOOLS

Rotary

## 21. ELEVATIONS (Show whether DF, RT, GR, etc.)

6018' GR

## 22. APPROX. DATE WORK WILL START\*

5-30-79

## 23. PROPOSED CASING AND CEMENTING PROGRAM

SIZE OF HOLE	SIZE OF CASING	WEIGHT PER FOOT	SETTING DEPTH	QUANTITY OF CEMENT
7-7/8"	5-1/2"	14#	30'	10 sx
4-3/4"	2-7/8"	6.4#	1250'	100 sx

Plan to drill 4-3/4" hole with minimum mud to 1250' to test Pictured Cliffs formation.  
If productive, plan to set 2-7/8" tbg for csg, selectively perforate, frac, cleanout  
after frac, run 1-1/4" tbg and complete well.

Do not plan to have blowout preventer on well while drilling.  
Will install master valve and stripper head while completing.

*gas is detected*

IN ABOVE SPACE DESCRIBE PROPOSED PROGRAM: If proposal is to deepen or plug back, give data on present productive zone and proposed new productive zone. If proposal is to drill or deepen directionally, give pertinent data on subsurface locations and measured and true vertical depths. Give blowout preventer program, if any.

## 24.

SIGNED

*Richard Tully*  
Richard Tully

TITLE Agent

DATE 5-4-79

(This space for Federal or State office use)

PERMIT NO.

APPROVAL DATE

APPROVED BY

TITLE

DATE

CONDITIONS OF APPROVAL, IF ANY:

*ok Brook*

\*See Instructions On Reverse Side

*NMOCE*

30-096-23566

5. LEASE DESIGNATION AND SERIAL NO.

NM 12028

6. IF INDIAN, ALLOTTEE OR TRIBE NAME

7. UNIT AGREEMENT NAME

8. FARM OR LEASE NAME

Chaco Plant

9. WELL NO.

3A

10. FIELD AND POOL OR WILDCAT

WAW-F  
NPP - PC Wildcat11. SEC., T., R., M., OR BLK.  
AND SURVEY OR AREA

Sec 20 T26N R12W

12. COUNTY OR PARISH

San Juan

13. STATE

NM

**NEW MEXICO OIL CONSERVATION COMMISSION  
WELL LOCATION AND ACREAGE DEDICATION PLAT**

Form C-102  
Supersedes C-128  
Effective 1-1-65

All distances must be from the outer boundaries of the Section.

Operator <b>Jerome P. McHugh</b>			Lease <b>Chaco Plant</b>		Well No. <b>3A</b>
Unit Letter <b>G</b>	Section <b>20</b>	Township <b>26 North</b>	Range <b>12 West</b>	County <b>San Juan</b>	
Actual Footage Location of Well: <div style="display: flex; justify-content: space-between;"> <span><b>1450</b> feet from the <b>North</b> line and</span> <span><b>1850</b> feet from the <b>East</b> line</span> </div>					
Ground Level Elev. <b>6018</b>	Producing Formation <b>Pictured Cliffs</b>	Pool <b>WAW - FF - PC</b>		Dedicated Acreage: <input checked="" type="checkbox"/> <b>160</b> Acres	

1. Outline the acreage dedicated to the subject well by colored pencil or hachure marks on the plat below.
2. If more than one lease is dedicated to the well, outline each and identify the ownership thereof (both as to working interest and royalty).
3. If more than one lease of different ownership is dedicated to the well, have the interests of all owners been consolidated by communitization, unitization, force-pooling, etc?

☐ Yes    ☐ No    If answer is "yes," type of consolidation \_\_\_\_\_

If answer is "no," list the owners and tract descriptions which have actually been consolidated. (Use reverse side of this form if necessary.) \_\_\_\_\_

No allowable will be assigned to the well until all interests have been consolidated (by communitization, unitization, forced-pooling, or otherwise) or until a non-standard unit, eliminating such interests, has been approved by the Commission.

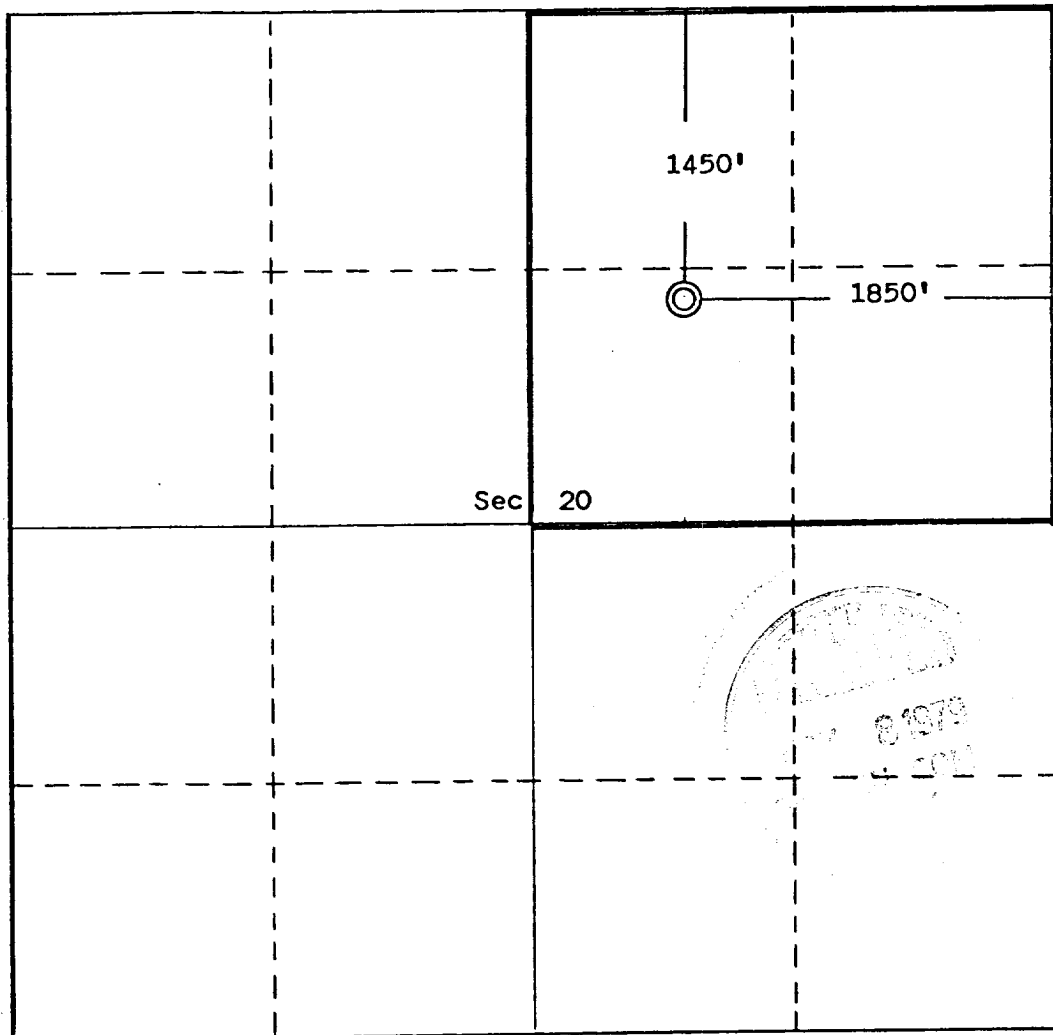

**CERTIFICATION**

I hereby certify that the information contained herein is true and complete to the best of my knowledge and belief.

*Richard Tully*

Name

**Richard Tully**

Position

**Agent**

Company

**Jerome P. McHugh**

Date

**5-4-79**

I hereby certify that the well location shown on this plat was plotted from field notes of actual surveys made by me or under my supervision, and that the same is true and correct to the best of my knowledge and belief.

Date Surveyed

**April 30, 1979**

Registered Professional Engineer  
and/or Land Surveyor

*Edgar L. Risenhoover*

Certificate No. **5979**

**Edgar L. Risenhoover, L.S.**

