

UNITED STATES
DEPARTMENT OF THE INTERIOR
GEOLOGICAL SURVEY

30-045-23544

APPLICATION FOR PERMIT TO DRILL, DEEPEN, OR PLUG BACK

1a. TYPE OF WORK

DRILL ☒

DEEPEN ☐

PLUG BACK ☐

b. TYPE OF WELL

OIL
WELL ☐

GAS
WELL ☒

OTHER

SINGLE
ZONE ☐

MULTIPLE
ZONE ☐

2. NAME OF OPERATOR

Jerome P. McHugh

3. ADDRESS OF OPERATOR

Box 234, Farmington, NM 87401

4. LOCATION OF WELL (Report location clearly and in accordance with any State requirements.)*

At surface

1450' FSL - 1450' FWL

At proposed prod. zone

14. DISTANCE IN MILES AND DIRECTION FROM NEAREST TOWN OR POST OFFICE*

23 miles south of Farmington

15. DISTANCE FROM PROPOSED*

LOCATION TO NEAREST

PROPERTY OR LEASE LINE, FT.

(Also to nearest drlg. unit line, if any) 1450'

18. DISTANCE FROM PROPOSED LOCATION*

TO NEAREST WELL, DRILLING, COMPLETED,

OR APPLIED FOR, ON THIS LEASE, FT.

3/4 mi.

16. NO. OF ACRES IN LEASE

1760

17. NO. OF ACRES ASSIGNED

TO THIS WELL

160

19. PROPOSED DEPTH

1350'

20. ROTARY OR CABLE TOOLS

Rotary

21. ELEVATIONS (Show whether DF, RT, GR, etc.)

6283' GR

22. APPROX. DATE WORK WILL START*

5-25-79

23.

PROPOSED CASING AND CEMENTING PROGRAM

SIZE OF HOLE	SIZE OF CASING	WEIGHT PER FOOT	SETTING DEPTH	QUANTITY OF CEMENT
7-7/8"	5-1/2"	14#	30'	10 sx
4-3/4"	2-7/8"	6.4#	1350'	100 sx

Plan to drill well using mud as circulating medium to test Pictured Cliffs formation. If productive, plan to set 2-7/8" tbg for csg, selectively perforate frac, clean out after frac, run 1-1/4" tbg and complete well.

Do not plan to use a blowout preventer while drilling. Will use master valve and stripper head while completing.

NMERB: Gas not dedicated.

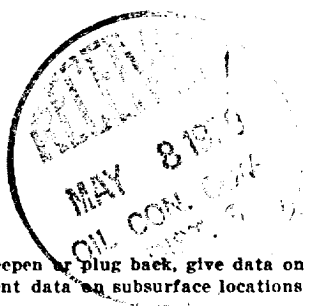

IN ABOVE SPACE DESCRIBE PROPOSED PROGRAM: If proposal is to deepen or plug back, give data on present productive zone and proposed new productive zone. If proposal is to drill or deepen directionally, give pertinent data on subsurface locations and measured and true vertical depths. Give blowout preventer program, if any.

24.

SIGNED

Richard Tully

TITLE

Agent

DATE

5-4-79

(This space for Federal or State office use)

PERMIT NO.

APPROVAL DATE

APPROVED BY

TITLE

DATE

CONDITIONS OF APPROVAL, IF ANY:

Oked

*See Instructions On Reverse Side

NMCC

**NEW MEXICO OIL CONSERVATION COMMISSION
WELL LOCATION AND ACREAGE DEDICATION PLAT**

Form C-102
Supersedes C-128
Effective 1-1-65

All distances must be from the outer boundaries of the Section.

Operator Jerome P. McHugh			Lease Chaco Plant		Well No. #25R
Unit Letter K	Section 36	Township 26 North	Range 12 West	County San Juan	
Actual Footage Location of Well: 1450 feet from the South line and 1450 feet from the West line					
Ground Level Elev. 6283	Producing Formation PC	Pool Waw - FF - PC		Dedicated Acreage: 160 Acres	

1. Outline the acreage dedicated to the subject well by colored pencil or hatchure marks on the plat below.
2. If more than one lease is dedicated to the well, outline each and identify the ownership thereof (both as to working interest and royalty).
3. If more than one lease of different ownership is dedicated to the well, have the interests of all owners been consolidated by communitization, unitization, force-pooling, etc?

☐ Yes ☐ No If answer is "yes," type of consolidation _____

If answer is "no," list the owners and tract descriptions which have actually been consolidated. (Use reverse side of this form if necessary.) _____

No allowable will be assigned to the well until all interests have been consolidated (by communitization, unitization, forced-pooling, or otherwise) or until a non-standard unit, eliminating such interests, has been approved by the Commission.

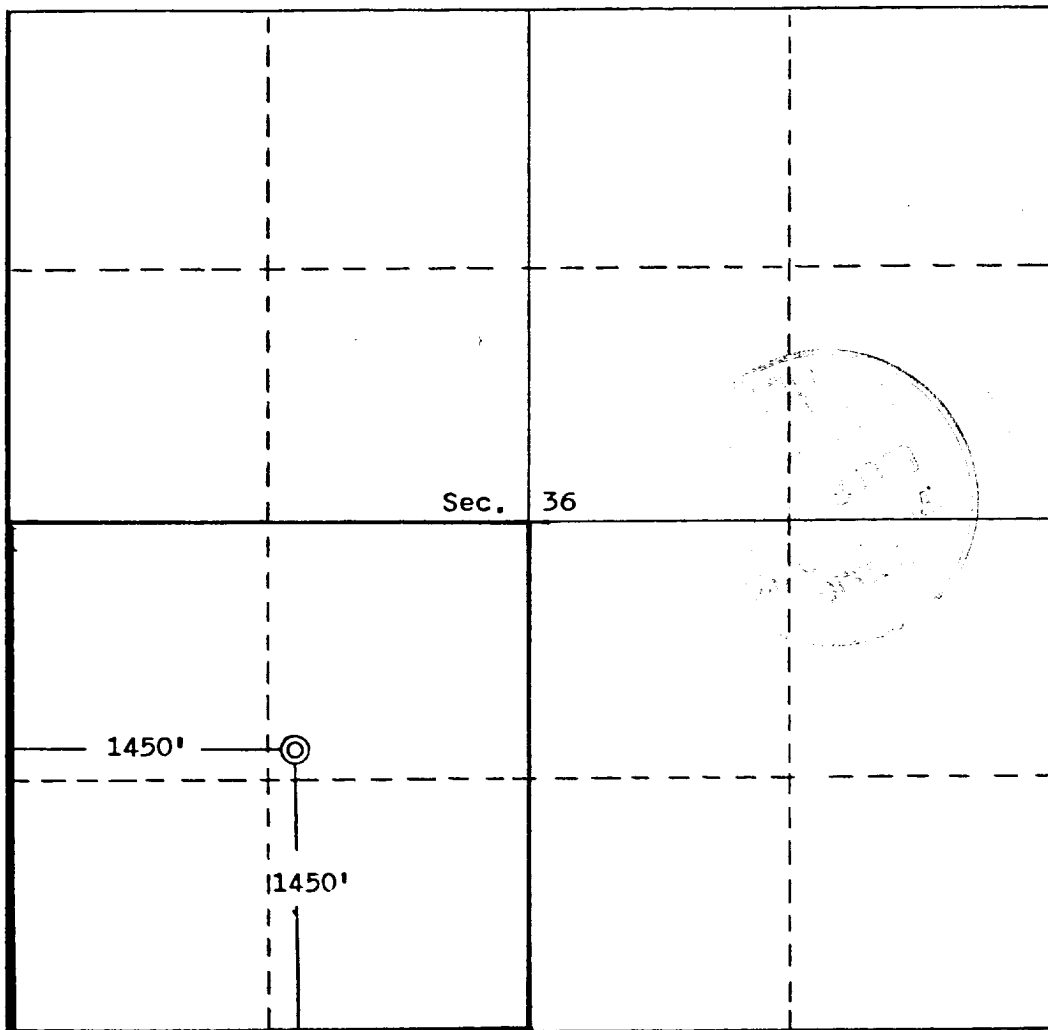

CERTIFICATION

I hereby certify that the information contained herein is true and complete to the best of my knowledge and belief.

Richard Tully

Name
Richard Tully

Position
Agent

Company
Jerome P. McHugh

Date
5-4-79

I hereby certify that the well location shown on this plat was plotted from field notes of actual surveys made by me or under my supervision, and that the same is true and correct to the best of my knowledge and belief.

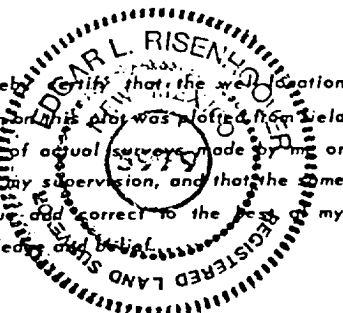

Date Surveyed
April 18, 1979

Registered Professional Engineer and/or Land Surveyor
Edgar L. Risenhoover

Certificate No. **5979**
Edgar L. Risenhoover, L.S.

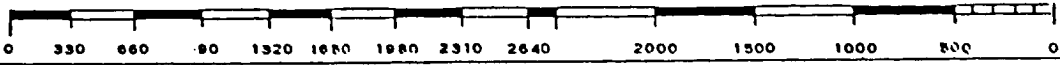

UNITED STATES
DEPARTMENT OF THE INTERIOR
GEOLOGICAL SURVEY

SUNDRY NOTICES AND REPORTS ON WELLS

(Do not use this form for proposals to drill or to deepen or plug back to a different reservoir. Use Form 9-331-C for such proposals.)

1. oil ☐ well gas ☒ well other ☐
2. NAME OF OPERATOR
Dugan Production Corp.
3. ADDRESS OF OPERATOR
Box 234, Farmington, NM 87401
4. LOCATION OF WELL (REPORT LOCATION CLEARLY. See space 17 below.)
AT SURFACE: 1450' FSL - 1450' FWL
AT TOP PROD. INTERVAL:
AT TOTAL DEPTH:
16. CHECK APPROPRIATE BOX TO INDICATE NATURE OF NOTICE, REPORT, OR OTHER DATA

REQUEST FOR APPROVAL TO: SUBSEQUENT REPORT OF:

TEST WATER SHUT-OFF	<input type="checkbox"/>	<input type="checkbox"/>
FRACTURE TREAT	<input type="checkbox"/>	<input type="checkbox"/>
SHOOT OR ACIDIZE	<input type="checkbox"/>	<input type="checkbox"/>
REPAIR WELL	<input type="checkbox"/>	<input type="checkbox"/>
PULL OR ALTER CASING	<input type="checkbox"/>	<input type="checkbox"/>
MULTIPLE COMPLETE	<input type="checkbox"/>	<input type="checkbox"/>
CHANGE ZONES	<input type="checkbox"/>	<input type="checkbox"/>
ABANDON*	<input type="checkbox"/>	<input type="checkbox"/>
(other) change name	<input type="checkbox"/>	<input type="checkbox"/>

17. DESCRIBE PROPOSED OR COMPLETED OPERATIONS (Clearly state all pertinent details, and give pertinent dates, including estimated date of starting any proposed work. If well is directionally drilled, give subsurface locations and measured and true vertical depths for all markers and zones pertinent to this work.)*

CHANGE NAME OF WELL

FROM: Chaco Plant #25R

TO: Chaco Plant #37

5. LEASE	NM 61
6. IF INDIAN, ALLOTTEE OR TRIBE NAME	
7. UNIT AGREEMENT NAME	
8. FARM OR LEASE NAME	Chaco Plant
9. WELL NO.	#37
10. FIELD OR WILDCAT NAME	Wildcat WAW Ft-Pc ext
11. SEC., T., R., M., OR BLK. AND SURVEY OR AREA	Sec 36 T26N R12W
12. COUNTY OR PARISH	San Juan
13. STATE	NM
14. API NO.	
15. ELEVATIONS, (SHOW DF, KDB, AND WD)	6283' GR

(NOTE: Report results of multiple completion or zone change on Form 9-330.)

Subsurface Safety Valve: Manu. and Type

Set @

18. I hereby certify that the foregoing is true and correct

SIGNED Thomas A. Dugan TITLE Agent DATE 5-11-79

(This space for Federal or State office use)

APPROVED BY _____ TITLE _____ DATE _____
CONDITIONS OF APPROVAL, IF ANY:

*See Instructions on Reverse Side

444000



UNITED STATES
DEPARTMENT OF THE INTERIOR
GEOLOGICAL SURVEY

SUNDRY NOTICES AND REPORTS ON WELLS

(Do not use this form for proposals to drill or to deepen or plug back to a different reservoir. Use Form 9-331-C for such proposals.)

1. oil well ☐ gas well ☒ other

2. NAME OF OPERATOR
Jerome P. McHugh

3. ADDRESS OF OPERATOR
Box 208, Farmington, NM 87401

4. LOCATION OF WELL (REPORT LOCATION CLEARLY. See space 17 below.)
AT SURFACE: 1450' FSL - 1450' FWL
AT TOP PROD. INTERVAL:
AT TOTAL DEPTH:

16. CHECK APPROPRIATE BOX TO INDICATE NATURE OF NOTICE, REPORT, OR OTHER DATA

REQUEST FOR APPROVAL TO:	SUBSEQUENT REPORT OF:
TEST WATER SHUT-OFF <input type="checkbox"/>	<input type="checkbox"/>
FRACTURE TREAT <input type="checkbox"/>	<input type="checkbox"/>
SHOOT OR ACIDIZE <input type="checkbox"/>	<input type="checkbox"/>
REPAIR WELL <input type="checkbox"/>	<input type="checkbox"/>
PULL OR ALTER CASING <input type="checkbox"/>	<input type="checkbox"/>
MULTIPLE COMPLETE <input type="checkbox"/>	<input type="checkbox"/>
CHANGE ZONES <input type="checkbox"/>	<input type="checkbox"/>
ABANDON* <input type="checkbox"/>	<input type="checkbox"/>
(other) <u>spud, surface csg, csg</u>	

5. LEASE
NM 61

6. IF INDIAN, ALLOTTEE OR TRIBE NAME

7. UNIT AGREEMENT NAME

8. FARM OR LEASE NAME
Chaco Plant

9. WELL NO.
37

10. FIELD OR WILDCAT NAME
WAW Fruitland PC

11. SEC., T., R., M., OR BLK. AND SURVEY OR AREA
Sec 36. T26N R12W

12. COUNTY OR PARISH
San Juan

13. STATE
NM

14. API NO.

15. ELEVATIONS (SHOW DF, KDB, AND WD)
6283' GR

(NOTE: Report results of multiple completion or zone change on Form 9-330.)

17. DESCRIBE PROPOSED OR COMPLETED OPERATIONS (Clearly state all pertinent details, and give pertinent dates, including estimated date of starting any proposed work. If well is directionally drilled, give subsurface locations and measured and true vertical depths for all markers and zones pertinent to this work.)

Moved in and rigged up Morrow Drlg Co. Spudded 8-3/4" hole @ 11:30 a.m. Drlg to 37'. Ran 1 jt 7" OD 26# K-55 LT&C csg. TE 36.58' set @ 37' GR. Cemented to surface w/7 sx. Job complete 1:30 p.m. 8-7-79.

Rigged up csg tools. Ran 45 jts 2-7/8" OD 6.4# CW-55 10R NEUE tbg for csg. TE 1369.31' set @ 1369' GR. Had good circulation and reciprocated pipe while cementing. Preflushed hole w/100 gals CW-7 mud wash. Cemented w/50 sx 65-35 poz w/12% gel w/1/4# cello flake per sx followed by 50 sx neat w/4% gel w/1/4# cello flake per sx. Total slurry 207 cu ft. Circulated 3 bbls cement to surface. Bumped plug w/1500 psi. Released to 750 psi. Shut in. POB 12:10 p.m. 8-11-79.

Subsurface Safety Valve: Manu. and Type _____ Set @ _____ Ft.

18. I hereby certify that the foregoing is true and correct

SIGNED Jim L. Jacobs TITLE Agent DATE 8-13-79

(This space for Federal or State office use)

APPROVED BY _____ TITLE _____ DATE _____

CONDITIONS OF APPROVAL, IF ANY: