

UNITED STATES  
DEPARTMENT OF THE INTERIOR  
GEOLOGICAL SURVEY

## APPLICATION FOR PERMIT TO DRILL, DEEPEN, OR PLUG BACK

## 1a. TYPE OF WORK

DRILL ☒DEEPEN ☐PLUG BACK ☐

## b. TYPE OF WELL

OIL  
WELL ☐GAS  
WELL ☒

OTHER

SINGLE  
ZONE ☐MULTIPLE  
ZONE ☒

## 2. NAME OF OPERATOR

J. Gregory Merriam &amp; Robert L. Bayless

## 3. ADDRESS OF OPERATOR

P.O. Box 1541, Farmington, New Mexico 87401

## 4. LOCATION OF WELL (Report location clearly and in accordance with any State requirements.)\*

At surface 790' FNL &amp; 1850' FEL

At proposed prod. zone 790' FNL &amp; 1850' FEL

## 14. DISTANCE IN MILES AND DIRECTION FROM NEAREST TOWN OR POST OFFICE\*

20 Miles South of Farmington

## 15. DISTANCE FROM PROPOSED\*

LOCATION TO NEAREST

PROPERTY OR LEASE LINE, FT.

(Also to nearest drlg. unit line, if any)

790 ft.

## 18. DISTANCE FROM PROPOSED LOCATION\*

TO NEAREST WELL, DRILLING, COMPLETED,  
OR APPLIED FOR, ON THIS LEASE, FT.

530 ft.

## 16. NO. OF ACRES IN LEASE

1,274.48

## 19. PROPOSED DEPTH

1475 ft.

17. NO. OF ACRES ASSIGNED  
TO THIS WELL

160

## 20. ROTARY OR CABLE TOOLS

Rotary

## 21. ELEVATIONS (Show whether DF, RT, GR, etc.)

6096 Ground Level

## 22. APPROX. DATE WORK WILL START\*

As soon as possible

## 23.

## PROPOSED CASING AND CEMENTING PROGRAM

SIZE OF HOLE	SIZE OF CASING	WEIGHT PER FOOT	SETTING DEPTH	QUANTITY OF CEMENT
9-3/4"	7"	23 lb/ft	40 ft	10 sacks
5"	2-7/8"	6.4 lb/ft	1475 ft	150 sacks

Will drill 9-3/4" hole to 40 ft. and set 40 ft. of 7", 23 lb/ft casing with 10 sacks of cement. Will drill 5" hole to 1475 ft. and run open hole logs. If appears productive, will run 1475 ft. of 2-7/8", 6.4 lb/ft, J-55 casing and cement with 150 sacks. Will perforate and stimulate as required. Minimum specifications for pressure control equipment which is to be used - none required. Circulating medium will be clear water and natural mud with water loss control additives. The gas from this formation is not dedicated. Will use a 6"-900 double ram blowout preventer.

## ESTIMATED TOPS

## FORMATION

## DEPTH

## CONTENT

Ojo Alamo

280 ft.

Water

Kirtland

415 ft.

Fruitland

1100 ft.

Natural gas, salt water

Pictured Cliff

1360 ft.

Natural gas, salt water

IN ABOVE SPACE DESCRIBE PROPOSED PROGRAM: If proposal is to deepen or plug back, give data on present productive zone and proposed new productive zone. If proposal is to drill or deepen directionally, give pertinent data on subsurface locations and measured and true vertical depths. Give blowout preventer program, if any.

## 24.

SIGNED

TITLE

Co-Owner

DATE May 21, 1979

(This space for Federal or State office use)

PERMIT NO.

APPROVAL DATE

APPROVED BY

TITLE

DATE

CONDITIONS OF APPROVAL, IF ANY:

ok Frank

\*See Instructions On Reverse Side

NMDC

30-045-23545

5. LEASE DESIGNATION AND SERIAL NO.

SF 078897-A

6. IF INDIAN, ALLOTTEE OR TRIBE NAME

7. UNIT AGREEMENT NAME

8. FARM OR LEASE NAME

Western Federal

9. WELL NO.

8-Y

10. FIELD AND POOL, OR WILDCAT

South Gallegos Fruitland

11. SEC., T., R., M., OR BLE.  
AND SURVEY OR AREA

Section 18, T26N, R11W

12. COUNTY OR PARISH

San Juan

13. STATE

N.M.

All distances must be from the corner four-faces of the Section.

Operator <b>MERRION &amp; BAYLESS</b>			Lease <b>WESTERN-FEDERAL</b>		Well No. <b>8-Y</b>
Unit Letter <b>B</b>	Section <b>18</b>	Township <b>26N</b>	Range <b>11W</b>	County <b>San Juan</b>	
Actual Footage Location of Well: <b>790</b> feet from the <b>North</b> line and <b>1850</b> feet from the <b>East</b> line					
Ground Level Elev. <b>6095</b>	Producing Formation <b>Fruitland</b>		Pool <b>South Gallinas</b>	Dedicated Acreage: <b>160</b> Acres	

1. Outline the acreage dedicated to the subject well by colored pencil or hatchure marks on the plat below.
2. If more than one lease is dedicated to the well, outline each and identify the ownership thereof (both as to working interest and royalty).
3. If more than one lease of different ownership is dedicated to the well, have the interests of all owners been consolidated by communitization, unitization, force-pooling, etc?

☒ Yes ☐ No If answer is "yes," type of consolidation Communitization

If answer is "no," list the owners and tract descriptions which have actually been consolidated. (Use reverse side of this form if necessary.)

No allowable will be assigned to the well until all interests have been consolidated (by communitization, unitization, forced-pooling, or otherwise) or until a non-standard unit, eliminating such interests, has been approved by the Commission.

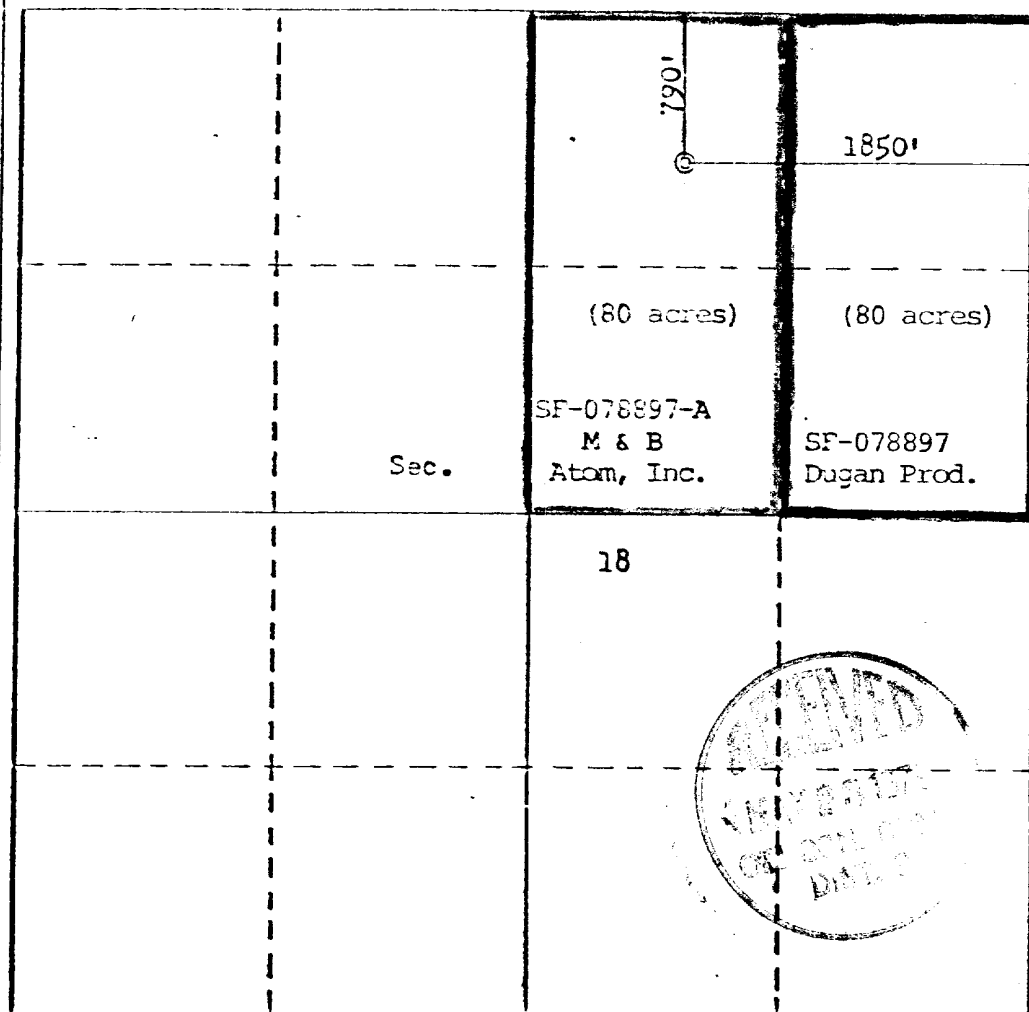

#### CERTIFICATION

I hereby certify that the information contained herein is true and complete to the best of my knowledge and belief.

*Steven S. Dunn*  
Name

Steven S. Dunn

Position

Engineer

Company

Merrion & Bayless

Date

May 3, 1979

I hereby certify that the well location shown on this plat was plotted from field notes of actual surveys made by me or under my supervision, and that the same is true and correct to the best of my knowledge and belief.

Date Surveyed

April 23, 1979

Registered Professional Engineer and/or Land Surveyor

*Fred B. Kerr, Jr.*  
Fred B. Kerr, Jr.

Certificate No.

3950

*Fred B. Kerr, Jr.*  
F. B. KERR, JR.

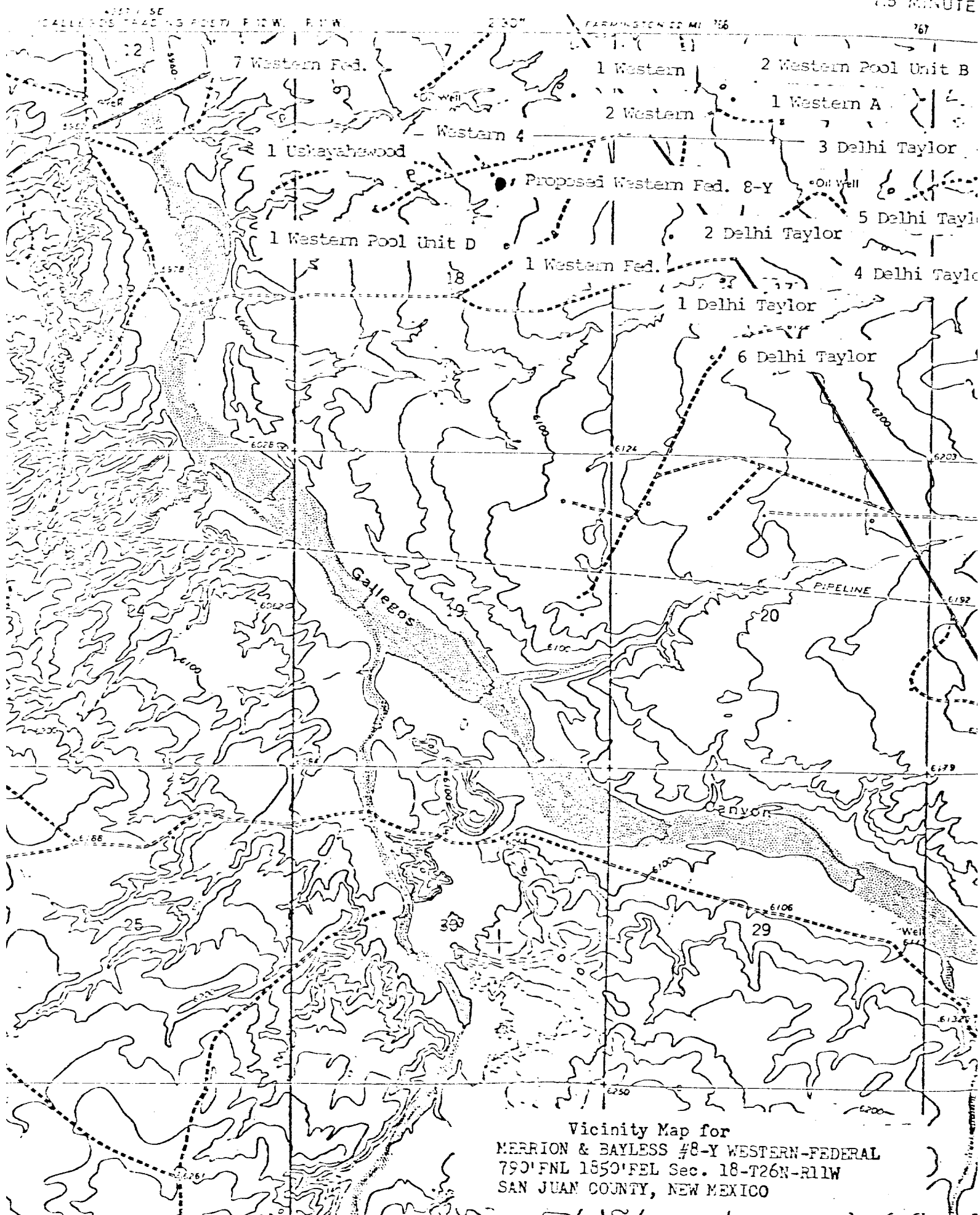

SURFACE USE AND OPERATIONS PLAN

MERRION & BAYLESS  
Western Federal #8-Y  
Section 18, T26N, R11W

- 1 & 2. A topographical map is attached showing location of drillsite and access roads to location; new roads are color coded on the location map. The terrain is relatively flat and no improvements are planned on existing roads. A drive in truck mounted drilling rig will be used and will be driven in to the location with our road work. Our planned access road will be twelve feet in width, and will follow the existing terrain. No turnouts, culverts or cuts and fills are anticipated on the proposed access. In addition, natural drainage and surfacing material will be used.
3. Wells within one mile radius are shown on the topographical map.
4. A. Existing facilities owned or controlled by the Operator and shown on the attached map are as follows: Wellheads, pumping units.  
B. No new facilities are contemplated.  
C. Disturbed areas will be reseeded per BLM specifications.
5. A. Water will be hauled from the San Juan River.  
B. Truck will haul water on proposed access route shown.
6. No construction materials will be used.
7. Methods of disposal of waste materials:  
A. Cuttings will be buried in drilling pit.  
B. Drilling fluids will be buried in drilling pit.  
C. No produced fluids are anticipated.  
D. Sewage will be buried.  
E. Garbage and other waste material will be buried.  
F. Operator will clean up, fill, and level pits and reseed location per BLM specifications.
8. No ancillary facilities.
9. Wellsite layout attached.
10. Restoration of drillsite -- pits will be filled and leveled and reseeded per BLM specifications immediately after completion.
11. Other information: The lease is on Navajo Tribal surface land. The drillsite is fairly level, arid land with very little vegetation. There is no other surface use or facilities existent. An archeological survey statement will be furnished.
12. Operator representative: Robert L. Bayless (505) 325-5093  
P.O. Box 1541  
Farmington, NM 87401
13. Certification:

I hereby certify that I, or persons under my direct supervision, have inspected the proposed drillsite and access route; that I am familiar with the conditions which presently exist; that the statements made in this plan are, to the best of my knowledge, true and correct; and, that the work associated with the operations proposed herein will be performed by Merrion & Bayless and its contractors and subcontractors in conformity with this plan and the terms and conditions under which it is approved.

5-21-79  
DATE

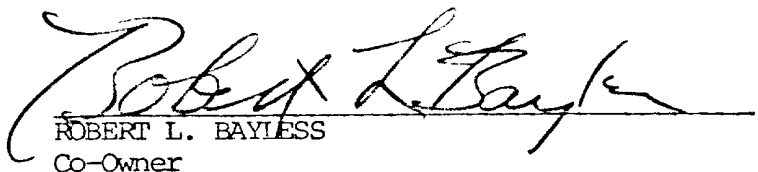
  
ROBERT L. BAYLESS  
Co-Owner

LOCATION AND EQUIPMENT LAY-OUT

MERRION & BAYLESS

Western Federal # 8-Y  
Section 18, T26N, R11W  
San Juan County, New Mexico

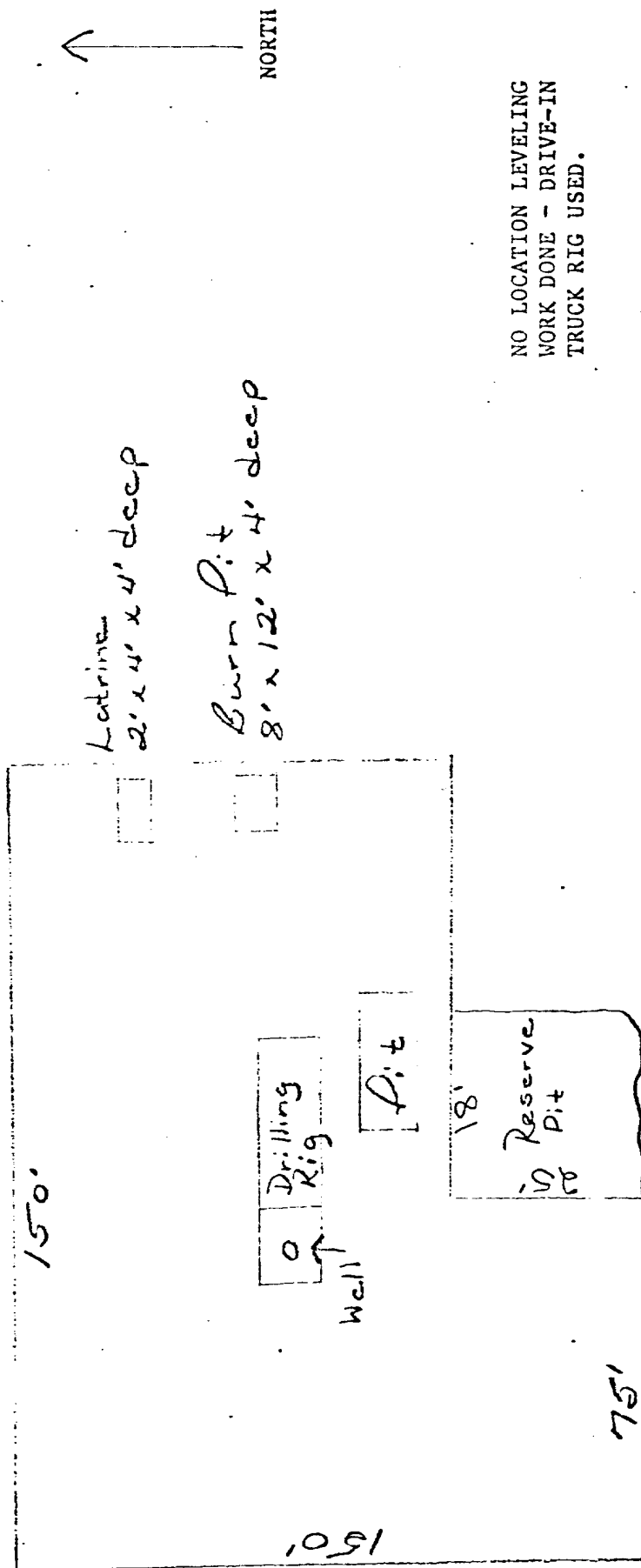

NO LOCATION LEVELING  
WORK DONE - DRIVE-IN  
TRUCK RIG USED.