

District I
P.O. Box 1980 Hobbs, NM

District II
P.O. Drawer 22, Aztec, NM 87410

District III
1000 Rio Brazos Rd, Aztec, NM 87410

State of New Mexico
Energy, Minerals and Natural Resources Department

OIL CONSERVATION DIVISION

2040 South Pacheco Street
Santa Fe, New Mexico 87505

SUBMIT 1 COPY TO
APPROPRIATE
DISTRICT OFFICE
AND 1 COPY TO
SANTA FE OFFICE

Denny E. Frost
DEPUTY OIL & GAS INSPECTOR

FEB 08 1999

Approved
PIT REMEDIATION AND CLOSURE REPORT

RECEIVED
NOV 12 1998

OIL CON. DIV.
DIST. 3

Operator: PNM Gas Services (Burlington) Telephone: 324-3764

Address: 603 W. Elm Street Farmington, NM 87401

Facility or Well Name: Starr #4

Location: Unit H Sec 6 T 26 N R 8 W County San Juan

Pit Type: Separator ☐ Dehydrator ☐ Other Drip Riser

Land Type: BLM ☐ State ☐ Fee ☐ Other Navajo

Pit Location: Pit dimensions: length 20 ' width 20 ' depth 3 '

(Attach diagram) Reference: wellhead ☒ other

Footage from reference: 120'

Direction from reference: 35 Degrees ☒ East ☐ West of North ☒ South ☐

Depth to Ground Water:	Less than 50 feet	(20 points)	<u>0</u>
	50 feet to 99 feet	(10 points)	
	Greater than 100 feet	(0 points)	

(Vertical distance from contaminants to
seasonal high water elevation of ground
water)

Wellhead Protection Area:	Yes	(20 points)	<u>0</u>
	No	(0 points)	

(Less than 200 feet from a private
domestic water source, or, less than 1,000
feet from all other water sources)

Distance to Surface Water:	Less than 200 feet	(20 points)	<u>0</u>
	200 feet to 1,000 feet	(10 points)	
	Greater than 1,000 feet	(0 points)	

(Horizontal distance to perennial lakes,
ponds, rivers, streams, creeks, irrigation
canals and ditches)

RANKING SCORE (TOTAL POINTS): 0

Starr #4

Date Remediation Started: 6/24/98

Date Completed: 6/24/98

Remediation Method: Excavation

X

Approx. Cubic Yard 213

(Check all appropriate sections)

Landfarmed

X

Amount Landfarmed (cubic yds) 213

Other

Remediation Location:

Onsite

X

Offsite

(i.e., landfarmed onsite, name and location of offsite facility)

RECEIVED
NOV 12 1998

Backfill Material Location:

General Description of Remedial Action:

OIL CON. DIV.
DIST. 3

Excavated contaminated soil to a pit size of 20' X 18' X 16' and landfarmed soil onsite within a bermed area at a depth of 6" to 12". Soil was aerated by disking/plowing until soil met regulatory levels.

Ground Water Encountered:

No



Yes



Depth

Final Pit Closure
Sampling:

Sample Location

Bottom of excavation.

(if multiple samples, attach sample result and diagram of sample locations and depths.)

Sample depth

16'

Sample date

6/24/98

Sample time

10:30:00 AM

Sample Results

Benzene (ppm) < 0.0010

Total BTEX (ppm) < 0.0070

Field headspace (ppm)

TPH (ppm)

160.00

Method

8015A

Vertical Extent (ft)

Risk Analysis form attached Yes



No



Ground Water Sample:

Yes



No



(If yes, see attached Groundwater Site Summary Report)

I HEREBY CERTIFY THAT THE INFORMATION ABOVE IS TRUE AND COMPLETE TO THE BEST OF MY KNOWLEDGE AND MY BELIEF

DATE October 29, 1998

PRINTED NAME Maureen Gannon
AND TITLE Project Manager

SIGNATURE

Starr # 4

6-24-98

B.R

Sec. 6, 26N, 8W, H

Start of excavation:

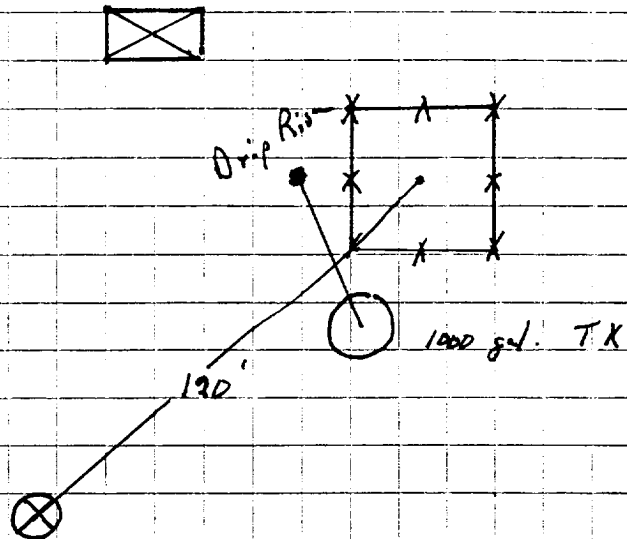

End of excavation

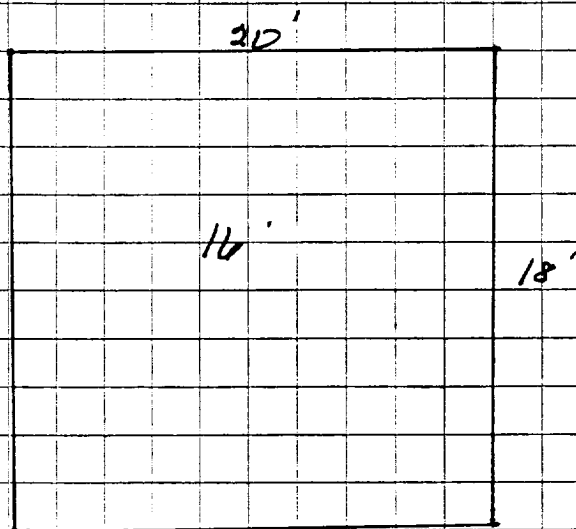

OFF: (505) 325-5667

ON SITE

LAB: (505) 325-1556

TECHNOLOGIES, LTD.

On Site Technologies, LTD.

Date: 06-Jul-98

CLIENT: PNM - Public Service Company of NM

Project: Starr #4

Lab Order: 9806101

CASE NARRATIVE

Samples were analyzed using the methods outlined in the following references:

Test Methods for Evaluating Solid Waste, Physical/Chemical Methods, SW846, 3rd Edition

All method blanks, laboratory spikes, and/or matrix spikes met quality assurance objectives.

OFF: (505) 325-5667



LAB: (505) 325-1556

ANALYTICAL REPORT

Date: 06-Jul-98

Client: PNM - Public Service Company of NM
Work Order: 9806101
Lab ID: 9806101-01A **Matrix:** SOIL
Project: Starr #4

Client Sample Info: Starr #4
Client Sample ID: 9806241030; Bottom @ 16ft.
Collection Date: 6/24/98 10:30:00 AM
COC Record: 7241

Parameter	Result	PQL	Qual	Units	DF	Date Analyzed
DIESEL RANGE ORGANICS						
T/R Hydrocarbons: C10-C28	160	25		mg/Kg	1	Analyst: HR 7/2/98
BTEX						
Benzene	ND	1		µg/Kg	1	Analyst: HR 7/1/98
Toluene	ND	2		µg/Kg	1	7/1/98
Ethylbenzene	ND	1		µg/Kg	1	7/1/98
m,p-Xylene	ND	2		µg/Kg	1	7/1/98
o-Xylene	ND	1		µg/Kg	1	7/1/98

7
 .007

Qualifiers:
 PQL - Practical Quantitation Limit
 ND - Not Detected at Practical Quantitation Limit
 J - Analyte detected below Practical Quantitation Limit
 B - Analyte detected in the associated Method Blank

S - Spike Recovery outside accepted recovery limits
 R - RPD outside accepted recovery limits
 E - Value above quantitation range
 Surr: - Surrogate

1 of 1

OFF: (505) 325-5667



LAB: (505) 325-1556

ANALYTICAL REPORT

Date: 06-Jul-98

Client:	PNM - Public Service Company of NM	Client Sample Info:	Starr #4
Work Order:	9806101	Client Sample ID:	9806241045; Walls @ 12ft.
Lab ID:	9806101-02A	Matrix:	SOIL
Project:	Starr #4	Collection Date:	6/24/98 10:45:00 AM
		COC Record:	7241

Parameter	Result	PQL	Qual	Units	DF	Date Analyzed
DIESEL RANGE ORGANICS		SW8015				Analyst: HR
T/R Hydrocarbons: C10-C28	670	25		mg/Kg	1	7/2/98
BTEX		SW8020A				Analyst: HR
Benzene	ND	1		µg/Kg	1	7/1/98
Toluene	ND	2		µg/Kg	1	7/1/98
Ethylbenzene	ND	1		µg/Kg	1	7/1/98
m,p-Xylene	2.4	2		µg/Kg	1	7/1/98
o-Xylene	2	1		µg/Kg	1	7/1/98
	4.4					
	0044 ppm					

Qualifiers:	PQL - Practical Quantitation Limit	S - Spike Recovery outside accepted recovery limits
	ND - Not Detected at Practical Quantitation Limit	R - RPD outside accepted recovery limits
	J - Analyte detected below Practical Quantitation Limit	E - Value above quantitation range
	B - Analyte detected in the associated Method Blank	Surr: - Surrogate

1 of 1

Starr # 4

7/20/98

BR

Sec. 6, 26N, 8W

Landfarm: On location

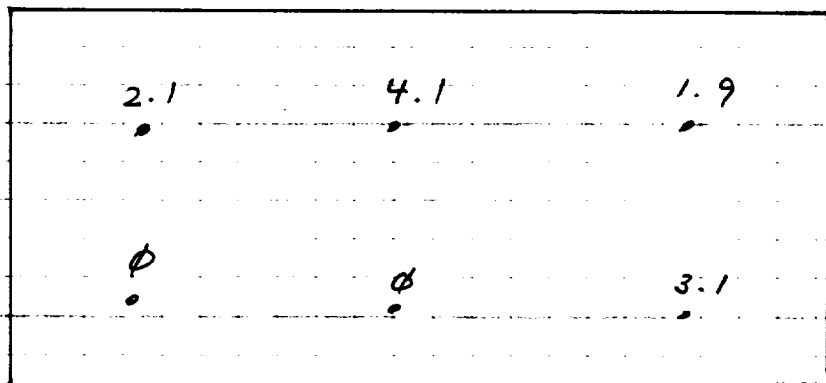

⊗

213 yards
2"-12" depth

Soil vapor head spec = 7.8 ppm

9807201200

OFF: (505) 325-5667



LAB: (505) 325-1556

On Site Technologies, LTD.

Date: 28-Jul-98

CLIENT: PNM - Public Service Company of NM
Project: PNM Pit Remediation
Lab Order: 9807058

CASE NARRATIVE

Samples were analyzed using the methods outlined in the following references:

Test Methods for Evaluating Solid Waste, Physical/Chemical Methods, SW846, 3rd Edition

All method blanks, laboratory spikes, and/or matrix spikes met quality assurance objectives.

OFF: (505) 325-5667



LAB: (505) 325-1556

ANALYTICAL REPORT

Date: 28-Jul-98

Client:	PNM - Public Service Company of NM	Client Sample Info:	Starr #4 LF
Work Order:	9807058	Client Sample ID:	9807201200; 6pt. Comp.
Lab ID:	9807058-07A	Matrix:	SOIL
Project:	PNM Pit Remediation	Collection Date:	7/20/98 12:00:00 PM
		COC Record:	7389

Parameter	Result	PQL	Qual	Units	DF	Date Analyzed
DIESEL RANGE ORGANICS		SW8015				Analyst: HR
T/R Hydrocarbons: C10-C28	580	25		mg/Kg	1	7/24/98

Qualifiers:	PQL - Practical Quantitation Limit	S - Spike Recovery outside accepted recovery limits
	ND - Not Detected at Practical Quantitation Limit	R - RPD outside accepted recovery limits
	J - Analyte detected below Practical Quantitation Limit	E - Value above quantitation range
	B - Analyte detected in the associated Method Blank	Surr: - Surrogate

1 of 1

P.O. BOX 2606 • FARMINGTON, NM 87499

- SERVING THE MINING INDUSTRY WITH THE ENVIRONMENT -