

STATE OF NEW MEXICO

ENERGY MINERALS AND NATURAL RESOURCES DEPARTMENT

ISION

GARREY CARRUTHER
GOVERNOR

Merrion
P.O. Box
Farming

Attentio

14, 1990

POST OFFICE BOX 2088
STATE LAND OFFICE BUILDING
SANTA FE, NEW MEXICO 87504
(505) 827-5800

RECEIVED

DEC 18 1990

OIL CON. DIV.
DIST.

Administrative Order NSL-2963

Dear Mr. Sharpe:

Reference is made to your application dated July 30, 1990 for a non-standard Basin-Fruitland coal gas well location for your existing Susco Federal Well No. 1 which was drilled in 1979 and completed in the WAW Fruitland Pictured Cliffs Pool at a standard gas well location 1840 feet from the South line and 1850 feet from the East line (Unit J) of Section 9, Township 26 North, Range 12 West, NMPM, San Juan County, New Mexico.

It is my understanding that the Pictured Cliffs zone will be properly plugged back and said well will be recompleted to the Basin-Fruitland Coal Gas Pool, which pursuant to the Special Rules and Regulations for the Basin-Fruitland Coal Gas Pool as promulgated by Division Order No. R-8768, is unorthodox. Further, the S/2 of said Section 9 shall be dedicated to the well forming a standard 320-acre gas spacing and proration unit for said pool.

By the authority granted me under the provisions of Rule 8 of said Division Order No. R-8768, the above-described unorthodox coal gas well location is hereby approved.

Sincerely,

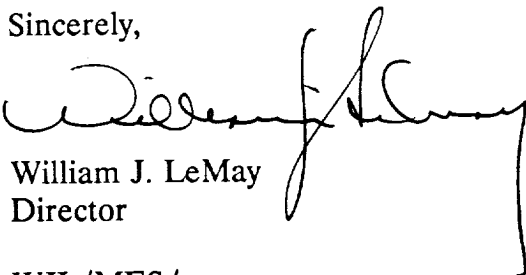

William J. LeMay
Director

WJL/MES/ag

cc: Oil Conservation Division - Aztec
US Bureau of Land Management - Farmington

Well P & A
8-9-90

- Need to do
reentry of P & A.



STATE OF NEW MEXICO
ENERGY AND MINERALS DEPARTMENT
OIL CONSERVATION DIVISION
AZTEC DISTRICT OFFICE

ARREY CARRUTHERS
GOVERNOR

10000 PUEBLO BLVD
AZTEC, NEW MEXICO 87410
(505) 334-0170

Date: 11-26-90

ATTN: M. Stagner

Oil Conservation Division
P.O. Box 2088
Santa Fe, NM 87504-2088

Re: Proposed MC _____
Proposed DHC _____
Proposed NSL Y _____
Proposed SWD _____
Proposed WFX _____
Proposed PMX _____

Gentlemen:

I have examined the application dated 10-6-90
for the Merion Oil & Gas Corp. Sisco Fed. #1
Operator Lease & Well No.

J-F-36W-12W and my recommendations are as follows:
Unit, S-T-R

Approve

Yours truly,

Ernie Bosch

MERRION OIL & GAS CORPORATION

610 REILLY AVE. • P. O. Box 840
FARMINGTON, NEW MEXICO 87499

OIL CONSERVATION DIVISION
505-327-9801
RECEIVED

'90 JUL 31 AM 8 44

Ann E. Bosch

July 30, 1990

Mr. William LeMay
New Mexico Oil Conservation Division
P. O. Box 2088
Santa Fe, New Mexico 87503

RE: Susco Federal No. 1
1840' FSL & 1850' FEL
Section 9, T26N, R12W
San Juan County, New Mexico

RECEIVED
SEP 06 1990
OIL CON. DIV.
DIST. 3

Dear Mr. LeMay:

This is a request for administrative approval for a non-standard gas well location in the Basin Fruitland Pool.

Merrion Oil & Gas intends to plugback and recomplete the Susco Federal No. 1 well from the Pictured Cliffs pool to the Basin Fruitland Coal Pool. The current location of this well is 1840' FSL & 1850' FEL, Section 9, T26N, R12W, San Juan County, New Mexico. The well is considered non-standard due to the NW/SW dedicated pattern established for the Basin Fruitland Coal Pool. To comply with the New Mexico Oil Conservation Division rules, Merrion is submitting the following for your approval of this non-standard location:

1. C-102 plat showing location of the well;
2. Plat showing offset owners/operators;
3. Affidavit of notification of offset owners/operators;
4. Copy of Well Completion Log for original completion.

A copy of this application is being submitted to all offset owners/operators by certified mail with a request that they furnish your Santa Fe office with a Waiver of Objection, and return one copy to this office.

Sincerely yours,

George F. Sharpe
Reservoir Engineer

GFS/eg
Enclosures

CC: Well File

SUSCO FEDERAL NO. 1
1840' FSL & 1850' FEL
Section 9, T26N, R12W
San Juan County, New Mexico

I hereby certify that the following offset owners/operators have been notified by certified mail of our application for administrative approval for non-standard gas well location for the plugback and recompletion of the above well.

BK Petroleum
P. O. Box 826
Farmington, New Mexico 87499

Dugan Petroleum Corporation
P. O. Box 420
Farmington, New Mexico 87499

Kindermac Partners
650 South Cherry, Suite 1225
Denver, Colorado 80222

Southern Union Exploration
Box NBU 3001
Farmington, New Mexico 87499

San Juan County
State of New Mexico

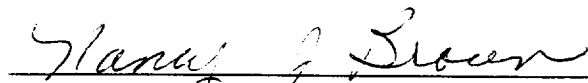

Nancy J. Brown
April 30, 1990

My commission expires:
March 16, 1993.

New Mexico Oil Conservation Division
Page Two
July 30, 1990

WAIVER

_____ hereby waives objection to Merrion Oil & Gas Corporation's application for a non-standard location for their Susco Federal No. 1 as proposed above.

By: _____ Date: _____

CC: BK Petroleum
Dugan Petroleum Corporation
Kindermac Partners
Southern Union Exploration
Well File

P 565 381 684

RECEIPT FOR CERTIFIED MAIL

NO INSURANCE COVERAGE PROVIDED
NOT FOR INTERNATIONAL MAIL
(See Reverse)

* U.S.G.P.O. 1989-234-555

PS Form 3800, June 1985

Sent to Dugan Petroleum Corp.	
Street and No. P. O. Box 420	
P.O., State and ZIP Code Farmington, NM 87499	
Postage	\$.45
Certified Fee	1.75
Special Delivery Fee	
Restricted Delivery Fee	
Return Receipt showing to whom and Date Delivered	
Return Receipt showing to whom, Date, and Address of Delivery	
TOTAL Postage and Fees	\$ 2.20
Postmark or Date 7/30/90	

P 565 381 683

RECEIPT FOR CERTIFIED MAIL

NO INSURANCE COVERAGE PROVIDED
NOT FOR INTERNATIONAL MAIL
(See Reverse)

* U.S.G.P.O. 1989-234-555

PS Form 3800, June 1985

Sent to BK Petroleum	
Street and No. P. O. Box 826	
P.O., State and ZIP Code Farmington, NM 87499	
Postage	\$.45
Certified Fee	1.75
Special Delivery Fee	
Restricted Delivery Fee	
Return Receipt showing to whom and Date Delivered	
Return Receipt showing to whom, Date, and Address of Delivery	
TOTAL Postage and Fees	\$ 2.20
Postmark or Date 7/30/90	

P 565 381 686

RECEIPT FOR CERTIFIED MAIL

NO INSURANCE COVERAGE PROVIDED
NOT FOR INTERNATIONAL MAIL
(See Reverse)

* U.S.G.P.O. 1989-234-555

PS Form 3800, June 1985

Sent to Southern Union Exploration	
Street and No. Box NBU 3001	
P.O., State and ZIP Code Farmington, NM 87499	
Postage	\$.45
Certified Fee	1.75
Special Delivery Fee	
Restricted Delivery Fee	
Return Receipt showing to whom and Date Delivered	
Return Receipt showing to whom, Date, and Address of Delivery	
TOTAL Postage and Fees	\$ 2.20
Postmark or Date 7/30/90	

P 565 381 685

RECEIPT FOR CERTIFIED MAIL

NO INSURANCE COVERAGE PROVIDED
NOT FOR INTERNATIONAL MAIL
(See Reverse)

* U.S.G.P.O. 1989-234-555

PS Form 3800, June 1985

Sent to Kindermac Patners	
Street and No. 850 So. Cherry, Ste 1225	
P.O., State and ZIP Code Denver, Colorado 80222	
Postage	\$.45
Certified Fee	1.75
Special Delivery Fee	
Restricted Delivery Fee	
Return Receipt showing to whom and Date Delivered	
Return Receipt showing to whom, Date, and Address of Delivery	
TOTAL Postage and Fees	\$ 2.20
Postmark or Date 7/30/90	

MERRION OIL & GAS CORPORATION

SUSCO FEDERAL NO. 1

1840' FSL & 1850' FEL

Section 9, T26N, R12W

San Juan County, New Mexico

APPLICATION FOR NON-STANDARD PRORATION UNIT

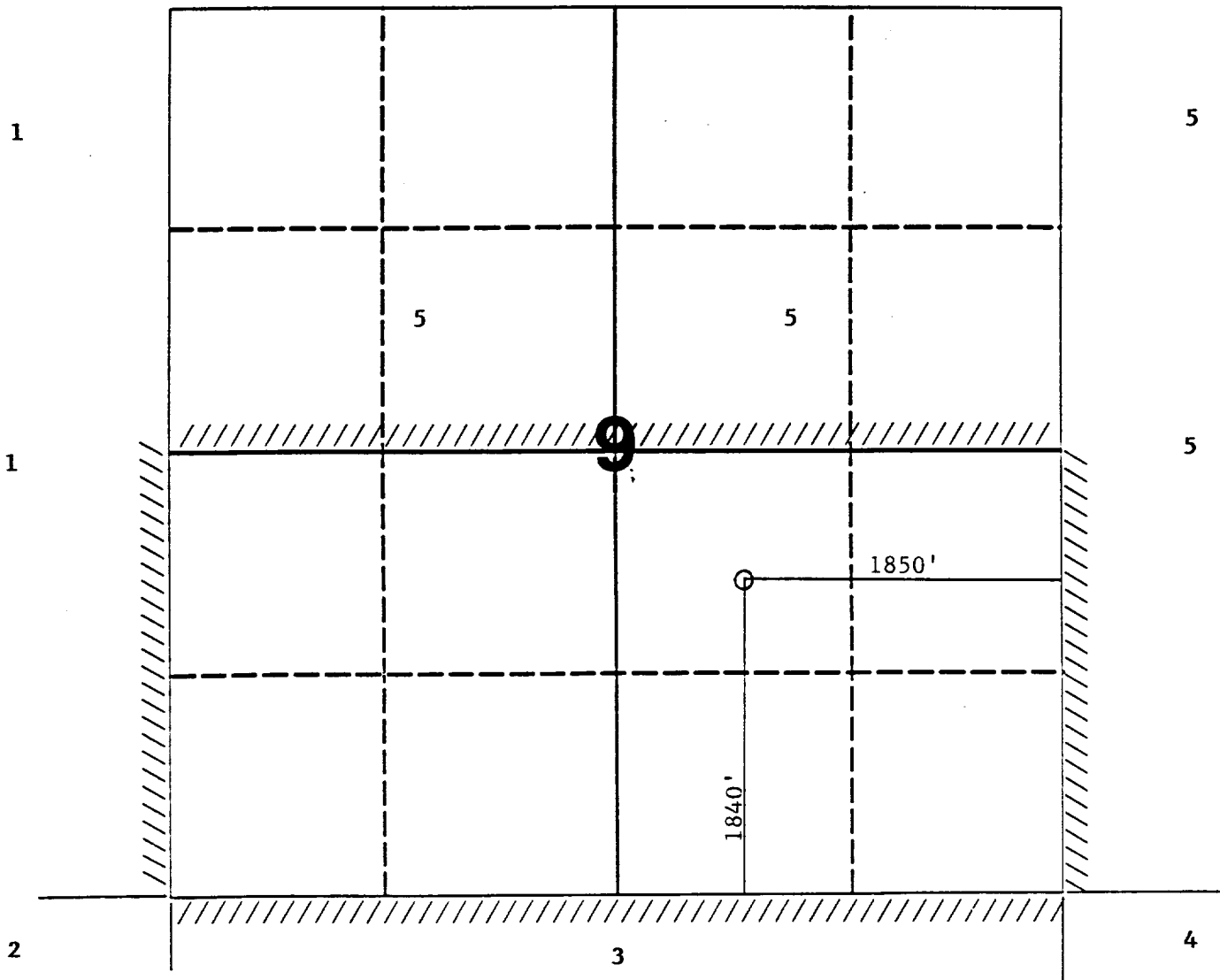

- REMARKS
- 1) BK Petroleum, Box 826, Farmington, New Mexico 87499
 - 2) Dugan Petroleum Corporation, Box 420, Farmington, New Mexico 87499
 - 3) Kindermac Partners, 650 S. Cherry, Ste 1225, Denver, CO 80222
 - 4) Southern Union Exploration, Box NBU 3001, Farmington, NM 874
 - 5) Merrion Oil & Gas Corporation

Submit to Appropriate
District Office
State Lease - 4 copies
Fee Lease - 3 copies

State of New Mexico
Geology, Minerals and Natural Resources Department

Form C-102
Revised 1-1-89

OIL CONSERVATION DIVISION

DISTRICT I
P.O. Box 1980, Hobbs, NM 88240

P.O. Box 2088
Santa Fe, New Mexico 87504-2088

DISTRICT II
P.O. Drawer DD, Artesia, NM 88210

DISTRICT III
1000 Rio Brazos Rd., Aztec, NM 87410

WELL LOCATION AND ACREAGE DEDICATION PLAT

All Distances must be from the outer boundaries of the section

Operator MERRION OIL & GAS CORPORATION			Lease Susco Federal		Well No. 1
Unit Letter J	Section 9	Township 26N	Range 12W	County NMPM San Juan	
Actual Footage Location of Well: 1840 feet from the South line and 1850 feet from the East line					
Ground level Elev. 6034' KB	Producing Formation Fruitland Coal	Pool Basin	Dedicated Acreage: 320 Acres		

1. Outline the acreage dedicated to the subject well by colored pencil or hatchure marks on the plat below.

2. If more than one lease is dedicated to the well, outline each and identify the ownership thereof (both as to working interest and royalty).

3. If more than one lease of different ownership is dedicated to the well, have the interest of all owners been consolidated by communitization, unitization, force-pooling, etc.?

☐ Yes

☒ No

If answer is "yes" type of consolidation

If answer is "no" list the owners and tract descriptions which have actually been consolidated. (Use reverse side of this form if necessary.)

No allowable will be assigned to the well until all interests have been consolidated (by communitization, unitization, forced-pooling, or otherwise) or until a non-standard unit, eliminating such interest, has been approved by the Division.

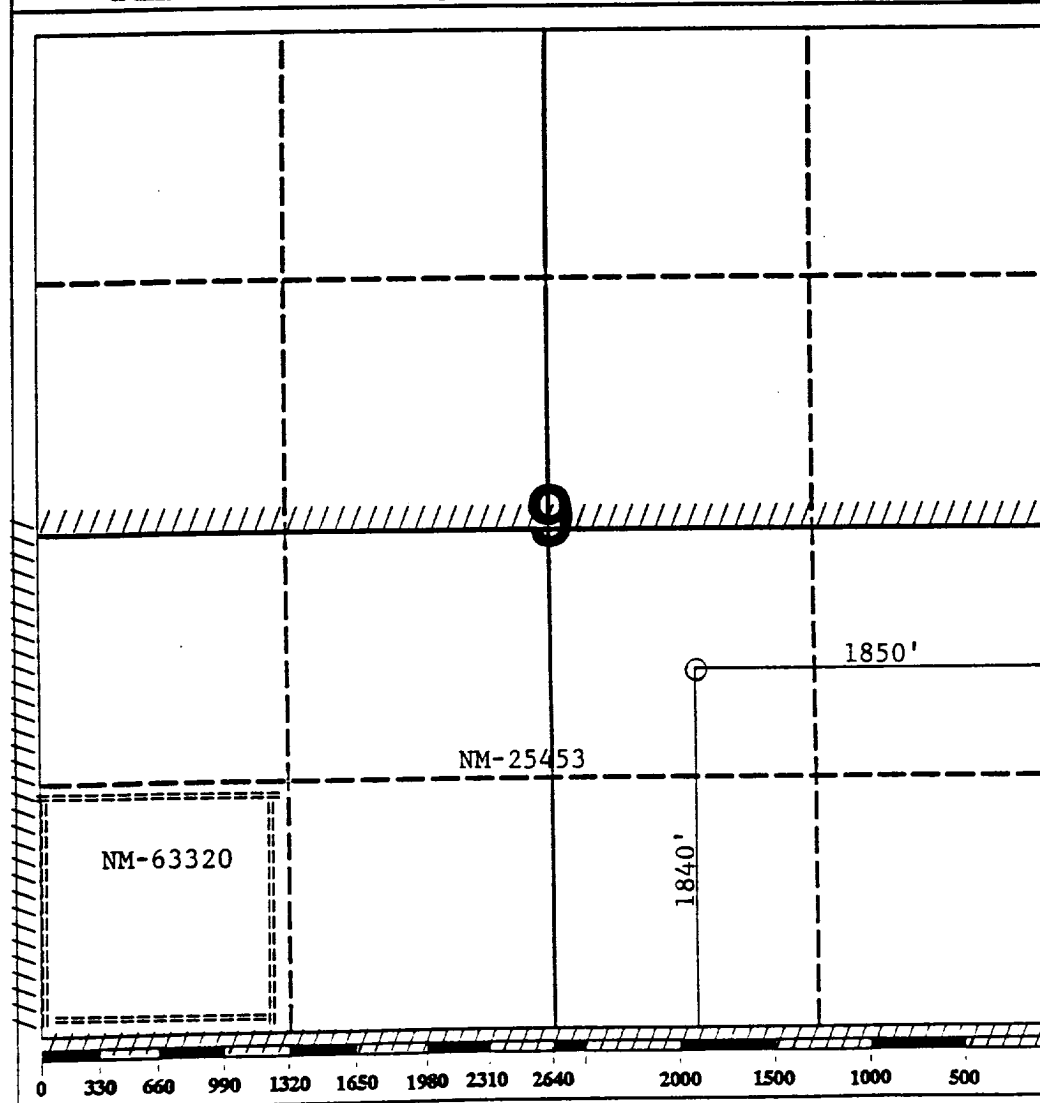

OPERATOR CERTIFICATION

I hereby certify that the information contained herein is true and complete to the best of my knowledge and belief.

Signature
George F. Sharpe

Printed Name
George F. Sharpe

Position
Reservoir Engineer

Company
Merrion Oil & Gas Corp.

Date

SURVEYOR CERTIFICATION

I hereby certify that the well location shown on this plat was plotted from field notes of actual surveys made by me or under my supervision, and that the same is true and correct to the best of my knowledge and belief.

Date Surveyed

Signature & Seal of
Professional Surveyor

Certificate No.

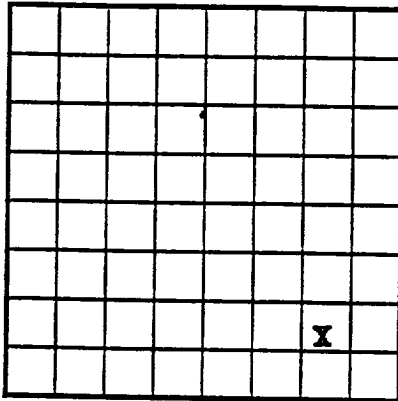
U. S. LAND OFFICE Santa Fe
SERIAL NUMBER 047039-B
LEASE OR PERMIT TO PROSPECT KUTZ

LOCATE WELL CORRECTLY

UNITED STATES
DEPARTMENT OF THE INTERIOR
GEOLOGICAL SURVEY

LOG OF OIL OR GAS WELL

Company El Paso Natural Gas Company Address P.O. Box 997, Farmington, New Mexico
 Lessor or Tract Kutz Canyon C. & G. Field Fulcher-Kutz State New Mexico
 Well No. 1 Sec. 17 T. 28N R. 10W Meridian NMPM County San Juan
 Location 990 ft. (N) of S Line and 990 (W) of E Line of Sec. 17 Elevation 5957
(Denote floor relative to sea level)

The information given herewith is a complete and correct record of the well and all work done thereon so far as can be determined from all available records.

Signed ORIGINAL SIGNED E. J. COELDate November 20, 1951Title Petroleum Engineer

The summary on this page is for the condition of the well at above date.

Commenced drilling October 7, 1951 Finished drilling October 18, 1951

OIL OR GAS SANDS OR ZONES

(Denote gas by G)

No. 1, from 2002 to 2050 (G) No. 4, from _____ to _____
 No. 2, from _____ to _____ No. 5, from _____ to _____
 No. 3, from _____ to _____ No. 6, from _____ to _____

IMPORTANT WATER SANDS

No. 1, from 962 to 1035 No. 3, from _____ to _____
 No. 2, from _____ to _____ No. 4, from _____ to _____

CASING RECORD

Size casing	Weight per foot	Threads per inch	Make	Amount	Kind of shoe	Cut and pulled from	Perforated		Purpose
							From—	To—	
8-5/8	21	8	Natl	27	HWCO				Surface
5-9/16	11.65	8	Natl	2003	HWCO				Production
1	1.68	8	Natl	2066	HWCO				Siphon

MUDDING AND CEMENTING RECORD

Size casing	Where set	Number sacks of cement	Method used	Mud gravity	Amount of mud used
8-5/8	20	60	Circulated		
5-9/16	2000	140	Single Stage		

PLUGS AND ADAPTERS

Heaving plug—Material _____ Length _____ Depth set _____

Adapter—Material _____