

UNITED STATES
DEPARTMENT OF THE INTERIOR
GEOLOGICAL SURVEY

APPLICATION FOR PERMIT TO DRILL, DEEPEN, OR PLUG BACK

1a. TYPE OF WORK

DRILL ☒DEEPEN ☐PLUG BACK ☐

b. TYPE OF WELL

OIL
WELL ☐GAS
WELL ☒

OTHER

SINGLE
ZONE ☒MULTIPLE
ZONE ☐

2. NAME OF OPERATOR

DOME PETROLEUM CORPORATION

3. ADDRESS OF OPERATOR

501 Airport Drive, Suite 107, Farmington, New Mexico 87401

4. LOCATION OF WELL (Report location clearly and in accordance with any State requirements.*)

At surface

1520' FNL, 1120' FWL

At proposed prod. zone

14. DISTANCE IN MILES AND DIRECTION FROM NEAREST TOWN OR POST OFFICE*

25 miles south of Farmington, New Mexico

15. DISTANCE FROM PROPOSED*

LOCATION TO NEAREST

PROPERTY OR LEASE LINE, FT.

(Also to nearest drlg. unit line, if any)

16. NO. OF ACRES IN LEASE

320

160

18. DISTANCE FROM PROPOSED LOCATION*

TO NEAREST WELL, DRILLING, COMPLETED,
OR APPLIED FOR, ON THIS LEASE, FT.

19. PROPOSED DEPTH

1500'

17. NO. OF ACRES ASSIGNED
TO THIS WELL

160

20. ROTARY OR CABLE TOOLS

ROTARY

21. ELEVATIONS (Show whether DF, RT, GR, etc.)

5932' GR

22. APPROX. DATE WORK WILL START*

September 15, 1979

23.

PROPOSED CASING AND CEMENTING PROGRAM

SIZE OF HOLE	SIZE OF CASING	WEIGHT PER FOOT	SETTING DEPTH	QUANTITY OF CEMENT
8 3/4"	7"	20#	90'	60 SACKS (CIRCULATED)
5"	2 7/8"	6.5#	1500'	BY CALIPER LOG - CIRCULATED

Move in rotary tools. Drill 8 3/4" hole to 90'. Set 90' of new 7" casing and cement as above. Wait on cement 12 hrs. Install 6" 600 series Blowout Preventer and test. Drill 5" hole to 1500'. No abnormal temperatures or pressures are anticipated. Mud system will be Gel-chem weighing 8.5-9.2#/gal. W.L. 8-10 cc and viscosity of 30-50 sec/quart. Logging program will be IES, FDC/CNL, with GR caliper log. If commercial, 2 7/8" casing will be run and cemented as above. If non-commercial, plug & abandonment will follow U.S.G.S. specifications. The geologic name of the surface formation is Ojo Alamo. The estimated tops of important geologic markers:

FARMINGTON	280
FRUITLAND	762
PICTURED CLIFF	1082

The above formations could either be water-bearing or gas.
Gas under this lease is dedicated to a contract.

IN ABOVE SPACE DESCRIBE PROPOSED PROGRAM: If proposal is to deepen or plug back, give data on present productive zone and proposed new productive zone. If proposal is to drill or deepen directionally, give pertinent data on subsurface locations and measured and true vertical depths. Give blowout preventer program, if any.

24.

SIGNED

H.D. HOLLYGSWORTH
H.D. HOLLYGSWORTH

TITLE DRILLING FOREMAN

DATE August 27, 1979

(This space for Federal or State office use)

PERMIT NO.

APPROVAL DATE

APPROVED BY

TITLE

DATE

CONDITIONS OF APPROVAL, IF ANY:

*ok Frank**NMLCC*

30-045-2 3801

5. LEASE DESIGNATION AND SERIAL NO.
NM 0560221

6. IF INDIAN, ALLOTTEE OR TRIBE NAME

7. UNIT AGREEMENT NAME

8. FARM OR LEASE NAME
FUSSELMAN FEDERAL

9. WELL NO.
2R

10. FIELD AND POOL, OR WILDCAT
WAW FRUITLAND-PICTURED CLIFF

11. SEC., T., R., M., OR BLK.
AND SURVEY OR AREA
SEC.17, T26N, R12W

12. COUNTY OR PARISH
SAN JUAN

13. STATE
NEW MEXICO

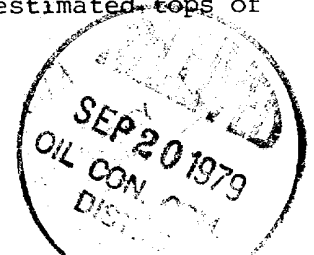

OIL CONSERVATION DIVISION

STATE OF NEW MEXICO
ENERGY AND MINERALS DEPARTMENTP. O. BOX 2088
SANTA FE, NEW MEXICO 87501Form C-107
Revised 10-1-78

All distances must be from the outer boundaries of the Section.

Operator DOME PETROLEUM CORPORATION			Lease FUSSELMAN-FEDERAL		Well No. 2 R
Unit Letter E	Section 17	Township 26N	Range 12W	County San Juan	
Actual Footage Location of Well: 1520 feet from the North line and 1120 feet from the West line					
Ground Level Elev. 5438	Producing Formation PICTURED CLIFF		Pool WAW FRUITLAND-PICTURED CLIFF		Dedicated Acreage: 160 Acres

1. Outline the acreage dedicated to the subject well by colored pencil or hachure marks on the plat below.
2. If more than one lease is dedicated to the well, outline each and identify the ownership thereof (both as to working interest and royalty).
3. If more than one lease of different ownership is dedicated to the well, have the interests of all owners been consolidated by communitization, unitization, force-pooling, etc?

☐ Yes ☐ No If answer is "yes," type of consolidation _____

If answer is "no," list the owners and tract descriptions which have actually been consolidated. (Use reverse side of this form if necessary.) _____

No allowable will be assigned to the well until all interests have been consolidated (by communitization, unitization, forced-pooling, or otherwise) or until a non-standard unit, eliminating such interests, has been approved by the Commission.

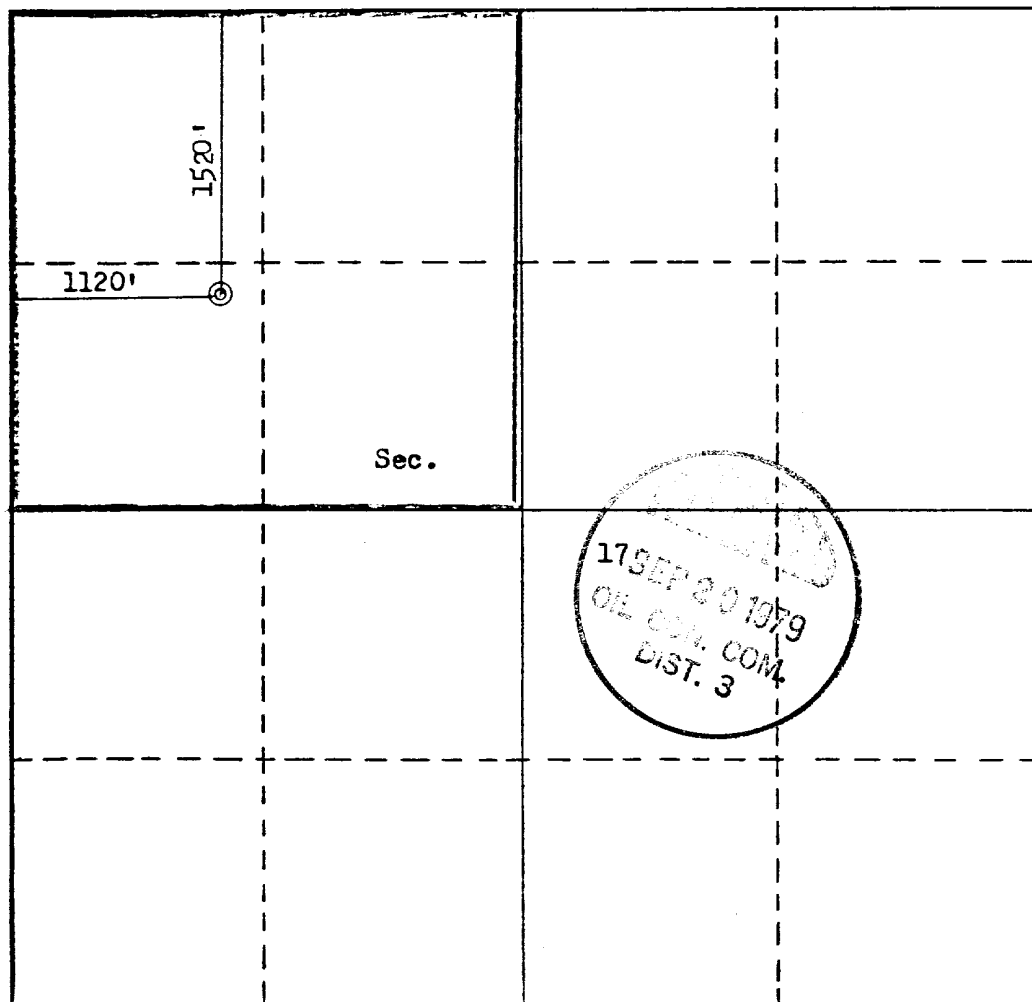

CERTIFICATION

I hereby certify that the information contained herein is true and complete to the best of my knowledge and belief.

Name

H.D. HOLLINGSWORTH

Position

DRILLING FOREMAN

Company

DOME PETROLEUM CORPORATION

Date

August 20, 1979

I hereby certify that the well location shown on this plat was plotted from field notes of actual surveys made by me or under my supervision, and that the same is true and correct to the best of my knowledge and belief.

Date Surveyed

August 20, 1979

Registered Professional Engineer
and/or Land Surveyor

Fred B. Kerr, Jr.

Certificate No. 3950

0 330 660 990 1320 1650 1980 2310 2640 2000 1500 1000 500 0



E. C. GENT
VICE PRESIDENT

DOME PETROLEUM CORP.

SUITE 1500, COLORADO STATE BANK BLDG.
1600 BROADWAY
DENVER, COLORADO 80202

TELEPHONE
(303) 861-1230

DEVELOPMENT PLAN FOR SURFACE USE

Fusselman Federal #3
1520' FNL and 1120' FWL
Sec. 17, T26N, R12W
San Juan County, New Mex.

1. EXISTING ROADS

The main road to the location is that from Farmington toward Bisti (Bisti highway) leaving this road approximately 23 miles south of Farmington and using existing side roads to the location.

2. PLANNED ACCESS ROADS

The access road, to be routed as shown on the attached map, will be 18' wide with adequate ditch and water bars.

3. EXISTING WELLS

Existing wells within one mile of location are shown on the attached topographic map.

4. LOCATION OF PROPOSED FACILITIES

Development of commercial gas production will require separation facilities on the location pad. Equipment and pits will be fenced as required for protection of livestock and wildlife. Above ground facilities will be painted brown or grey to blend in with the surrounding area as specified by the BLM. The disturbed areas no longer needed for operations after well completion will be restored to natural contour and reseeded.

5. LOCATION AND TYPE OF WATER SUPPLY

To be hauled from El Paso Natural Gas Co. water pit at Chaco Gas Plan, approximately 3 miles east.

6. SOURCE OF CONSTRUCTION MATERIALS

Not applicable.

7. METHOD OF HANDLING WASTE MATERIAL

All garbage and trash that can be burned shall be burned. All trash that cannot be burned will be contained in a trash pit and covered with a minimum of 24 inches of dirt. All drilling waste such as cuttings, overflows of oil, water and drilling fluids will be contained in the reserve pit and buried with adequate cover upon completion of operations. The reserve pit will be fenced until cleanup operations are commenced. Toilet facilities will be provided.

8. ANCILLARY FACILITIES

No camps or airstrips are proposed for this location.

9. WELL SITE LAYOUT

See attached diagram.

10. PLANS FOR RESTORATION OF SURFACE

Cleanup of the location will commenced immediately following the removal of the drilling equipment. The reserve pit will be fenced until restoration operations are commenced. The location will be returned to original contour if the well is not productive. Both the road and location will be reseeded in accordance with BLM specifications.

11. OTHER INFORMATION

Topography consists of rolling hills with very sandy soil. Vegetation is composed of Snake Weed, Mormon Tea, Yucca, Prickly Pear and Blue Gramma.

12. LEASEE'S OR OPERATOR'S REPRESENTATIVE

Dome Petroleum Corporation
H. D. Hollingsworth
501 Airport Drive, Suite 107
Farmington, New Mexico 87401
Phone: 505-325-2897 Office
505-327-1548 Home

13. CERTIFICATION

I hereby certify that I, or persons under my direct supervision, have inspected the proposed drill site and access route; that I am familiar with the conditions which presently exist; that the statements made in the plan are, to the best of my knowledge, true and correct; and that the work associated with the operations proposed herein will be performed by Dome Petroleum Corporation and it's contractors and subcontractors in conformity with this plan and the terms and conditions under which it is approved.



H. D. HOLLINGSWORTH, DRILLING FOREMAN
Dome Petroleum Corporation

August 20, 1979

HDH/clp

BLOWOUT PREVENTERS

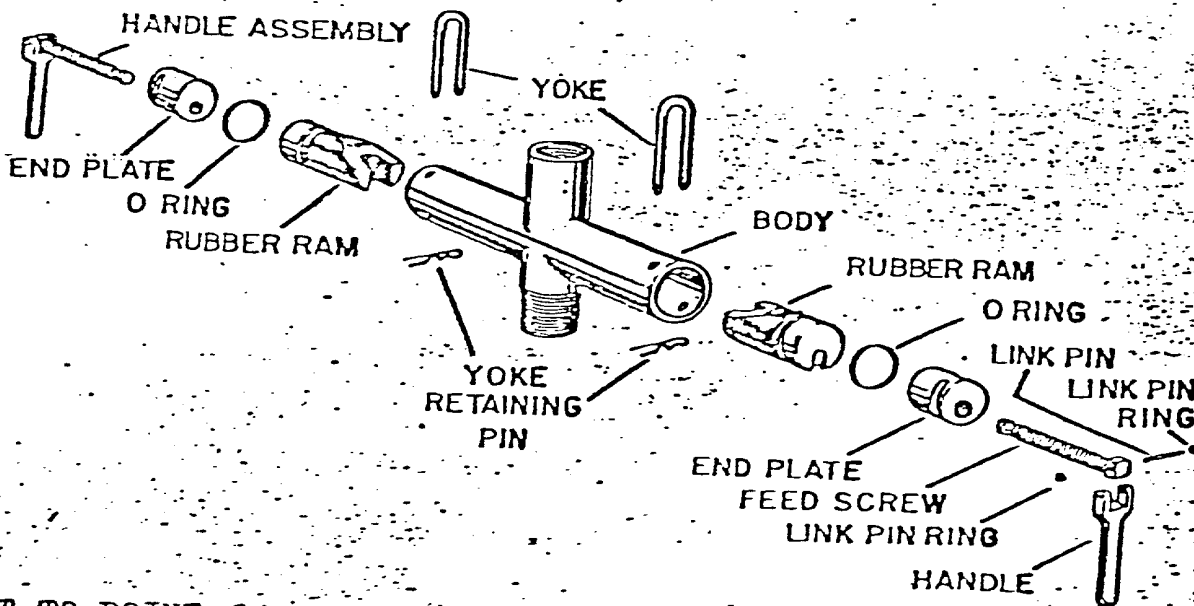

ATTACHMENT TO POINT 5
 [SERIES 6" 600

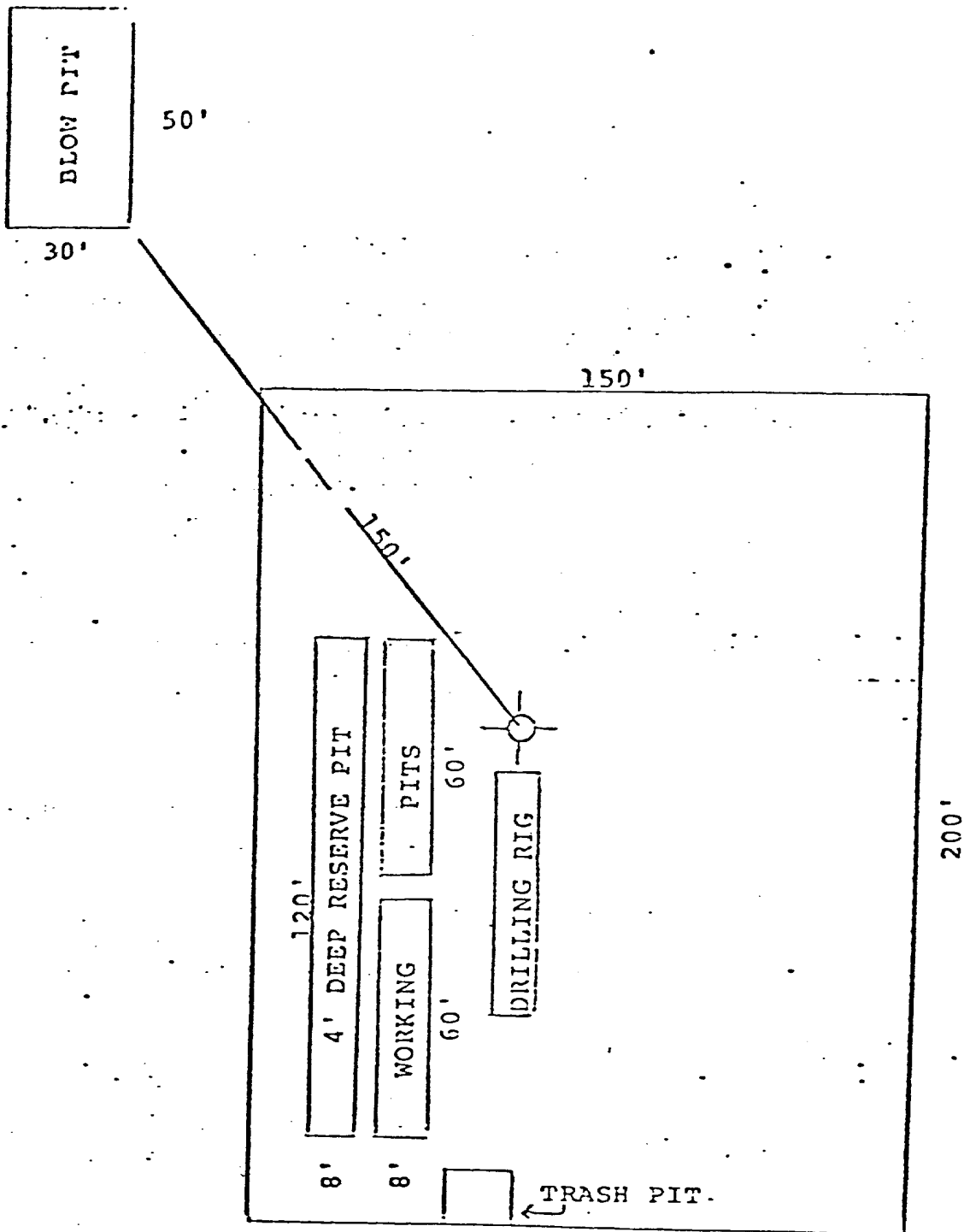

· DOME PETROLEUM CORP.

SUITE 1500, COLORADO STATE BANK BLDG.

1600 BROADWAY

DENVER, COLORADO 80202

NEW MEXICO-SAN JUAN CO.
7.5 MINUTE SERIES (TOPOGRAPHIC)

1 GALL
TRADING

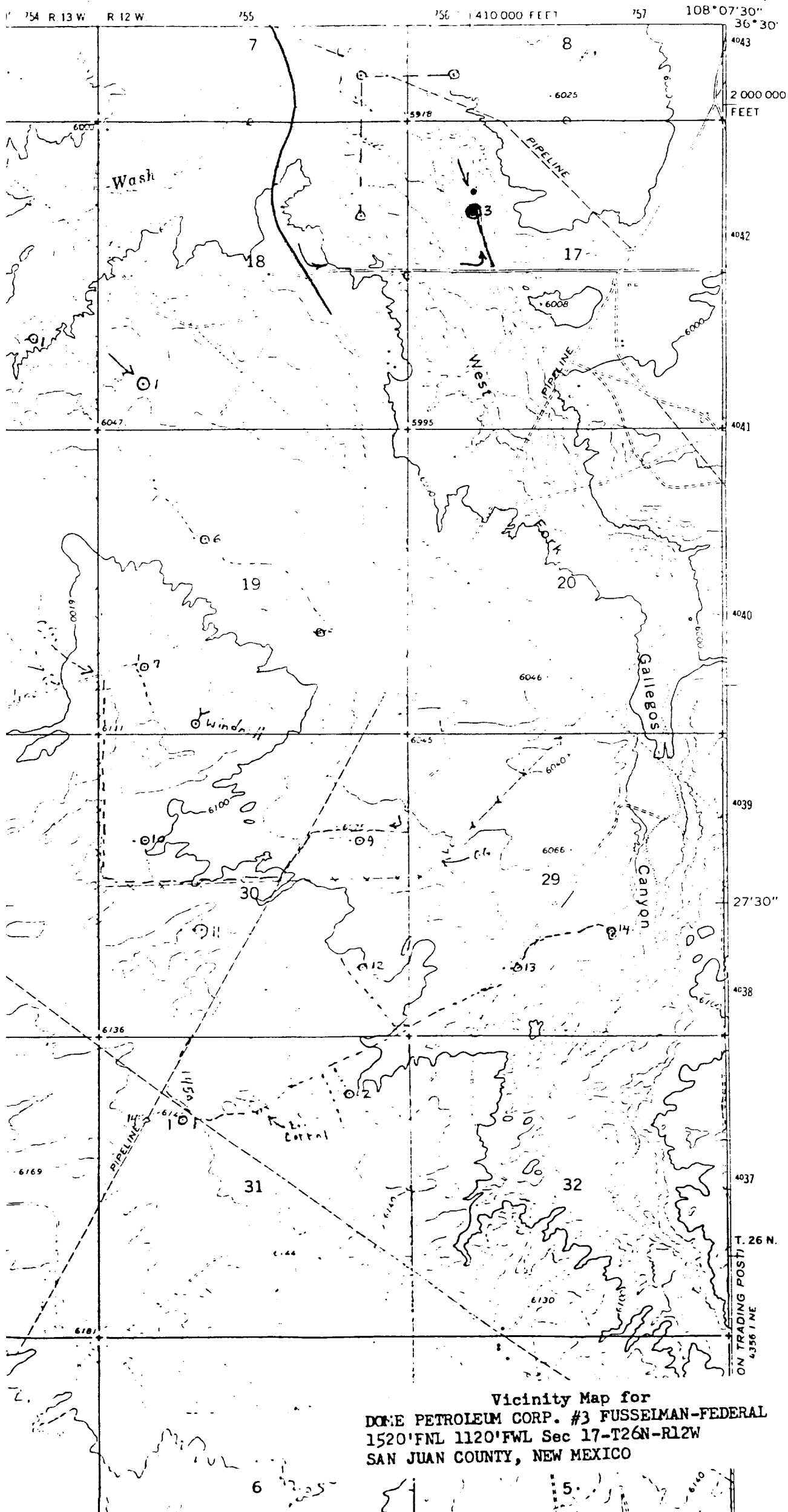

Vicinity Map for
DOME PETROLEUM CORP. #3 FUSSELMAN-FEDERAL
1520'FNL 1120'FWL Sec 17-T26N-R12W
SAN JUAN COUNTY, NEW MEXICO