

UNITED STATES
DEPARTMENT OF THE INTERIOR
GEOLOGICAL SURVEY

30-045-23886

APPLICATION FOR PERMIT TO DRILL, DEEPEN, OR PLUG BACK

1a. TYPE OF WORK

DRILL ☒DEEPEN ☐PLUG BACK ☐

b. TYPE OF WELL

OIL
WELL ☐GAS
WELL ☒

OTHER

SINGLE
ZONE ☒MULTIPLE
ZONE ☐

2. NAME OF OPERATOR

J. Gregory Merrion and Robert L. Bayless

3. ADDRESS OF OPERATOR

P.O. Box 1541, Farmington, NM 87401

4. LOCATION OF WELL (Report location clearly and in accordance with any State requirements.)*

At surface

1850 FNL & 1850 FEL

At proposed prod. zone

same

14. DISTANCE IN MILES AND DIRECTION FROM NEAREST TOWN OR POST OFFICE*

Approximately 17 miles south of Farmington, NM

15. DISTANCE FROM PROPOSED*

LOCATION TO NEAREST
PROPERTY OR LEASE LINE, FT.
(Also to nearest drlg. unit line, if any)

1850 ft.

16. NO. OF ACRES IN LEASE

1120

17. NO. OF ACRES ASSIGNED
TO THIS WELL

160

18. DISTANCE FROM PROPOSED LOCATION*

TO NEAREST WELL, DRILLING, COMPLETED,
OR APPLIED FOR, ON THIS LEASE, FT.

7500 ft.

19. PROPOSED DEPTH

1310'

20. ROTARY OR CABLE TOOLS

Rotary

21. ELEVATIONS (Show whether DF, RT, GR, etc.)

6065 ft. GL

22. APPROX. DATE WORK WILL START*

November 15, 1979

23.

PROPOSED CASING AND CEMENTING PROGRAM

| SIZE OF HOLE | SIZE OF CASING | WEIGHT PER FOOT | SETTING DEPTH | QUANTITY OF CEMENT |
|--------------|----------------|-----------------|---------------|-------------------------------|
| 9-3/4" | 7" | 23 lb. | 90 ft. | 30 sacks |
| 5" | 2-7/8" | 6.4 lb. | 1310 ft. | 150 sacks circulated to surf. |

Will drill 9-3/4" hole to 90 ft. and set 90 ft. of 7", 23 lb./ft., J-55 used casing with 30 sacks Class "H" cement. Will drill 5" hole to 1310 ft. and run 1310 ft. of 2-7/8" EUE, C-45 used casing and cement with 150 sacks Class "H" with 2% D-79 cement, circulated to surface. No abnormal pressures or temperatures are anticipated. Circulating medium will be clear water, natural mud, and water loss control additives. Will run Induction and Density logs. Blowout preventer schematic attached. The gas from this formation is not dedicated.

ESTIMATED TOPS

| FORMATION |
|-------------|
| Ojo Alamo |
| Kirtland |
| Fruitland |
| Pic. Cliffs |

| DEPTH |
|---------|
| Surface |
| 60' |
| 835' |
| 1195' |

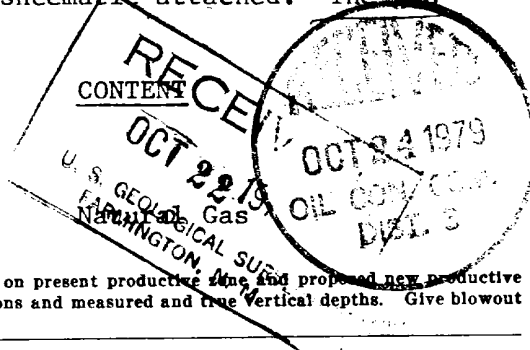

IN ABOVE SPACE DESCRIBE PROPOSED PROGRAM: If proposal is to deepen or plug back, give data on present productive zone and proposed new productive zone. If proposal is to drill or deepen directionally, give pertinent data on subsurface locations and measured and true vertical depths. Give blowout preventer program, if any.

24.

Original Signed By

SIGNED ROBERT L. BAYLESS

TITLE Co-Owner

DATE Oct. 19, 1979

(This space for Federal or State office use)

PERMIT NO.

APPROVAL DATE

APPROVED BY

TITLE

DATE

CONDITIONS OF APPROVAL, IF ANY:

oh Frank

NMOC

*See Instructions On Reverse Side

OIL CONSERVATION DIVISION

STATE OF NEW MEXICO
ENERGY AND MINERALS DEPARTMENTP. O. BOX 2088
SANTA FE, NEW MEXICO 87501Form C-107
Revised 10-1-78

All distances must be from the outer boundaries of the Section.

| | | | | |
|--|--|---------------------------------------|---------------------------------|--------------------|
| Operator • MERRION & BAYLESS | | Lease SOUTHLAND | | Well No. 5 |
| Unit Letter G | Section 11 | Township 26N | Range 13W | County San Juan |
| Actual Footage Location of Well: 1850 feet from the North line and 1850 feet from the East line | | | | |
| Ground Level Elev. 6065 | Producing Formation Pictured Cliffs | Pool WAW Fruitland/Pictured Cliffs | Dedicated Acreage: 160 Acres | |

1. Outline the acreage dedicated to the subject well by colored pencil or hachure marks on the plat below.
2. If more than one lease is dedicated to the well, outline each and identify the ownership thereof (both as to working interest and royalty).
3. If more than one lease of different ownership is dedicated to the well, have the interests of all owners been consolidated by communitization, unitization, force-pooling, etc?

☐ Yes ☐ No If answer is "yes," type of consolidation _____

If answer is "no," list the owners and tract descriptions which have actually been consolidated. (Use reverse side of this form if necessary.) _____

No allowable will be assigned to the well until all interests have been consolidated (by communitization, unitization, forced-pooling, or otherwise) or until a non-standard unit, eliminating such interests, has been approved by the Commission.

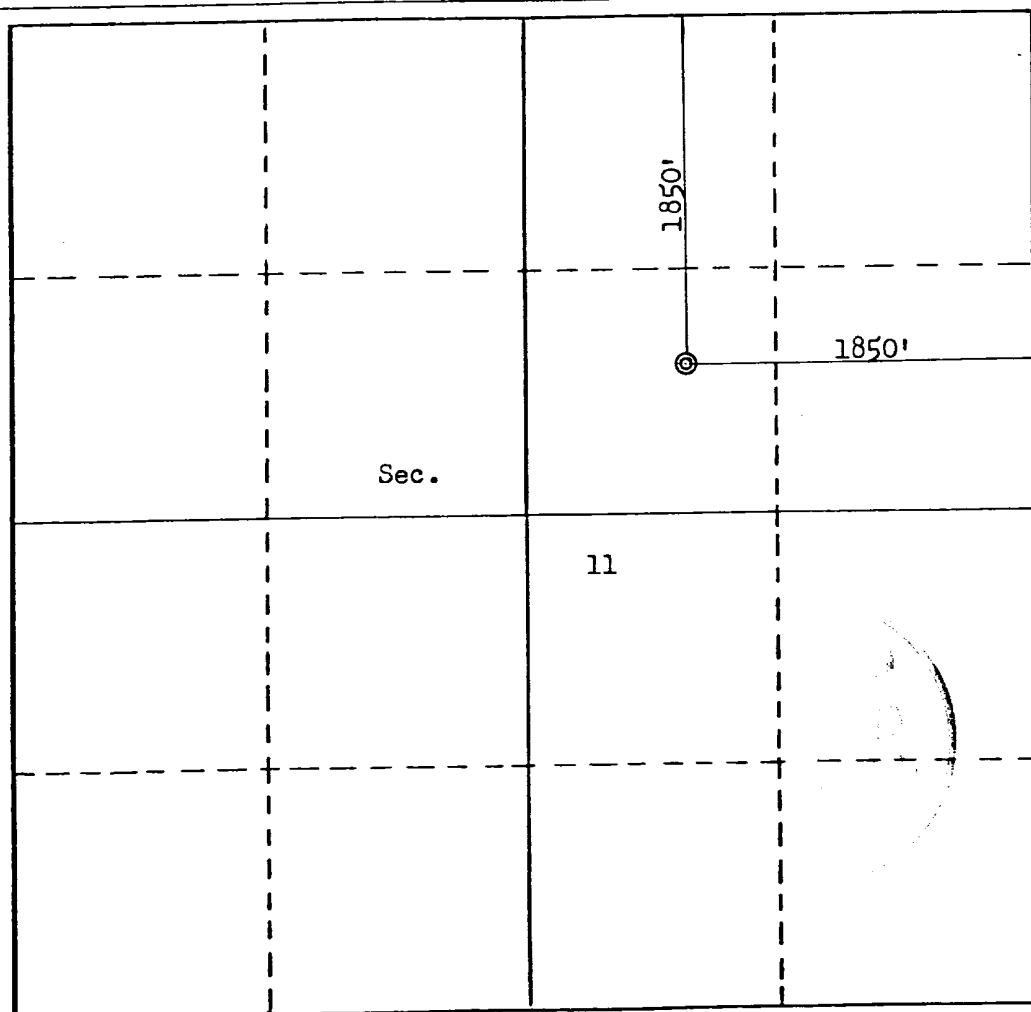

CERTIFICATION

I hereby certify that the information contained herein is true and complete to the best of my knowledge and belief.

Original Signed By
ROBERT L. BAYLESS

Name
Robert L. Bayless

Position
Co-Owner

Company
MERRION & BAYLESS

Date
October 17, 1979

I hereby certify that the well location shown on this plat was plotted from field notes of actual surveys made by me or under my supervision, and that the same is true and correct to the best of my knowledge and belief.

Date Surveyed
October 12, 1979
Registered Professional Engineer
and/or Land Surveyor

3950
KERR, JR.

SURFACE WELL CONTROL EQUIPMENT

MERRION & BAYLESS
Southland #5
Section 11, T26N, R13W
San Juan County, New Mexico

MERRION~BAYLESS

DRAWN BY

REVISED

APPROVED BY:

SCALE:

DATE:

SCHEMATIC

DRAWING NUMBER

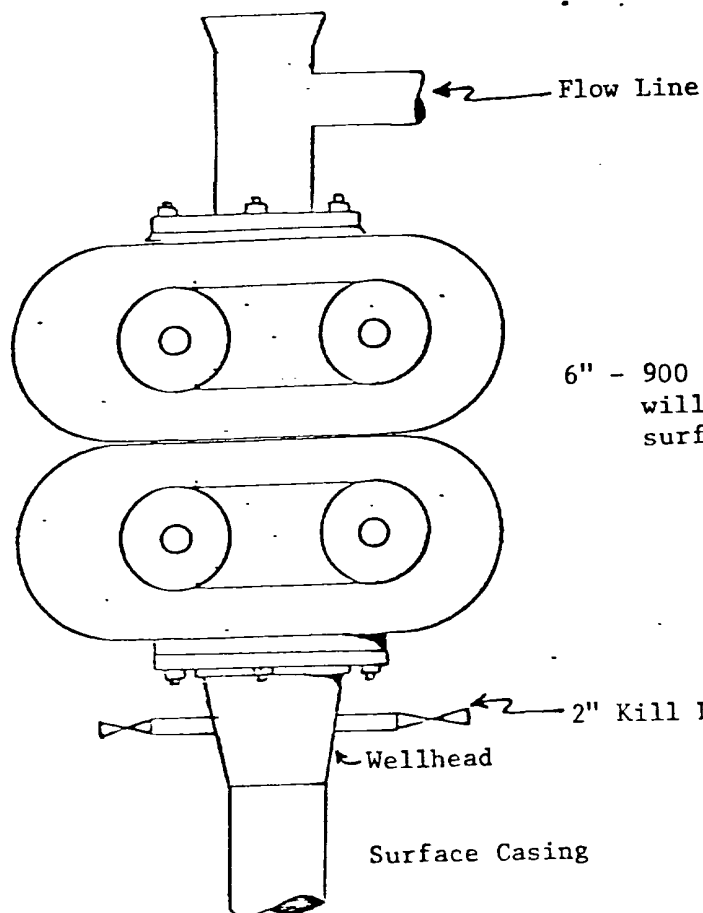

6" - 900 Series Mechanical Double Ram BOP which
will be tested to 500 PSIG after setting of
surface casing

2" Kill Line with 2000 WOG Ball Valve

Wellhead

Surface Casing

SURFACE USE AND OPERATIONS PLAN

MERRION & BAYLESS
Southland #5
Section 11, T26N, R13W

- 1 & 2. A topographical map is attached showing location of drillsite and access road to location; new roads are color coded on the location map. The terrain is relatively flat and no improvements are planned on existing roads. A drive in truck mounted drilling rig will be used and will be driven in to the location with our road work. Our planned access road will be twelve feet in width, and will follow the existing terrain. No turnouts, culverts or cuts and fills are anticipated on the proposed access. In addition, natural drainage and surfacing material will be used.
3. Wells within one mile radius are shown on the topographical map.
4. A. Existing facilities owned or controlled by the Operator and shown on the attached map are as follows: wellheads.
B. No new facilities are contemplated.
C. Disturbed areas will be reseeded per BLM specifications.
5. A. Water will be hauled from the San Juan River.
B. Truck will haul water on proposed access route shown.
6. No construction materials will be used.
7. Methods of disposal of waste materials:
A. Cuttings will be buried in drilling pit.
B. Drilling fluids will be buried in drilling pit.
C. No produced fluids are anticipated.
D. Sewage will be buried.
E. Garbage and other waste material will be buried.
F. Operator will clean up, fill, and level pits and reseed location per BLM specifications.
8. No ancillary facilities.
9. Wellsite layout attached.
10. Restoration of drillsite -- pits will be filled and leveled and reseeded per BLM specifications immediately after completion.
11. Other information: the lease is on Navajo Tribal surface land. The drillsite is fairly level, arid land with very little vegetation. There is no other surface use or facilities existent. An archeological survey statement will be furnished.
12. Operator representative: Robert L. Bayless (505) 325-5093
P.O. Box 1541
Farmington, NM 87401
13. Certification:

I hereby certify that I, or persons under my direct supervision, have inspected the proposed drillsite and access route; that I am familiar with the conditions which presently exist; that the statements made in this plan are, to the best of my knowledge, true and correct; and, that the work associated with the operations proposed herein will be performed by Merrion & Bayless and its contractors and subcontractors in conformity with this plan and the terms and conditions under which it is approved.

Original Signed By
ROBERT L. BAYLESS

Date

ROBERT L. BAYLESS
Co-Owner
Merrion & Bayless

LOCATION AND EQUIPMENT LAY-OUT

MERRION & BAYLESS
Southland #5
Section 11, T26N, R13W
San Juan County, New Mexico

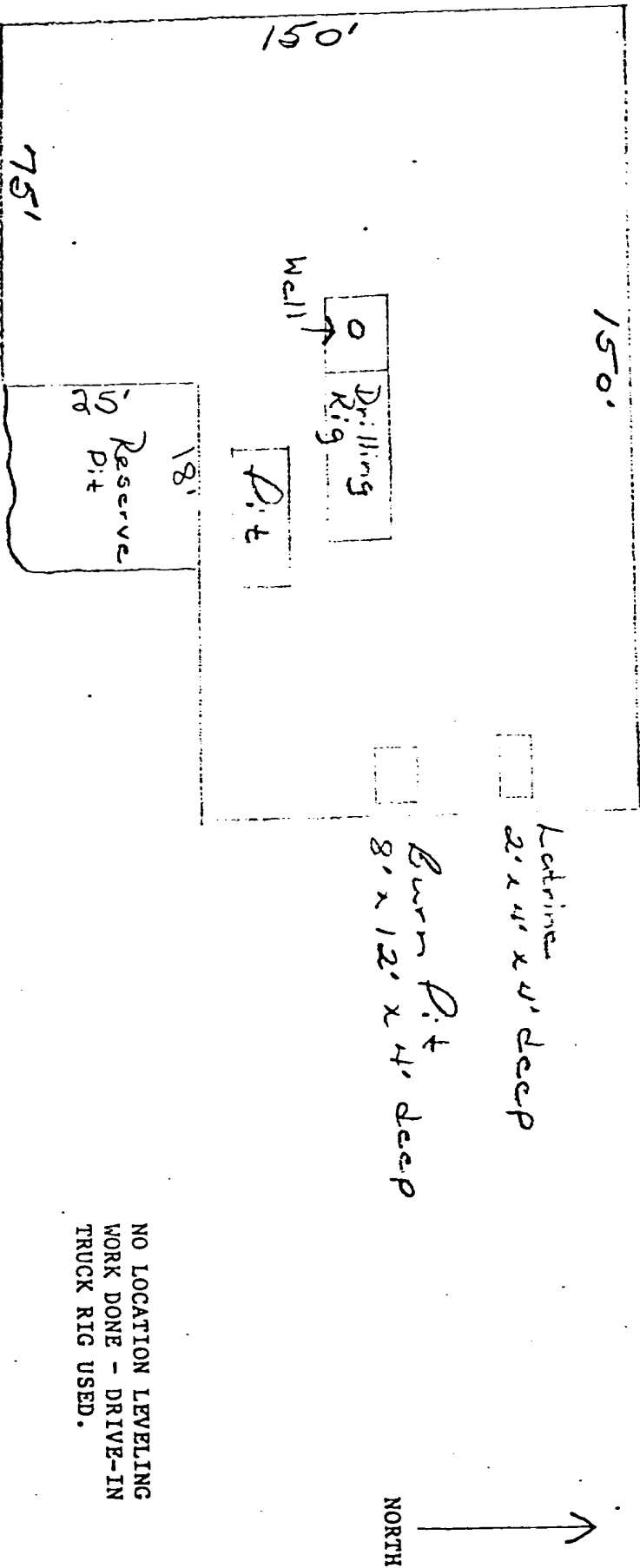

NO LOCATION LEVELING
WORK DONE - DRIVE-IN
TRUCK RIG USED.

