

OIL CONSERVATION COMMISSION

Antelope DISTRICT

OIL CONSERVATION COMMISSION  
BOX 2088  
SANTA FE, NEW MEXICO

DATE 11-20-79

RE: Proposed MC \_\_\_\_\_  
Proposed DHC \_\_\_\_\_  
Proposed NSL ✓ \_\_\_\_\_  
Proposed SWD \_\_\_\_\_  
Proposed WFX \_\_\_\_\_  
Proposed PMX \_\_\_\_\_

Gentlemen:

I have examined the application dated 11-1-79  
for the Merrion & Bayless Chaco #13 I-10-26-N-13-W  
Operator Lease and Well No. Unit, S-T-R

and my recommendations are as follows:

Approve  
\_\_\_\_\_  
\_\_\_\_\_  
\_\_\_\_\_  
\_\_\_\_\_

Yours very truly,

AR Kendrick

ROBERT L. BAYLESS

PETROLEUM CLUB PLAZA BUILDING

P. O. BOX 1541

FARMINGTON, NEW MEXICO 87401

November 1, 1979

State of New Mexico  
Energy & Minerals Department  
Oil Conservation Division  
P.O. Box 2088  
Santa Fe, NM 87501

RE: Chaco 13  
Pictured Cliff Gas Well  
SE/4 Sec. 10, T26N, R13W

Gentlemen:

We request administrative approval of an unorthodox location for the above well.

Enclosed is a survey plat along with the letter from the Navajo Indian Irrigation Project dated September 19 setting forth reasons for unorthodox location.

Yours truly,

MERRION & BAYLESS

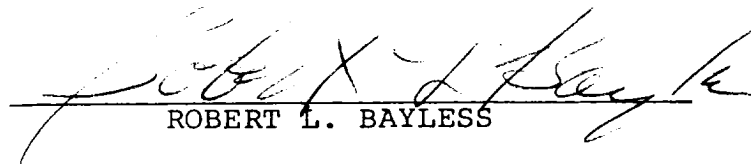
  
ROBERT L. BAYLESS

RLB/pb

Enclosures

xc: Aztec Office



## OIL CONSERVATION DIVISION

OF NEW MEXICO  
MINERALS DEPARTMENT

P. O. BOX 2088  
SANTA FE, NEW MEXICO 87501

Form C-102  
Revised 10-1-78

All distances must be from the outer boundaries of the Section

Owner <b>MERRION &amp; BAYLESS</b>			Lease <b>CHACO</b>		Well No. <b>13</b>
Unit Letter <b>I</b>	Section <b>10</b>	Township <b>26N</b>	Range <b>13W</b>	County <b>San Juan</b>	
Actual Footage Location of Well:					
1900 feet from the South line and		790 feet from the East line			
Ground Level Elev. <b>6160</b>	Producing Formation <b>Fruitland/Pic. Cliffs</b>	Pool <b>WAW</b>	Dedicated Acreage: <b>160</b> Acres		

1. Outline the acreage dedicated to the subject well by colored pencil or hatchure marks on the plat below.
2. If more than one lease is dedicated to the well, outline each and identify the ownership thereof (both as to working interest and royalty).
3. If more than one lease of different ownership is dedicated to the well, have the interests of all owners been consolidated by communitization, unitization, force-pooling, etc?

☐ Yes ☐ No If answer is "yes," type of consolidation \_\_\_\_\_

If answer is "no," list the owners and tract descriptions which have actually been consolidated. (Use reverse side of this form if necessary.) \_\_\_\_\_

No allowable will be assigned to the well until all interests have been consolidated (by communitization, unitization, forced-pooling, or otherwise) or until a non-standard unit, eliminating such interests, has been approved by the Commission.

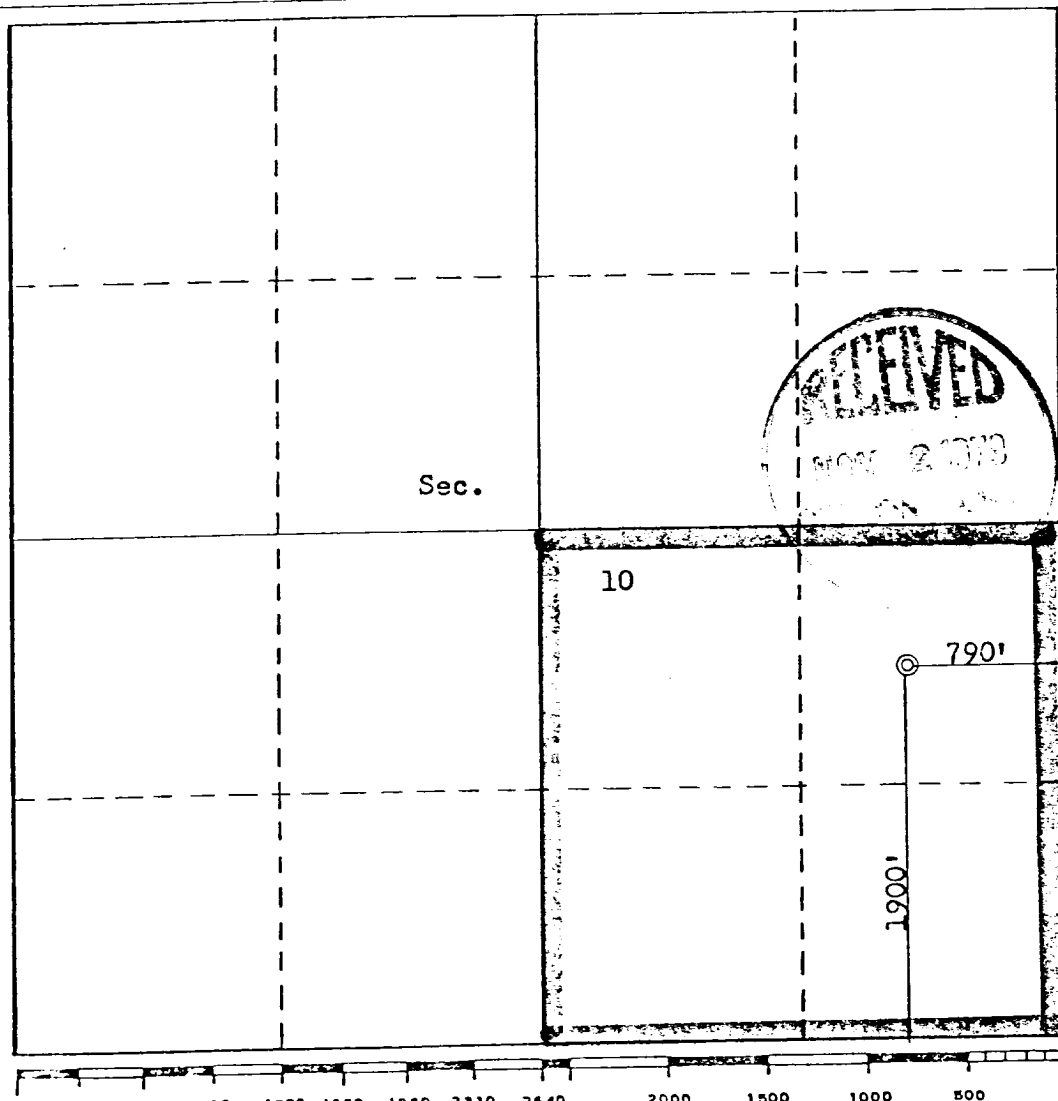

## CERTIFICATION

I hereby certify that the information contained herein is true and complete to the best of my knowledge and belief.

Original Signed By  
**ROBERT L. BAYLESS**

Position  
**Co-Owner**

Company  
**Merrion & Bayless**

Date  
**October 10, 1979**

I hereby certify that the well location shown on this plat was plotted from field notes of actual surveys made by me or under my supervision, and that the same is true and correct to the best of my knowledge and belief.

Date Surveyed  
**September 21, 1979**  
Registered Professional Engineer  
and/or Land Surveyor  
**Fred S. Kern, Jr.**  
Certificate No. **3950**

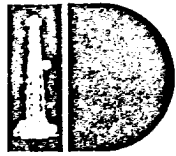

**DIETRICH**  
EXPLORATION COMPANY, INC.

602 MIDLAND SAVINGS BUILDING • 444 SEVENTEENTH STREET • DENVER, COLORADO 80202 • TELEPHONE (303) 534-6080

November 9, 1979

New Mexico Oil Conservation  
Division  
1000 Rio Brazos Road  
Aztec, New Mexico 87410

Gentlemen:

Dietrich Exploration has no objection to the unorthodox locations referred to in the attached letter from Robert L. Bayless. However, the ownership attributed to Dietrich Exploration in Section 2, T26N, R13W on the attached plat is incorrect in that Dietrich Exploration only has the E/2 Section 2 under lease, as we have shown by our correction.

Yours very truly,

DIETRICH EXPLORATION COMPANY, INC.

Ray F. Dietrich  
President

RFD/smh

Enclosures

