

UNITED STATES
DEPARTMENT OF THE INTERIOR
GEOLOGICAL SURVEY

APPLICATION FOR PERMIT TO DRILL, DEEPEN, OR PLUG BACK

1a. TYPE OF WORK

DRILL ☒DEEPEN ☐PLUG BACK ☐

b. TYPE OF WELL

OIL
WELL ☐GAS
WELL ☒

OTHER

SINGLE
ZONE ☒MULTIPLE
ZONE ☐

2. NAME OF OPERATOR

Supron Energy Corporation

3. ADDRESS OF OPERATOR

Building V, Fifth Floor

10300 N. Central Expressway, Dallas, Texas 75231

4. LOCATION OF WELL (Report location clearly and in accordance with any State requirements.)*

At surface

-1500' FSL & -1700' FEL (NW SE)

At proposed prod. zone

1910' 1290' NE

same

14. DISTANCE IN MILES AND DIRECTION FROM NEAREST TOWN OR POST OFFICE*

24.3 miles South of Blanco, New Mexico

15. DISTANCE FROM PROPOSED*

LOCATION TO NEAREST
PROPERTY OR LEASE LINE, FT.
(Also to nearest drilg. unit line, if any)

1500'

16. NO. OF ACRES IN LEASE

2480.36

17. NO. OF ACRES ASSIGNED
TO THIS WELL

160

18. DISTANCE FROM PROPOSED LOCATION*

TO NEAREST WELL, DRILLING, COMPLETED,
OR APPLIED FOR, ON THIS LEASE, FT.

19. PROPOSED DEPTH

2400'

20. ROTARY OR CABLE TOOLS

Rotary

21. ELEVATIONS (Show whether DF, RT, GR, etc.)

6362' GR

22. APPROX. DATE WORK WILL START*

April 30, 1980

23.

PROPOSED CASING AND CEMENTING PROGRAM

SIZE OF HOLE	SIZE OF CASING	WEIGHT PER FOOT	SETTING DEPTH	QUANTITY OF CEMENT
9 7/8"	7 5/8" new	20# F-25 ST&C	200'	cement with 100 sacks
6 3/4"	2 7/8" new	6.5# J-55 ST&C	2400'	cement with 200 sacks

1. Drill 9 7/8" hole and set 7 5/8" surface casing to 200' with good returns.
2. Log B.O.P. checks in daily drill reports and drill 6 3/4" hole to 2400'.
3. Run tests if warranted and run 2 7/8" casing if productive.
4. Run logs, as needed, and perforate and stimulate as needed.

EXHIBITS ATTACHED:

- "A" Location and Elevation Plat
- "B" The Ten-Point Compliance Program
- "C" The Blowout Preventer Diagram
- "D" The Multi-Point Requirements for A.P.D.
- "E" & "E₁" Access Road Maps to Location
- "F" Radius Map of Field
- "G" & "G₁" Drill Pad Layout, Production Facilities & Cut-Fill Cross-Section
- "H" Drill Rig Layout

IN ABOVE SPACE DESCRIBE PROPOSED PROGRAM: If proposal is to deepen or plug back, give data on present productive zone and proposed new productive zone. If proposal is to drill or deepen directionally, give pertinent data on subsurface locations and measured and true vertical depths. Give blowout preventer program, if any.

24.

SIGNED

(This space for Federal or State signature)

PERMIT NO.

APPROVED BY

CONDITIONS OF APPROVAL, IF ANY:

TITLE

APPROVAL DATE

DATE

RECEIVED
MAY 15 1980
CONSERVATION DIVISION
SANTA FE

*See Instructions On Reverse Side

**NEW MEXICO OIL CONSERVATION COMMISSION
WELL LOCATION AND ACREAGE DEDICATION PLAT**

Form C-102
Supersedes C-120
Effective 1-1-65

All distances must be from the outer boundaries of the Section.

Operator Supron Energy Corporation			Lease SF-078433 Newsom		Well No. Newsom #23
Unit Letter I	Section 20	Township 26 North	Range 8 West	County San Juan	
Actual Footage Location of Well: 1910 feet from the South line and 1290 feet from the East line					
Ground Level Elev. 6330'	Producing Formation PC		Pool Ballard PC		Dedicated Acreage: 160 Acres

1. Outline the acreage dedicated to the subject well by colored pencil or hachure marks on the plat below.
2. If more than one lease is dedicated to the well, outline each and identify the ownership thereof (both as to working interest and royalty).
3. If more than one lease of different ownership is dedicated to the well, have the interests of all owners been consolidated by communitization, unitization, force-pooling, etc?

☐ Yes ☐ No If answer is "yes," type of consolidation _____

If answer is "no," list the owners and tract descriptions which have actually been consolidated. (Use reverse side of this form if necessary.) _____

No allowable will be assigned to the well until all interests have been consolidated (by communitization, unitization, forced-pooling, or otherwise) or until a non-standard unit, eliminating such interests, has been approved by the Commission.

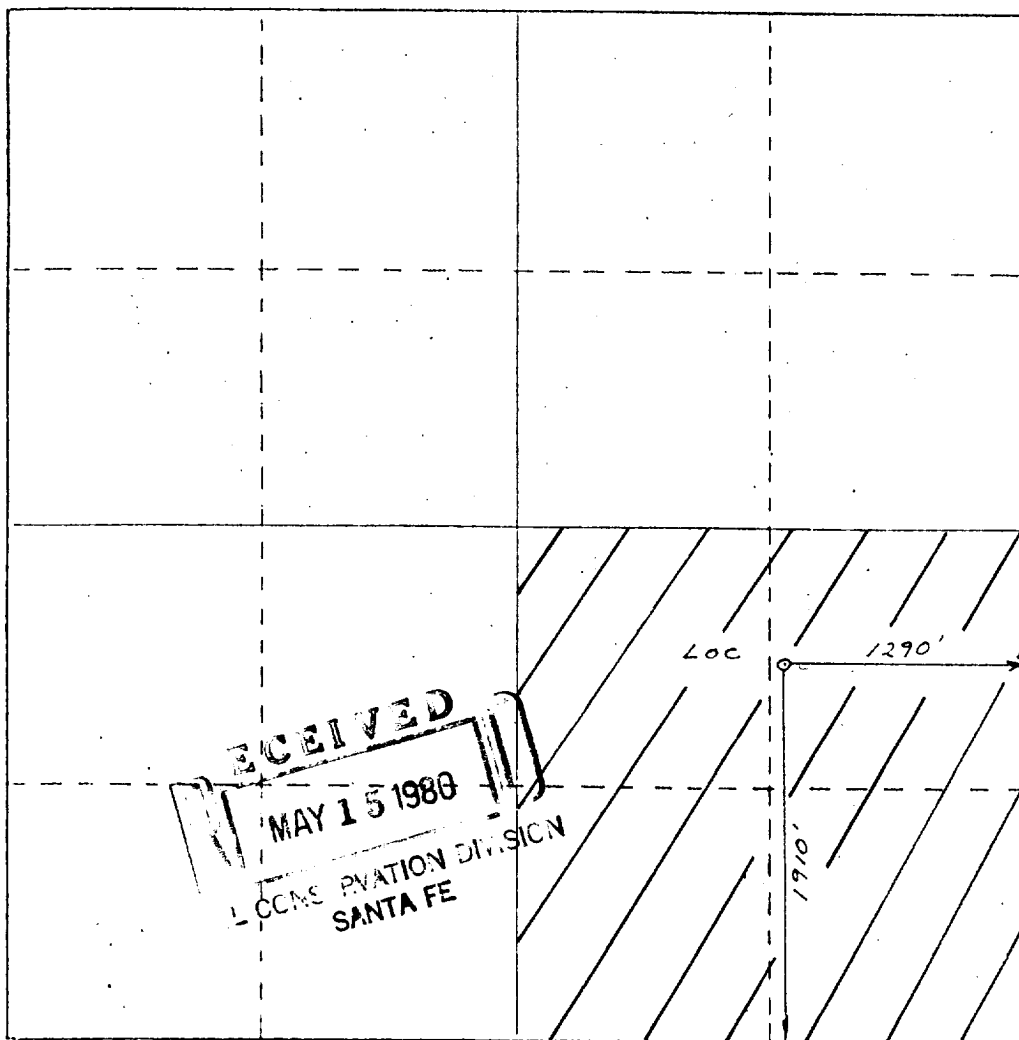

CERTIFICATION

I hereby certify that the information contained herein is true and complete to the best of my knowledge and belief.

Name **George Lapaseotes**
 V. Pres. Powers Elevation
 Position
 Agent Consultant for
 Company
Supron Energy Corporation
 Date
5-12-80

I hereby certify that the well location shown on this plat was plotted from field notes of actual surveys made by me or under my supervision, and that the same is true and correct to the best of my knowledge and belief.

Date Surveyed
5-12-80
 Registered Professional Engineer and or Land Surveyor
68
 Certificate No. **1000**

