

UNITED STATES
DEPARTMENT OF THE INTERIOR
GEOLOGICAL SURVEY

SUBMIT IN TRIPLICATE*
(Other instructions on reverse side)

Form approved.
Budget Bureau No. 42-R1424.

5. LEASE DESIGNATION AND SERIAL NO.

SF-078622

6. IF INDIAN, ALLOTTEE OR TRIBE NAME

7. UNIT AGREEMENT NAME

8. FARM OR LEASE NAME

Lively

9. WELL NO.

17-E

10. FIELD AND POOL, OR WILDCAT

Basin Dakota

11. SEC., T., R., M., OR BLK. AND SURVEY OR AREA

Sec. 1-126N-R8W
N.M.P.M.

12. COUNTY OR PARISH 13. STATE

San Juan NM

SUNDRY NOTICES AND REPORTS ON WELLS

(Do not use this form for proposals to drill or to deepen or plug back to a different reservoir. Use "APPLICATION FOR PERMIT—" for such proposals.)

1. OIL WELL GAS WELL OTHER

2. NAME OF OPERATOR
LIVELY EXPLORATION COMPANY

3. ADDRESS OF OPERATOR
1010 First City National Bank Bldg. Houston, Texas 77002

4. LOCATION OF WELL (Report location clearly and in accordance with any State requirements.* See also space 17 below.)
At surface

2390'FNL, 1270'FEL

14. PERMIT NO. 15. ELEVATIONS (Show whether DF, RT, GR, etc.)
6197'GL

16. Check Appropriate Box To Indicate Nature of Notice, Report, or Other Data

NOTICE OF INTENTION TO:

SUBSEQUENT REPORT OF:

TEST WATER SHUT-OFF PULL OR ALTER CASING
FRACTURE TREAT MULTIPLE COMPLETE
SHOOT OR ACIDIZE ABANDON*
REPAIR WELL CHANGE PLANS
(Other) Change in Location Footage

WATER SHUT-OFF REPAIRING WELL
FRACTURE TREATMENT ALTERING CASING
SHOOTING OR ACIDIZING ABANDONMENT*
(Other)
(NOTE: Report results of multiple completion on Well Completion or Recompletion Report and Log form.)

17. DESCRIBE PROPOSED OR COMPLETED OPERATIONS (Clearly state all pertinent details, and give pertinent dates, including estimated date of starting any proposed work. If well is directionally drilled, give subsurface locations and measured and true vertical depths for all markers and zones pertinent to this work.)*

The location footages are changed as follows:

FROM: 2300'FNL, 1180'FEL
TO: 2390'FNL, 1270'FEL

The change was made due to topographical conditions and to decrease the environmental impact. The change in location moves the location off a solid rock bench.

The original Application for Permit to Drill was approved July 16, 1980.

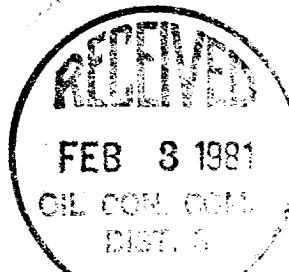

FOR: LIVELY EXPLORATION CO.

18. I hereby certify that the foregoing is true and correct
ORIGINAL SIGNED BY President, Walsh Engr.
SIGNED Ewell N. Walsh, P.E. TITLE & Production Corp. DATE 1/21/81

(This space for Federal or State office use)

APPROVED BY APPROVED TITLE _____ DATE _____
CONDITIONS OF APPROVAL, IF ANY:

JAN 20 1981
Beverly Wamsley
for

NMOCC

*See Instructions on Reverse Side

OIL CONSERVATION DIVISION

STATE OF NEW MEXICO
ENERGY AND MINERALS DEPARTMENT

P. O. BOX 2088
SANTA FE, NEW MEXICO 87501

Form C-102
Revised 10-1-71

All distances must be from the outer boundaries of the Section.

Operator Lively Exploration Company		Lease Lively		Well No. 17-E
Unit Letter H	Section 1	Township 25 North	Range 8 West	County San Juan

Actual Footage Location of Well:
2390 feet from the North line and 1270 feet from the East line

Ground Level Elev. 5197	Producing Formation Dakota	Pool Basin Dakota	Dedicated Acreage: 320 Acres
----------------------------	-------------------------------	----------------------	---------------------------------

1. Outline the acreage dedicated to the subject well by colored pencil or hachure marks on the plat below.
2. If more than one lease is dedicated to the well, outline each and identify the ownership thereof (both as to working interest and royalty).
3. If more than one lease of different ownership is dedicated to the well, have the interests of all owners been consolidated by communitization, unitization, force-pooling, etc?

Yes No If answer is "yes," type of consolidation _____

If answer is "no," list the owners and tract descriptions which have actually been consolidated. (Use reverse side of this form if necessary.) _____

No allowable will be assigned to the well until all interests have been consolidated (by communitization, unitization, forced-pooling, or otherwise) or until a non-standard unit, eliminating such interests, has been approved by the Division.

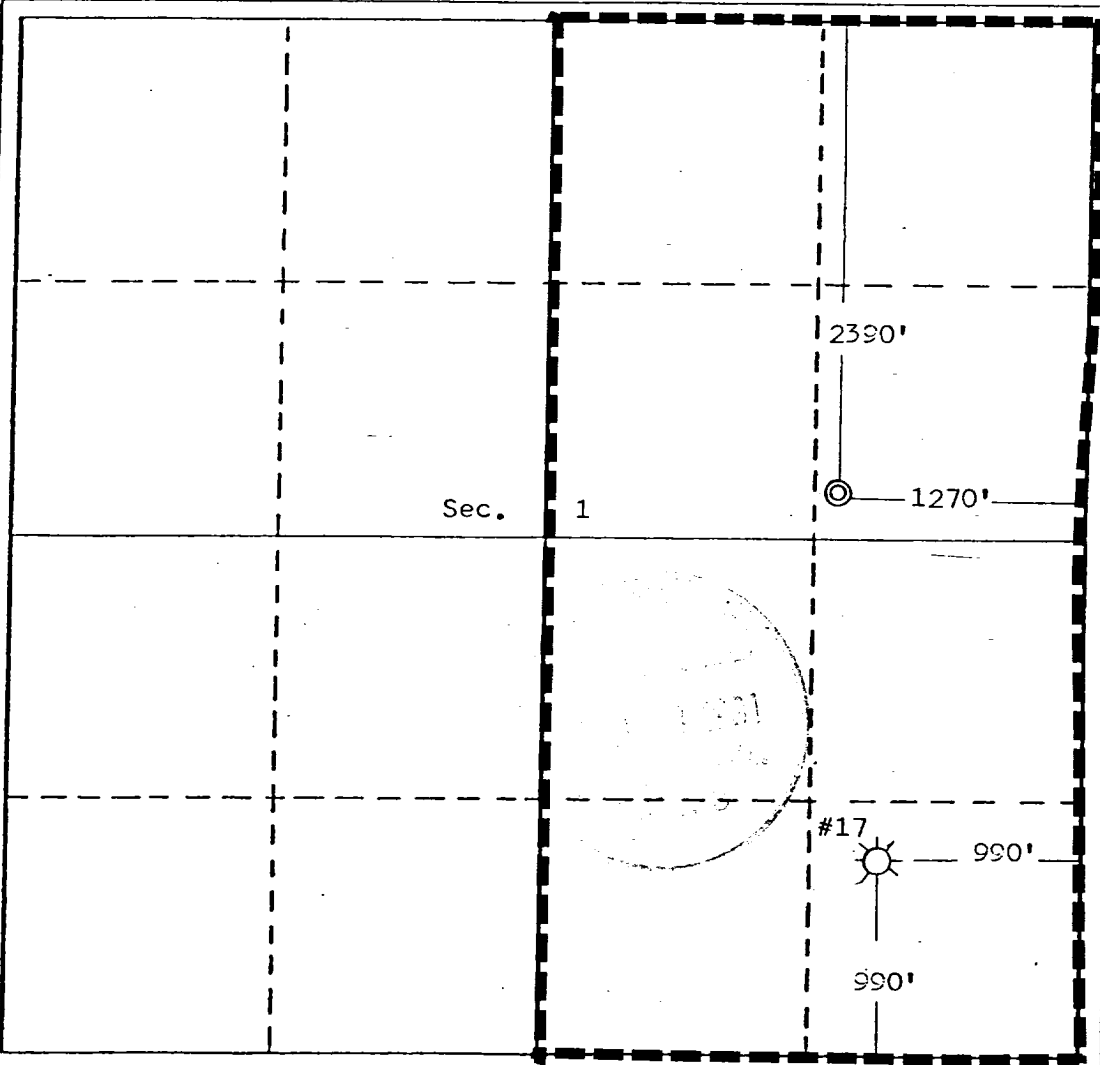

CERTIFICATION

I hereby certify that the information contained herein is true and complete to the best of my knowledge and belief.

For: **LIVELY EXPLORATION CO.**
ORIGINAL SIGNED BY
EWELL N. WALSH

Name	Ewell N. Walsh, P.E.
Position	President
Company	Walsh Engr. & Prod. Corp.
Date	1/21/81

I hereby certify that the location shown on this plat was made by me or under my supervision, and that the same is correct to the best of my knowledge and belief.

EDGAR L. RISENHOOVER
REGISTERED LAND SURVEYOR
NEW MEXICO
5979

Date Surveyed	January 8, 1981
Registered Professional Engineer and/or Land Surveyor	<i>Edgar L. Risenhoover</i>
Certificate No.	5979
	Edgar L. Risenhoover, L.S.

