

UNITED STATES
DEPARTMENT OF THE INTERIOR
GEOLOGICAL SURVEY

APPLICATION FOR PERMIT TO DRILL, DEEPEN, OR PLUG BACK

1a. TYPE OF WORK

DRILL ☒DEEPEN ☐PLUG BACK ☐

b. TYPE OF WELL

OIL
WELL ☐GAS
WELL ☒OTHER ☐SINGLE
ZONE ☐MULTIPLE
ZONE ☐

2. NAME OF OPERATOR

Jerome P. McHugh

3. ADDRESS OF OPERATOR

Box 208, Farmington, NM 87401

4. LOCATION OF WELL (Report location clearly and in accordance with any State requirements.)*
At surface

1150' FNL - 190' FEL

At proposed prod. zone

14. DISTANCE IN MILES AND DIRECTION FROM NEAREST TOWN OR POST OFFICE*

20 miles south of Bloomfield, NM

15. DISTANCE FROM PROPOSED*

LOCATION TO NEAREST
PROPERTY OR LEASE LINE, FT.
(Also to nearest drlg. unit line, if any)

190'

18. DISTANCE FROM PROPOSED LOCATION*
TO NEAREST WELL, DRILLING, COMPLETED,
OR APPLIED FOR, ON THIS LEASE, FT.

100'

16. NO. OF ACRES IN LEASE

638.36'

17. NO. OF ACRES ASSIGNED
TO THIS WELL

160 / 59.32

19. PROPOSED DEPTH OF WELL, FT.
20. STARTY OR CABLE TOOLS

1250'

21. ELEVATIONS (Show whether DF, RT, GR, etc.)

5962' GL

23.

PROPOSED CASING AND CEMENTING PROGRAM

SIZE OF HOLE	SIZE OF CASING	WEIGHT PER FOOT	SETTING DEPTH	QUANTITY OF CEMENT
8-3/4"	7"	14#	90'	35 sx (circulate)
6-1/4"	4-1/2"	9.5#	1145'	50 sx

Plan to drill 6-1/4" hole to 1145' and set 4-1/2" csg. above Fruitland Formation.
Plan to drill 3-7/8" hole w/air and test Fruitland Formation in open hole. If
productive, plan to run tbq and complete well.

Plan to use 3000 psi BOP per attached schematic diagram. Will use master valve
and stripper head while completing well.

NMRB: Gas dedicated.

APPROVED
AS AMENDED

SEP 12 1980

JAMES F. SIMS
DISTRICT ENGINEER

IN ABOVE SPACE DESCRIBE PROPOSED PROGRAM: If proposal is to deepen or plug back, give data on present productive zone and proposed new productive zone. If proposal is to drill or deepen directionally, give pertinent data on subsurface locations and measured and true vertical depths. Give blowout preventer program, if any.

24.

SIGNED

Sherman E. Dugan

TITLE Agent

DATE 8-13-80

(This space for Federal or State office use)

PERMIT NO.

APPROVAL DATE

APPROVED BY

TITLE

DATE

CONDITIONS OF APPROVAL, IF ANY:

*See Instructions On Reverse Side

NM000

NEW MEXICO OIL CONSERVATION COMMISSION
WELL LOCATION AND ACREAGE DEDICATION PLAT

Form C-102
Supersedes C-128
Effective 1-1-65

All distances must be from the outer boundaries of the Section.

Operator Jerome P. McHugh		Lease Bengal		Well No. #3-R
Unit Letter A	Section 2	Township 26N	Range 12W	County San Juan
Actual Footage Location of Well: 1150' feet from the North line and 190' feet from the East line				
Ground Level Elev. 5962'	Producing Formation Fruitland	Pool South Gallegos	Dedicated Acreage: 159.32 - 160 Acres	

1. Outline the acreage dedicated to the subject well by colored pencil or hachure marks on the plat below.
2. If more than one lease is dedicated to the well, outline each and identify the ownership thereof (both as to working interest and royalty).
3. If more than one lease of different ownership is dedicated to the well, have the interests of all owners been consolidated by communitization, unitization, force-pooling, etc?

☐ Yes ☐ No If answer is "yes," type of consolidation _____

If answer is "no," list the owners and tract descriptions which have actually been consolidated. (Use reverse side of this form if necessary.) _____

No allowable will be assigned to the well until all interests have been consolidated by communitization, unitization, forced-pooling, or otherwise) or until a non-standard unit, eliminating such interests, has been approved by the Commission.

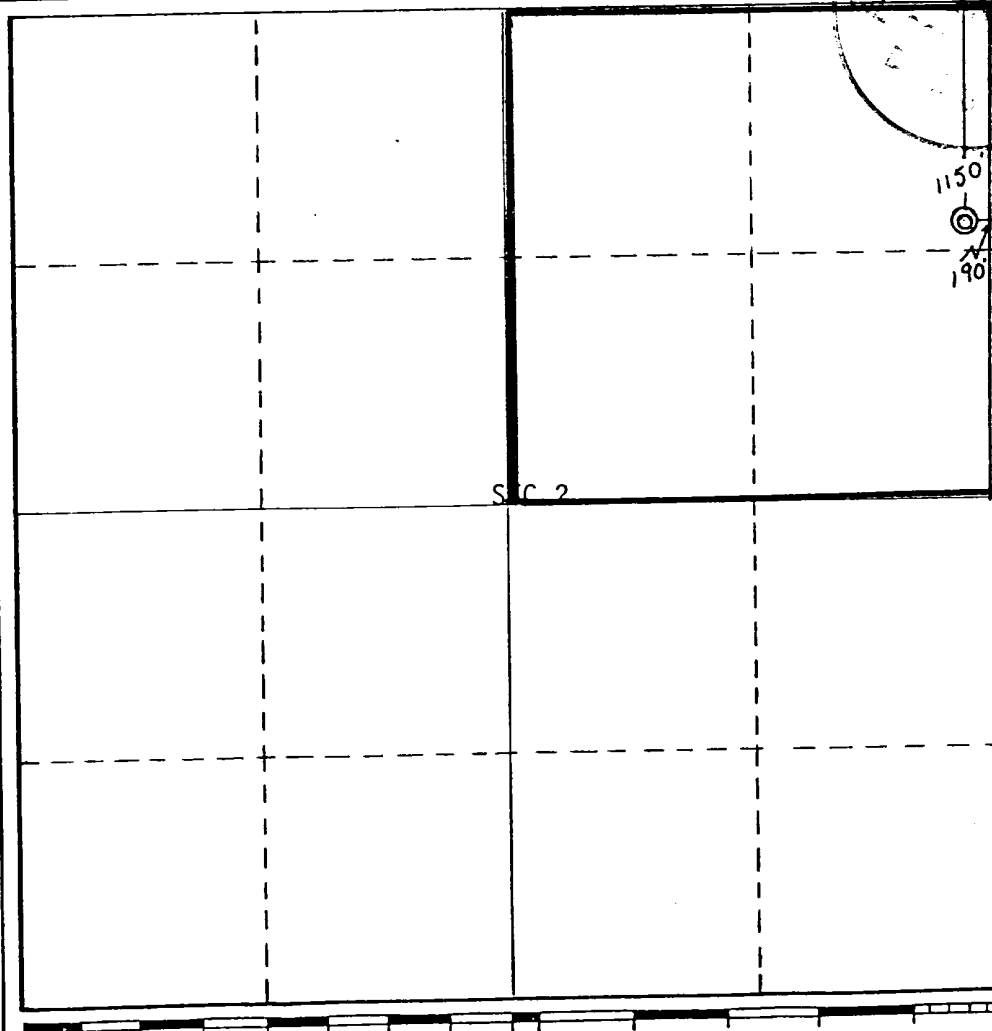

CERTIFICATION

I hereby certify that the information contained herein is true and complete to the best of my knowledge and belief.

Name
Sherman E. Dugan

Position
Agent

Company
Jerome P. McHugh

Date
8-13-80

I hereby certify that the well location shown on this plat was plotted from field notes of actual surveys made by me or under my supervision, and that the same is true and correct to the best of my knowledge and belief.

Date Surveyed
August 11, 1980

Registered Professional Engineer and/or Land Surveyor

Certificate No.

2772

Jerome P. McHugh
Bengal B #3R

PROPOSED LOCATION LAYOUT

N
↑

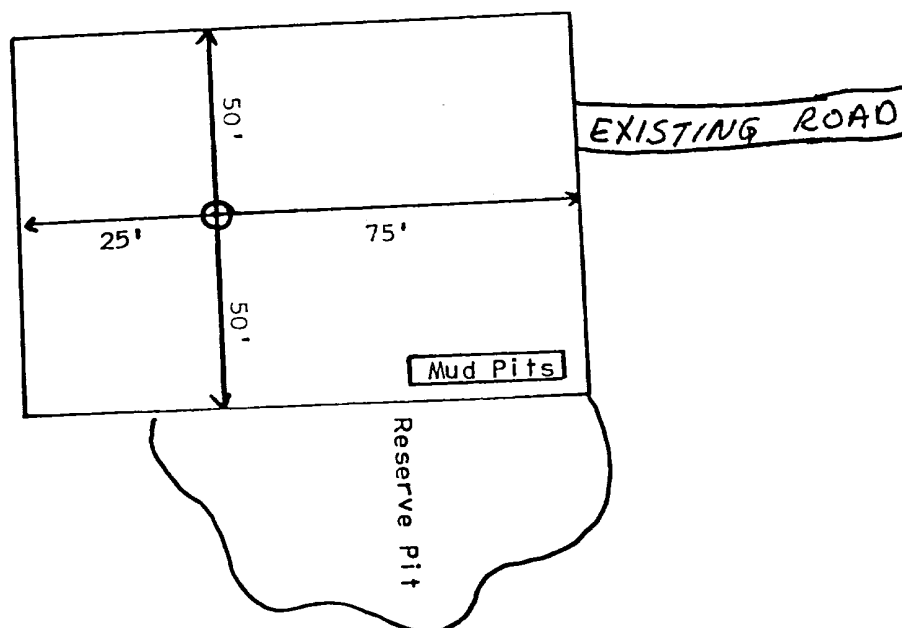

SCHEMATIC DIAGRAM

TESTING PROCEDURES

Install BOP after setting surface pipe and pressure test to 1000 psi after drilling out from under surface pipe.

REGAN BLOWOUT PREVENTERS

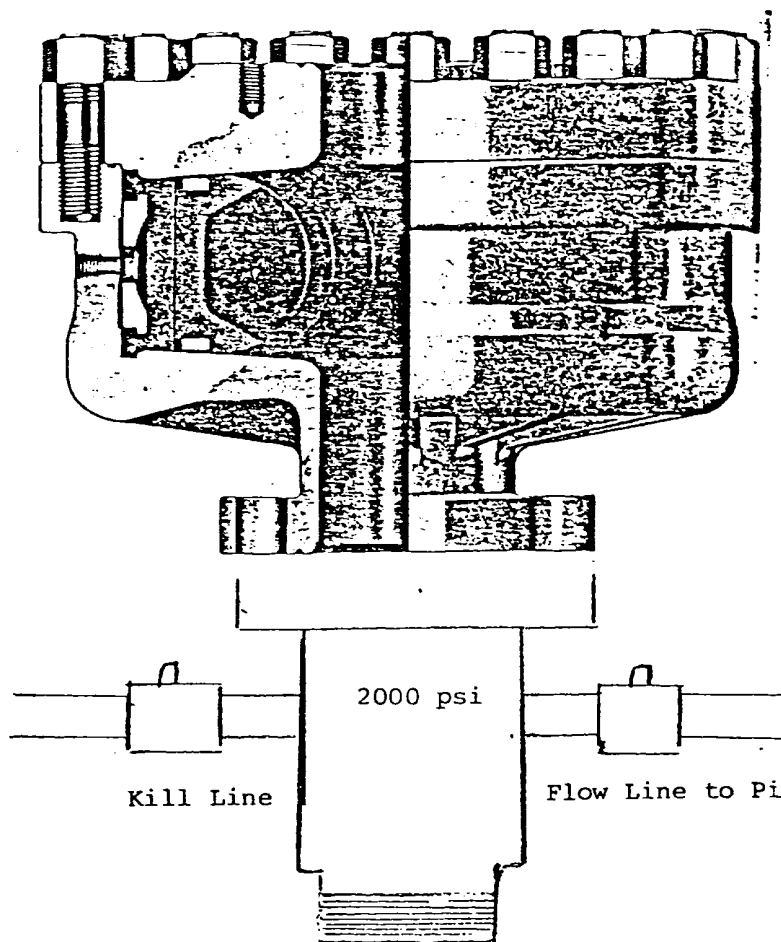

The Regan Torus Blowout Preventer is used primarily on production and workover rigs for well control up to 3000 PSI working pressure

DESIGN FEATURES

- a. The Torus Preventer is designed for minimum height to facilitate its use with production and workover rigs.
- b. The rubber packer will conform to any object in the well bore. Sealing ability is not affected by minor damage to the inner bore.
- c. The packer will seal on open hole at full working pressure.
- d. The dual packer design increases the reliability of the preventer since the outer rubber is never exposed to the well bore. Under ordinary service, the outer packer is rarely replaced.

TORUS BLOWOUT PREVENTER PATENTED

SPECIFICATIONS

Nominal Size	Test Pressure (psi)	DIMENSIONS (in.)			Weight (lb.)	End Flanges (I)	R/RX Ring Grooves	Side Outlet
		Outside Diameter	Thru Bore	Overall Height				
6	3000 6000	27 28 1/2	7 1/8 7 1/8	19 1/4 21 1/4	1360 1950	Nom. 6 Nom. 6	45 45	None 2" L.P.

OPERATIONS PLAN

OPERATOR: Jerome P. McHugh
WELL NAME: Bengal B #3R
FIELD: South Gallegos Fruitland
LOCATION: 1150' FNL - 190' FEL Sec 2 T26N R12W San Juan County, NM
ELEVATION: 5962' GL

EXPECTED FORMATION TOPS:	Ojo Alamo 200'	Point Lookout
	Kirtland 320'	Mancos
	Fruitland 1066'	Gallup
	Pictured Cliffs	Greenhorn
	Lewis	Graneros
	Cliff House	Dakota
	Menefee	Total Depth 1250'

LOGGING PROGRAM: IES

SAMPLES: Catch samples in 10' intervals beginning at 975'

CASING PROGRAM

<u>Hole Size</u>	<u>Depth</u>	<u>Csg Size, Wt, Grade, & Condition</u>	<u>Cementing Program</u>
8-3/4"	90'	7" 14# J-55 "B"	Cement to surface w/35 sx neat cement. Circulate to surface.
6-1/4"	1145'	4-1/2" 9.5# J 55 "B"	Cement casing string w/50 sx cement w/4% gel.

Plan to drill w/air below casing point to TD.

WELLHEAD EQUIPMENT

1000# working pressure, screwed, non-flanged, new

Office	-	325-0238
Tom Dugan		325-5694
Jim Jacobs		325-8353
Sherman Dugan		327-4287
Bill Donovan		325-5692
James Hazen		

DEVELOPMENT PLAN

JEROME P. McHUGH

Bengal B #3R

1. Existing roads and existing wells are shown on attached plat.
2. Planned access from existing road approximately 0' to new location. Will leave natural grass and small vegetation on roadway. Will remove large brush or trees from road. Do not plan to make road grade or bar ditches. Will bottom-out any arroyo we cross and not install culverts.
3. Location of well: 1150' FNL - 190' FEL
Sec 2 T26N R12W
San Juan County, NM
4. No additional well(s) planned on this lease at this time.
5. Separator and flow line will be located within 50' of wellhead.
6. Water will be secured from Chaco Plant San Juan River.
7. Waste materials will be buried on location or in reserve pit.
8. No permanent camp is planned; trailer house will be used on location while drilling.
9. Do not plan to build airstrip.
10. See attached plat for proposed location layout.
11. A general description of the topography, soil characteristics, geologic features, flora and fauna; other surface-use activities and surface ownership of involved lands, proximity of water, occupied dwellings, archeological, historical or cultural sites can be found in the archeologist's report.
12. Geologic name of surface formation: Undifferentiated Tertiary
13. Estimated tops of important geologic markers:
See Attached Operations Plan
14. Estimated depths of anticipated water, oil, gas, or other mineral bearing formations which are expected to be encountered: Ojo Alamo - 200' - water
Fruitland - 1066' - gas no oil anticipated
15. We do not anticipate to encounter any abnormal pressures or temperatures or any potential hazards such as those associated with hydrogen sulfide.
16. Will clean up location, fill and level pits, level ruts in road, reseed location and road with Seed Mixture #2 and paint equipment with Sandstone Brown.
17. Operator's Representative:
Sherman E. Dugan
Box 208
Farmington, NM 87401
18. Certification: The following statement must be signed by the lessee's or operator's field representative who is identified in Item #17 of the Plan:

I hereby certify that I, or persons under my direct supervision, have inspected the proposed drillsite and access route; that I am familiar with the conditions which presently exist; that the statements made in this Plan are, to the best of my knowledge, true and correct; and, that the work associated with the operations proposed herein will be performed by Jerome P. McHugh and its contractors and subcontractors in conformity with this Plan and the terms and conditions under which it is approved.

Date: 8-13-80

Agent

