

District I
P.O. Box 1980, Hobbs, NM
District II
P.O. Drawer DD, Artesia, NM 88211
District III
000 Rio Brazos Rd, Aztec, NM 87410

State of New Mexico
Energy, Minerals and Natural Resources Department

OIL CONSERVATION DIVISION
P.O. Box 2089
Santa Fe, New Mexico 87504-2089

SEP - UK
Dehy-R&K
non-volatile
RECEIVED
OCT 21 1999
DIST. 3
BK 305
SUBMIT 1 COPY TO
APPROPRIATE
DISTRICT OFFICE
AND 1 COPY TO
SANTA FE OFFICE

PIT REMEDIATION AND CLOSURE REPORT

Operator: R. C. RESOURCES COMPANY INC. Telephone: (505) 326-6903

Address: 501 AIRPORT DR., SUITE 161, FARMINGTON, NEW MEXICO 87499

Facility Or: NEWSOM B 10E
Well Name

Location: Unit or Qtr/Qtr Sec P Sec 8 T26N R8W County SAN JUAN

Pit Type: Separator ☒ Dehydrator ☐ Other ☐

Land Type: BLM ☒, State ☐, Fee ☐, Other ☐

Pit Location: Pit dimensions: length 18', width 19', depth 7'
(Attach diagram) Reference: wellhead ☒, other ☐

Footage from reference: 114'

Direction from reference: 56 Degrees ☒ East North ☐
of. ☐ West South ☒

Depth To Ground Water:
(Vertical distance from
contaminants to seasonal
high water elevation of
ground water)

Less than 50 feet (20 points)
50 feet to 99 feet (10 points) 0
Greater than 100 feet (0 Points)

Wellhead Protection Area:
(Less than 200 feet from a private
domestic water source, or; less than
1000 feet from all other water sources)

Yes (20 points)
No (0 points) 0

Distance To Surface Water:
(Horizontal distance to perennial
lakes, ponds, rivers, streams, creeks,
irrigation canals and ditches)

Less than 200 feet (20 points)
200 feet to 1000 feet (10 points) 0
Greater than 1000 feet (0 points)

RANKING SCORE (TOTAL POINTS) 0

Date Remediation Started: _____ Date Completed: 8/7/95

Remediation Method: Excavation ☒ Approx. cubic yards 50
 (Check all appropriate sections) Landfarmed ☒ Insitu Bioremediation _____
 other _____

Remediation Location: Onsite ☒ Offsite _____
 (ie. landfarmed onsite, name and location of offsite facility)

General Description of Remedial Action: _____

Excavation

Ground Water Encountered: No ☒ Yes _____ Depth _____

Final Pit:

Closure Sampling:

(if multiple samples, attach sample results and diagram of sample locations and depths)

Sample location see Attached Documents

Sample depth 7'

Sample date 8/7/95

Sample time 0910

Sample Results

Benzene(ppm) _____

Total BTEX(ppm) _____

Field headspace(ppm) 1.0

TPH 68 ppm

Ground Water Sample: Yes _____ No ☒ (If yes, attach sample results)

I HEREBY CERTIFY THAT THE INFORMATION ABOVE IS TRUE AND COMPLETE TO THE BEST OF MY KNOWLEDGE AND BELIEF

DATE 8/7/95

SIGNATURE

PRINTED NAME
AND TITLE

Robert R. Clark - President

BLAGG ENGINEERING, INC.
P.O. Box 87, Bloomfield, New Mexico 87413
Phone: (505)632-1199 Fax: (505)632-3903

**FIELD MODIFIED EPA METHOD 418.1
TOTAL PETROLEUM HYDROCARBONS**

Client: R.R. CLICK
Sample ID: 5 @ 7'
Project Location: Newsom B 10E
Laboratory Number: TPH-1559

Project #:
Date Analyzed: 08-07-95
Date Reported: 08-07-95
Sample Matrix: Soil

Parameter	Result, mg/kg	Detection Limit, mg/kg
-----	-----	-----
Total Recoverable Petroleum Hydrocarbons	68	20

ND = Not Detectable at stated detection limits.

QA/QC:	QA/QC Sample TPH mg/kg	Duplicate TPH mg/kg	% *Diff.
	-----	-----	-----
	1040	956	8.42

* Administrative Acceptance limits set at 30%.

Method: Modified Method 418.1, Petroleum Hydrocarbons, Total
Recoverable, Chemical Analysis of Water and Waste,
USEPA Storet No.4551, 1978

Comments: Separator Pit - BR305

Analyst

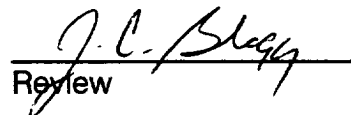
Review

000 Rio Brazos Rd, Aztec, NM 87410

Santa Fe, New Mexico 87504-2088

BK 505
SUBMIT 1 COPY TO
APPROPRIATE
DISTRICT OFFICE
AND 1 COPY TO
SANTA FE OFFICE

RANKING SCORE (TOTAL POINTS) :

Date Remediation Started: _____

Date Completed: 8/8/95Remediation Method: Excavation ☒
(Check all appropriate sections)Approx. cubic yards 300Landfarmed ☒

Insitu Bioremediation _____

Other _____

Remediation Location: onsite ☒ offsite _____
(ie. landfarmed onsite,
name and location of
offsite facility)

General Description of Remedial Action: _____

Excavation

Ground Water Encountered: _____

No ☒

Yes _____

Depth _____

Final Pit:

Closure Sampling:

(if multiple samples,
attach sample results
and diagram of sample
locations and depths)Sample location see Attached DocumentsSample depth 18'Sample date 8/8/95Sample time 0745

Sample Results

Benzene(ppm) _____

Total BTEX(ppm) _____

Field headspace(ppm) 796TPH 15,100 ppmGround Water Sample: Yes _____ No ☒ (If yes, attach sample results)

I HEREBY CERTIFY THAT THE INFORMATION ABOVE IS TRUE AND COMPLETE TO THE BEST OF MY KNOWLEDGE AND BELIEF

DATE 8/8/95

SIGNATURE

PRINTED NAME
AND TITLERobert R. Clark - President

Well Name:	Newsom B 10E
Well Site location:	Unit P, Sec. 8, T26N, R8W
Pit Type:	Dehydrator Pit
Producing Formation:	Basin Dakota
Pit Category:	Non Vulnerable
Horizontal Distance to Surface Water:	> 1000 ft.
Vicinity Groundwater Depth:	> 100 ft.

RISK ASSESSMENT (non-vulnerable area)

Pit remediation activities were terminated when trackhoe reached practical extent for abandoned pit at 18 ft. below grade and for safety concerns (sloughing soils).

No past or future threat to surface water or groundwater is likely based on the following considerations:

1. Groundwater levels located on or close to the well pad are estimated to be at a much greater depth below presumed shallow sandstone bedrock (based on informal site observation of adjacent sandstone outcrop).
2. Topographic information does not indicate off site lateral fluid migration near the earthen pit.
3. Daily discharge into the earthen pit has been terminated (pit abandoned). Prior discharge into the pit is believed to be under 5 barrels per day.
4. Well site located within the **non-vulnerable area** and is approximately 1.0 mile east of the nearest vulnerable area boundary (Blanco wash).

(Refer to Thompson Mesa Quadrangle, New Mexico - San Juan County, 7.5 Minute Series (Topographic), provisional edition 1985, (vulnerable area boundary developed by Mr. William C. Olson, Hydrogeologist, Environmental Bureau, New Mexico Oil Conservation Division).

Based upon the information given, we conclude that the subsurface vertical and lateral contamination is limited and impact to groundwater is very unlikely. R.C. Resources requests pit closure approval on this location.

CLIENT: R.R. CLICKBLAGG ENGINEERING, INC.
P.O. BOX 87, BLOOMFIELD, NM 87413
(505) 632-1199LOCATION NO: 82305

C.D.C. NO: _____

FIELD REPORT: CLOSURE VERIFICATION

PAGE No: 1 of 1LOCATION: NAME: NEWSOM B WELL #: 10E PIT: DEHY
QUAD/UNIT: P SEC: 8 TWP: 26N RNG: 8W PM: NM CNTY: SJ ST: NM
QTR/FOOTAGE: 820' FSL | 1055' FEL CONTRACTOR: EPCDATE STARTED: 8/8/95

DATE FINISHED: _____

ENVIRONMENTAL
SPECIALIST: NVEXCAVATION APPROX. 24 FT. x 21 FT. x 17 FT. DEEP. CUBIC YARDAGE: 300DISPOSAL FACILITY: ON-SITE REMEDIATION METHOD: LANDFARMEDLAND USE: RANGE LEASE: 5F - 078384 FORMATION: OKFIELD NOTES & REMARKS: PIT LOCATED APPROXIMATELY 140 FT. N55E FROM WELLHEAD.DEPTH TO GROUNDWATER: 2100' NEAREST WATER SOURCE: >1000' NEAREST SURFACE WATER: >1000'NMOC D RANKING SCORE: 0 NMOC D TPH CLOSURE STD: 5000 PPM

CHECK ONE:

☒ PIT ABANDONED☐ STEEL TANK INSTALLED

SOIL AND EXCAVATION DESCRIPTION:

SOIL COLOR VARYING FROM GRAYISH ORANGE (NORTH SIDEWALL), DK. YELL. ORANGE (WEST SIDEWALL),
MD. YEL. BROWN (SOUTH SIDEWALL), OLIVE GRAY (EAST SIDEWALL), LT. OLIVE GRAY (BOTTOM)
SAND, NON-COHESIVE, SLIGHTLY MOIST, FIRM, STRONG HC ODOR IN ALL OVM
SAMPLES EXCEPT NORTH SIDEWALL.

CONDITIONAL

FIELD 418.1 CALCULATIONS

TIME	SAMPLE I.D.	LAB No:	WEIGHT (g)	mL. FREON	DILUTION	READING	CALC. ppm
0745	⑤ @ 18'	TPH-1560	5	20	10:1	378	15,120
"	DUPLICATE	"	"	"	"	399	15,960

SCALE



0 FT

PIT PERIMETER

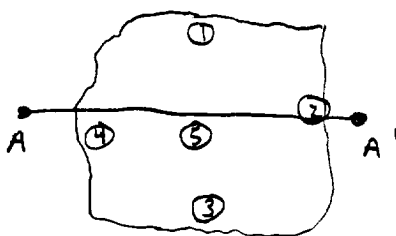
OVM
RESULTS

SAMPLE ID	FIELD HEADSPACE PID (ppm)
1 @ 10'	0.0
2 @ 13'	788
3 @ 12'	790
4 @ 12'	513
5 @ 18'	796

LAB SAMPLES

SAMPLE ID	ANALYSIS	TIME

PIT PROFILE

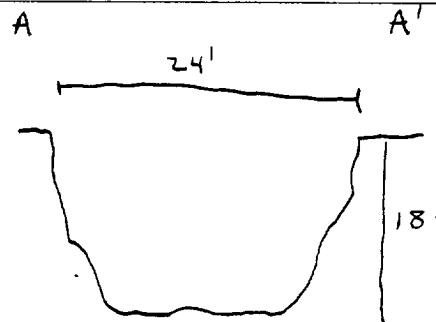

TRAVEL NOTES:

CALLOUT: 8/7/95 AFTER. ONSITE: 8/8/95 MORN.

BLAGG ENGINEERING, INC.

P.O. Box 87, Bloomfield, New Mexico 87413

Phone: (505)632-1199 Fax: (505)632-3903

**FIELD MODIFIED EPA METHOD 418.1
TOTAL PETROLEUM HYDROCARBONS**

Client: R.R. CLICK
Sample ID: 5 @ 18'
Project Location: Newsom B 10E
Laboratory Number: TPH-1560

Project #:
Date Analyzed: 08-08-95
Date Reported: 08-08-95
Sample Matrix: Soil

Parameter	Result, mg/kg	Detection Limit, mg/kg
-----	-----	-----
Total Recoverable Petroleum Hydrocarbons	15,100	200

ND = Not Detectable at stated detection limits.

QA/QC:	QA/QC Sample TPH mg/kg	Duplicate TPH mg/kg	% *Diff.
	-----	-----	-----
	15120	15960	5.41

*Administrative Acceptance limits set at 30%.

Method: Modified Method 418.1, Petroleum Hydrocarbons, Total
Recoverable, Chemical Analysis of Water and Waste,
USEPA Storet No.4551, 1978

Comments: Dehydrator Pit - BR305

Analyst

Review

CLIENT: <u>RC RESOURCES</u>	BLAGG ENGINEERING, INC. P.O. BOX 87, BLOOMFIELD, NM 87413 (505) 632-1199	LOCATION NO: <u>B2305</u> C.O.C. NO: <u>7095</u>
-----------------------------	--	---

FIELD REPORT: LANDFARM/COMPOST PILE CLOSURE VERIFICATION

LOCATION: NAME: <u>NEWSOM B</u> WELL #: <u>10E</u> PITS: <u>SEP, DEHY</u> QUAD/UNIT: <u>P</u> SEC: <u>B</u> TWP: <u>26N</u> RNG: <u>BW</u> PM: <u>NM</u> CNTY: <u>SJ</u> ST: <u>NM</u> QTR/FOOTAGE: <u>8205-1055E</u> CONTRACTOR: <u>EPC</u>	DATE STARTED: <u>8.3.99</u> DATE FINISHED: <u>8.4.99</u> ENVIRONMENTAL SPECIALIST: <u>REP</u>
--	---

SOIL REMEDIATION:

REMEDICATION SYSTEM: <u>LANDFARM</u>	APPROX. CUBIC YARDAGE: <u>350</u>
LAND USE: <u>RANGE</u>	LIFT DEPTH (ft): <u>1.5</u>

FIELD NOTES & REMARKS:

DEPTH TO GROUNDWATER: >100' NEAREST WATER SOURCE: >1000' NEAREST SURFACE WATER: >1000'

NMOCB RANKING SCORE: 0 NMOCB TPH CLOSURE STD: 5000 PPM

MODERATE YELLOWISH BROWN SAND. NON COHESIVE, SLIGHTLY MOIST, FIRM.
 NO APPARENT STAINING, HC. ODOR DETECTED IN SAMPLING PTS. ①, ③+⑤
 SAMPLING DEPTHS RANGE FROM 6"-10", COLLECTED A SPT. COMPOSITE
 SAMPLE FOR LAB ANALYSIS.

FIELD 418.1 CALCULATIONS

SAMP. TIME	SAMPLE I.D.	LAB No:	WEIGHT (g)	mL. FREON	DILUTION	READING	CALC. ppm

SKETCH/SAMPLE LOCATIONS

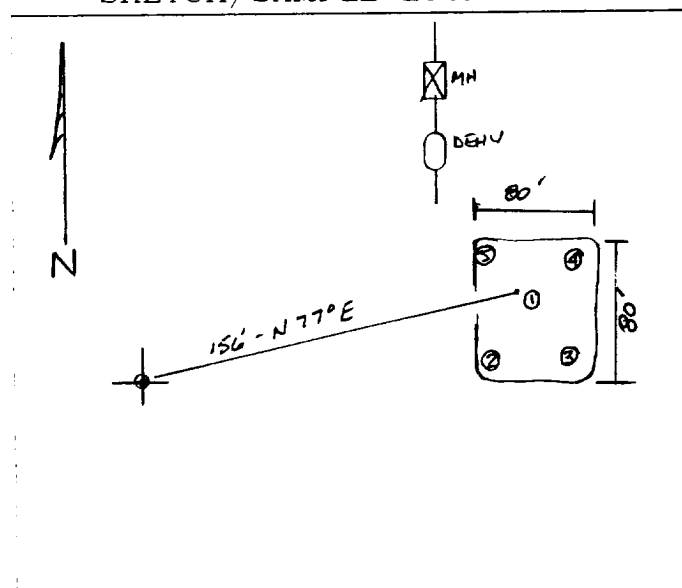

OVM RESULTS

LAB SAMPLES

SAMPLE ID	FIELD HEADSPACE PID (ppm)	SAMPLE ID	ANALYSIS	TIME	RESULTS
LF-1	5.7	LF-1	TPH (8015)	1000	45.0

SCALE



TRAVEL NOTES: CALLOUT: NA ONSITE: 8.3.99

ENVIROTECH LABS

PRACTICAL SOLUTIONS FOR A BETTER TOMORROW

EPA METHOD 8015 Modified Nonhalogenated Volatile Organics Total Petroleum Hydrocarbons

Client:	Blagg / R C Resources	Project #:	403410
Sample ID:	LF - 1	Date Reported:	08-04-99
Laboratory Number:	F810	Date Sampled:	08-03-99
Chain of Custody No:	7095	Date Received:	08-03-99
Sample Matrix:	Soil	Date Extracted:	08-04-99
Preservative:	Cool	Date Analyzed:	08-04-99
Condition:	Cool and Intact	Analysis Requested:	8015 TPH

Parameter	Concentration (mg/Kg)	Det. Limit (mg/Kg)
Gasoline Range (C5 - C10)	1.5	0.2
Diesel Range (C10 - C28)	43.5	0.1
Total Petroleum Hydrocarbons	45.0	0.2

ND - Parameter not detected at the stated detection limit.

References: Method 8015B, Nonhalogenated Volatile Organics, Test Methods for Evaluating Solid Waste, SW-846, USEPA, December 1996.

Comments: **Newsom B 10E 5 Pt. Composite.**

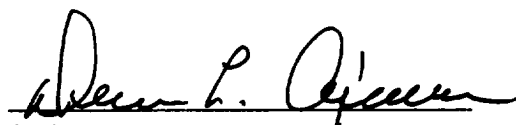
Analyst

Review

7095

[illegible]