

UNITED STATES
DEPARTMENT OF THE INTERIOR
GEOLOGICAL SURVEY

30-095-25435

APPLICATION FOR PERMIT TO DRILL, DEEPEN, OR PLUG BACK

1a. TYPE OF WORK

DRILL ☒DEEPEN ☐PLUG BACK ☐

b. TYPE OF WELL

OIL
WELL ☐GAS
WELL ☒

OTHER

SINGLE
ZONE ☐MULTIPLE
ZONE ☐

2. NAME OF OPERATOR

Gulf Oil Corporation

3. ADDRESS OF OPERATOR

P. O. Box 670, Hobbs, NM 88240

4. LOCATION OF WELL (Report location clearly and in accordance with any State requirements.)

At surface

1850' FNL & 1850' FEL

At proposed prod. zone

14. DISTANCE IN MILES AND DIRECTION FROM NEAREST TOWN OR POST OFFICE*

23 miles southwest of Bloomfield, NM

16. DISTANCE FROM PROPOSED*
LOCATION TO NEAREST
PROPERTY OR LEASE LINE, FT.
(Also to nearest drig. unit line, if any)18. DISTANCE FROM PROPOSED LOCATION*
TO NEAREST WELL, DRILLING, COMPLETED,
OR APPLIED FOR, ON THIS LEASE, FT.

1110'

16. NO. OF ACRES IN LEASE

160

19. PROPOSED DEPTH

650'

17. NO. OF ACRES ASSIGNED
TO THIS WELL

160

20. ROTARY OR CABLE TOOLS

Rotary

21. ELEVATIONS (Show whether DF, RT, GR, etc.)

6043' GL

22. APPROX. DATE WORK WILL START

8-15-82

23.

PROPOSED CASING AND CEMENTING PROGRAM

SIZE OF HOLE	SIZE OF CASING	WEIGHT PER FOOT	SETTING DEPTH	QUANTITY OF CEMENT
8-3/4"	7"	17#	90'	100 sx - circ
6 1/2"	2-7/8"	6.5#	650'	200 sx - circ

Mud Program:

0' - 90'
90' - 650'Fresh water spud mud
Fresh water spud mud

See attached BOP Drawing #2

Gas Is Not Dedicated

IN ABOVE SPACE DESCRIBE PROPOSED PROGRAM: If proposal is to deepen or plug back, give data on present productive zone and proposed new production zone. If proposal is to drill or deepen directionally, give pertinent data on subsurface locations and measured and true vertical depths. Give blowout preventer program if any.

24.

SIGNED

R.C. Anderson

TITLE

Area Production Manager

DATE

7-21-82

(This space for Federal or State office use)

PERMIT NO.

APPROVAL DATE

APPROVED BY

TITLE

DATE

CONDITIONS OF APPROVAL, IF ANY:

*See Instructions On Reverse Side

NMOC



AUG 16 1982

NEW MEXICO OIL CONSERVATION COMMISSION
WELL LOCATION AND ACREAGE DEDICATION PLAT

Form O-104
Supersedes C-172
Effective 1-1-65

All distances must be from the outer boundaries of the Section.

Operator GULF OIL CO.			Lease SAN JUAN "S" FED. COMM.		Well No. #2
Unit Letter G	Section 32	Township 26 NORTH	Range 12 WEST	County San Juan County	
Actual Footage Location of Well: 1850 feet from the NORTH line and 1850 feet from the EAST line					
Ground Level Elev. 8043	Producing Formation Farmington		Pool Bisti Farmington		Dedicated Acreage: 160 Acres

1. Outline the acreage dedicated to the subject well by colored pencil or hatchure marks on the plat below.
2. If more than one lease is dedicated to the well, outline each and identify the ownership thereof (both as to working interest and royalty).
3. If more than one lease of different ownership is dedicated to the well, have the interests of all owners been consolidated by communitization, unitization, force-pooling, etc?

☐ Yes ☐ No If answer is "yes," type of consolidation _____

If answer is "no," list the owners and tract descriptions which have actually been consolidated. (Use reverse side of this form if necessary.) _____

No allowable will be assigned to the well until all interests have been consolidated (by communitization, unitization, forced-pooling, or otherwise) or until a non-standard unit, eliminating such interests, has been approved by the Commission.

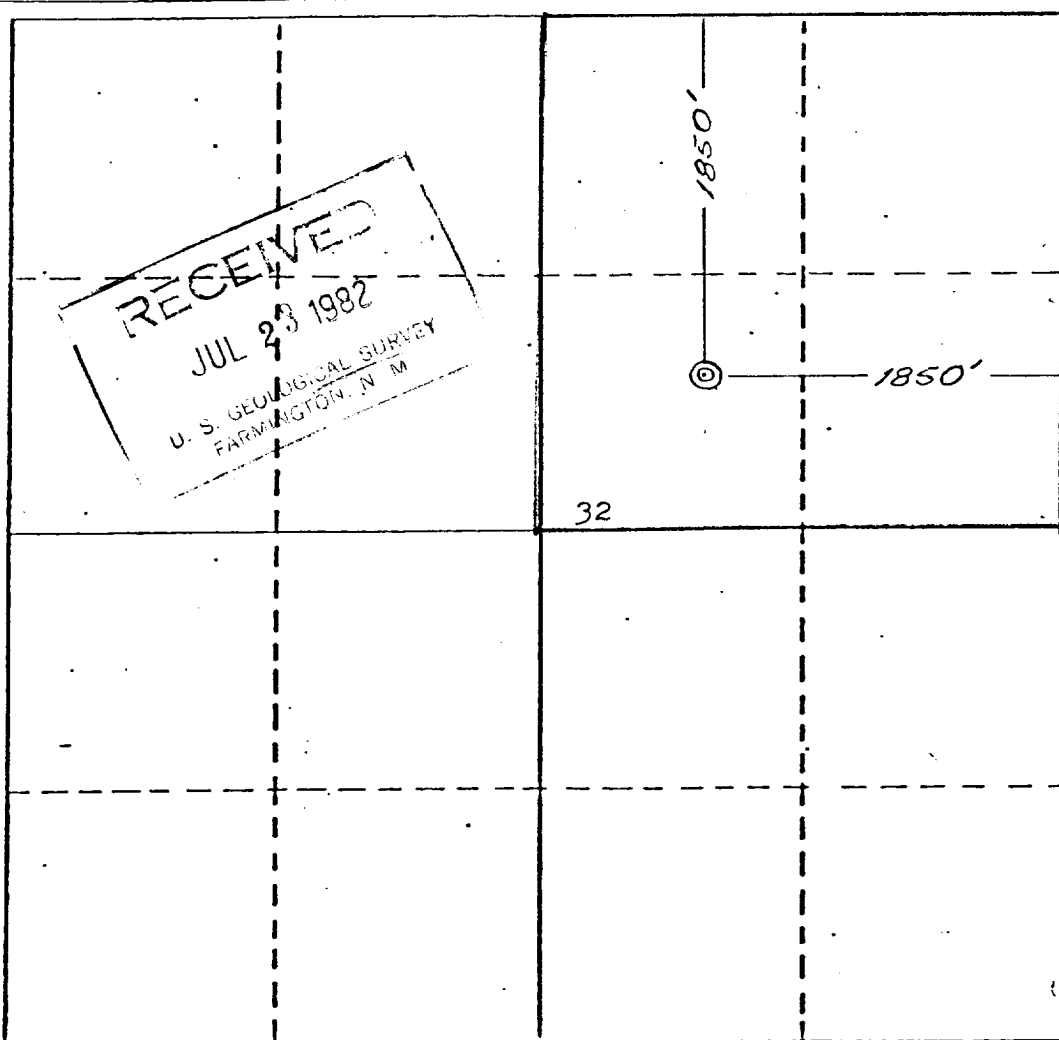

CERTIFICATION

I hereby certify that the information contained herein is true and complete to the best of my knowledge and belief.

R. C. Anderson

Name
R. C. Anderson
Position
Area Production Manager
Company
Gulf Oil Corporation
Date
7-21-82

I hereby certify that the location shown on this plat was plotted on field notes, actual surveys made by me or under my supervision, and is true to the best of my knowledge and belief.

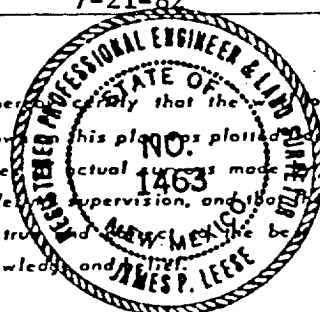

June 26, 1982

Date Surveyed
James P. Leese
Registered Professional Engineer
and/or Land Surveyor

James P. Leese

Certificate No.
1463

0 330 660 990 1320 1650 1980 2310 2640 2970 3300 3630 3960 4290 4620 4950 5280 5610 5940 6270 6600 6930 7260 7590 7920 8250 8580 8910 9240 9570 9900 0

Gulf Oil Exploration and Production Company

R. C. Anderson
PRODUCTION MANAGER, HOBBS AREA

July 21, 1982

P. O. Box 670
Hobbs, NM 88240

U. S. Geological Survey
P. O. Drawer 600
Farmington, NM 87401

Gentlemen:

The following is Gulf Oil Corporation's plan for surface restoration associated with the drilling of our San Juan "S" Federal Com #2 to be located 1850' FNL & 1850' FEL, Section 32, Township 26 North, Range 12 West, San Juan County, New Mexico.

After completion of drilling and/or completion operations, all equipment and other material not needed for operations will be removed. Pits will be filled and the location cleaned of all trash and junk to leave the well site in as aesthetically pleasing condition as possible. Any unguarded pits containing fluids will be fenced until they are filled.

After abandonment of the well, surface restoration will be in accordance with the agreement with the surface owner. Pits will be filled and the location will be cleaned. The pit area, well pad and all unneeded access roads will be ripped to promote revegetation. Rehabilitation should be accomplished within ninety (90) days after abandonment.

Yours very truly,

R. C. Anderson

GSS/jr

Subscribed and sworn to before me this 22nd day of July, 1982.

My Commission Expires 8-21-85

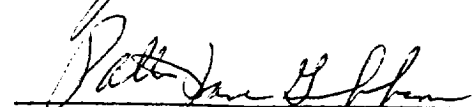
Notary Public in and for Lea
County, New Mexico



A DIVISION OF GULF OIL CORPORATION

