

UNITED STATES
DEPARTMENT OF THE INTERIOR
GEOLOGICAL SURVEY

SUNDRY NOTICES AND REPORTS ON WELLS

(Do not use this form for proposals to drill or to deepen or plug back to a different reservoir. Use Form 9-331-C for such proposals.)

1. oil ☐ gas ☒ other ☐
well well

2. NAME OF OPERATOR
Merriam Oil & Gas Corporation

3. ADDRESS OF OPERATOR
P. O. Box 1017, Farmington, New Mexico 87499

4. LOCATION OF WELL (REPORT LOCATION CLEARLY. See space 17 below.)
AT SURFACE: 1850' FSL and 960' FEL
AT TOP PROD. INTERVAL: Same
AT TOTAL DEPTH: Same

16. CHECK APPROPRIATE BOX TO INDICATE NATURE OF NOTICE, REPORT, OR OTHER DATA

REQUEST FOR APPROVAL TO:		SUBSEQUENT REPORT OF:	
TEST WATER SHUT-OFF	<input type="checkbox"/>		<input type="checkbox"/>
FRACTURE TREAT	<input type="checkbox"/>		<input type="checkbox"/>
SHOOT OR ACIDIZE	<input type="checkbox"/>		<input type="checkbox"/>
REPAIR WELL	<input type="checkbox"/>		<input type="checkbox"/>
PULL OR ALTER CASING	<input type="checkbox"/>		<input type="checkbox"/>
MULTIPLE COMPLETE	<input type="checkbox"/>		<input type="checkbox"/>
CHANGE ZONES	<input type="checkbox"/>		<input type="checkbox"/>
ABANDON*	<input type="checkbox"/>		<input type="checkbox"/>
(other) Extension and Change of Footage			

5. LEASE
SF 080384 B

6. IF INDIAN, ALLOTTEE OR TRIBE NAME

7. UNIT AGREEMENT NAME

8. FARM OR LEASE NAME
Hickman

9. WELL NO.
8Y

10. FIELD OR WILDCAT NAME
So. Gallegos Fruitland-*Refined C.H.s*

11. SEC., T., R., M., OR BLK. AND SURVEY OR AREA
Sec. 3, T26N, R12W

12. COUNTY OR PARISH
San Juan

13. STATE
New Mexico

14. API NO.

15. ELEVATIONS (SHOW DF, KDB, AND WD)
5956' GL
5957

(NOTE: Report results of multiple completion or zone change on Form 9-330.)

17. DESCRIBE PROPOSED OR COMPLETED OPERATIONS (Clearly state all pertinent details, and give pertinent dates, including estimated date of starting any proposed work. If well is directionally drilled, give subsurface locations and measured and true vertical depths for all markers and zones pertinent to this work.)*

Please extend the Application for Permit to Drill for six months.
Also, please change the footage from 1850' FSL & 840' FEL to
1850' FSL & 960' FEL.

RECEIVED
JUN 14 1984
CR. CO. L.S.
DIST. 5

Subsurface Safety Valve: Manu. and Type _____ Set @ _____ Ft.

18. I hereby certify that the foregoing is true and correct

SIGNED *John J. Ad* TITLE Operations Manager DATE 3/27/84

(This space for Federal or State office use)

APPROVED BY _____ TITLE _____ DATE _____
CONDITIONS OF APPROVAL, IF ANY:

*See Instructions on Reverse Side

NMOCC

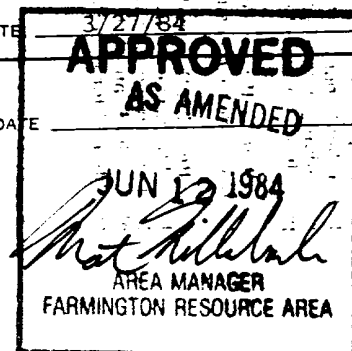

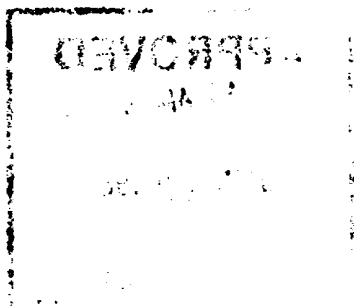

OIL CONSERVATION DIVISION

P. O. BOX 2088

SANTA FE, NEW MEXICO 87501

Form C-107
Revised 10-1-78

STATE OF NEW MEXICO

ENERGY AND MINERALS DEPARTMENT

All distances must be from the outer boundaries of the Section.

Operator MERRION OIL & GAS CORPORATION			Lease HICKMAN		Well No. 8Y
Unit Letter I	Section 3	Township 26N	Range 12W	County San Juan	
Actual Footage Location of Well: 1850 feet from the South line and 960 feet from the East line					
Ground Level Elev: 5956 5' 5"	Producing Formation Pictured Cliffs		Pool S. Gallegos Fruitland Pictured Cliffs	Dedicated Acreage: 160 Acres	
<p>1. Outline the acreage dedicated to the subject well by colored pencil or hatchure marks on the plat below.</p> <p>2. If more than one lease is dedicated to the well, outline each and identify the ownership thereof (both as to working interest and royalty).</p> <p>3. If more than one lease of different ownership is dedicated to the well, have the interests of all owners been consolidated by communitization, unitization, force-pooling, etc?</p> <p><input type="checkbox"/> Yes <input checked="" type="checkbox"/> No If answer is "yes," type of consolidation _____</p> <p>If answer is "no," list the owners and tract descriptions which have actually been consolidated. (Use reverse side of this form if necessary.) _____</p> <p>No allowable will be assigned to the well until all interests have been consolidated (by communitization, unitization, forced-pooling, or otherwise) or until a non-standard unit, eliminating such interests, has been approved by the Commission.</p>					

JUN 14 1984 OIL CON. DIV. DIST. 3		Sec.	
3		960'	
1850'		SF 080384 B	

CERTIFICATION

I hereby certify that the information contained herein is true and complete to the best of my knowledge and belief.

Name
Steve S. Dunn

Position
Operations Manager

Company
Merrion Oil & Gas Corporation

Date
3/27/84

I hereby certify that the well location shown on this plat was plotted from field notes of actual surveys made by me or under my supervision, and that the same is true and correct to the best of my knowledge and belief.

Date Surveyed
March 23, 1984

Registered Professional Engineer
and Land Surveyor
Fred B. Kerr Jr.

Certificate No. **4** REC. 10
3950

Scale: 1"=1000'

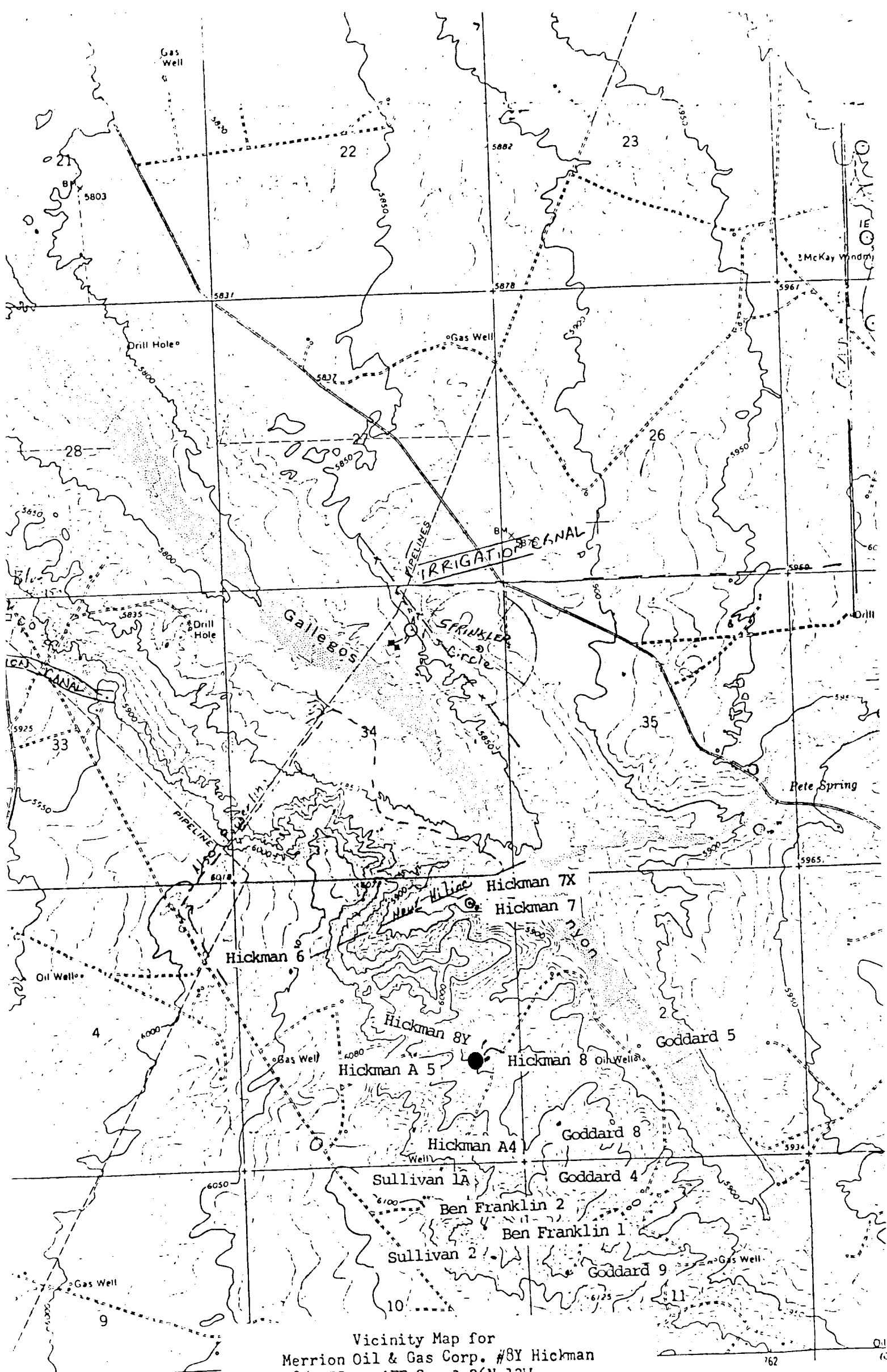

Vicinity Map for
 Merrion Oil & Gas Corp. #8Y Hickman
 1850'FS 960'FE Sec 3-26N-12W
 San Juan County New Mexico

Edited and published by the
 U.S.G.S., U.S.C.G.S., and U.S. Bureau
 of Geometric Methods from aerial

Scale 1:50,000
 1944