

UNITED STATES
DEPARTMENT OF THE INTERIOR
GEOLOGICAL SURVEY

5. LEASE DESIGNATION AND SERIAL NO.

NM-33031

6. IF INDIAN, ALLOTTEE OR TRIBE NAME

N.A.

7. UNIT AGREEMENT NAME

N.A.

8. FARM OR LEASE NAME

Serendipity

9. WELL NO.

1

10. FIELD AND POOL, OR WILDCAT

Bisti-Gallup

11. SEC., T., R., M., OR BLK.
AND SURVEY OR AREA

Sec. 26, T26N-R13W, NMPM

12. COUNTY OR PARISH

San Juan

13. STATE

N.M.

APPLICATION FOR PERMIT TO DRILL, DEEPEN, OR PLUG BACK

1a. TYPE OF WORK

DRILL ☒DEEPEN ☐PLUG BACK ☐

b. TYPE OF WELL

OIL
WELL ☒GAS
WELL ☐OTHER ☐

2. NAME OF OPERATOR

Oxoco Production Corp.

3. ADDRESS OF OPERATOR

P.O. Box 255, Farmington, NM 87401

4. LOCATION OF WELL (Report location clearly and in accordance with any State requirements.)

At surface

1650 ft. fS1, 2310 ft. fE1

At proposed prod. zone

same

14. DISTANCE IN MILES AND DIRECTION FROM NEAREST TOWN OR POST OFFICE*

24 miles south of Farmington, N.M.

15. DISTANCE FROM PROPOSED*

LOCATION TO NEAREST
PROPERTY OR LEASE LINE, FT.
(Also to nearest drlg. unit line, if any) 330 ft.18. DISTANCE FROM PROPOSED LOCATION*
TO NEAREST WELL, DRILLING, COMPLETED,
OR APPLIED FOR, ON THIS LEASE, FT.

21. ELEVATIONS (Show whether DF, RT, GR, etc.)

6205 ft.Gr., 6218 ft. KB (est.)

23. PROPOSED CASING AND CEMENTING PROGRAM

SIZE OF HOLE	SIZE OF CASING	WEIGHT PER FOOT	SETTING DEPTH	QUANTITY OF CEMENT
12 1/4"	8 5/8"	24 lb.	215'	200 cu.ft. circ. to surf.
7 7/8"	5 1/2"	15.5 lb.	5120'	800 cu. ft.
	2 3/8"	4.7 lb.	5100'	

Operator proposes to rotary drill a Gallup fm. test well to 5120 ft. depth. A 12 1/4" hole will be drilled to 215 ft. and 8 5/8", 24 lb., J-55 casing will be set with 200 cu. ft. Class B cement circulated to surface. A dual ram, 900 series, 3000 psi-test blow preventer will be installed & pressure tested before drilling surface casing shoe. A 7 7/8" hole will be drilled then to T.D. with gel-based mud of appropriate properties. No abnormal pressure zones are anticipated. At T.D. an induction-electrical, formation density and compensated neutron-density & gamma ray logs will be run. If logs warrant, 5 1/2", 15.5 lb., J-55 casing will be run to T.D. & cemented back to the surface casing. The well will then be completed by running cement bond & correlation gamma-ray logs, selectively perforated, acidized and sand-oil fractured with appropriate volumes, cleaned out & 2 3/8" tubing run. Rods & pumping unit will be installed if required. Anticipated formation tops are: Ojo Alamo-450', Kirtland-595', Fruitland-1065', Pict. Cliffs-1255', Lewis-1435', Mesaverde-1620', Pt. Lookout-3755', Mancos-3915', Gallup-4845'.

IN ABOVE SPACE DESCRIBE PROPOSED PROGRAM: If proposal is to deepen or plug back, give data on present productive zone and proposed new productive zone. If proposal is to drill or deepen directionally, give pertinent data on subsurface locations and measured and true vertical depths. Give blowout preventer program, if any.

24.

SIGNED

Wm R. Speer

TITLE

Agent

DATE April 22, 1983

(This space for Federal or State office use)

PERMIT NO.

APPROVAL DATE

APPROVED BY

James F. Sims

TITLE

Asst. District Engineer

CONDITIONS OF APPROVAL, IF ANY:

APPROVED
AS AMENDED

APR 28 1983

JAMES F. SIMS
DISTRICT ENGINEER

NMCC

STATE OF NEW MEXICO
ENERGY AND MINERALS DEPARTMENT

OIL CONSERVATION DIVISION

P. O. BOX 2088
SANTA FE, NEW MEXICO 87501

Form C-107
Revised 10-1-78

All distances must be from the outer boundaries of the Section.

Operator Oxoco Production Corporation			Lease Serendipity		Well No. #1
Unit Letter J	Section 26	Township 26 North	Range 13 West	County San Juan	
Actual Footage Location of Well: 1650 feet from the South line and 2310 feet from the East line					
Ground Level Elev. 6205	Producing Formation Gallup Fm.		Pool Bisti	Dedicated Acreage: N/2 80.00 Acres	

1. Outline the acreage dedicated to the subject well by colored pencil or hatchure marks on the plat below.
2. If more than one lease is dedicated to the well, outline each and identify the ownership thereof (both as to working interest and royalty).
3. If more than one lease of different ownership is dedicated to the well, have the interests of all owners been consolidated by communitization, unitization, force-pooling, etc?

☐ Yes ☐ No If answer is "yes," type of consolidation _____
If answer is "no," list the owners and tract descriptions which have actually been consolidated. (Use reverse side of this form if necessary.) _____

No allowable will be assigned to the well until interests have been consolidated (by communitization, unitization, forced-pooling, or otherwise) or until a non-standard unit, eliminating such interests, has been approved by the Division

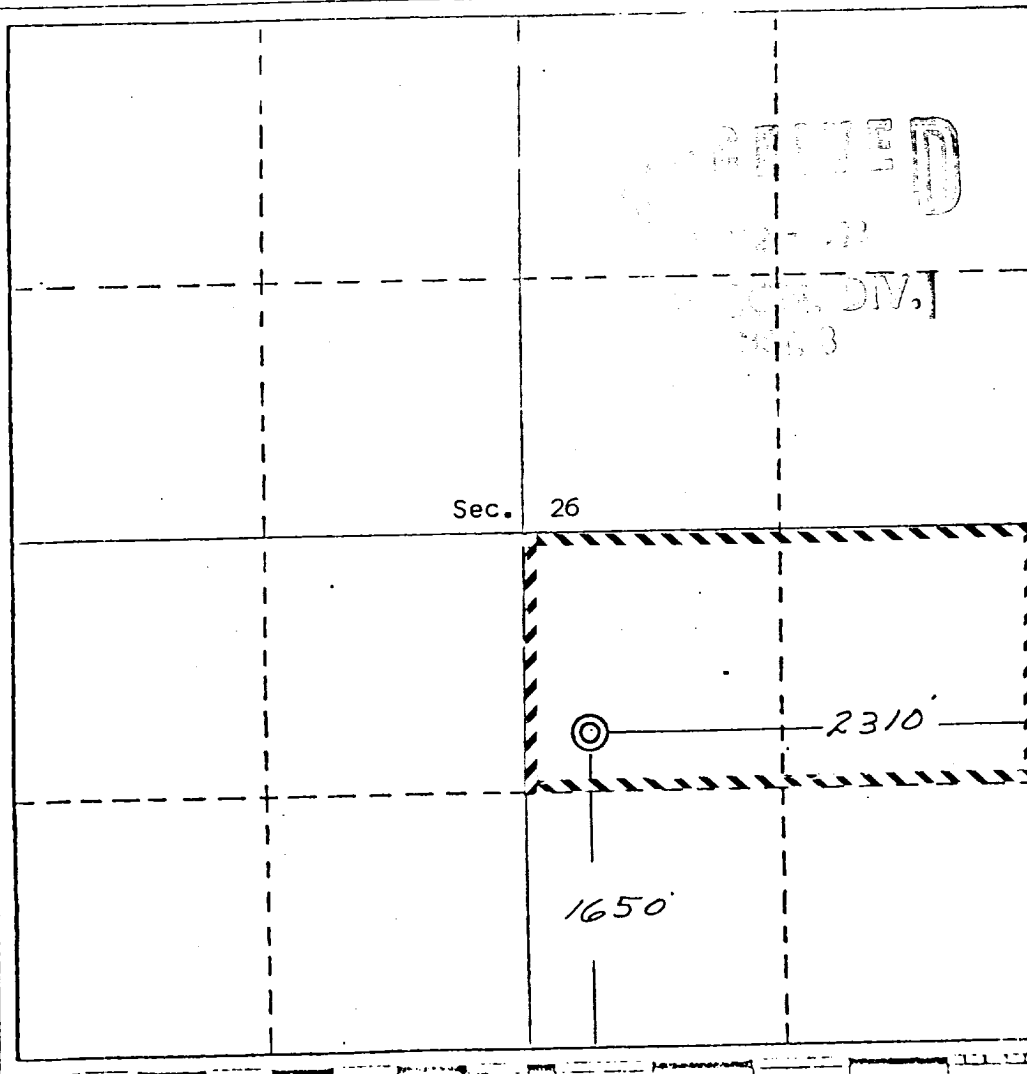

CERTIFICATION

I hereby certify that the information contained herein is true and complete to the best of my knowledge and belief.

Name **Wm R. Speer**
Position **Agent**
Company _____

Date **April 22, 1983**

I hereby certify that the information shown on this plat was obtained from notes of actual surveys made by me or under my supervision and that the same is true and correct to the best of my knowledge and belief.

Date Surveyed
April 22, 1983

Registered Professional Engineer
and/or Land Surveyor

Edgar L. Risenhoover
Certificate No. **5979**
Edgar L. Risenhoover, L.S.

