

RECEIVED
STAMP IN THIS SPACE (Other instructions on reverse side)

**UNITED STATES
 DEPARTMENT OF THE INTERIOR
 GEOLOGICAL SURVEY**

JUN 23 1983

30-045-25753

APPLICATION FOR PERMIT TO DRILL, DEEPEN, OR PLUG BACK

1a. TYPE OF WORK
 DRILL DEEPEN PLUG BACK

b. TYPE OF WELL
 OIL WELL GAS WELL OTHER SINGLE ZONE MULTIPLE ZONE

2. NAME OF OPERATOR
 Union Texas Petroleum Corporation

3. ADDRESS OF OPERATOR
 P. O. Box 808, Farmington, New Mexico 87499

4. LOCATION OF WELL (Report location clearly and in accordance with any State requirements.)
 At surface: 1830 ft./South and 1760 ft./West line East
 At proposed prod. zone: Same as above

14. DISTANCE IN MILES AND DIRECTION FROM NEAREST TOWN OR POST OFFICE
 17 miles North of Nageezi, New Mexico

15. DISTANCE FROM PROPOSED* LOCATION TO NEAREST PROPERTY OR LEASE LINE, FT. (Also to nearest drlg. unit line, if any)
 810 ft. 810 ft.

18. DISTANCE FROM PROPOSED LOCATION* TO NEAREST WELL, DRILLING, COMPLETED, OR APPLIED FOR, ON THIS LEASE, FT.
 930 ft.

21. ELEVATIONS (Show whether DF, RT, GR, etc.)
 6800' GR

23. DRILLING OPERATIONS AUTHORIZED ARE SUBJECT TO COMPLIANCE WITH ATTACHED "GENERAL REQUIREMENTS" PROPOSED CASING AND CEMENTING PROGRAM

5. LEASE DESIGNATION AND SERIAL NO.
 SF 078430

6. IF INDIAN, ALLOTTEE OR TRIBE NAME

7. UNIT AGREEMENT NAME

8. FARM OR LEASE NAME
 Newsom "A"

9. WELL NO.
 3-E

10. FIELD AND POOL, OR WILDCAT
 Basin Dakota

11. SEC., T., R., M., OR BLE. AND SURVEY OR AREA
 Sec 4, T-26N, R-8W, N.M.P.M.

12. COUNTY OR PARISH 13. STATE
 San Juan New Mexico

16. NO. OF ACRES IN LEASE
 2480.00

19. PROPOSED DEPTH
 7334'

17. NO. OF ACRES ASSIGNED TO THIS WELL
 320.00

20. ROTARY OR CABLE TOOLS
 Rotary

22. APPROX. DATE WORK WILL START*
 June 20, 1983

SIZE OF HOLE	SIZE OF CASING	WEIGHT PER FOOT	SETTING DEPTH	QUANTITY OF CEMENT
12-1/4"	8-5/8"	24.0# K-55	300'	250 cu. ft. (circulated)
7-7/8"	5-1/2"	15.5# K-55	7334'	2775 cu. ft. (circulated)

We desire to drill 12-1/4" surface hole to approx. 300 ft. using natural mud as a circulating medium. Run new 8-5/8", 24.0#, K-55 casing to TD. Cement with approx. 250 cu. ft. Class "B" cement circulated to surface. Pressure test the casing. Drill 7-7/8" hole to TD of approx. 7334 ft. using a permaloid non-dispersed mud as the circulating medium. Log the well. Run new 5-1/2". 15.5#, K-55 casing to TD with DV tool at approx. 2150 ft. Cement first stage with approx. 1400 cu. ft. of 65/35/6 followed by 275 cu. ft. 50/50 Poz. Cement second stage with approx. 1100 cu. ft. 65/35/12 Poz circulated to surface. Drill out the DV tool and pressure test the casing. Perforate and fracture the Dakota zone. Clean the well up. Run new 2-3/8" EUE, 4.7#, J-55 tubing to the Dakota zone. Set surface production unit. Test the well and connect to a gathering system.

The gas from this well has previously been dedicated to a transporter.

NOTE: Actual cement volumes to be calculated from caliper log.
 IN ABOVE SPACE DESCRIBE PROPOSED PROGRAM: If proposal is to deepen or plug back, give data on present productive zone and proposed new productive zone. If proposal is to drill or deepen directionally, give pertinent data on subsurface locations and measured and true vertical depths. Give blowout preventer program, if any.

24. SIGNED W. K. Cooper TITLE Field Operations Manager DATE May 19, 1983
 (This space for Federal or State office use)

PERMIT NO. _____ APPROVAL DATE _____

APPROVED BY ahz TITLE _____

APPROVED AS AMENDED
 JUN 22 1983
 JAMES F. SIMS
 DISTRICT ENGINEER

All distances must be from the outer boundaries of the Section

Operator UNION TEXAS PETROLEUM CORPORATION		Lease NEWSOM A		Well No. 3-E
Well Letter J	Section 4	Township 26 NORTH	Range 8 WEST	County SAN JUAN
Critical Postage Location of Well: 1830 feet from the SOUTH line and 1760 feet from the EAST line				
Ground Level Elev. 6800	Producing Formation DAKOTA	Pool BASIN	Dedicated Acreage: 320.00 Acres	

1. Outline the acreage dedicated to the subject well by colored pencil or hatchure marks on the plat below.
2. If more than one lease is dedicated to the well, outline each and identify the ownership thereof (both as to working interest and royalty).
3. If more than one lease of different ownership is dedicated to the well, have the interests of all owners been consolidated by communitization, unitization, force-pooling, etc?

Yes No If answer is "yes," type of consolidation _____

If answer is "no," list the owners and tract descriptions which have actually been consolidated. (Use reverse side of this form if necessary.) _____

No allowable will be assigned to the well until all interests have been consolidated (by communitization, unitization, forced-pooling, or otherwise) or until a non-standard unit, eliminating such interests, has been approved by the Division.

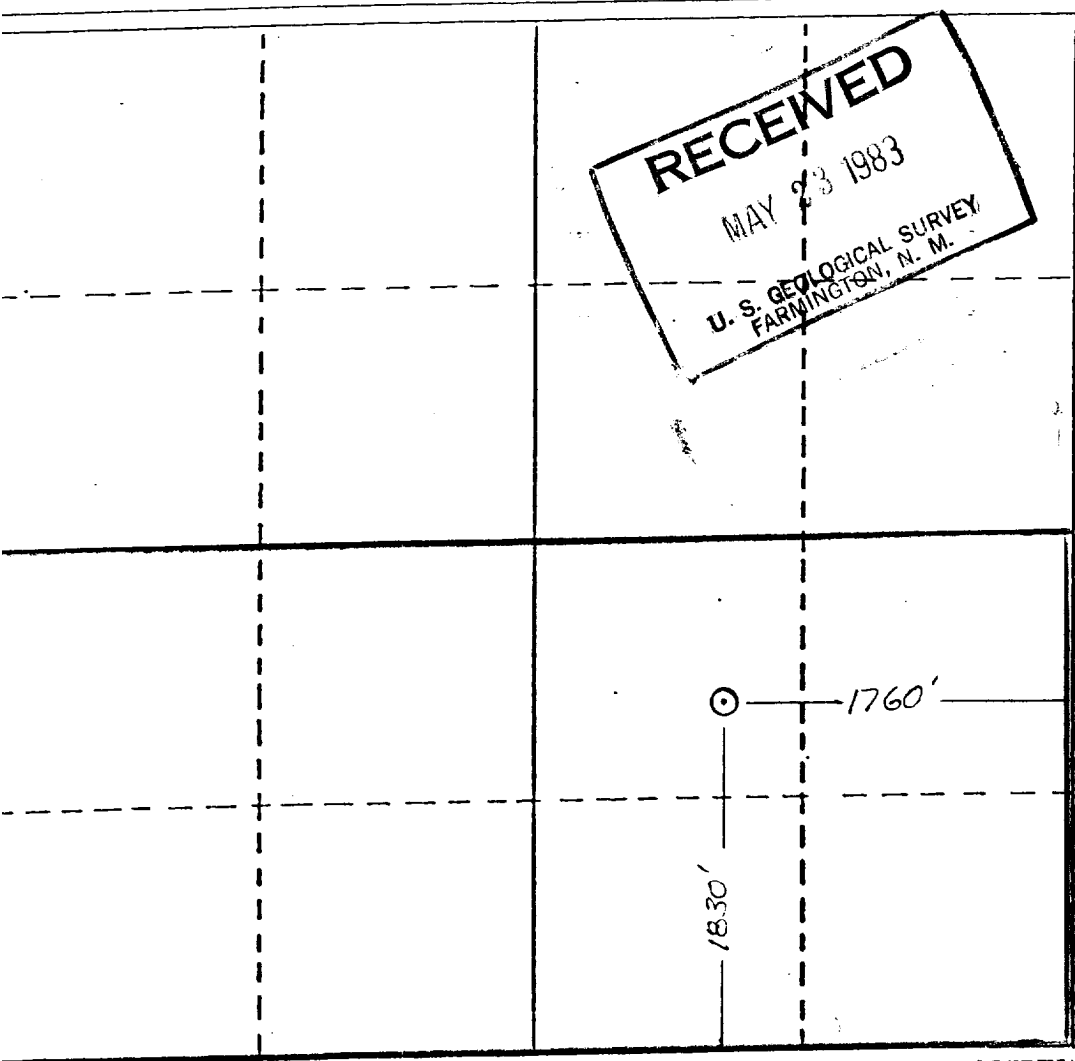

CERTIFICATION

I hereby certify that the information contained herein is true and complete to the best of my knowledge and belief.

Rudy D. Motto
Name
Rudy D. Motto
Position
Area Operations Manager
Company
Union Texas Petroleum Corp.
Date
May 19, 1983

Michael Daly
I hereby certify that the well location shown on this 5892 was plotted from field notes of _____ and _____ by me or under my supervision, and that the same is true and correct to the best of my knowledge and belief.

Date Surveyed
December 5, 1982
Registered Professional Engineer and/or Land Surveyor

Michael Daly
Certificate No.
5992

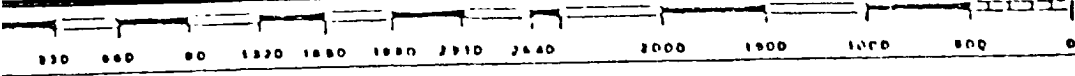

UNION TEXAS PETROLEUM CORPORATION

NEWSON "A" 3-E

1. The Geologic name of the surface formation is, "Wasatch".

2. The estimated tops of important Geologic markers are:

A. Top of the Ojo Alamo	1883	ft.
B. Kirtland	2006	ft.
C. Fruitland	2471	ft.
D. Pictured Cliffs	2706	ft.
E. Chacra	3589	ft.
F. Cliff House	4284	ft.
G. Point Lookout	4985	ft.
H. Gallup	6227	ft.
I. Greenhorn	6984	ft.
J. Dakota	7146	ft.

RECEIVED
 JUN 27 1983
 CR CON. DIV.
 DIST. 3

3. The estimated depths at which anticipated water, oil or other mineral bearing formations are expected to be encountered are:

A. Ojo Alamo	1883	ft.	Water
B. Kirtland	2006	ft.	Water
C. Fruitland	2471	ft.	Water
D. Pictured Cliffs	2706	ft.	Gas
E. Chacra	3589	ft.	Dry
F. Cliff House	4284	ft.	Water
G. Point Lookout	4985	ft.	Water
H. Gallup	6227	ft.	Dry
I. Greenhorn	6984	ft.	Shale
J. Dakota	7146	ft.	Gas

4. The casing program is shown on form 9-331C and all casing is new.

5. The lessee's pressure control equipment schematics are attached, along with minimum specifications, testing procedures, and frequencies.

6. The type, estimated volumes, and characteristics of the circulating medium are as follows:

A. 0 - 300± ft.	Natural Mud.
B. 300± - 7334±ft.	Permaloid non dispersed mud containing approx. 150 sx gel, 60 sx of permaloid and 15 sx of CMC.

7. The auxiliary equipment to be used will be floats at the bit and a sub on the floor with a full opening valve to be stabbed into the drill pipe when the kelly is not in the string.

8. The well is in an area which is partially developed; therefore we will not have a testing and coring program. The logging program is as follows:

- A. G.R. - DIFL
- B. GR - CAL
- C. F.D.C.-C.N.L.

9. We do not expect to find any abnormal pressures, temperatures or hydrogen sulfide problems in this partially developed area.

10. The anticipated starting date for this well is June 20, 1983

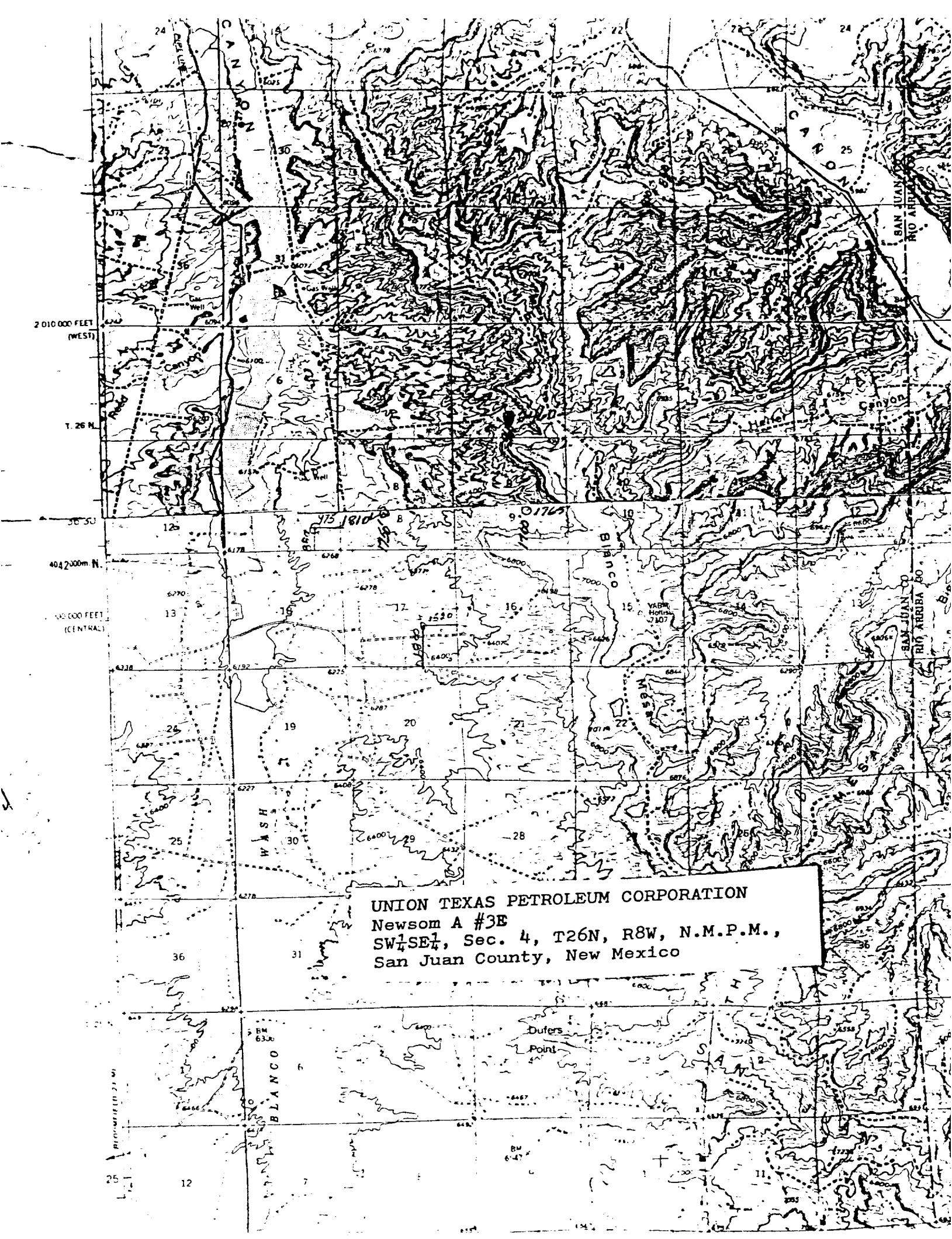

UNION TEXAS PETROLEUM CORPORATION
Newsom A #3E
SW 1/4 SE 1/4, Sec. 4, T26N, R8W, N.M.P.M.,
San Juan County, New Mexico