

UNITED STATES  
DEPARTMENT OF THE INTERIOR  
GEOLOGICAL SURVEYRECEIVED  
SF 078430  
JUN 23 1983

## APPLICATION FOR PERMIT TO DRILL, DEEPEN, OR PLUG BACK

1a. TYPE OF WORK DRILL <input checked="" type="checkbox"/> DEEPEN <input type="checkbox"/> PLUG BACK <input type="checkbox"/>		8. IF IN MINERAL ZONE OR TRIBE NAME OIL CON. DIV. DIST. 3	
b. TYPE OF WELL OIL WELL <input checked="" type="checkbox"/> GAS WELL <input type="checkbox"/> OTHER <input type="checkbox"/>		9. FARM OR LEASE NAME Nickson	
2. NAME OF OPERATOR Union Texas Petroleum Corporation		9. WELL NO. 22	
3. ADDRESS OF OPERATOR P. O. Box 808, Farmington, New Mexico 87499		10. FIELD AND POOL, OR WILDCAT Undesignated Gallup	
4. LOCATION OF WELL (Report location clearly and in accordance with any State requirements.) At surface 1852 ft./North and 637 ft./East lines At proposed prod. zone Same as above		11. SEC., T., R., M., OR BLK. AND SURVEY OR AREA Sec. 14, T-26N, R-8W, N.M.P.M.	
14. DISTANCE IN MILES AND DIRECTION FROM NEAREST TOWN OR POST OFFICE* 15 miles North of Nageezi, New Mexico		12. COUNTY OR PARISH San Juan	
15. DISTANCE FROM PROPOSED* LOCATION TO NEAREST PROPERTY OR LEASE LINE, FT. (Also to nearest drlg. unit line, if any) 637 ft. 532 ft.		13. STATE New Mexico	
16. NO. OF ACRES IN LEASE 2480.00		17. NO. OF ACRES ASSIGNED TO THIS WELL 40.00	
18. DISTANCE FROM PROPOSED LOCATION* TO NEAREST WELL, DRILLING, COMPLETED, OR APPLIED FOR, ON THIS LEASE, FT. 4428 ft.		20. ROTARY OR CABLE TOOLS Rotary	
21. ELEVATIONS (Show whether DF, RT, GR, etc.) 6300' GR		22. APPROX. DATE WORK WILL START* June 20, 1983	

23. GENERAL REQUIREMENTS  
This action is subject to administrative appeal pursuant to 30 CFR 290.

SIZE OF HOLE	SIZE OF CASING	WEIGHT PER FOOT	SETTING DEPTH	QUANTITY OF CEMENT
12-1/4"	8-5/8"	24.0# K-55	300'	250 cu. ft. (circulated)
7-7/8"	5-1/2"	15.5# K-55	6289'	2575 cu. ft. (circulated)

We desire to drill 12-1/4" surface hole to approx. 300 ft. using natural mud as a circulating medium. Run new 8-5/8", 24.0#, K-55 casing to TD. Cement with approx. 250 cu. ft. Class "B" cement circulated to surface. Pressure test the casing. Drill 7-7/8" hole to TD of approx. 6289 ft. using a permaloid non-dispersed mud as the circulating medium. Log the well. Run new 5-1/2", 15.5#, K-55 casing to TD with DV tool at approx. 2150 ft. Cement 1st stage with approx. 1200 cu. ft. of 65/35/6 followed by 275 cu. ft. 50/50 Poz. Cement 2nd stage with approx. 1100 cu. ft. 65/35/12 Poz circulated to surface. Drill out the DV tool and pressure test the casing. Perforate and fracture the Gallup zone. Clean the well up. Run new 2-3/8" EUE, 4.7#, J-55 tubing to the Gallup zone. Run rod pump and rods. Set a pumping unit and tanks. Test the well and connect to a gathering system.

The gas from this well has not been dedicated to a transporter.

NOTE: Actual cement volumes to be calculated from caliper log.

IN ABOVE SPACE DESCRIBE PROPOSED PROGRAM: If proposal is to deepen or plug back, give data on present productive zone and proposed new productive zone. If proposal is to drill or deepen directionally, give pertinent data on subsurface locations and measured and true vertical depths. Give blowout preventer program, if any.

24. SIGNED W. K. Cooper TITLE Field Operations Manager DATE May 19, 1983  
(This space for Federal or State office use)

PERMIT NO. \_\_\_\_\_ APPROVAL DATE \_\_\_\_\_  
APPROVED BY \_\_\_\_\_ TITLE \_\_\_\_\_  
CONDITIONS OF APPROVAL, IF ANY:

APPROVED  
AS AMENDED

JUN 22 1983

JAMES F. SIMS  
DISTRICT ENGINEER

All distances must be from the outer boundaries of the Section.

Operator <b>UNION TEXAS PETROLEUM CORPORATION</b>			Lease <b>NICKSON</b>		Well No. <b>22</b>
Unit Letter <b>H</b>	Section <b>14</b>	Township <b>26 NORTH</b>	Range <b>8 WEST</b>	County <b>SAN JUAN</b>	
Actual Footage Location of Well: <b>1852</b> feet from the <b>NORTH</b> line and <b>637</b> feet from the <b>EAST</b> line					
Ground Level Elev. <b>6300</b>	Producing Formation <b>GALLUP</b>	Pool <b>UNDESIGNATED WC</b>		Dedicated Acreage: <b>SE NE 40.00</b> Acres	

1. Outline the acreage dedicated to the subject well by colored pencil or hatchure marks on the plat below.
2. If more than one lease is dedicated to the well, outline each and identify the ownership thereof (both as to working interest and royalty).
3. If more than one lease of different ownership is dedicated to the well, have the interests of all owners been consolidated by communitization, unitization, force-pooling, etc?

☐ Yes ☐ No If answer is "yes," type of consolidation \_\_\_\_\_

If answer is "no," list the owners and tract descriptions which have actually been consolidated. (Use reverse side of this form if necessary.) \_\_\_\_\_

No allowable will be assigned to the well until all interests have been consolidated (by communitization, unitization, forced-pooling, or otherwise) or until a non-standard unit, eliminating such interests, has been approved by the Division

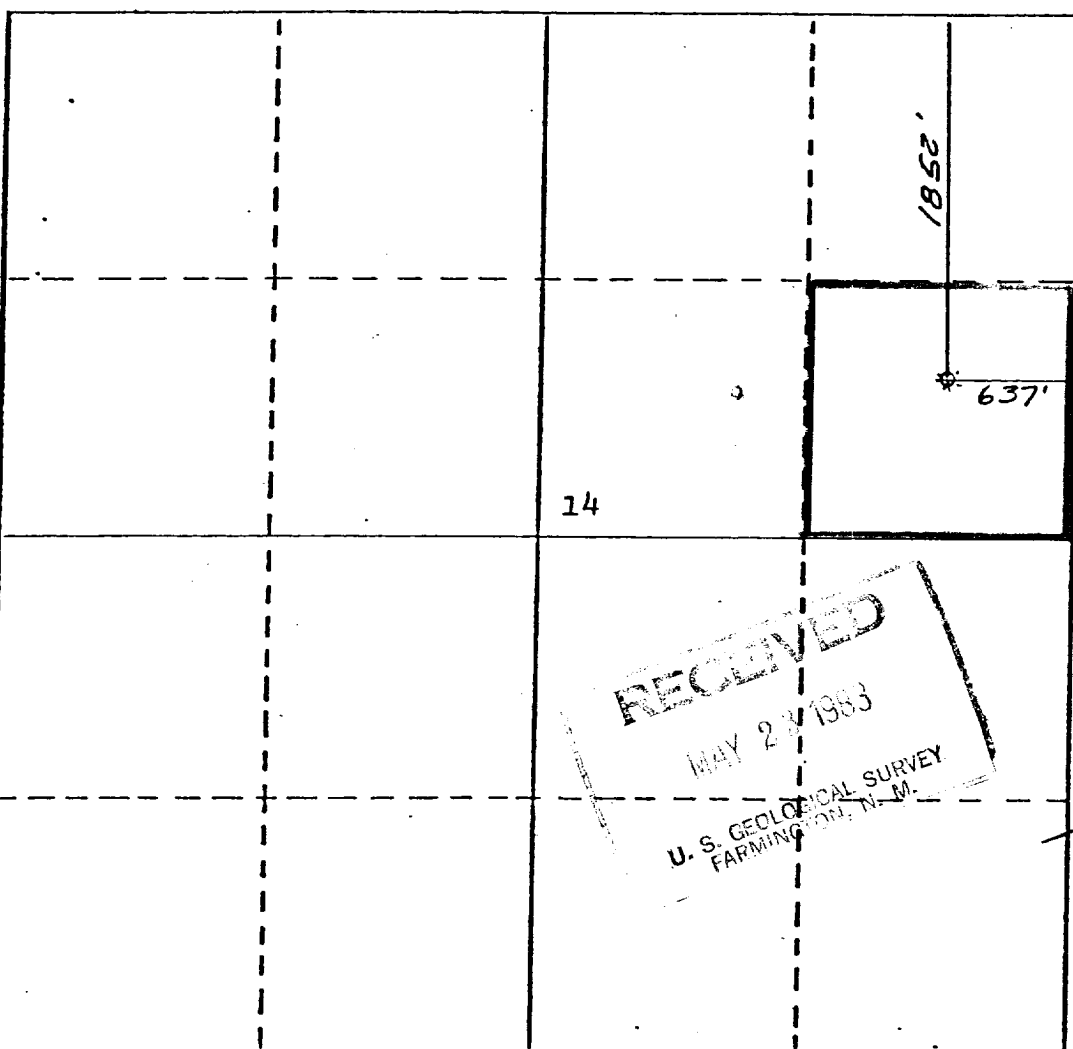

#### CERTIFICATION

I hereby certify that the information contained herein is true and complete to the best of my knowledge and belief.

*Rudy D. Motto*  
Name

Rudy D. Motto  
Position

Area Operations Manager  
Company

Union Texas Petroleum Corp.  
Date

April 4, 1983

I hereby certify that the well location shown on this plat was plotted from field notes of a well survey made by me or under my supervision and that the same is true and correct to the best of my knowledge and belief.

*Michael Daly*  
Date Surveyed  
March 22, 1983

Registered Professional Engineer  
and/or Land Surveyor

Michael Daly

Certificate No.  
5992

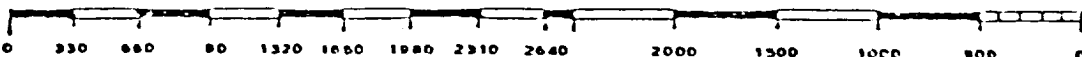

UNION TEXAS PETROLEUM CORPORATION

NICKSON NO. 22

1. The geologic name of the surface formation is "Wasatch".

2. The estimated tops of important geologic markers are:

A. Top of the Ojo Alamo	1342	ft.
B. Kirtland	1504	ft.
C. Fruitland	1872	ft.
D. Pictured Cliffs	2124	ft.
E. Chacra	3029	ft.
F. Cliff House	3726	ft.
G. Point Lookout	4419	ft.
H. Gallup	5641	ft.

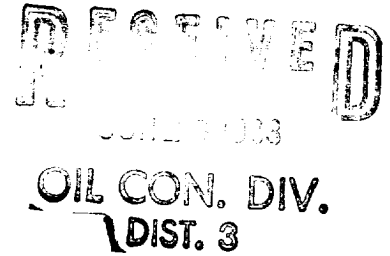

3. The estimated depths at which anticipated water, oil or other mineral bearing formations are expected to be encountered are:

A. Top of the Ojo Alamo	1342	ft.	Water
B. Kirtland	1504	ft.	Water
C. Fruitland	1872	ft.	Water
D. Pictured Cliffs	2124	ft.	Gas
E. Chacra	3029	ft.	Gas
F. Cliff House	3726	ft.	Water
G. Point Lookout	4419	ft.	Gas
H. Gallup	5641	ft.	Oil & Gas

4. The casing program is shown on form 9-331C and all casing is new.

5. The lessee's pressure control equipment schematics are attached, along with minimum specifications, testing procedures, and frequencies.

6. The type, estimated volumes, and characteristics of the circulating medium are as follows:

A.	0 - 300 ±	ft.	Natural Mud
B.	300± - 6289±	ft.	Permaloid non-dispersed mud containing approx. 150 sx. gel, 60 sx. of permaloid and 15 sx. of CMC.

7. The auxiliary equipment to be used will be floats at the bit and a sub on the floor with a full opening valve to be stabbed into the drill pipe when the kelly is not in the string.

8. The well is in an area which is partially developed; therefore, we will not have a testing and coring program. The logging program is as follows:

- A. G.R. - DIFL
- B. GR - CAL
- C. F.D.C.- C.N.L.

9. We do not expect to find any abnormal pressures, temperatures or hydrogen sulfide problems in this partially developed area.

10. The anticipated starting date for this well is: June 20, 1983



UNION TEXAS PETROLEUM CORPORATION  
Nickson #22  
SE  $\frac{1}{4}$  NE  $\frac{1}{4}$ , Sec. 14, T26N, R8W, N.M.P.M.,  
San Juan County, New Mexico