

UNITED STATES
DEPARTMENT OF THE INTERIOR
BUREAU OF LAND MANAGEMENT

RECEIVED
BLM

APPLICATION FOR PERMIT TO DRILL OR DEEPEN

1a. TYPE OF WORK
 DRILL DEEPEN 98 FEB 13 PM 1:27

b. TYPE OF WELL
 OIL WELL GAS WELL OTHER SINGLE ZONE MULTIPLE ZONE

2. NAME OF OPERATOR
 Conoco Inc. 5073

3. ADDRESS AND TELEPHONE NO
 10 Desta Dr. Ste 430E, Midland, Tx. 79705-4500

4. LOCATION OF WELL (Report location clearly and in accordance with any State requirements *)
 At surface 790' FNL & 880' FWL
 At proposed prod. zone 790' FNL & 880' FWL

5. DISTANCE IN MILES AND DIRECTION FROM NEAREST TOWN OR POST OFFICE*
 Rio Arriba NM

6. LEASE DESIGNATION AND SERIAL NO
 SF 078972

7. UNIT AGREEMENT NAME
 San Juan 28-7 A 16608

8. FARM OR LEASE NAME WELL NO
 145M

9. API WELL NO
 30-039-25823

10. FIELD AND POOL, OR WILDCAT
 B Mesaverde/Basin Dakota 71599

11. SEC. T. R. M. OR BLK. AND SURVEY OR AREA
 D Sec. 10, T27N, R7W

12. COUNTY OR PARISH
 Rio Arriba

13. STATE
 NM

14. DISTANCE FROM PROPOSED* LOCATION TO NEAREST PROPERTY OR LEASE LINE, FT. (Also to nearest drlg. unit line, if Any)
 6696' GR

15. NO OF ACRES IN LEASE

16. NO OF ACRES ASSIGNED TO THIS WELL
 W/ 320 W/ 320

17. DISTANCE FROM PROPOSED LOCATION* TO NEAREST WELL, DRILLING, COMPLETED, OR APPLIED FOR, ON THIS LEASE, FT.
 7755' 8046'

18. PROPOSED DEPTH

19. ROTARY OR CABLE TOOLS
 Rotary

20. APPROX. DATE WORK WILL START*
 3/15/98

21. ELEVATIONS (Show whether DF, RT, GR, etc.)

This action is subject to technical and procedural review pursuant to 43 CFR 3165.3 and appeal pursuant to 43 CFR 3165.4

PROPOSED CASING AND CEMENTING PROGRAM DRILLING OPERATIONS AUTHORIZED ARE SUBJECT TO COMPLIANCE WITH ATTACHED GENERAL REQUIREMENTS

SIZE OF HOLE	GRADE, SIZE OF CASING	WEIGHT PER FOOT	SETTING DEPTH	QUANTITY OF CEMENT
12-1/4"	K-55, 9-5/8"	36#	250'	145 sxs, circ.
8-3/4"	K-55, 7"	23#	3549'	465 sxs, circ.
6-1/4"	K-55, 4-1/2"	9.5#	7755'	530 sxs, toc @ 3400'

It is proposed to drill a vertical wellbore to the Blanco Mesaverde and Basin Dakota Pools. An NOS was filed 10/13/97. The well will be drilled and equipped according to the following additional attachments:

1. Well Location & Acreage Dedication Plat (C-102).
2. Proposed Well Plan Outline.
3. Cementing Plan.
4. Blowout Preventer Hookup.
5. Surface Use Plan with Production Facility layout.
6. Pipeline Tie Specifications with plat.

This application includes ROW's for the well pad, cathodic protection and pipeline.

RECEIVED
APR - 3 1998
OIL CON. DIV.
DIST. 3

IN ABOVE SPACE DESCRIBE PROPOSED PROGRAM: If proposal is to deepen give data on present productive zone and proposed new productive zone. If proposal is to drill or deepen directionally, give pertinent data on subsurface locations and measured and true vertical depths. Give blowout preventer program, if any.

24. SIGNED Jo Ann Johnson TITLE Property Analyst DATE 2-12-98

(This space for Federal or State office use)

PERMIT NO. _____ APPROVAL DATE APR 01 1998

Application approval does not warrant or certify that the applicant holds legal or equitable title to those rights in the subject lease which would entitle the applicant to conduct operations thereon.

CONDITIONS OF APPROVAL, IF ANY:

APPROVED BY /s/ Duane W. Spencer TITLE _____ DATE APR - 1 1998

*See Instructions On Reverse Side

Title 18 U.S.C. Section 1001, makes it a crime for any person knowingly and willfully to make to any department or agency of the United States any false, fictitious or fraudulent statements or representations as to any matter within its jurisdiction.

NMOCD

District II
PO Drawer 00, Artesia, NM 88211-0719

OIL CONSERVATION DIVISION
PO Box 2088
Santa Fe, NM 87504-2088

Submit to Appropriate District Office
State Lease - 4 Copies
Fee Lease - 3 Copies

District III
1200 Rio Brazos Rd., Aztec, NM 87410

95 FEB 13 PM 1:27 AMENDED REPORT

District IV
PO Box 2088, Santa Fe, NM 87504-2088

WELL LOCATION AND ACREAGE DEDICATION PLAT

1 API Number 30-034-25823		2 Pool Code 72319/71599		3 Pool Name Blanco Mesaverde/Basin Dakota	
4 Property Code 016608		5 Property Name SAN JUAN 28-7 UNIT			6 Well Number 145M
7 OGRID No. 005073		8 Operator Name CONOCO, INC.			9 Elevation 6695'

10 Surface Location

UL or lot no.	Section	Township	Range	Lot Idn	Feet from the	North/South line	Feet from the	East/West line	County
D	10	27N	7W		790	North	880	West	RIO ARRIBA

11 Bottom Hole Location If Different From Surface

UL or lot no.	Section	Township	Range	Lot Idn	Feet from the	North/South line	Feet from the	East/West line	County

12 Dedicated Area? W/320	13 Joint or Infill Y	14 Consolidation Code U	15 Order No.
------------------------------------	--------------------------------	-----------------------------------	--------------

NO ALLOWABLE WILL BE ASSIGNED TO THIS COMPLETION UNTIL ALL INTERESTS HAVE BEEN CONSOLIDATED OR A NON-STANDARD UNIT HAS BEEN APPROVED BY THE DIVISION

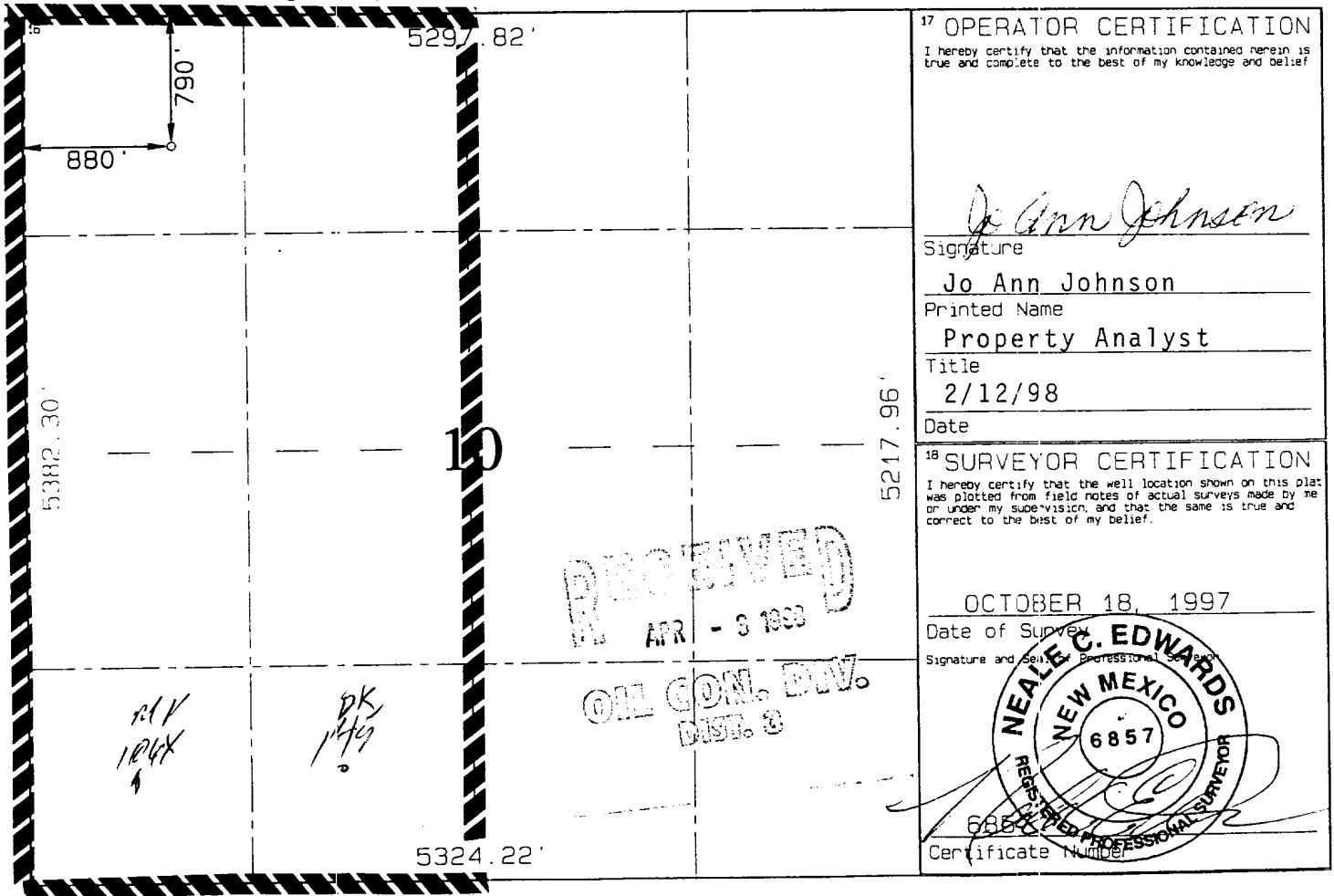

17 OPERATOR CERTIFICATION

I hereby certify that the information contained herein is true and complete to the best of my knowledge and belief

Jo Ann Johnson
Signature
Jo Ann Johnson
Printed Name
Property Analyst
Title
2/12/98
Date

18 SURVEYOR CERTIFICATION

I hereby certify that the well location shown on this plat was plotted from field notes of actual surveys made by me or under my supervision, and that the same is true and correct to the best of my belief.

OCTOBER 18, 1997
Date of Survey
Neale C. Edwards
Signature and Seal of Registered Professional Surveyor
NEALE C. EDWARDS
NEW MEXICO
6857
REGISTERED PROFESSIONAL SURVEYOR
Certificate Number

PROPOSED WELL PLAN OUTLINE

EST. GL = 6696
EST. KB = 6709

WELL NAME: **SJ 28-7 UNIT No. 145M**
LOCATION: **SEC 10, T-27N, R-7W, RIO ARRIBA CO., NM**

TV/D IN 1000 MD	FORMATION TOPS & TYPE	DRILLING PROBLEMS	TYPE OF FORMATION EVALUATION	HOLE SIZE	CASING		FRAC GRAD. psi/ft	FORMATION PRESSURE PSI	MUD		
					SIZE	DEPTH			WT	TYPE	DAYS
0				12-1/4"	9-5/8" 36# K-55 ST&C @ 250'			NORMAL	8.4 - 8.8# SPUD MUD		1
1				8-3/4"	CIRC CMT				8.4 - 9.0# GEL/WATER MAINTAIN MW AS LOW AS POSSIBLE		
2	OJAM @ 2393'	POSSIBLE WATERFLOW								CONTROL FLUID LOSS PRIOR TO OJAM	
	KRLD @ 2559'										
3	FRLD @ 2836'	POSSIBLE GAS FLOW						432 PSI			
	PCCF @ 3249'	POSSIBLE LOST RETURNS POSSIBLE DIFFERENTIAL STICKING						360 PSI			
	LEWS @ 3391'			8-3/4"	7" 23# K-55 LTC at 3649' (special drift) CIRC CMT						5
4	CHRA @ 4211'			8-1/4"					AIR/AIR MIST/GAS		
5	CLFH/MV @ 4934'	PROBABLE LOST RETURNS IF FLUID IN HOLE					0.5	457 PSI			
	MENF @ 5031'										
	PTLK @ 5501'										
6	MNCS @ 5899'										
	GLLP @ 6665'										
7	GRHN @ 7420'										
	GRRS DKOT @ 7479'	POSSIBLE WATERFLOW POSSIBLE OVERPRESSURE IN DEEP DAKOTA	CASED HOLE LOGS	6-1/4"	4-1/2" 9.5# K-55 LTC @ 7755'		0.5	713 PSI	AIR/AIR MIST/GAS		10
	PAGU @ 7646'				10C @ 3400'			BHT = 175 deg F			
8	T.D. @ 7755'										
	NOTE: PERMIT TO 8065'										

DATE 02/02/98
PREPAR Ricky Joyce/Ted Kelly
DRILLING ENGINEER

APPROVALS: M. Shannon
REG. ENGINEER
JBN
PROD. ENGINEER

[Signature]
GEOLOGIST
[Signature]
DRILLING MGR.

10:00 A.M.

