

UNITED STATES
DEPARTMENT OF THE INTERIOR
GEOLOGICAL SURVEY

30-045-25846

5. LEASE DESIGNATION AND SERIAL NO.
NM 05791

6. IF INDIAN, ALLOTTEE OR TRIBE NAME

7. UNIT AGREEMENT NAME

8. FARM OR LEASE NAME
Federal M

9. WELL NO.
I-A

10. FIELD AND POOL, OR WILDCAT
Blanco Mesaverde

11. SEC., T., R., M., OR BLK. AND SURVEY OR AREA
F 3-27N-8W

12. COUNTY OR PARISH
San Juan

13. STATE
N.M.

APPLICATION FOR PERMIT TO DRILL, DEEPEN, OR PLUG BACK

1a. TYPE OF WORK
DRILL ☒ DEEPEN ☐ PLUG BACK ☐

b. TYPE OF WELL
OIL WELL ☐ GAS WELL ☒ OTHER ☐ SINGLE ZONE ☒ MULTIPLE ZONE ☐

2. NAME OF OPERATOR
AAA Operating Company, Inc.

3. ADDRESS OF OPERATOR
Suite 3545

First International Building Dallas, Texas 75270

4. LOCATION OF WELL (Report location clearly and in accordance with any State requirements.)*
At surface

At proposed prod. zone 1500' from North line 1680' from West line

14. DISTANCE IN MILES AND DIRECTION FROM NEAREST TOWN OR POST OFFICE*
15 Miles South

15. DISTANCE FROM PROPOSED* LOCATION TO NEAREST PROPERTY OR LEASE LINE, FT. (Also to nearest drlg. unit line, if any)
RECEIVED OCT 2 1983

16. NO. OF ACRES IN LEASE
4605

17. NO. OF ACRES ASSIGNED TO THIS WELL
w/ 320.62

18. DISTANCE FROM PROPOSED LOCATION* TO NEAREST WELL, DRILLING, COMPLETED, OR APPLIED FOR, ON THIS LEASE, FT.
BUREAU OF LAND MANAGEMENT 5835 GR

19. PROPOSED DEPTH
4605'

20. ROTARY OR CABLE TOOLS
Rotary

21. ELEVATIONS (Show whether DF, RT, GR, etc.)
5835 GR

22. APPROX. DATE WORK WILL START*
Immediately

23. PROPOSED CASING AND CEMENTING PROGRAM

SIZE OF HOLE	SIZE OF CASING	WEIGHT PER FOOT	SETTING DEPTH
9 7/8	8 5/8	23#	180'
7 7/8	4 1/2	9.5#	4605'

This action is subject to administrative appeal pursuant to 30 CFR 290.

Selectively perforate & sand-water frac the Mesaverde Formation.

A 3000 psi WP & 6000 psi test double gate preventer equipped with blind & pipe rams will be used for blow out prevention on this well.

This gas is dedicated.

W/2 Section 3 is dedicated to this well.

RECEIVED
DEC - 6 1983
OIL CON. DIV.
DIST. 3

IN ABOVE SPACE DESCRIBE PROPOSED PROGRAM: If proposal is to deepen or plug back, give data on present productive zone and proposed new productive zone. If proposal is to drill or deepen directionally, give pertinent data on subsurface locations and measured and true vertical depths. Give blowout preventer program, if any.

24. SIGNED R. W. G. TITLE President

(This space for Federal or State office use)

PERMIT NO. APPROVAL DATE

APPROVED BY TITLE

CONDITIONS OF APPROVAL, IF ANY:

*See Instructions On Reverse Side

DATE October 3, 1983

APPROVED
AS AMENDED
NOV 29 1983
AREA MANAGER
FARMINGTON RESOURCE AREA

All distances must be from the outer boundaries of the Section.

Operator: AAA OPERATING COMPANY, INC.			Lease: FEDERAL "M"		Well No.: 1A
Unit Letter: F	Section: 3	Township: 27N	Range: 8W	County: WYNN, COCO San Juan	
Actual Footage Location of Well: 1500 feet from the North line and 1680 feet from the West line					
Ground Level Elev.: 5835	Producing Formation: Mesa Verde		Pool:	Dedicated Acreage: 320.60 Acres	

1. Outline the acreage dedicated to the subject well by colored pencil or hachure marks on the plat below.
2. If more than one lease is dedicated to the well, outline each and identify the ownership thereof (both as to working interest and royalty).
3. If more than one lease of different ownership is dedicated to the well, have the interests of all owners been consolidated by communitization, unitization, force-pooling, etc?

☐ Yes ☐ No If answer is "yes," type of consolidation _____

If answer is "no," list the owners and tract descriptions which have actually been consolidated. (Use reverse side of this form if necessary.) _____

No allowable will be assigned to the well until all interests have been consolidated (by communitization, unitization, forced-pooling, or otherwise) or until a non-standard unit, eliminating such interests, has been approved by the Division.

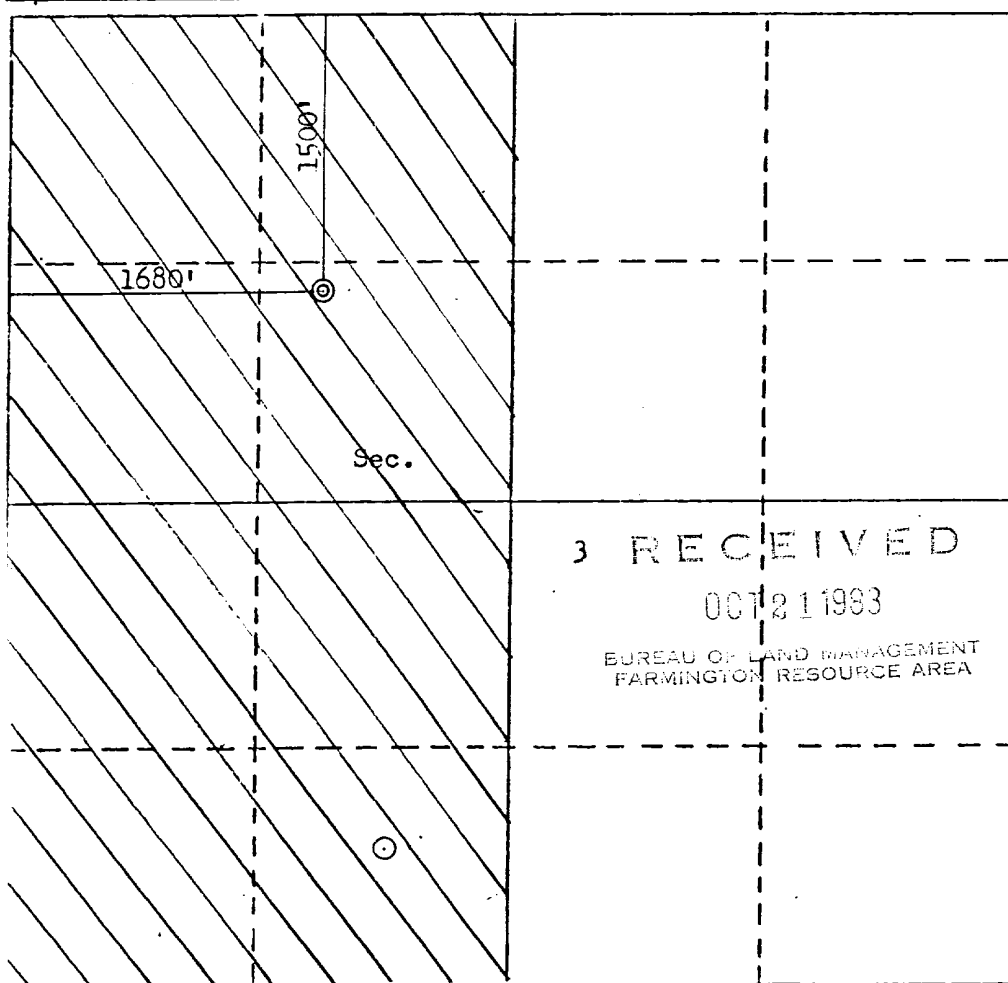

CERTIFICATION

I hereby certify that the information contained herein is true and complete to the best of my knowledge and belief.

Name
R. C. WYNN
Position
PRESIDENT
Company
AAA OPERATING COMPANY, INC.
Date
October 3, 1983

I hereby certify that the well location shown on this plat was plotted from field notes of actual surveys made by me or under my supervision, and that the same is true and correct to the best of my knowledge and belief.

Date Surveyed
June 7, 1979
Registered Professional Engineer and Oil and Gas Surveyor
Fred B. Kerr Jr.
Certified **B. KERR, JR.**
3950

