

UNITED STATES  
DEPARTMENT OF THE INTERIOR  
BUREAU OF LAND MANAGEMENT

FORM APPROVED  
Budget Bureau No. 1004-0135  
Expires: March 31, 1993

SUNDRY NOTICES AND REPORTS ON WELLS

Do not use this form for proposals to drill or to deepen or reentry to a different reservoir.

Use "APPLICATION FOR PERMIT--" for such proposals.

SUBMIT IN TRIPLICATE

1. Type of Well

☐

Oil  
Well

☒

Gas  
Well

☐

Other

2. Name of Operator

GREYSTONE ENERGY, INC.

3. Address and Telephone No.

5802 HIGHWAY 64, FARMINGTON, NM 87401

Phone: (505) 632-8056

4. LOCATION OF WELL (Footage, Sec., T., R., M., or Survey Description)

1553' FSL & 1520' FEL

SEC. 26, T26N, R8W

5. Lease Designation and Serial No.

NMSF 078431

6. Indian, Allottee or Tribe Name

7. If Unit or CA, Agreement Designation

8. Well Name and No.

CON HALE 3E

9. API Well No.

30-045-25984

10. Field and Pool, Or Exploratory Area

FRUITLAND COAL

11. County or Parish, State

SAN JUAN, NEW MEXICO

12. CHECK APPROPRIATE BOX(S) TO INDICATE NATURE OF NOTICE, REPORT, OR OTHER DATA

TYPE OF SUBMISSION

☒

Notice of Intent

☐

Subsequent Report

☐

Final Abandonment Notice

TYPE OF ACTION

☐

Abandonment

☒

Recompletion

☐

Plugging Back

☐

Casing Repair

☐

Altering Casing

☐

Other

☐

Change of Plans

☐

New Construction

☐

Non-Routine Fracturing

☐

Water Shut-Off

☐

Conversion to Injection

☐

Dispose Water

(Note: Report results of multiple completion on Well Completion or Recompletion Report and Log form.)

13. Describe Proposed or Completed Operations (Clearly state all pertinent details, and give pertinent dates, including estimated date of starting any proposed work. If well is directional drilled, give subsurface locations and measured and true vertical depths for all markers and zones pertinent to this work.)

See attached Recompletion to Fruitland Coal procedure for above referenced well.  
The work will be done based on rig availability.

14. I hereby certify that the foregoing is true and correct

Signed

*Ray S. Pimental*

Title

PRODUCTION TECHNICIAN

Date

May 8, 2001

(This space for Federal or State office use)

Approved by

Title

Date

5/18/01

Conditions of Approval, if any:

Title 18 U.S.C. Section 1001, makes it a crime for any person knowingly and wilfully to make any department or agency of the United States any false, fictitious or fraudulent statements or representations as to any matter within its jurisdiction.

\*See Instruction on Reverse Side

HOLD C104 FOR *NSL*

NMOCD

K

Con Hale 3E  
1553' FSI. & 1520' FEL  
Sec 26, T26N, R8W  
San Juan County, NM  
NMSF - 078431

Recompletion to Fruitland Coal

Elevations: KB 6,941'  
GL 6,929'

5-1/2" 17 & 15.5# N-80 and J-55 casing set @ 7,320'  
DV tool set @ 2,848', cemented to surface.  
Current PBTD 7,010'

1. ND wellhead. NU and test BOPE.
2. RU WL unit. Run GR-CCl from 2,700' to surface. TIIH and set CIBP @ 2,700'.  
Dump bail 10' of cement of top of CIBP.
3. Load hole and pressure test casing to 2000 psi for 15 minutes.
4. Perforate Fruitland Coal as follows:

2,612' - 2,616'	2 SPF
2,580' - 2,584'	2 SPF
2,550' - 2,558'	2 SPF
2,522' - 2,530'	2 SPF
2,516' - 2,518'	2 SPF
2,496' - 2,500'	2 SPF

All depths based on Gearhart Laser log ran 7-25-84

5. Frac Fruitland Coal down casing with 150,000# of sand. (Frac procedure to follow).
6. Flow back frac until well is dead.
7. MI and RU service rig. RIH with tubing, clean out fill and swab test for 4 hours or until sand cleans up.
8. Run 2-7/8" production tubing and anchor. Set anchor with 20M# of shear.
9. Run rods and pump.
10. Install pumping unit and place well on production. Monitor load recovery with Howco meter.

Form C-102  
Revised October 18, 1994  
Instructions on back  
to Appropriate District Office  
State Lease - 4 Copies  
Fee Lease - 3 Copies

HOLD C104 FOR NSL

All distances must be from the outer boundaries of the Section.

Operator <b>CONSOLIDATED OIL &amp; GAS, INC.</b>			Lease <b>CON HALE</b>		Well No. <b>3E</b>
Unit Letter <b>J</b>	Section <b>26</b>	Township <b>26 NORTH</b>	Range <b>8 WEST</b>	County <b>SAN JUAN</b>	
Actual Footage Location of Well: <b>1553</b> feet from the <b>SOUTH</b> line and <b>1520</b> feet from the <b>EAST</b> line					
Ground Level Elev. <b>6929</b>	Producing Formation <b>Dakota</b>		Pool <b>Basin Dakota</b>		Dedicated Acreage: <b>320</b> Acres

1. Outline the acreage dedicated to the subject well by colored pencil or hatchure marks on the plat below.
2. If more than one lease is dedicated to the well, outline each and identify the ownership thereof (both as to working interest and royalty).
3. If more than one lease of different ownership is dedicated to the well, have the interests of all owners been consolidated by communitization, unitization, force-pooling, etc?

☐ Yes ☐ No If answer is "yes," type of consolidation \_\_\_\_\_

If answer is "no," list the owners and tract descriptions which have actually been consolidated. (Use reverse side of this form if necessary.) \_\_\_\_\_

No allowable will be assigned to the well until all interests have been consolidated (by communitization, unitization, forced-pooling, or otherwise) or until a non-standard unit, eliminating such interests, has been approved by the Division

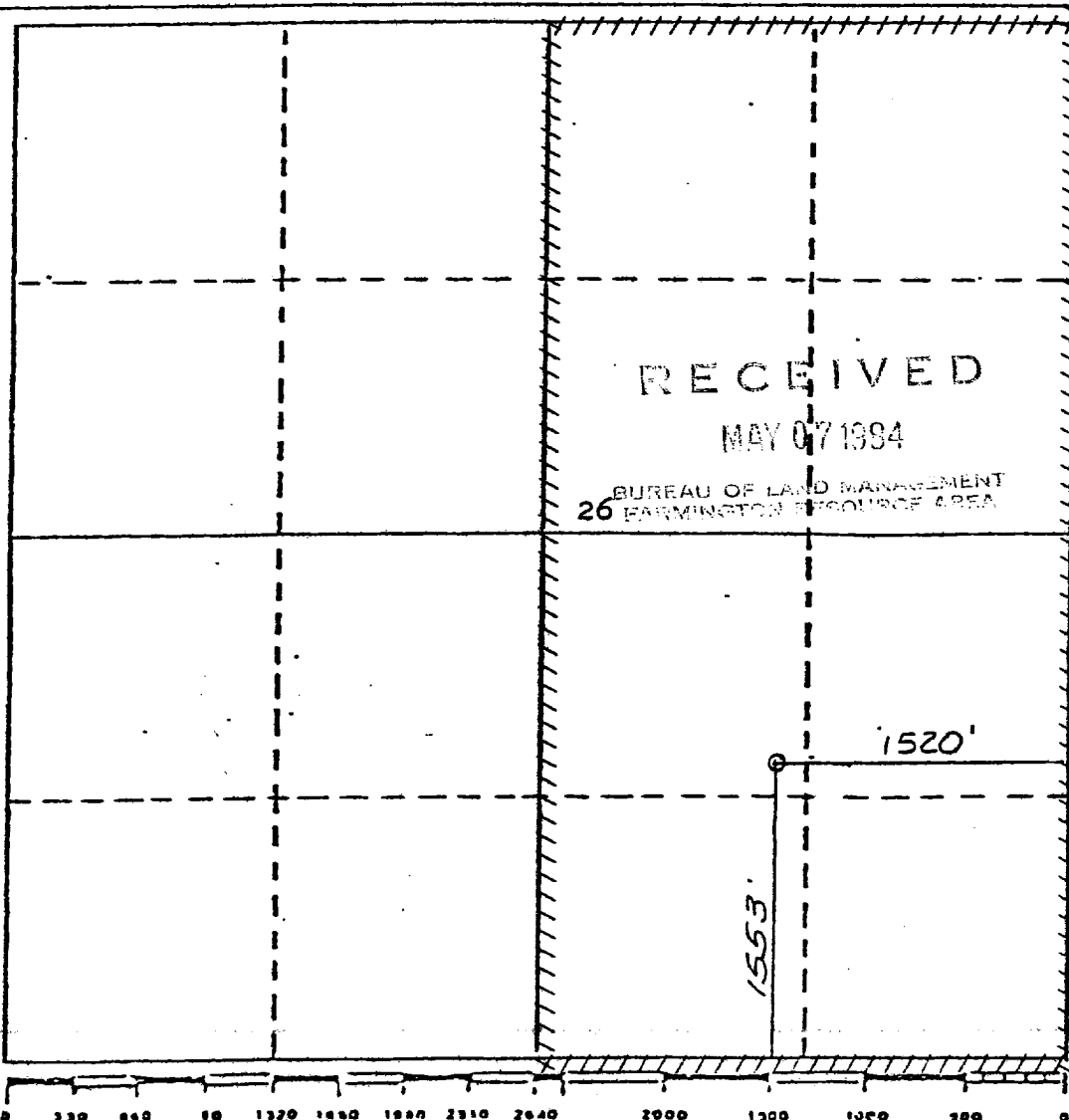

## CERTIFICATION

I hereby certify that the information contained herein is true and complete to the best of my knowledge and belief.

Name

Barney Jones

Position

Drilling Foreman

Company

Consolidated Oil &amp; Gas, Inc.

Date

May 1, 1984

I hereby certify that the well location shown on this plat was plotted from field notes actually made by me or under my supervision, and that the same is true and correct to the best of my knowledge and belief.

Date

March 10, 1984

Registered Professional Engineer  
and/or Land Surveyor

Michael Daly

Certificate No.

5992

B.L.M.