



STATE OF NEW MEXICO
ENERGY, MINERALS AND NATURAL RESOURCES DEPARTMENT

OIL CONSERVATION DIVISION
2040 S. PACHECO
SANTA FE, NEW MEXICO 87505
(505) 827-7131

July 1, 1996

RECEIVED
JUL 08 1996
OIL CON. DIV
DIST. 3

Dugan Production Corp.
P. O. Box 420
Farmington, New Mexico 87499-0420
Attention: Gary Brink

Administrative Order NSL-3685

Dear Mr. Brink:

Reference is made to your application dated June 5, 1996 for a non-standard Basin-Fruitland coal gas well location for your existing Irish Well No. 2 (API No. 30-045-26093), which was drilled in 1984 and completed in the WAW-Fruitland Sand-Pictured Cliffs Pool at a standard gas well location 790 feet from the South and East lines (Unit P) of Section 11, Township 26 North, Range 13 West, NMPM, San Juan County, New Mexico.

It is our understanding that the Fruitland Sand-Pictured Cliffs interval will be properly plugged back and said well will be recompleted to the Basin-Fruitland Coal (Gas) Pool, which pursuant to the "*Special Rules and Regulations for the Basin-Fruitland Coal (Gas) Pool*", as promulgated by Division Order No. R-8768, as amended, is also unorthodox.

By the authority granted me under the provisions of Rule 8 of said Order No. R-8768, as amended, the above-described unorthodox coal gas well location for the Irish Well No. 2 is hereby approved.

Sincerely,

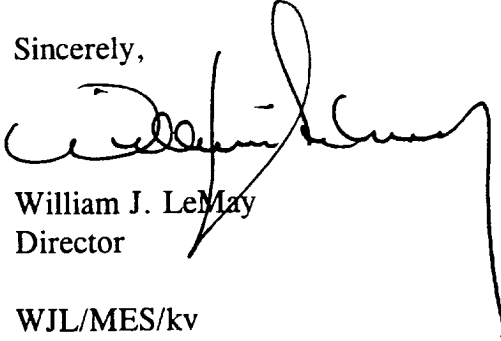

William J. LeMay
Director

WJL/MES/kv

cc: Oil Conservation Division - Aztec ✓
U.S. Bureau of Land Management - Farmington

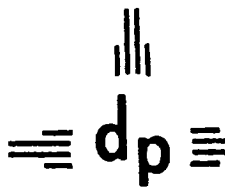

dugan production corp.



June 5, 1996

Mr. Michael E. Stogner
New Mexico Oil Conservation Division
2040 South Pacheco Street
Santa Fe, NM 87505

**Subject: Administrative Approval of Unorthodox Location
Dugan Production Corp.
Irish #2
790' FSL & 790' FEL, Sec. 11, T26N, R13W, NMPM
San Juan County, NM
Basin Fruitland Coal**

Dear Mr. Stogner:

Dugan Production Corp. requests administrative approval for an unorthodox location for its Irish No. 2 well under the provisions of NMOCD Order No. R-8768.

The subject well is currently completed in the Pictured Cliffs formation and it is nonproductive. It is intended to abandon the Pictured Cliffs zone and recomplete in the Basin Fruitland Coal.

A copy of this application is being submitted to all offset operators by certified mail with a request that they furnish your office in Santa Fe a Waiver of Objection.

Attached is a well location plat showing dedicated acreage, a well location map and a map showing all offsetting operators.

Sincerely,

Gary W. Brink

GWB/cg

cc: New Mexico Oil Conservation Division, Aztec
Bureau of Land Management, Farmington
Offset Operators

RECEIVED
JUN - 6 1996

OIL CON. DIV.
DIST. 3

District I
PO Box 1789, Hobbs, NM 88241-1789
District II
PO Drawer DD, Artesia, NM 88211-0719
District III
1000 Rio Bruma Rd., Aztec, NM 87410
District IV
PO Box 2088, Santa Fe, NM 87504-2088

State of New Mexico
Energy, Minerals & Natural Resources Department

OIL CONSERVATION DIVISION
PO Box 2088
Santa Fe, NM 87504-2088

Form C-102
Revised February 21, 1994
Instructions on back
Submit to Appropriate District Office
State Lease - 4 Copies
Fee Lease - 3 Copies

☐ AMENDED REPORT

WELL LOCATION AND ACREAGE DEDICATION PLAT

* API Number 30 045 26093		* Pool Code 71629		* Pool Name Basin Fruitland Coal	
* Property Code 003713		* Property Name Irish			* Well Number 2
* OGRID No. 006515		* Operator Name Dugan Production Corp.			* Elevation 6023' GL

10 Surface Location

UL or lot no.	Section	Township	Range	Lot Ids	Feet from the	North/South Line	Feet from the	East/West Line	County
P	11	26N	13W		790	South	790	East	San Juan

11 Bottom Hole Location If Different From Surface

UL or lot no.	Section	Township	Range	Lot Ids	Feet from the	North/South Line	Feet from the	East/West Line	County

* Dedicated Acres 320	* Joint or Infill	* Consolidation Code	* Order No. Will be communitized
--------------------------	-------------------	----------------------	-------------------------------------

NO ALLOWABLE WILL BE ASSIGNED TO THIS COMPLETION UNTIL ALL INTERESTS HAVE BEEN CONSOLIDATED
OR A NON-STANDARD UNIT HAS BEEN APPROVED BY THE DIVISION

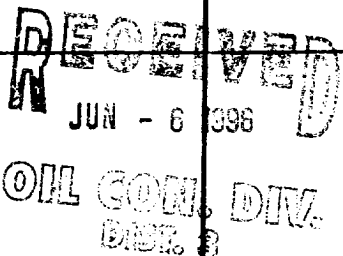
16				17 OPERATOR CERTIFICATION I hereby certify that the information contained herein is true and complete to the best of my knowledge and belief  Signature Gary Brink Printed Name Operations Manager Title 6/5/96 Date	
				18 SURVEYOR CERTIFICATION I hereby certify that the well location shown on this plat was plotted from field notes of actual surveys made by me or under my supervision, and that the same is true and correct to the best of my belief. August 17, 1984 Date of Survey Signature and Seal of Professional Surveyor: original plat surveyed & signed by Edgar L. Risenhoover, 5979 Certificate Number	
Lease #NM 57580 Southland Royalty		Lease #NM 10757 Dugan Prod. 50% Hawthorn Oil 50%			
Lease #NM 10757 Dugan Prod. 50% Hawthorn Oil 50%		Lease #NM 57580 Southland Roy. 790' 790'			

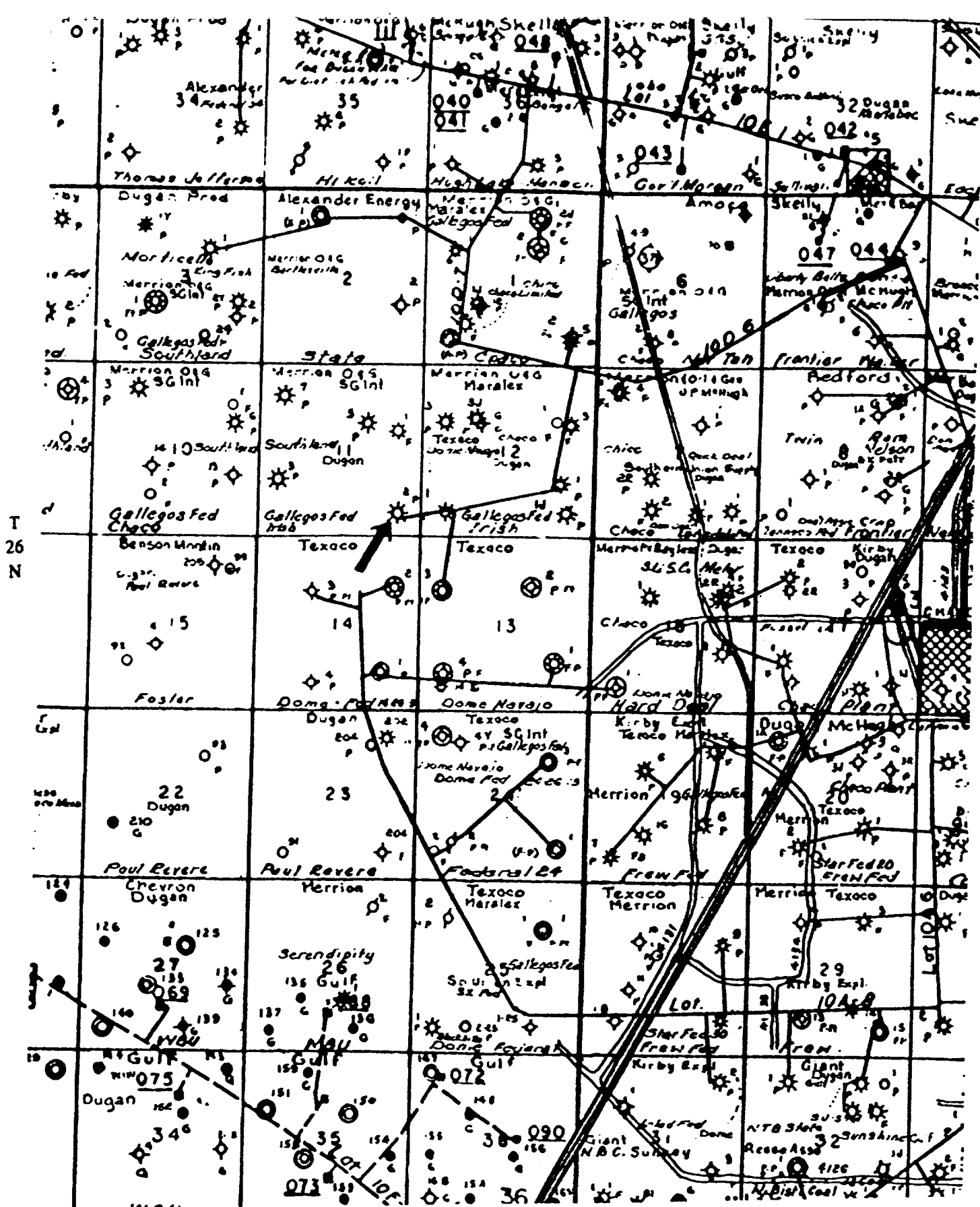

R13W

Application for Unorthodox Location

Dugan Production Corp.

Irish #2

Unit P, Sec 11, T26N, R13W, San Juan Co., N.M.

Basin Fruitland Coal

Well Location Map

Application for Unorthodox Location
Dugan Production Corp.
Irish #2
Unit P, Sec 11, T26N, R13W, San Juan Co., N.M.
Basin Fruitland Coal
Offset Operator Map

