

UNITED STATES
DEPARTMENT OF THE INTERIOR
GEOLOGICAL SURVEY

APPLICATION FOR PERMIT TO DRILL, DEEPEN, OR PLUG BACK

1a. TYPE OF WORK

DRILL ☒DEEPEN ☐PLUG BACK ☐

b. TYPE OF WELL

OIL
WELL ☐GAS
WELL ☒

OTHER

SINGLE
ZONE ☒MULTIPLE
ZONE ☐

2. NAME OF OPERATOR

SOUTHERN UNION EXPLORATION COMPANY

3. ADDRESS OF OPERATOR

PO BOX 2179 FARMINGTON NM 87499

4. LOCATION OF WELL (Report location clearly and in accordance with any State requirements.*)

At surface

890' FNL & 1510' FWL

At proposed prod. zone

14. DISTANCE IN MILES AND DIRECTION FROM NEAREST TOWN OR POST OFFICE*

35 miles south east of Bloomfield, NM

15. DISTANCE FROM PROPOSED*

LOCATION TO NEAREST
PROPERTY OR LEASE LINE, FT.
(Also to nearest drlg. unit line, if any)

4390'

18. DISTANCE FROM PROPOSED LOCATION*
TO NEAREST WELL, DRILLING, COMPLETED,
OR APPLIED FOR, ON THIS LEASE, FT.

826'

16. NO. OF ACRES IN LEASE

2480.

19. PROPOSED DEPTH

7000'

17. NO. OF ACRES ASSIGNED
TO THIS WELL

320

20. ROTARY OR CABLE TOOLS

Rotary 0-7000'

21. ELEVATIONS (Show whether DF, RT, GR, etc.)

6603 6614' GR

22. APPROX. DATE WORK WILL START*

February 1985

23.

DRILLING OPERATIONS AUTHORIZED ARE
SUBJECT TO COMPLIANCE WITH ATTACHED
PROPOSED CASING AND CEMENTING PROGRAM
"GENERAL REQUIREMENTS"This action is subject to administrative
appeal pursuant to 30 CFR 290.
QUANTITY OF CEMENT

SIZE OF HOLE	SIZE OF CASING	WEIGHT PER FOOT	SETTING DEPTH	QUANTITY OF CEMENT
12 1/2"	8 5/8"	32.0#	350'	307 cu ft Class B w/2% CaCl ₂
4 1/2"	7 7/8"	11.6# & 10.5#	7000'	1st 383 cu ft 50/50 poz, 2% gel 2nd 418 cu ft 65/35 poz, 6% gel & 59 cu ft Class B neat

- Spud rat hole & mouse hole; Drill 12 1/2" surface hole to 350' w/water & benex.
Run 8 jts 8 5/8", 32.0#, K-55 ST&C csg. Cement w/307 cu ft Class B Cement.
- WOC 12 hrs. NU BOP & pressure test to 1000 psi.
- Drill out surface csg and 7 7/8" hole to 7000' w/low solids mud.
- Run dual induction log 7000' to surface, CNL-FDC through productive intervals
- Run 4 1/2" 11.6# csg (7000'-4250') & 10.5# csg (4250'-surface) w/stage tool @ \pm 2400'.
Cmt 1st stage to fill to 5700', cmt 2nd stage to fill to 1000'. (cover Ojo Alamo @ \pm 1260'). Set slips & NU wellhead.
- Run temperature survey 8-16 hrs after plug down to locate TOC.
- Perforate & stimulate the Dakota 6710-6900'.

IN ABOVE SPACE DESCRIBE PROPOSED PROGRAM: If proposal is to deepen or plug back, give data on present productive zone and proposed new productive zone. If proposal is to drill or deepen directionally, give pertinent data on subsurface locations and measured and true vertical depths. Give blowout preventer program, if any.

24.

SIGNED

J. B. Schaefer

Div Drlg & Prod Engineer DATE 11-12-84

(This space for Federal or State use)

PERMIT NO.

APPROVAL DATE

APPROVED BY

CONDITIONS OF APPROVAL, IF ANY:

RECEIVED
JAN 07 1985OIL CON. DIV.
DIST. 3APPROVED
AS AMENDED

JAN 04 1985

7s/J. Stan McKee

ASST. AREA MANAGER
FARMINGTON RESOURCE AREA

All distances must be from the outer boundaries of the Section.

Operator SOUTHERN UNION EXPLORATION COMPANY			Lease HODGES		Well No. 11E
Unit Letter C	Section 27	Township 26N	Range 8W	County San Juan	
Actual Footage Location of Well: 830 feet from the North line and 1510 feet from the West line					
Ground Level Elev: 6608	Producing Formation Dakota		Pool Basin Dakota		Dedicated Acreage 320 Acres

1. Outline the acreage dedicated to the subject well by colored pencil or hachure marks on the plat below.
2. If more than one lease is dedicated to the well, outline each and identify the ownership thereof (both as to working interest and royalty).
3. If more than one lease of different ownership is dedicated to the well, have the interests of all owners been consolidated by communitization, unitization, force-pooling, etc?

☐ Yes ☐ No If answer is "yes," type of consolidation _____

If answer is "no," list the owners and tract descriptions which have actually been consolidated. (Use reverse side of this form if necessary.) _____

No allowable will be assigned to the well until all interests have been consolidated (by communitization, unitization, forced-pooling, or otherwise) or until a non-standard unit, eliminating such interests, has been approved by the Commission.

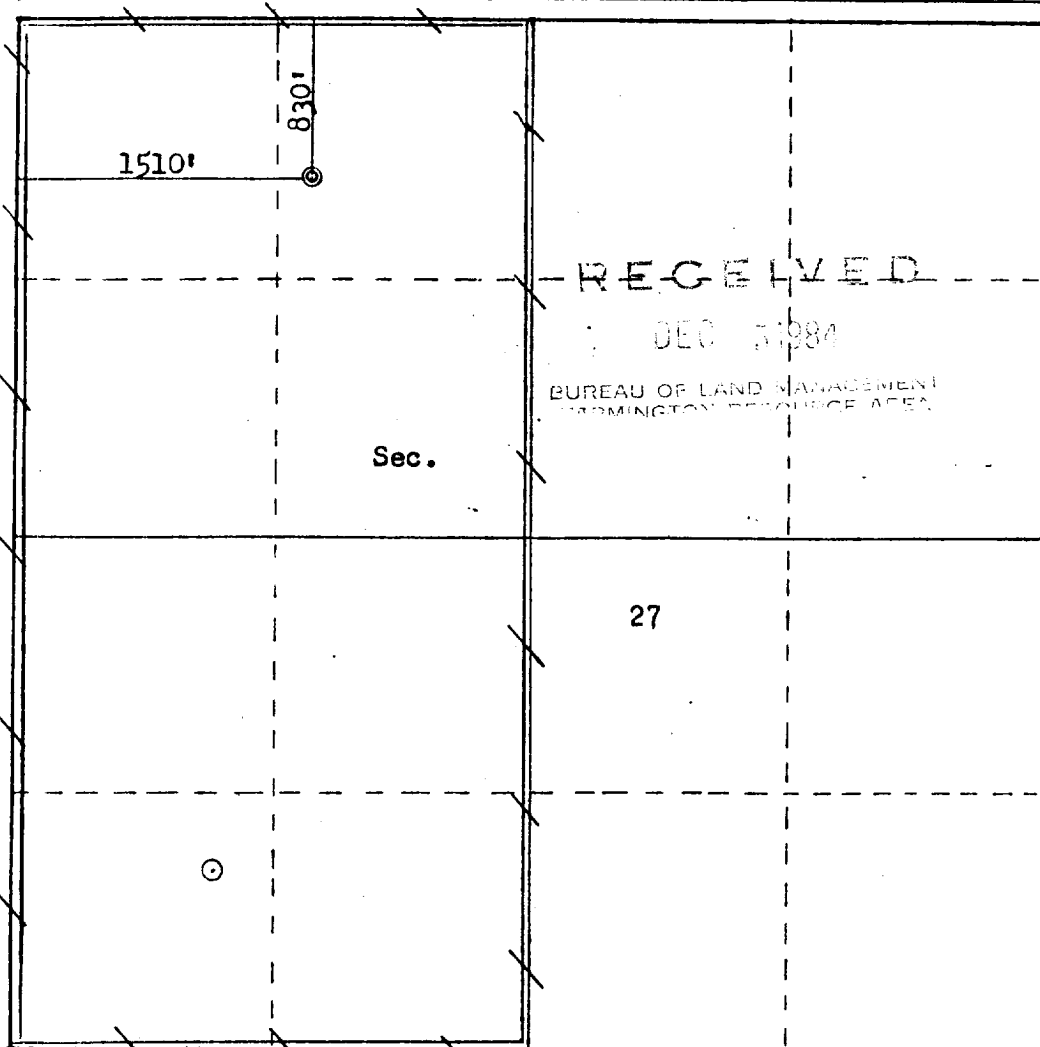

Scale: 1"=1000'

CERTIFICATION

I hereby certify that the information contained herein is true and complete to the best of my knowledge and belief.

Jeffrey J. Bollschweiler

Name *Bollschweiler*

Position *Drlg. & Prod. Engineer*

Company *Southern Union Exploration*

Date *December 4, 1984*

I hereby certify that the well location shown on this plat was plotted from field notes of actual surveys made by me or under my supervision, and that the same is true and correct to the best of my knowledge and belief.

Date Surveyed *November 30, 1984*

Registered Professional Engineer and Land Surveyor

Fred B. Kern Jr.

Certificate No. *3950*

133 OOMFIELD

