

NO. OF COPIES RECEIVED	
DISTRIBUTION	
SANTA FE	
FILE	
U.S.G.S.	
LAND OFFICE	
OPERATOR	

# NEW MEXICO OIL CONSERVATION COMMISSION

Form C-101  
Revised 1-1-65

5A. Indicate Type of Lease	
STATE <input checked="" type="checkbox"/>	FEE <input type="checkbox"/>
5. State Oil & Gas Lease No.	
E-9895-3	

## APPLICATION FOR PERMIT TO DRILL, DEEPEN, OR PLUG BACK

1a. Type of Work		7. Unit Agreement Name	
b. Type of Well		8. Farm or Lease Name	
DRILL <input checked="" type="checkbox"/> DEEPEN <input type="checkbox"/> PLUG BACK <input type="checkbox"/>		Moncrief Com	
OIL WELL <input type="checkbox"/> GAS WELL <input checked="" type="checkbox"/> OTHER <input type="checkbox"/>		9. Well No.	
2. Name of Operator		1E	
El Paso Natural Gas Company		10. Field and Pool, or Wildcat	
3. Address of Operator		Basin Dakota	
PO Box 4289, Farmington, NM 87499		8/320	
4. Location of Well		12. County	
UNIT LETTER B LOCATED 820 FEET FROM THE North LINE		San Juan	
AND 1840 FEET FROM THE East LINE OF SEC. 16 TWP. 26N RGE. 11W NMPM			
		19. Proposed Depth	
		6285'	
		19A. Formation	
		Dakota	
		20. Rotary or C.T.	
		Rotary	
21. Elevations (Show whether DF, RT, etc.)		22. Approx. Date Work will start	
6277' GL			
21A. Kind & Status Plug. Bond		21B. Drilling Contractor	
statewide			

23.

## PROPOSED CASING AND CEMENT PROGRAM

SIZE OF HOLE	SIZE OF CASING	WEIGHT PER FOOT	SETTING DEPTH	SACKS OF CEMENT	EST. TOP
12 1/4"	8 5/8"	24.0#	200'	165 cu.ft.	circ. surface
7 7/8"	4 1/2"	10.5# & 11.6#	6285'	1900 cu.ft.	circulated

1st stage - 361 cu.ft. to cover Gallup  
2nd stage - 859 cu.ft. to cover Mesa Verde  
3rd stage - 680 cu.ft. to cover Ojo Alamo

Selectively perforate and sandwater fracture the Dakota formation.

A 3000 psi WP and 6000 psi test double gate preventer equipped with blind and pipe rams will be used for blow out prevention on this well.

This gas is dedicated. APPROVAL EXPIRES 8-15-85  
UNLESS DRILLING IS COMMENCED.  
SPUD NOTICE MUST BE SUBMITTED  
WITHIN 10 DAYS.

The E/2 of Section 16 is dedicated to this well.

RECEIVED  
FEB 15 1985

OIL CON. DIV.  
DIST. 2

IN ABOVE SPACE DESCRIBE PROPOSED PROGRAM; IF PROPOSAL IS TO DEEPEN OR PLUG BACK, GIVE DATA ON PRESENT PRODUCTIVE ZONE AND PROPOSED NEW PRODUCTIVE ZONE. GIVE BLOWOUT PREVENTER PROGRAM, IF ANY.

I hereby certify that the information above is true and complete to the best of my knowledge and belief.

Signed Peggy Doak Title Drilling Clerk Date February 14, 1985

(This space for State Use)  
APPROVED BY [Signature] TITLE SUPERVISOR DISTRICT #3 DATE FEB 15 1985  
CONDITIONS OF APPROVAL, IF ANY:

## OIL CONSERVATION DIVISION

P. O. BOX 2088

STATE OF NEW MEXICO  
ENERGY AND MINERALS DEPARTMENT

SANTA FE, NEW MEXICO 87501

Form C-107  
Revised 10-1

All distances must be from the outer boundaries of the Section.

Operator EL PASO NATURAL GAS COMPANY			Lease MONCRIEF COM (E-9895-3)		Well No. 1E
Unit Letter B	Section 16	Township 26N	Range 11W	County San Juan	
Actual Footage Location of Well: 820 feet from the North line and 1840 feet from the East line					
Ground Level Elev: 6277	Producing Formation Dakota		Pool Basin	Dedicated Acreage: 320 Acres	

1. Outline the acreage dedicated to the subject well by colored pencil or hachure marks on the plat below.
2. If more than one lease is dedicated to the well, outline each and identify the ownership thereof (both as to working interest and royalty).
3. If more than one lease of different ownership is dedicated to the well, have the interests of all owners been consolidated by communitization, unitization, force-pooling, etc?

☐ Yes ☐ No If answer is "yes," type of consolidation \_\_\_\_\_

If answer is "no," list the owners and tract descriptions which have actually been consolidated. (Use reverse side of this form if necessary.) \_\_\_\_\_

No allowable will be assigned to the well until all interests have been consolidated (by communitization, unitization, forced-pooling, or otherwise) or until a non-standard unit, eliminating such interests, has been approved by the Commission.

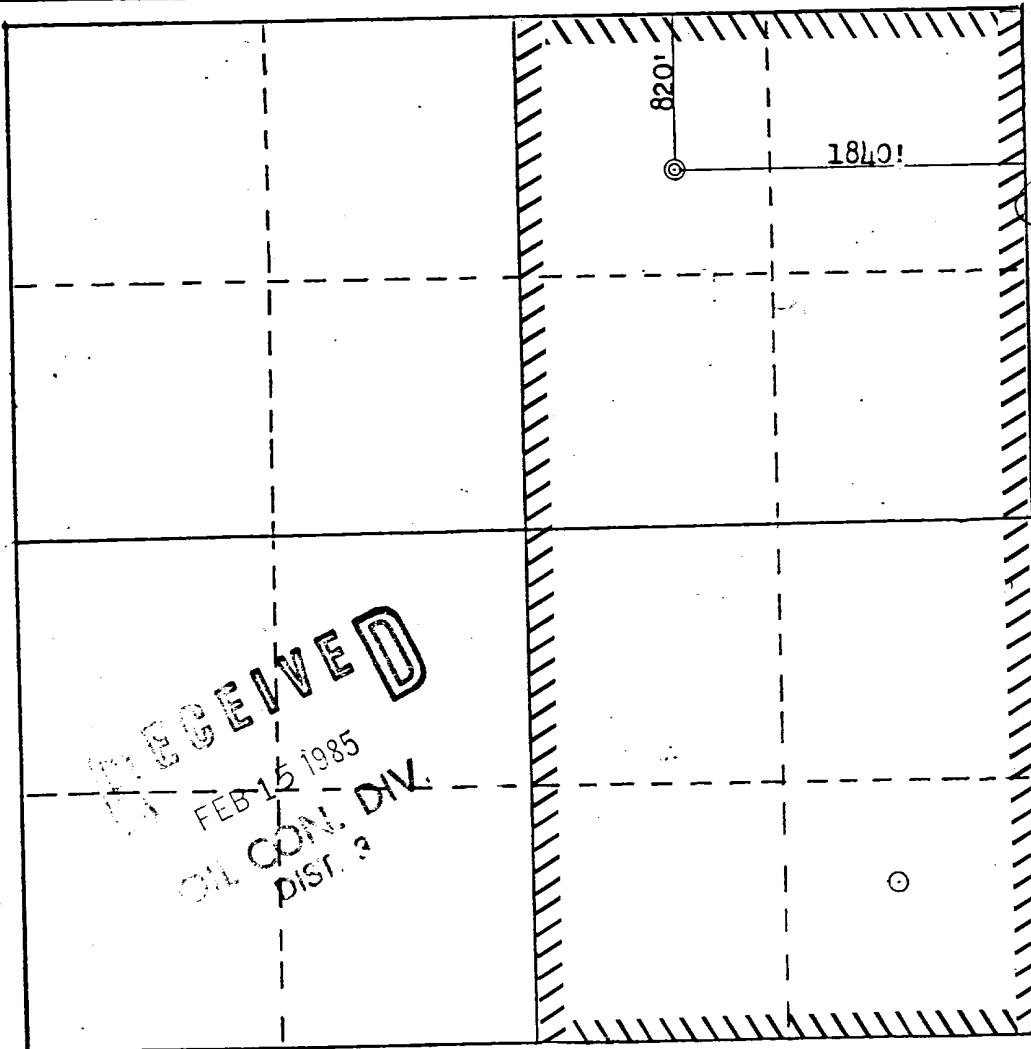

## CERTIFICATION

I hereby certify that the information contained herein is true and complete to the best of my knowledge and belief.

*Reggie Doak*

Name  
Drilling Clerk

Position  
El Paso Natural Gas Co.

Company  
February 14, 1985

Date

I hereby certify that the well location shown on this plat was plotted from field notes of actual surveys made by me or under my supervision, and that the same is true and correct to the best of my knowledge and belief.

Date Surveyed

Registered Professional Engineer  
and Land Surveyor

Fred B. Kerr Jr.

Certificate No.

DATE REVIEWED: \_\_\_\_\_  
REVIEWED BY: \_\_\_\_\_  
(FOR BIA USE ONLY)

February 14, 1985

Navajo Indian Irrigation Project  
3539 East 30th Street, NW Energy Building, Room 103  
Farmington, New Mexico 87401-87499

Date:

RE: NIIP ARCHEOLOGICAL AND HISTORICAL CLEARANCE UPDATE (Project Description): \_\_\_\_\_  
El Paso Natural Gas Company's Moncrief Com #1E gas well location

Dear Project Manager:

I hereby request archeological clearance for a project which I believe is located entirely within the boundaries of the Navajo Indian Irrigation Project. This project will consist of (brief description); \_\_\_\_\_  
drilling a gas well to the Basin Dakota formation

\_\_\_\_\_ : and is designated by the following name and/or number in our company files; Moncrief Com #1E ; as shown on the attached map(s); 3 copies provided and enclosed.

The project is located in Township 26 N, Range 11 W, Section 16 in the 820'N of the 1840'E of the \_\_\_\_\_  
(describing a 10 acre parcel). Access will be obtained as also shown on the attached map. No more than 2 acres  
(\_\_\_\_\_ hectares) will be used or occupied considering all direct and indirect effects of proposed project activities

I certify that I am the duly authorized agent of the proposed project sponsor and will take responsibility for the accuracy of the information submitted above. When clearance is received I will assure that the instructions as indicated below and in any future guidance from you for this project will be followed.

Donald C. Walker  
Signature

Archeological clearance for the area described is hereby granted under the terms of the Memorandum of Agreement for Protection of Archeological and Historical resources in the Navajo Indian Irrigation Project consummated by the Advisory Council for Historic Preservation on July 17, 1977.

The area of the currently proposed project was intensively inventoried for archeological and historical resources as documented in (Report # \_\_\_\_\_). These sites (listed by number) were located in the area of this newly proposed project: \_\_\_\_\_

These sites (listed by number) were located within 100 feet (33 meters) of the newly proposed project and special efforts should be taken to avoid inadvertent impacts in these areas: \_\_\_\_\_

This clearance does not constitute approval of right-of-way, concurrence in the proposed action by the Bureau of Indian Affairs, or approval to proceed with the project. This clearance constitutes one of several mandated requirements which must be completed prior to the granting of rights-of-way, easements, or approval by the BIA for land modifying projects proposed within the Navajo Indian Irrigation Project boundaries.

IT IS THE RESPONSIBILITY OF THE PROJECT SPONSOR TO ACQUAINT CONTRACTORS AND SUB-CONTRACTORS WITH THE BOUNDARIES FOR WHICH THIS CLEARANCE IS GRANTED.

Discovery Clause (36 CFR Part 800.7) Should any archeological or historical resources be discovered during project operations, all work must cease in the immediate area of the exposed resource. The Navajo Tribal Archeologist and the BIA Navajo Area Archeologist shall be notified to arrange an on-site inspection for the purpose of determining the significance and disposition of the remains. Such discoveries may be subject to the provisions and prohibitions of the Archeological Resources Protection Act (P.L. 96-95, Title 43 Code of Federal Regulations, Part 7).

THE PROJECT SPONSOR IS RESPONSIBLE FOR ADVISING CONTRACTORS AND SUB-CONTRACTORS OF THIS REQUIREMENT AND ASSURING ITS COMPLIANCE.

NIIP Project Manager

Date

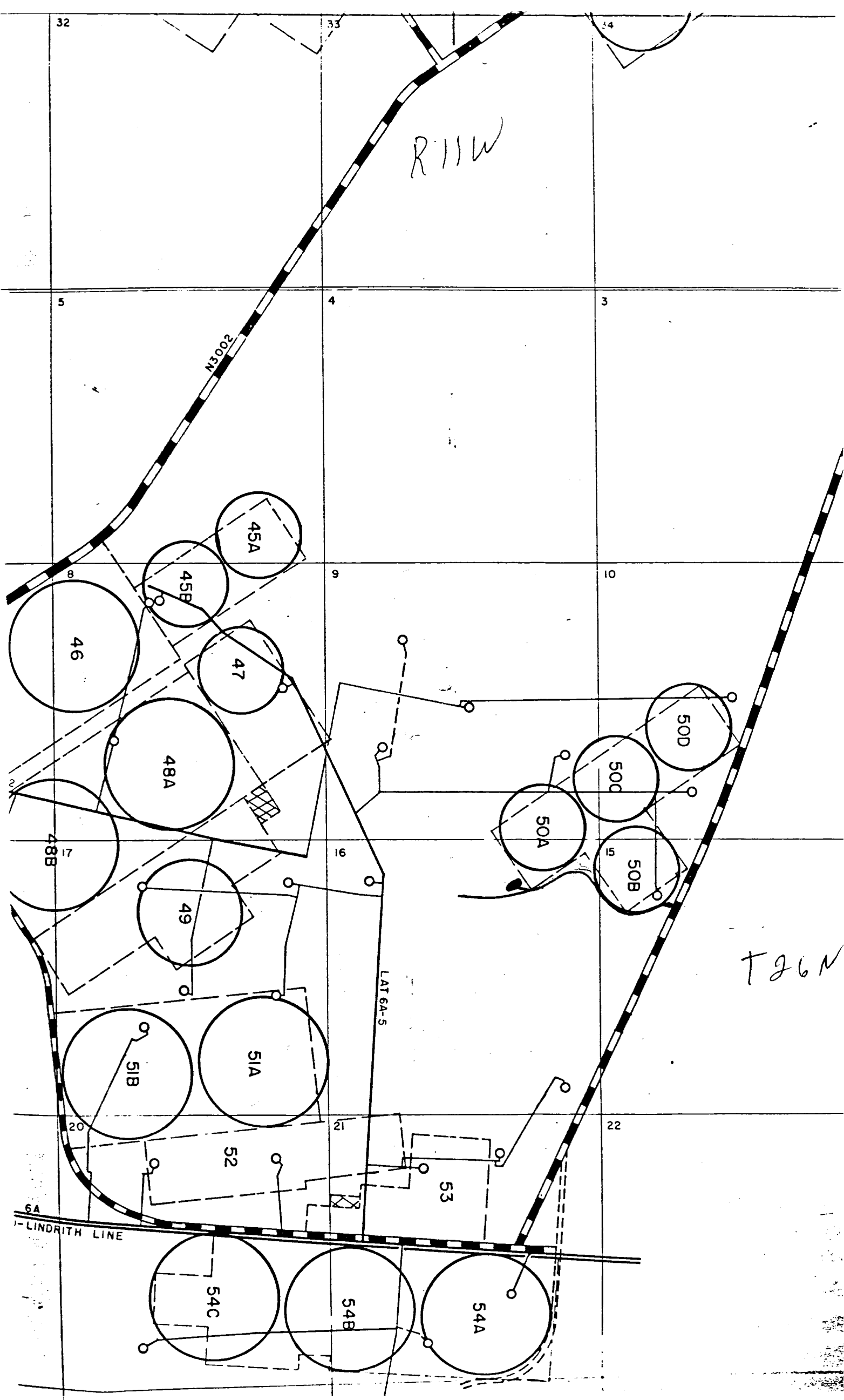

R11W

N3002

T26N

LAT 6A-5

LINDRITH LINE

45A

45B

46

47

48A

48B

49

51B

51A

52

53

54C

54B

54A

50D

50C

50A

50B