

UNITED STATES  
DEPARTMENT OF THE INTERIOR  
BUREAU OF LAND MANAGEMENT

APPLICATION FOR PERMIT TO DRILL, DEEPEN, OR PLUG BACK

1a. TYPE OF WORK

DRILL ☒

DEEPEN ☐

PLUG BACK ☐

b. TYPE OF WELL

OIL  
WELL ☐

GAS  
WELL ☒

OTHER

SINGLE  
ZONE ☒

MULTIPLE  
ZONE ☐

2. NAME OF OPERATOR

El Paso Natural Gas Company

3. ADDRESS OF OPERATOR

PO Box 4289, Farmington, NM 87499

4. LOCATION OF WELL (Report location clearly and in accordance with any State requirements.)\*

At surface

1650'N, 990'E

At proposed prod. zone

14. DISTANCE IN MILES AND DIRECTION FROM NEAREST TOWN OR POST OFFICE\*

19 miles Southeast of Bloomfield, NM

15. DISTANCE FROM PROPOSED\*

LOCATION TO NEAREST  
PROPERTY OR LEASE LINE, FT.

(Also to nearest drlg. unit line, if any) 990'

18. DISTANCE FROM PROPOSED LOCATION\*

TO NEAREST WELL, DRILLING, COMPLETED,  
OR APPLIED FOR, ON THIS LEASE, FT. 800'

21. ELEVATIONS (Show whether DF, RT, GR, etc.)

6370'GL

23.

DRILLING OPERATIONS AUTHORIZED ARE  
SUBJECT TO COMPLIANCE WITH ATTACHED  
"GENERAL REQUIREMENTS"  
PROPOSED CASING AND CEMENTING PROGRAM

5. LEASE DESIGNATION AND SERIAL NO.

SE 078103

6. IF INDIAN, ALLOTTEE OR TRIBE NAME

7. UNIT AGREEMENT NAME

Huerfano Unit

8. FARM OR LEASE NAME

Huerfano Unit

9. WELL NO.

135E

10. FIELD AND POOL, OR WILDCAT

Basin Dakota

11. SEC., T., R., M., OR BLK.  
AND SURVEY OR AREA

Sec. 23, T-26-N, R- 9-W

NMPM

12. COUNTY OR PARISH

San Juan

13. STATE

NM

16. NO. OF ACRES IN LEASE

Unit

19. PROPOSED DEPTH

6700'

17. NO. OF ACRES ASSIGNED  
TO THIS WELL

320.00

20. ROTARY OR CABLE TOOLS

Rotary

22. APPROX. DATE WORK WILL START\*

This action is subject to administrative  
appeal pursuant to 30 CFR 290.

| SIZE OF HOLE | SIZE OF CASING | WEIGHT PER FOOT | SETTING DEPTH | QUANTITY OF CEMENT    |
|--------------|----------------|-----------------|---------------|-----------------------|
| 12 1/4"      | 8 5/8"         | 24.0#           | 200'          | 165 cu.ft.circulated  |
| 7 7/8"       | 4 1/2"         | 10.5#&11.6#     | 6700'         | 1457 cu.ft.circulated |

1st stage - 396 cu.ft. to cover Gallup

2nd stage - 567 cu.ft. to cover Mesa Verde

3rd stage - 494 cu.ft. to cover Ojo Alamo

Selectively perforate and sand water fracture the Dakota formation.

A 3000 psi WP and 6000 psi test double gate preventer equipped with  
blind and pipe rams will be used for blow out prevention on this well.

This gas is dedicated.

The N/2 of Section 23 is dedicated to this well.

IN ABOVE SPACE DESCRIBE PROPOSED PROGRAM: If proposal is to deepen or plug back, give data on present production and proposed new productive zone. If proposal is to drill or deepen directionally, give pertinent data on subsurface locations and measured and true vertical depths. Give blowout preventer program if any.

24.

SIGNED

TITLE

Drilling Clerk

DATE

(This space for Federal or State office use)

PERMIT NO.

APPROVAL DATE

APPROVED BY

TITLE

DATE

CONDITIONS OF APPROVAL, IF ANY:

NMOCC

\*See Instructions On Reverse Side

NEW MEXICO OIL CONSERVATION COMMISSION  
WELL LOCATION AND ACREAGE DEDICATION PLAT

Form C-102  
Supersedes C-128  
Effective 1-1-65

All distances must be from the outer boundaries of the Section.

|   |                                      |                        |   |                           |  |
|---|--------------------------------------|------------------------|---|---------------------------|--|
| Operator<br><b>EL PASO NATURAL GAS COMPANY</b>  |                                      |                        | Lease<br><b>HUERFANO UNIT (SF 078103)</b> |                           | Well No.<br><b>135E</b>                |
| Unit Letter<br><b>H</b>   | Section<br><b>23</b>                 | Township<br><b>26N</b> | Range<br><b>9W</b>                        | County<br><b>San Juan</b> |  |
| Actual Footage Location of Well:<br><b>1650</b> feet from the <b>North</b> line and <b>990</b> feet from the <b>East</b> line |                                      |                        |   |                           |  |
| Ground Level Elev:<br><b>6370</b>   | Producing Formation<br><b>Dakota</b> |                        | Pool<br><b>Basin</b>                      |                           | Dedicated Acreage:<br><b>320</b> Acres |

1. Outline the acreage dedicated to the subject well by colored pencil or hachure marks on the plat below.
2. If more than one lease is dedicated to the well, outline each and identify the ownership thereof (both as to working interest and royalty).
3. If more than one lease of different ownership is dedicated to the well, have the interests of all owners been consolidated by communitization, unitization, force-pooling, etc?

☒ Yes ☐ No If answer is "yes," type of consolidation Unitization

If answer is "no," list the owners and tract descriptions which have actually been consolidated. (Use reverse side of this form if necessary.)

No allowable will be assigned to the well until all interests have been consolidated (by communitization, unitization, forced-pooling, or otherwise) or until a non-standard unit, eliminating such interests, has been approved by the Commission.

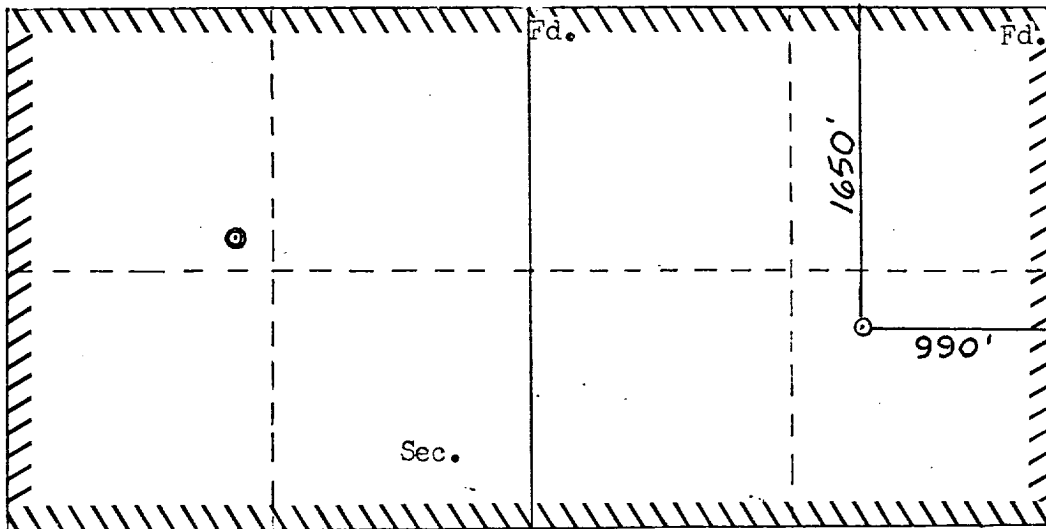

**RECEIVED**  
23  
MAR 01 1985  
BUREAU OF LAND MANAGEMENT

**RECEIVED**  
MAR 27 1985  
OIL CON. DIV.  
DIST. 3

CERTIFICATION

I hereby certify that the information contained herein is true and complete to the best of my knowledge and belief.

*Peggy Doak*

Name  
Drilling Clerk

Position  
El Paso Natural Gas

Company  
February 28, 1985

Date

I hereby certify that the well location shown on this plat was plotted from field notes of actual surveys made by me or under my supervision, and that the same is true and correct to the best of my knowledge and belief.

**WILLIAM E. HARTLEY**  
NEW MEXICO  
Date Surveyed  
2-20-85

Registered Professional Engineer  
and Land Surveyor

*With E. Mall II*  
Certificate No.

Huerfano Unit #135E (Dk)  
SENE 23-26-9

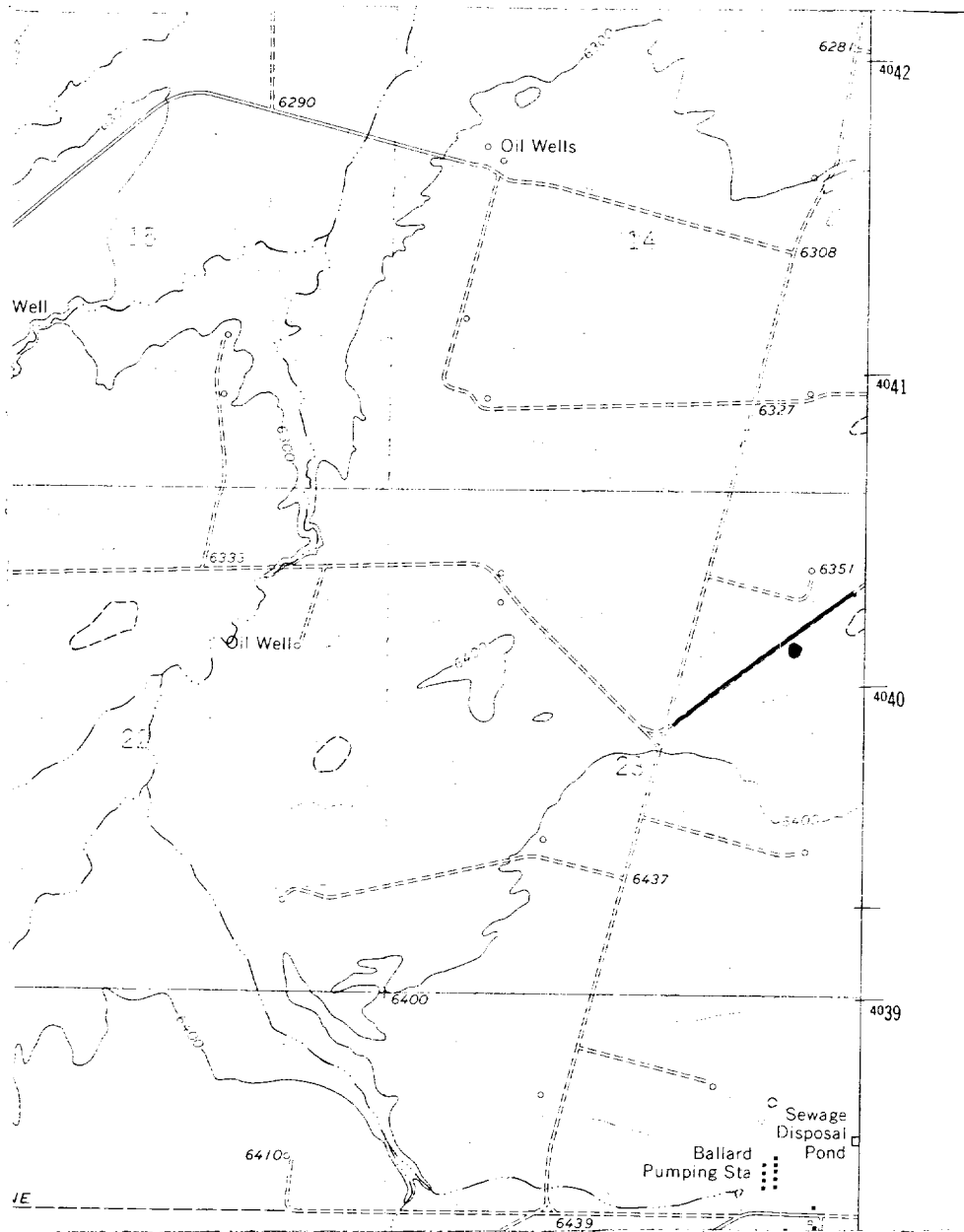

Map #1

LEGEND OF RIGHT-OF-WAYS

EXISTING ROADS

EXISTING PIPELINES

EXISTING ROAD & PIPELINE

PROPOSED ROADS

PROPOSED PIPELINES

PROPOSED ROAD & PIPELINE

