

UNITED STATES  
DEPARTMENT OF THE INTERIOR  
BUREAU OF LAND MANAGEMENT

APPLICATION FOR PERMIT TO DRILL, DEEPEN, OR PLUG BACK

1a. TYPE OF WORK

DRILL ☒

DEEPEN ☐

PLUG BACK ☐

b. TYPE OF WELL

OIL  
WELL ☐

GAS  
WELL ☒

OTHER

SINGLE  
ZONE ☒

MULTIPLE  
ZONE ☐

2. NAME OF OPERATOR

El Paso Natural Gas Company

3. ADDRESS OF OPERATOR

PO Box 4289, Farmington, NM 87499

4. LOCATION OF WELL (Report location clearly and in accordance with any State requirements.)

At surface  
1120'S, 1660'E

At proposed prod. zone

BUREAU OF LAND MANAGEMENT

14. DISTANCE IN MILES AND DIRECTION FROM NEAREST TOWN OR POST OFFICE

8 miles Northeast of Huerfano Trading Post

15. DISTANCE FROM PROPOSED\*

LOCATION TO NEAREST  
PROPERTY OR LEASE LINE, FT. 1120'

(Also to nearest drlg. unit line, if any)  
18. DISTANCE FROM PROPOSED LOCATION\*  
TO NEAREST WELL, DRILLING, COMPLETED,  
OR APPLIED FOR, ON THIS LEASE, FT. 1000

16. NO. OF ACRES IN LEASE  
1280

19. PROPOSED DEPTH  
6729'

17. NO. OF ACRES ASSIGNED  
TO THIS WELL S 320.00

20. ROTARY OR CABLE TOOLS  
Rotary

21. ELEVATIONS (Show whether DE, RT, GR, etc.)

6330' GL

DRILLING OPERATIONS AUTHORIZED ARE  
SUBJECT TO COMPLIANCE WITH ATTACHED

23. "GENERAL REQUIREMENTS" USED CASING AND CEMENTING PROGRAM

This action is subject to technical and  
procedural review pursuant to 43 CFR 3165.3  
and appeal pursuant to 43 CFR 3165.4.

SIZE OF HOLE	SIZE OF CASING	WEIGHT PER FOOT	SETTING DEPTH	QUANTITY OF CEMENT
12 1/4"	8 5/8"	24.0#	200'	165 cu.ft.circulated
7 7/8"	4 1/2"	10.5#&11.6#	6729'	1400 cu.ft.circulated

1st stage - 405 cu.ft. to cover Gallup  
2nd stage - 550 cu.ft. to cover Mesa Verde  
3rd stage - 445 cu.ft. to cover surface

Selectively perforate and sand water fracture the Dakota formation.

A 3000 psi WP and 6000 psi test double gate preventer equipped with  
blind and pipe rams will be used for blow out prevention on this well.

This gas is dedicated.

The S/2 of Section 14 is dedicated to this well.

IN ABOVE SPACE DESCRIBE PROPOSED PROGRAM: If proposal is to deepen or plug back, give data on present productive zone and proposed new productive zone. If proposal is to drill or deepen directionally, give pertinent data on subsurface locations and measured and true vertical depths. Give blowout preventer program, if any.

24. [Signature] Drilling Clerk 6-27-85

SIGNED [Signature] TITLE

(This space for Federal or State office use)

PERMIT NO. APPROVAL DATE

APPROVED BY TITLE  
CONDITIONS OF APPROVAL, IF ANY:

APPROVED  
AS AMENDED

JUL 03 1985

DATE [Signature]

For M. MILLENBACH  
AREA MANAGER

NMOCC

\*See Instructions On Reverse Side

All distances must be from the outer boundaries of the Section.

Operator <b>EL PASO NATURAL GAS COMPANY</b>			Lease <b>BALLARD (NM-03154)</b>		Well No. <b>14E</b>
Unit Letter <b>0</b>	Section <b>14</b>	Township <b>26N</b>	Range <b>9W</b>	County <b>San Juan</b>	
Actual Footage Location of Well: <b>1120</b> feet from the <b>South</b> line and <b>1660</b> feet from the <b>East</b> line					
Ground Level Elev: <b>6330</b>	Producing Formation <b>Dakota</b>		Pool <b>Basin Dakota</b>		Dedicated Acreage: <b>320.00</b> Acres

1. Outline the acreage dedicated to the subject well by colored pencil or hachure marks on the plat below.
2. If more than one lease is dedicated to the well, outline each and identify the ownership thereof (both as to working interest and royalty).
3. If more than one lease of different ownership is dedicated to the well, have the interests of all owners been consolidated by communitization, unitization, force-pooling, etc?

☐ Yes ☐ No If answer is "yes," type of consolidation \_\_\_\_\_

If answer is "no," list the owners and tract descriptions which have actually been consolidated. (Use reverse side of this form if necessary.) \_\_\_\_\_

No allowable will be assigned to the well until all interests have been consolidated (by communitization, unitization, forced-pooling, or otherwise) or until a non-standard unit, eliminating such interests, has been approved by the Commission.

<p style="text-align: center;">RECEIVED JUN 23 1985 BUREAU OF LAND MANAGEMENT FARMINGTON RESOURCE AREA</p>		Sec.	
<p>#14</p> <p style="text-align: center;">RECEIVED JUL 05 1985 OIL CON. DIV. DIST. 3</p>	<p>NM-03154</p>	14	
		1660'	
		1120'	

CERTIFICATION

I hereby certify that the information contained herein is true and complete to the best of my knowledge and belief.

*Reggie Daab*

Name  
Drilling Clerk  
Position  
El Paso Natural Gas  
Company  
June 27, 1985  
Date

I hereby certify that the well location shown on this plat was plotted from field notes of actual surveys made by me or under my supervision, and that the same is true and correct to the best of my knowledge and belief.

Date Surveyed  
July 25, 1980  
Registered Professional Engineer  
and Land Surveyor  
*Fred B. Kerr Jr.*  
Certificate No. 3950

EL PASO NATURAL GAS COMPANY  
 Ballard #14E  
 SE 14-26-9

R-9-W

8-2

HUERFANO TRADING POST QUADRANGLE  
 NEW MEXICO—SAN JUAN CO.  
 7.5 MINUTE SERIES (TOPOGRAPHIC)

4457 11  
 16000 PACE  
 1.62 500

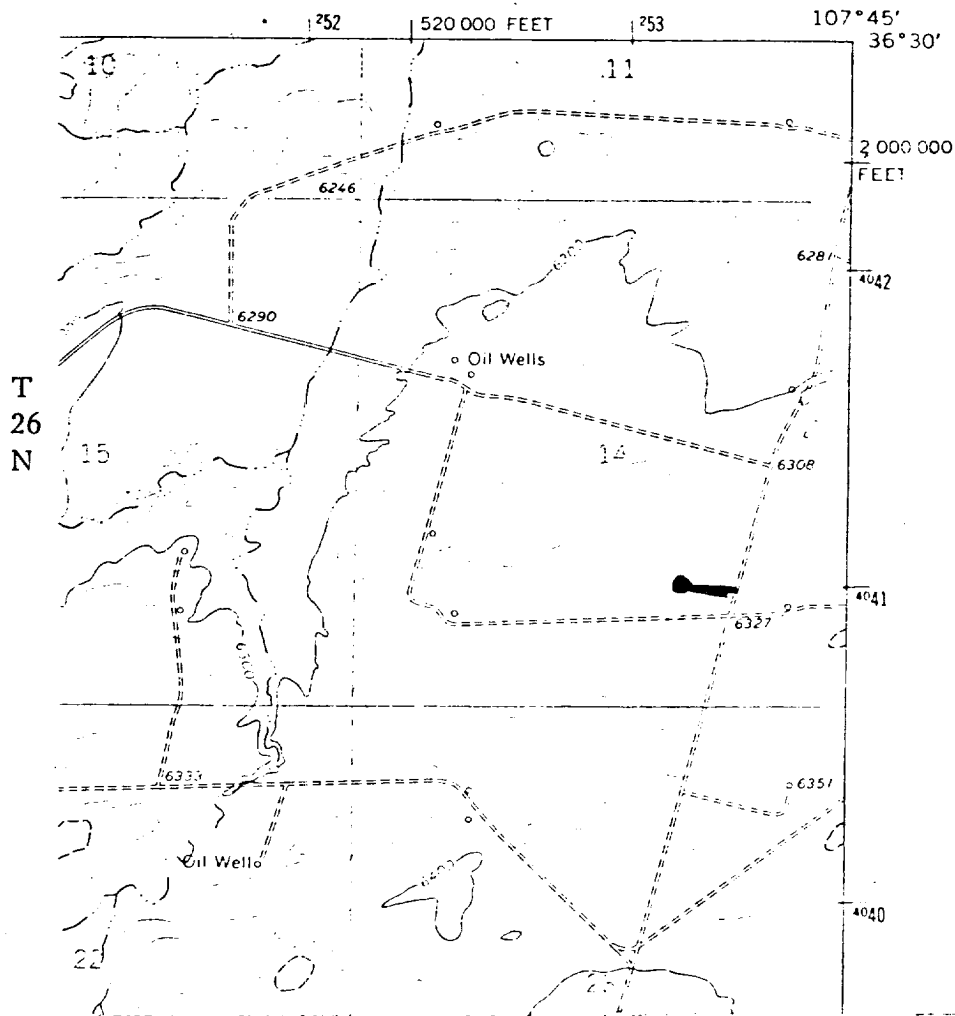

LEGEND OF RIGHT-OF-WAYS

EXISTING ROADS	—————
EXISTING PIPELINES	+ + +
EXISTING ROAD & PIPELINE	+++
PROPOSED ROADS	—————
PROPOSED PIPELINES	+ + +
PROPOSED ROAD & PIPELINE	+++