

S

Sept. 3, 1971

30-045-21547

F. Loc. 1180/N; 300/E Elev. 6290 GL Spd. _____ Comp. _____ TD _____ PB _____Casing S. _____ @ _____ W _____ Sx. Int. _____ @ _____ W _____ Sx. Pr. _____ @ _____ W _____ Sx. T. _____
Csg. Perf. _____ Prod. Stim. _____T
R
A
N
S

I.P. _____ BO/D _____ MCF/D After _____ Hrs. _____ SICP _____ PSI After _____ Days GOR _____ Grav. _____ 1st Del. _____ s _____

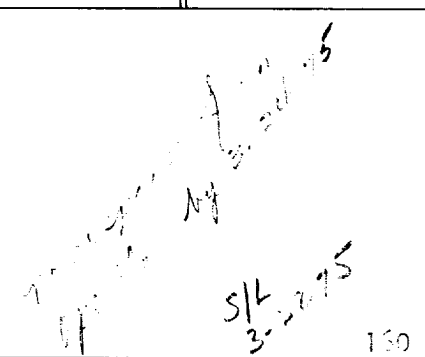
TOPS		NITD	X	Well Log	TEST DATA							
Kirtland		C-103		Plat	X	Schd.	PC	Q	PW	PD	D	Ref. No.
Fruitland		C-104		Electric Log								
Pictured Cliffs				C-122								
Cliff House		Ditr		Dfa								
Menefee		Datr		Dac								
Point Lookout												
Mancos												
Gallup												
Sanostee												
Greenhorn												
Dakota												
Morrison												
Entrada												

P
O
O

Ballard PC Co. S.J. S 36 T 26N R 2W U A Oper. EPNG Co. Lse. Turner B Com K No. 17



OIL CONSERVATION COMMISSION

STATE OF NEW MEXICO
1000 RIO BRAZOS ROAD - AZTEC
87410

March 10, 1975

I. R. TRUJILLO
CHAIRMAN

LAND COMMISSIONER
ALEX J. ARMIJO
MEMBER

STATE GEOLOGIST
A. L. PORTER, JR.
SECRETARY - DIRECTOR

El Paso Natural Gas Company
PO Box 990
Farmington, New Mexico 87401

RE: SJ 27-4 Unit #104
M-17-27N-4W

✓ Turner B Com K #17
A-36-26N-8W

Gentlemen:

Application for Permit to Drill was received on the above wells,
September 9, 1974.

No further progress reports have been received. Your application to drill will be canceled two weeks subsequent to the date of this notice unless we have been advised of your intent to drill this location.

REMARKS: Also, on your Burroughs Com F #8 , E-2-27N-8W, we had granted an extension. On February 24, 1975 we sent this same notice, but we have not heard from you as to your intentions for this location.

Thank you,

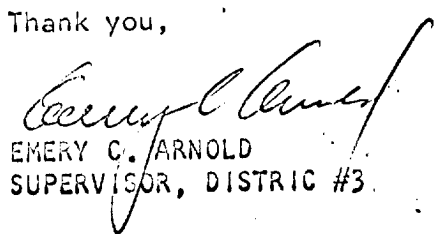
EMERY C. ARNOLD
SUPERVISOR, DISTRICT #3

cc: Oil Conservation Commission
Santa Fe, New Mexico

ABANDONED LOCATION

NO. OF COPIES RECEIVED	6
DISTRIBUTION	
SANTA FE	1
FILE	1
U.S.G.S.	2
LAND OFFICE	1
OPERATOR	1

NEW MEXICO OIL CONSERVATION COMMISSION

30-045-21547

Form C-101
Revised 1-1-65

APPLICATION FOR PERMIT TO DRILL, DEEPEN, OR PLUG BACK			
1a. Type of Work		5A. Indicate Type of Lease	
b. Type of Well DRILL <input checked="" type="checkbox"/> DEEPEN <input type="checkbox"/> PLUG BACK <input type="checkbox"/> OIL WELL <input type="checkbox"/> GAS WELL <input checked="" type="checkbox"/> OTHER <input type="checkbox"/> SINGLE ZONE <input checked="" type="checkbox"/> MULTIPLE ZONE <input type="checkbox"/>		STATE <input checked="" type="checkbox"/> FEE <input type="checkbox"/>	
2. Name of Operator El Paso Natural Gas Company		5. State Oil & Gas Lease No. E-8441	
3. Address of Operator PO Box 990, Farmington, NM 87401		7. Unit Agreement Name	
4. Location of Well UNIT LETTER A LOCATED 1180 FEET FROM THE North LINE AND 800 FEET FROM THE East LINE OF SEC. 36 TWP. 26N RGE. 8W NMPM		8. Farm or Lease Name Turner B Com K	
		9. Well No. 17	
		10. Field and Pool, or Wildcat Ballard Pictured Cliffs	
		12. County San Juan	
		19. Proposed Depth 2350'	
		19A. Formation Pictured Cliffs	
		20. Rotary or C.T. Rotary	
21. Elevations (Show whether DF, RT, etc.) 6399'GL		21A. Kind & Status Plug. Bond statewide	
		21B. Drilling Contractor	
		22. Approx. Date Work will start	

23.

PROPOSED CASING AND CEMENT PROGRAM

SIZE OF HOLE	SIZE OF CASING	WEIGHT PER FOOT	SETTING DEPTH	SACKS OF CEMENT	EST. TOP
12 1/4"	8 5/8"	24.0#	120'	106 cu. ft.	circulate to surface
6 3/4"	2 7/8"	6.4#	2350'	278 cu. ft.	cover Ojo Alamo

Selectively perforate and sandwater fracture the Pictured Cliffs formation.

The NE/4 of Section 36 is dedicated to this well.

APPROVAL VALID
FOR 90 DAYS
DRILLING CONTRACT

EXPIRES

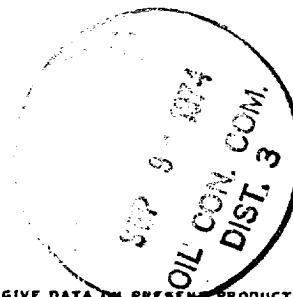

IN ABOVE SPACE DESCRIBE PROPOSED PROGRAM; IF PROPOSAL IS TO DEEPEN OR PLUG BACK, GIVE DATA ON PRESENT PRODUCTIVE ZONE AND PROPOSED NEW PRODUCTIVE ZONE. GIVE BLOWOUT PREVENTER PROGRAM, IF ANY.

I hereby certify that the information above is true and complete to the best of my knowledge and belief.

Signed D. G. Lisco Title Drilling Clerk Date September 5, 1974

(This space for State Use)

APPROVED BY R. Kendrick PETROLEUM ENGINEER DIST. NO. 3 DATE SEP 9 - 1974
CONDITIONS OF APPROVAL, IF ANY

**NEW MEXICO OIL CONSERVATION COMMISSION
WELL LOCATION AND ACREAGE DEDICATION PLAT**

Form C-102
Supersedes C-128
Effective 1-1-65

All distances must be from the outer boundaries of the Section.

Operator EL PASO NATURAL GAS COMPANY			Lease TURNER B COM. K (E-8441)		Well No. 17
Unit Letter A	Section 36	Township 26-N	Range 8-W	County SAN JUAN	
Actual Footage Location of Well: 1180 feet from the NORTH line and 800 feet from the EAST line					
Ground Level Elev. 6399	Producing Formation PICTURED CLIFFS		Pool BALLARD PICTURED CLIFFS	Dedicated Acreage: 160.00 Acres	

1. Outline the acreage dedicated to the subject well by colored pencil or hachure marks on the plat below.
2. If more than one lease is dedicated to the well, outline each and identify the ownership thereof (both as to working interest and royalty).
3. If more than one lease of different ownership is dedicated to the well, have the interests of all owners been consolidated by communitization, unitization, force-pooling, etc?

☒ Yes ☐ No If answer is "yes," type of consolidation **Communitization**

If answer is "no," list the owners and tract descriptions which have actually been consolidated. (Use reverse side of this form if necessary.) _____

No allowable will be assigned to the well until all interests have been consolidated (by communitization, unitization, forced-pooling, or otherwise) or until a non-standard unit, eliminating such interests, has been approved by the Commission.

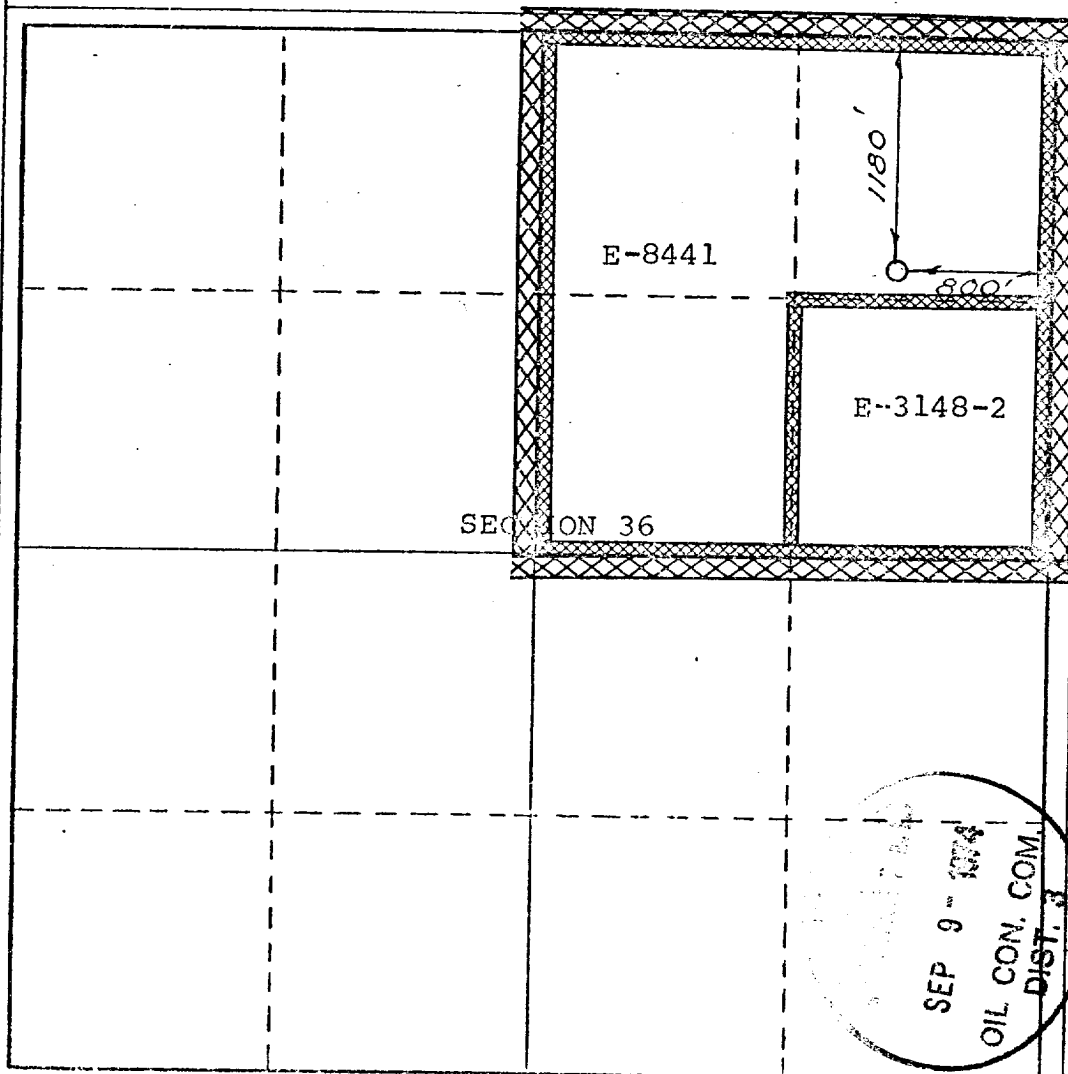

CERTIFICATION

I hereby certify that the information contained herein is true and complete to the best of my knowledge and belief.
Original Signed by
D. G. Brisco

Name
Drilling Clerk
Position
El Paso Natural Gas Co.
Company
September 5, 1974
Date

I hereby certify that the well location shown on this plat was plotted from field notes of actual surveys made by me or under my supervision, and that the same is true and correct to the best of my knowledge and belief.

Date Surveyed
AUGUST 8, 1974
Registered Professional Engineer and/or Land Surveyor

Certificate No. **1760**

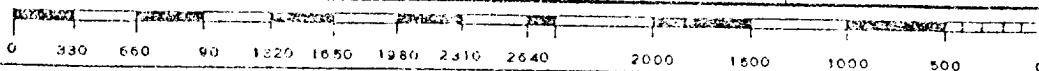

NO. OF COPIES RECEIVED	3
DISTRIBUTION	
SANTA FE	1
FILE	1
U.S.G.S.	
LAND OFFICE	
OPERATOR	1

NEW MEXICO OIL CONSERVATION COMMISSION

Form C-103
Supersedes Old
C-102 and C-103
Effective 1-1-65

5a. Indicate Type of Lease	
State <input checked="" type="checkbox"/>	Fee <input type="checkbox"/>
5. State Oil & Gas Lease No.	
E-8441	

SUNDRY NOTICES AND REPORTS ON WELLS (DO NOT USE THIS FORM FOR PROPOSALS TO DRILL OR TO DEEPEN OR PLUG BACK TO A DIFFERENT RESERVOIR. USE "APPLICATION FOR PERMIT -" (FORM C-101) FOR SUCH PROPOSALS.)

1. OIL WELL <input type="checkbox"/> GAS WELL <input checked="" type="checkbox"/> OTHER- <input type="checkbox"/>	7. Unit Agreement Name
2. Name of Operator El Paso Natural Gas Company	8. Farm or Lease Name Turner B Com K
3. Address of Operator PO Box 990, Farmington, NM 87401	9. Well No. 17
4. Location of Well UNIT LETTER <u>A</u> , <u>1180</u> FEET FROM THE <u>North</u> LINE AND <u>800</u> FEET FROM THE <u>East</u> LINE, SECTION <u>36</u> TOWNSHIP <u>26N</u> RANGE <u>8W</u> NMPM.	10. Field and Pool, or Wildcat Ballard Pictured Cliffs
15. Elevation (Show whether DF, RT, GR, etc.) 6399'GL	12. County San Juan

16. Check Appropriate Box To Indicate Nature of Notice, Report or Other Data	
NOTICE OF INTENTION TO:	SUBSEQUENT REPORT OF:
PERFORM REMEDIAL WORK <input type="checkbox"/>	REMEDIAL WORK <input type="checkbox"/>
TEMPORARILY ABANDON <input type="checkbox"/>	COMMENCE DRILLING OPNS. <input type="checkbox"/>
PULL OR ALTER CASING <input type="checkbox"/>	CASING TEST AND CEMENT JOB <input type="checkbox"/>
OTHER <u>Request for Extension</u> <input checked="" type="checkbox"/>	OTHER <input type="checkbox"/>
PLUG AND ABANDON <input type="checkbox"/>	ALTERING CASING <input type="checkbox"/>
CHANGE PLANS <input type="checkbox"/>	PLUG AND ABANDONMENT <input type="checkbox"/>

17. Describe Proposed or Completed Operations (Clearly state all pertinent details, and give pertinent dates, including estimated date of starting any proposed work) SEE RULE 1103.

It is anticipated that the "Permit to Drill" will expire before this well can be spudded. Therefore, an extension is requested.

APPROVED FOR DRILLING
EXPIRES 3-10-75



18. I hereby certify that the information above is true and complete to the best of my knowledge and belief.		
SIGNED <u>A. G. Buices</u>	TITLE <u>Drilling Clerk</u>	DATE <u>December 10, 1974</u>
Original Signed By <u>Henry C. Arnold</u>		
APPROVED BY _____	TITLE _____	DATE <u>DEC 10 1974</u>
CONDITIONS OF APPROVAL, IF ANY:		



OIL CONSERVATION COMMISSION

STATE OF NEW MEXICO
1000 RIO BRAZOS ROAD - AZTEC
87410

December 9, 1974

I. R. TRUJILLO
CHAIRMAN

LAND COMMISSIONER
ALEX J. ARMIJO
MEMBER

STATE GEOLOGIST
A. L. PORTER, JR.
SECRETARY - DIRECTOR

El Paso Natural Gas Company
PO Box 990
Farmington, N. M. 87401

RE: Turner B Com K #17
A-36-26N-3W

Gentlemen:

Application for Permit to Drill was received on the above well,
September 9, 1974.

No further progress reports have been received. Your application to drill will be canceled two weeks subsequent to the date of this notice unless we have been advised of your intent to drill this location.

REMARKS:

Thank you,

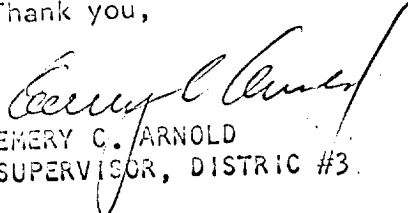
EMERY C. ARNOLD
SUPERVISOR, DISTRICT #3

cc: Oil Conservation Commission
Santa Fe, New Mexico