

NO. OF COPIES RECEIVED	
DISTRIBUTION	
SANTA FE	
FILE	
U.S.G.S.	
LAND OFFICE	
OPERATOR	

# NEW MEXICO OIL CONSERVATION COMMISSION

Form C-101  
Revised 1-1-65

5A. Indicate Type of Lease STATE <input checked="" type="checkbox"/> FEE <input type="checkbox"/>
5. State Oil & Gas Lease No. E-2941-2

## APPLICATION FOR PERMIT TO DRILL, DEEPEN, OR PLUG BACK

1a. Type of Work b. Type of Well OIL WELL <input type="checkbox"/> GAS WELL <input checked="" type="checkbox"/> OTHER <input type="checkbox"/> SINGLE ZONE <input checked="" type="checkbox"/> MULTIPLE ZONE <input type="checkbox"/>		7. Unit Agreement Name Huerfano Unit	
2. Name of Operator El Paso Natural Gas Company		8. Farm or Lease Name Huerfano Unit Com	
3. Address of Operator PO Box 4289, Farmington, NM 87499		9. Well No. 208E	
4. Location of Well UNIT LETTER L LOCATED 1460 FEET FROM THE South LINE AND 1170 FEET FROM THE West LINE OF SEC. 32 TWP. 26N RGE. 9W NMPM		10. Field and Pool, or Wildcat Basin Dakota	
12. County San Juan		19. Proposed Depth 6765'	
21. Elevations (Show whether DF, RT, etc.) 6647' GL		19A. Formation Dakota	
21A. Kind & Status Plug. Bond statewide		20. Rotary or C.T. Rotary	
21B. Drilling Contractor		22. Approx. Date Work will start	

## PROPOSED CASING AND CEMENT PROGRAM

SIZE OF HOLE	SIZE OF CASING	WEIGHT PER FOOT	SETTING DEPTH	SACKS OF CEMENT	EST. TOP
12 1/4"	8 5/8"	36.0#	200'	165 cu.ft.	circulated
7 7/8"	4 1/2"	10.5# & 11.6#	6765'	1486 cu.ft.	circulated

1st stage - 391 cu.ft. to cover Gallup  
2nd stage - 522 cu.ft. to cover Mesa Verde  
3rd stage - 573 cu.ft. to cover surface

Selectively perforate and sand water fracture the Dakota formation.

A 3000 psi WP and 6000 psi test double gate preventer equipped with blind and pipe dams will be used for blow out prevention on this well.

This gas is dedicated.

The W/2 of Section 32 is dedicated to this well.

APPROVAL EXPIRES 6-16-85  
UNLESS DRILLING IS COMPLETED.  
SPUD NOTICE MUST BE SUBMITTED  
WITHIN 40 DAYS

RECEIVED  
DEC 16 1985  
OIL & GAS DIV.

IN ABOVE SPACE DESCRIBE PROPOSED PROGRAM: IF PROPOSAL FOR PLUG BACK, GIVE DATA ON PRESENT PRODUCTIVE ZONE AND PROPOSED NEW PRODUCTIVE ZONE. GIVE BLOWOUT PREVENTER PROGRAM, IF ANY.

I hereby certify that the information above is true and complete to the best of my knowledge and belief.

Signed Ernie Busch Title Drilling Clerk Date 12-13-85

(This space for State Use)

APPROVED BY ORIGINAL SIGNED BY ERNIE BUSCH TITLE GEOLOGIST, DISTRICT #3 DATE DEC 16 1985

CONDITIONS OF APPROVAL, IF ANY:

## OIL CONSERVATION DIVISION

STATE OF NEW MEXICO  
ENERGY AND MINERALS DEPARTMENTP. O. BOX 2088  
SANTA FE, NEW MEXICO 87501Form C-102  
Revised 10-1-78

All distances must be from the outer boundaries of the Section.

Operator El Paso Natural Gas Company			Lease Huerfano Unit Com (E-2941-2)		Well No. 208E
Unit Letter L	Section 32	Township 26 N	Range 9 W	County San Juan	
Actual Footage Location of Well: 1460 feet from the South line and 1170 feet from the West line					
Ground Level Elev. 6647	Producing Formation Dakota		Pool Basin		Dedicated Acreage: 320 Acres

1. Outline the acreage dedicated to the subject well by colored pencil or hachure marks on the plat below.
2. If more than one lease is dedicated to the well, outline each and identify the ownership thereof (both as to working interest and royalty).
3. If more than one lease of different ownership is dedicated to the well, have the interests of all owners been consolidated by communitization, unitization, force-pooling, etc?

☒ Yes ☐ No If answer is "yes," type of consolidation Communitization

If answer is "no," list the owners and tract descriptions which have actually been consolidated. (Use reverse side of this form if necessary.) \_\_\_\_\_

No allowable will be assigned to the well until all interests have been consolidated (by communitization, unitization, forced-pooling, or otherwise) or until a non-standard unit, eliminating such interests, has been approved by the Division.

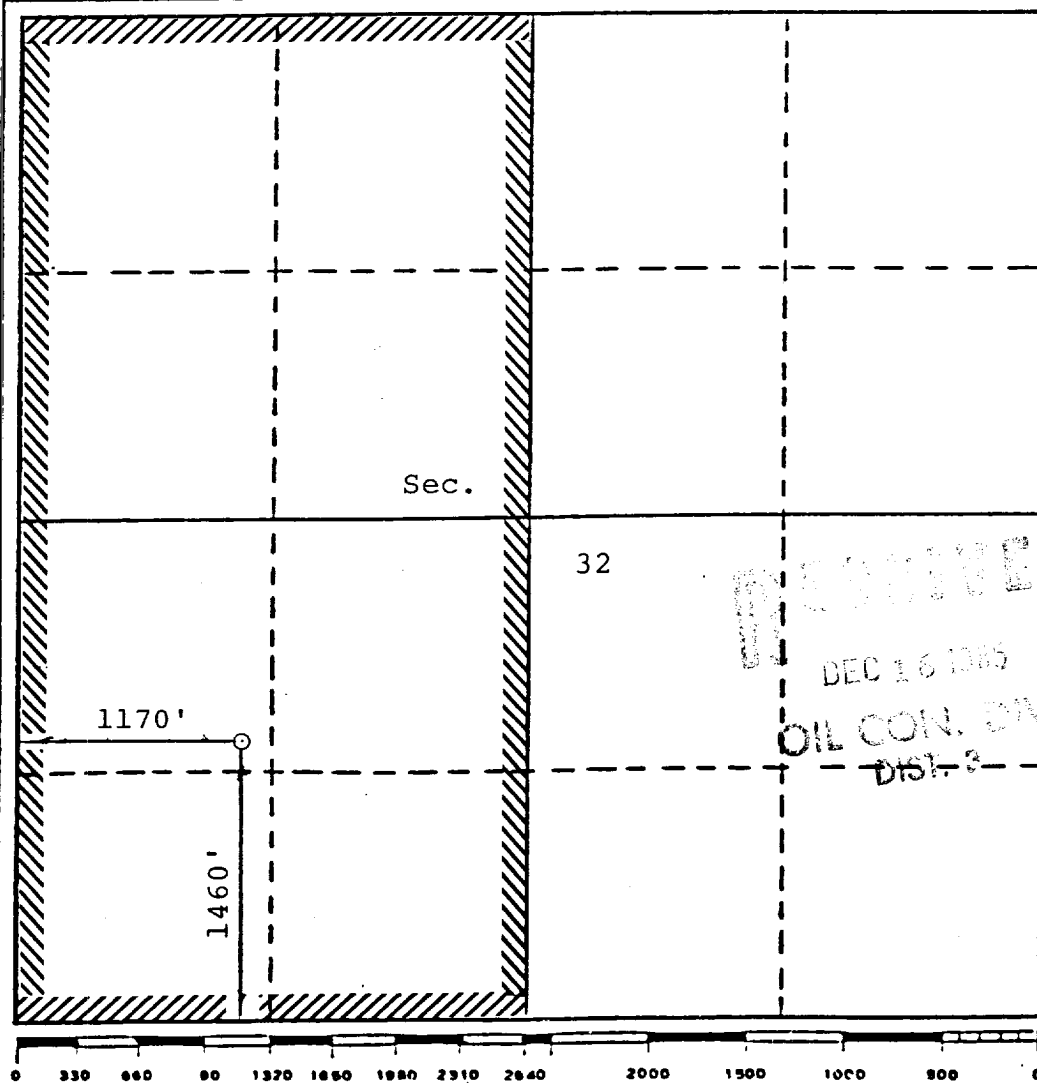

## CERTIFICATION

I hereby certify that the information contained herein is true and complete to the best of my knowledge and belief.

Name  
Drilling Clerk  
Position  
El Paso Natural Gas  
Company

Date  
12-12-85

I hereby certify that the well location shown on this plat was plotted from field notes of actual surveys made by me or under my supervision, and that the same is true and correct to the best of my knowledge and belief.

November 13, 1985

Date Surveyed  
David O. Vilven

Registered Professional Engineer  
and/or Land Surveyor

Certificate No.

1760