

UNITED STATES
DEPARTMENT OF THE INTERIOR
BUREAU OF LAND MANAGEMENT

RECEIVED
MAIL ROOM
30-045-27714
AM 11:06

APPLICATION FOR PERMIT TO DRILL, DEEPEN, OR PLUG BACK		
1a. TYPE OF WORK DRILL	5. LEASE NUMBER SF-078461	
1b. TYPE OF WELL GAS	6. IF INDIAN, ALL. OR TRIBE NAME	
2. OPERATOR UNION OIL CO. OF CAL.	7. UNIT AGREEMENT NAME	
3. ADDRESS OF OPERATOR P O BOX 2074 FARMINGTON, NM, 87401 (505) 325-8786	8. FARM OR LEASE NAME FILAN	
	9. WELL NO. # 8	
4. LOCATION OF WELL 1285' FNL, 1755' FEL	10. FIELD, POOL, OR WILDCAT BASIN FRUITLAND COAL	
	11. SEC. 5., T. 27N, R. 8W	
14. DISTANCE FROM NEAREST TOWN 20 Miles SE of Bloomfield	12. COUNTY San Juan	13. STATE New Mex.
15. DISTANCE FROM PROPOSED LOCATION TO NEAREST PROPERTY OR LEASE LINE 1285'	16. ACRES IN LEASE 642.72	17. ACRES ASSIGNED TO WELL 330
18. DISTANCE FROM PROPOSED LOCATION TO NEAREST WELL DRILLING, COMPLETED OR APPLIED FOR ON THIS LEASE: 762'	19. PROPOSED DEPTH 2250'	20. ROTARY OR CABLE TOOLS Rotary
21. ELEVATIONS (DF, FT, GR, ETC.) 6025' GL	22. APPROX. DATE WORK WILL BEGIN Spring 1990	
23. PROPOSED CASING AND CEMENTING PROGRAM SEE ATTACHED DRILLING PLAN		
24. AUTHORIZED BY <i>Chris Runell</i> AGENT		
DATE 3/16/90		
PERMIT NO. RECEIVE		
APPROVAL DATE		
APPROVED BY APR 04 1990		
TITLE DATE		
NOTE: THIS FORM IS ISSUED IN LIEU OF BLM FORM 3160-3		

"Approval of this action does
not warrant that the applicant
holds legal or equitable rights
or title to this lease."

NMOCD

APPROVED
AS AMENDED
APR 02 1990
Ken Townsend
AREA MANAGER

Appropriate
Office
Lease - 4 copies
Lease - 3 copies

State of New Mexico
Energy, Minerals and Natural Resources Department

OIL CONSERVATION DIVISION

P.O. Box 2088
Santa Fe, New Mexico 87504-2088

Form C-102
Revised 1-1-89

DISTRICT I
P.O. Box 1980, Hobbs, NM 88240

DISTRICT II
P.O. Drawer DD, Artesia, NM 88210

DISTRICT III
1000 Rio Brazos Rd., Aztec, NM 87410

WELL LOCATION AND ACREAGE DEDICATION PLAT

All Distances must be from the outer boundaries of the section

Operator UNION OIL CO. OF CALIFORNIA			Lease FILAN		Well No. 8
Unit Letter B	Section 5	Township T.27 N.	Range R.8 W.	County SAN JUAN COUNTY	
Actual Footage Location of Well: 1285 feet from the NORTH line and 1755 feet from the EAST line					
Ground level Elev. 6025	Producing Formation Fruitland Coal		Pool Basins Fruitland Coal		Dedicated Acreage: 322.72 Acres

- Outline the acreage dedicated to the subject well by colored pencil or hatchure marks on the plat below.
- If more than one lease is dedicated to the well, outline each and identify the ownership thereof (both as to working interest and royalty).
- If more than one lease of different ownership is dedicated to the well, have the interest of all owners been consolidated by communitization, unitization, force-pooling, etc.?
☐ Yes ☐ No If answer is "yes" type of consolidation _____
If answer is "no" list the owners and tract descriptions which have actually been consolidated. (Use reverse side of this form if necessary.)
No allowable will be assigned to the well until all interests have been consolidated (by communitization, unitization, forced-pooling, or otherwise) or until a non-standard unit, eliminating such interest, has been approved by the Division.

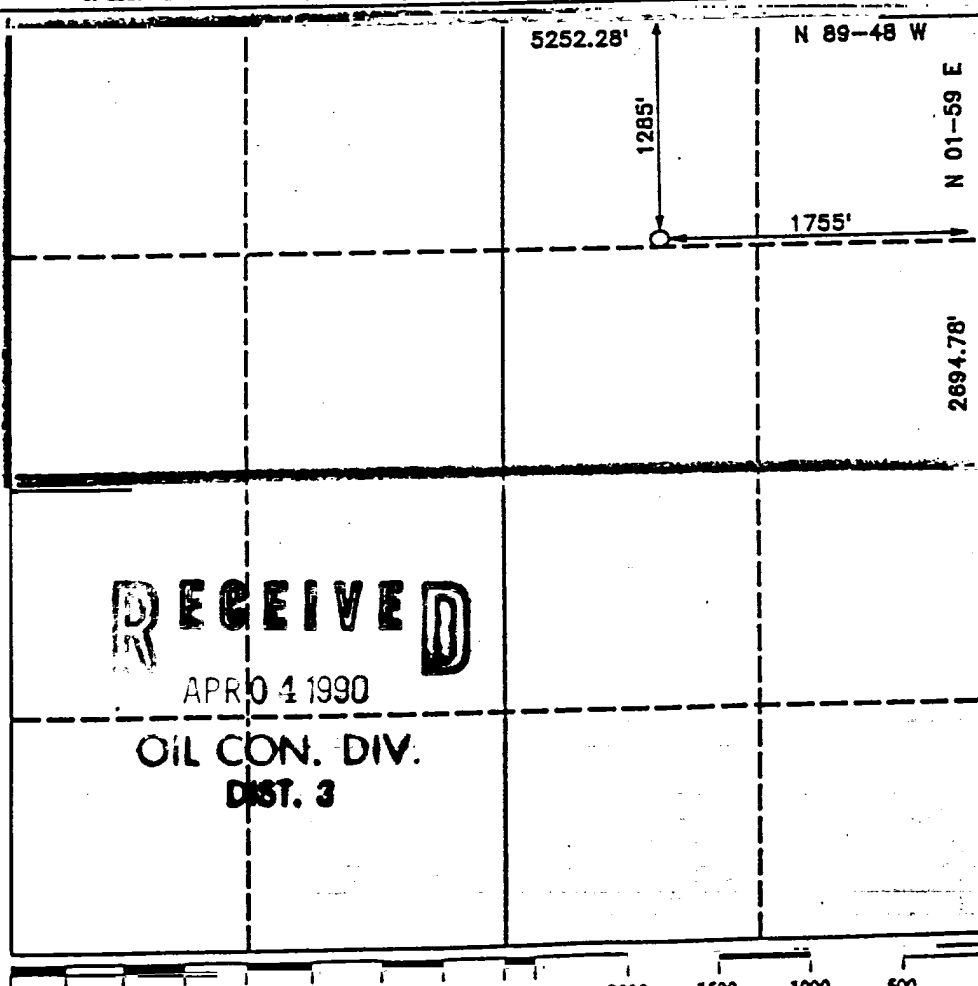

OPERATOR CERTIFICATION

I hereby certify that the information contained herein is true and complete to the best of my knowledge and belief.

Signature
Chris Russell
Printed Name
Chris Russell
Position
AGENT
Company
Unocal
Date
3/16/90

SURVEYOR CERTIFICATION

I hereby certify that the well location shown on this plat was plotted from field notes of actual surveys made by me or under my supervision, and that the same is true and correct to the best of my knowledge and belief.

Date Surveyed
MARCH 26 1990
Signature & Seal
Professional Surveyor
R. HOWARD DAGGETT
Certificate No.
Reg 5679
Professional Land Surveyor