

UNITED STATES  
DEPARTMENT OF THE INTERIOR  
BUREAU OF LAND MANAGEMENT

APPLICATION FOR PERMIT TO DRILL, DEEPEN, OR PLUG BACK

1a. TYPE OF WORK DRILL <input checked="" type="checkbox"/> DEEPEN <input type="checkbox"/> PLUG BACK <input type="checkbox"/>		5. LEASE DESIGNATION AND SERIAL NO. SF-079679
b. TYPE OF WELL OIL WELL <input type="checkbox"/> GAS WELL <input checked="" type="checkbox"/> OTHER <input type="checkbox"/>		6. IF INDIAN, ALLOTTEE OR TRIBE NAME
2. NAME OF OPERATOR MERRION OIL & GAS CORPORATION		7. UNIT AGREEMENT NAME
3. ADDRESS OF OPERATOR P. O. BOX 840, FARMINGTON, NEW MEXICO 87499		8. FARM OR LEASE NAME Delhi Taylor A
4. LOCATION OF WELL (Report location clearly and in accordance with any State requirements.)* At surface 920' FNL & 990' FEL (NE/NE) At proposed prod. zone Same as above		9. WELL NO. 7
14. DISTANCE IN MILES AND DIRECTION FROM NEAREST TOWN OR POST OFFICE* 20 miles South of Farmington, New Mexico		10. FIELD AND POOL, OR WILDCAT Basin Fruitland Coal
15. DISTANCE FROM PROPOSED* LOCATION TO NEAREST PROPERTY OR LEASE LINE, FT. (Also to nearest drlg. unit line, if any)		11. SEC., T., R., M., OR BLK. AND SURVEY OR AREA A Section 17, T26N, R11W
16. NO. OF ACRES IN LEASE 640		12. COUNTY OR PARISH San Juan
17. NO. OF ACRES ASSIGNED TO THIS WELL E/320		13. STATE New Mexico
18. DISTANCE FROM PROPOSED LOCATION* TO NEAREST WELL, DRILLING, COMPLETED, OR APPLIED FOR, ON THIS LEASE, FT.		20. ROTARY OR CABLE TOOLS Rotary
21. ELEVATIONS (Show whether DF, RT, GR, etc.) 6215' GL		22. APPROX. DATE WORK WILL START* June, 1990
23. PROPOSED CASING AND CEMENTING PROGRAM		

SIZE OF HOLE	SIZE OF CASING	WEIGHT PER FOOT	SETTING DEPTH	QUANTITY OF CEMENT
9-3/4"	7"	20 lb/ft	100'	50 sx ( 59 cu.ft.)
6-1/4"	4-1/2"	10.5 lb/ft	1490'	140 sx (242 cu.ft.)

Propose to drill 9-3/4" surface hole to 100' KB. Will set approximately 100 ft. of 7", J-55, 20 lb/ft surface casing at 100 ft KB with 50 sx (59 cu.ft.) of Class "B" with 2% CaCl<sub>2</sub>. Top of cement at the surface. Wait on cement 10 hours. Nipple up BOPs. Pressure test casing to 600 psi for 30 minutes. Drill 6-1/4" hole to total depth at 1,490 ft. Will run open hole logs. If well appears productive will set 4-1/2", J-55, 10.5 lb/ft production casing at total depth with 85 sx of Class "B" with 2% D-79 (175 cu.ft.) followed by 55 sx (67 cu.ft.) of Class "H" with 2% gel. Estimated top of cement at the surface. Will perforate and stimulate as necessary to test well. Additional program details attached.

RECEIVED  
JUL 31 1990

IN ABOVE SPACE DESCRIBE PROPOSED PROGRAM: If proposal is to deepen or plug back, give data on present productive zone and proposed new productive zone. If proposal is to drill or deepen directionally, give pertinent data on subsurface locations and measured and true vertical depths. Give blowout preventer program, if any.

24. SIGNED Steven S. Dunn TITLE Operations Manager DATE APRIL 27, 1990  
(This space for Federal or State office use)

PERMIT NO. \_\_\_\_\_ APPROVAL DATE \_\_\_\_\_  
APPROVED BY \_\_\_\_\_ TITLE \_\_\_\_\_ DATE JUL 24 1990  
CONDITIONS OF APPROVAL, IF ANY: \_\_\_\_\_

APPROVED  
AS AMENDED  
JUL 24 1990  
AREA MANAGER

\*See Instructions On Reverse Side

Submit to Appropriate  
District Office  
State Leases - 4 copies  
Fee Leases - 3 copies

State of New Mexico  
Energy, Minerals and Natural Resources Department

Form C-102  
Revised 1-1-89

OIL CONSERVATION DIVISION

DISTRICT I  
P.O. Box 1980, Hobbs, NM 88240

P.O. Box 2088

Santa Fe, New Mexico 87504-2088

DISTRICT II  
P.O. Drawer DD, Artesia, NM 88210

DISTRICT III  
1000 Rio Brazos Rd., Aztec, NM 87410

WELL LOCATION AND ACREAGE DEDICATION PLAT

All Distances must be from the outer boundaries of the section

Operator MERRION OIL & GAS CORPORATION			Lease DELHI TAYLOR A		Well No. 7
Unit Letter A	Section 17	Township 26 N	Range 11 W	County NMNM	San Juan.
Actual Footage Location of Well: 920 feet from the North line and 990 feet from the East line					
Ground level Elev. 6215	Producing Formation Fruitland		Pool Basin	Dedicated Acreage: 320 Acres	

1. Outline the acreage dedicated to the subject well by colored pencil or hatchure marks on the plat below.
2. If more than one lease is dedicated to the well, outline each and identify the ownership thereof (both as to working interest and royalty).
3. If more than one lease of different ownership is dedicated to the well, have the interest of all owners been consolidated by communitization, unitization, force-pooling, etc.?  
☐ Yes ☐ No If answer is "yes" type of consolidation \_\_\_\_\_  
If answer is "no" list the owners and tract descriptions which have actually been consolidated. (Use reverse side of this form if necessary.) \_\_\_\_\_  
No allowable will be assigned to the well until all interests have been consolidated (by communitization, unitization, forced-pooling, or otherwise) or until a non-standard unit, eliminating such interest, has been approved by the Division.

0 330 660 990 1320 1650 1980 2310 2640 2000 1500 1000 500 0

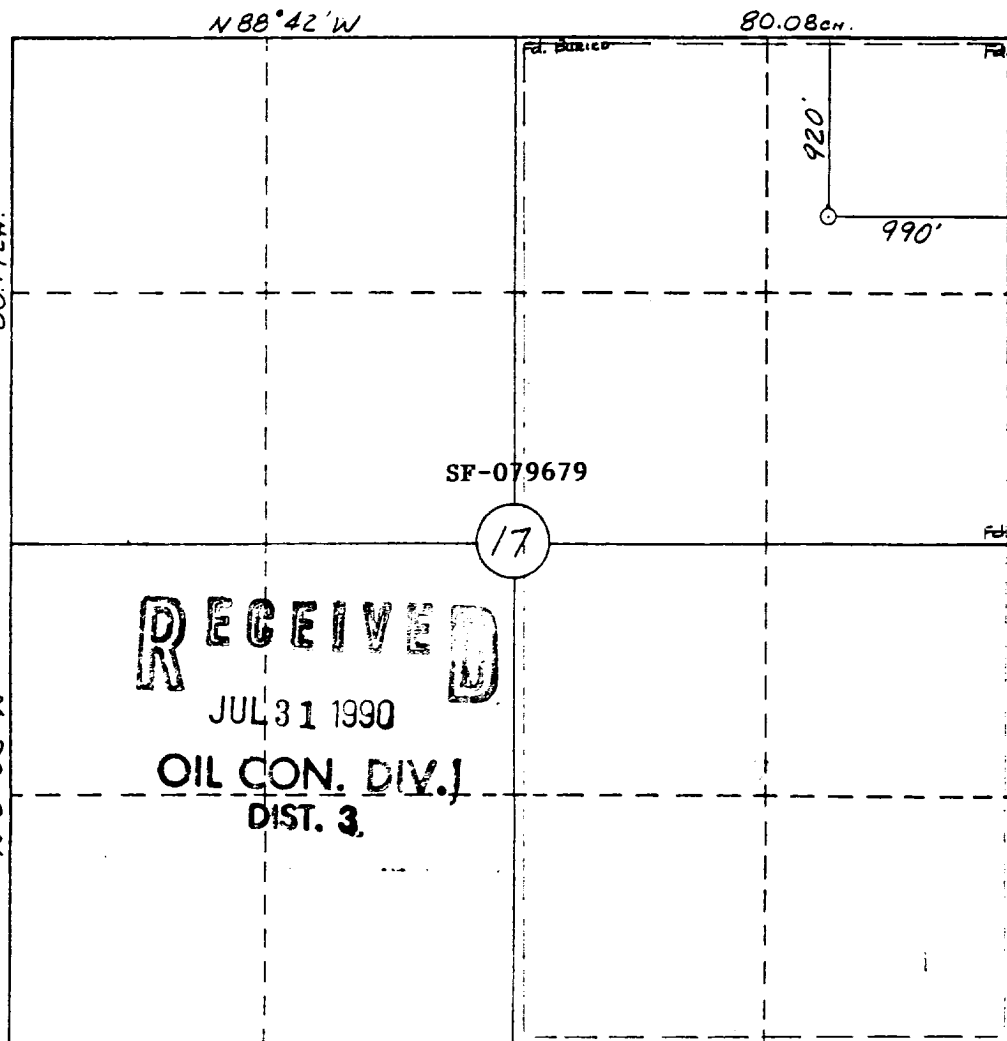

OPERATOR CERTIFICATION

I hereby certify that the information contained herein is true and complete to the best of my knowledge and belief.

Signature

Printed Name

Steven S. Dunn

Position

Operations Manager

Company

Merrion Oil & Gas Corp.

Date

APRIL 27, 1990

SURVEYOR CERTIFICATION

I hereby certify that the well location shown on this plat was plotted from field notes of actual surveys made by me or under my supervision, and that the same is true and correct to the best of my knowledge and belief.

4-13-90

Date Surveyed

William E. Mahnke II

Signature & Seal of Professional Surveyor

Certificate No.

PROFESSOR

CARSON TRADING POST QUADRANGLE  
NEW MEXICO-SAN JUAN CO.  
7.5 MINUTE SERIES (TOPOGRAPHIC)

4457 III  
(BLOOMFIELD)  
1:62,500

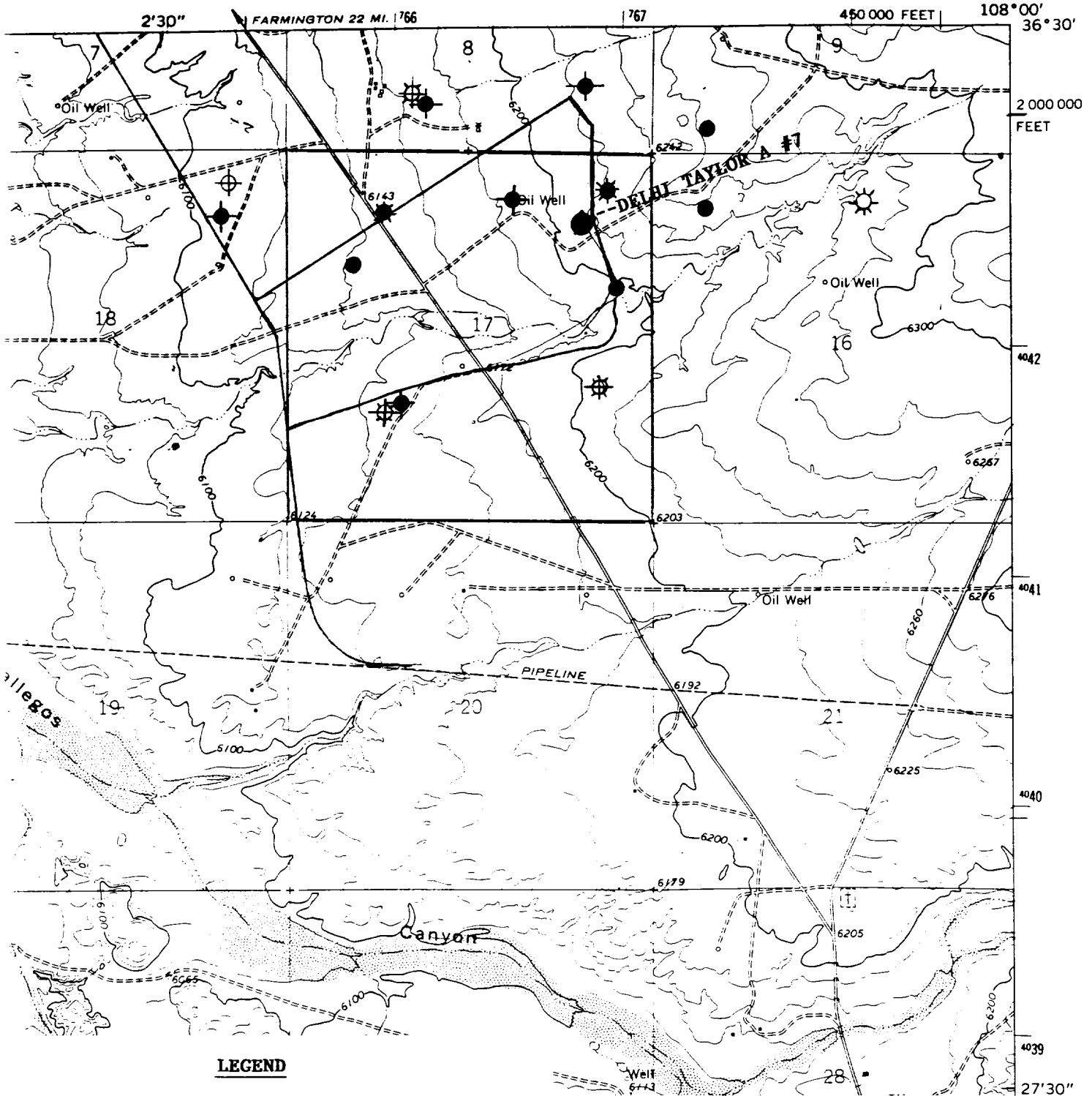

**LEGEND**

- PROPOSED WELL
- PRODUCING OIL WELLS
- P&A OIL WELLS
- ⊗ P&A GAS WELLS
- EXISTING ROAD

**MERRION OIL & GAS CORPORATION**

**DELHI TAYLOR A NO. 7**

920' FNL & 990' FEL

NE/NE, Section 17, T26N, R11W  
San Juan County, New Mexico