

UNITED STATES  
DEPARTMENT OF THE INTERIOR  
BUREAU OF LAND MANAGEMENT

30-045-28201

APPLICATION FOR PERMIT TO DRILL, DEEPEN, OR PLUG BACK

1a. TYPE OF WORK DRILL	5. LEASE NUMBER SF-078571
1b. TYPE OF WELL GAS	6. IF INDIAN, ALL. OR TRIBE NAME
2. OPERATOR UNION OIL CO. OF CAL.	7. UNIT AGREEMENT NAME None
3. ADDRESS OF OPERATOR P O BOX 2074 FARMINGTON, NM, 87401 (505)-325-8786	8. FARM OR LEASE NAME DAY "B"
	9. WELL NO. # 8
4. LOCATION OF WELL 734' FNL, 1233' FEL BHL 836' FNL, 1335' FEL	10. FIELD, POOL, OR WILDCAT BASIN FRUITLAND COAL
	11. SEC. 7, T.27N, R.8W
14. DISTANCE FROM NEAREST TOWN 30 Miles SE of Bloomfield	12. COUNTY San Juan
	13. STATE New Mex.
15. DISTANCE FROM PROPOSED LOCATION TO NEAREST PROPERTY OR LEASE LINE 734'	16. ACRES IN LEASE E/ 320.00
	17. ACRES ASSIGNED TO WELL 320
18. DISTANCE FROM PROPOSED LOCATION TO NEAREST WELL DRILLING, COMPLETED OR APPLIED FOR ON THIS LEASE: 367'	19. PROPOSED DEPTH TVD 2485' TMD 2490'
	20. ROTARY OR CABLE TOOLS Rotary
21. ELEVATIONS (DF, FT, GR, ETC.) 6272' GL	22. APPROX. DATE WORK WILL BEGIN Summer 1990

This action is subject to technical and procedural review pursuant to 43 CFR 3165.3 and appeal pursuant to 43 CFR 3165.4. PROPOSED CASING AND CEMENTING PROGRAM SEE ATTACHED DRILLING PLAN DRILLING OPERATIONS AND WORK ARE SUBJECT TO THE REQUIREMENTS OF THE ATTACHED "GENERAL REQUIREMENTS".

24. AUTHORIZED BY: Chris Russell AGENT 5/24/90 DATE

PERMIT NO. **RECEIVED** APPROVAL DATE \_\_\_\_\_  
APPROVED BY SEP 04 1990 TITLE \_\_\_\_\_ DATE \_\_\_\_\_

OIL CON. DIV  
DIST. 3  
NOTE: THIS FORM IS ISSUED IN LIEU OF BLM FORM 3160-3

APPROVED  
AS AMENDED

AUG 28 1990

AREA MANAGER

SEP 26 11 08:10 1990  
BUREAU OF LAND MANAGEMENT  
WASHINGTON, D.C.

RECEIVED  
SEP 26 1990  
BUREAU OF LAND MANAGEMENT  
WASHINGTON, D.C.

"No portion of this application shall be used to establish any right, claim, or title to this lease."  
Hold C-104 For D Doeder

OIL CONSERVATION DIVISION

P.O. Box 2088  
Santa Fe, New Mexico 87504-2088

90 MAY 16 1990

1980, Hobbs, NM 88240

UNCL II  
Answer DD, Artesia, NM 88210

UNCL III  
Rio Brazos Rd., Aztec, NM 87410

WELL LOCATION AND ACREAGE DEDICATION PLAT

All Distances must be from the outer boundaries of the section

Lease			DAY B		Well No.	8
UNION OIL CO. OF CALIFORNIA						
Letter	Section	Township	Range	County		
A	7	T.27 N.	R.8 W. NMPM	SAN JUAN COUNTY		
Well Location of Well:						
734		NORTH		1233	EAST	
feet from the		line and		feet from the		line
and level Elev.	Producing Formation		Pool		Dedicated Acreage:	
6272	FRUITLAND COAL		BASIN FRUITLAND COAL		320 Acres	

1. Outline the acreage dedicated to the subject well by colored pencil or hatchure marks on the plat below.

2. If more than one lease is dedicated to the well, outline each and identify the ownership thereof (both as to working interest and royalty).

3. If more than one lease of different ownership is dedicated to the well, have the interest of all owners been consolidated by communitization, unitization, force-pooling, etc.?

☐ Yes ☐ No

If answer is "yes" type of consolidation

If answer is "no" list the owners and tract descriptions which have actually been consolidated. (Use reverse side of this form if necessary.)

No allowable will be assigned to the well until all interests have been consolidated (by communitization, unitization, force-pooling, or otherwise) or until a non-standard unit, eliminating such interest, has been approved by the Division.

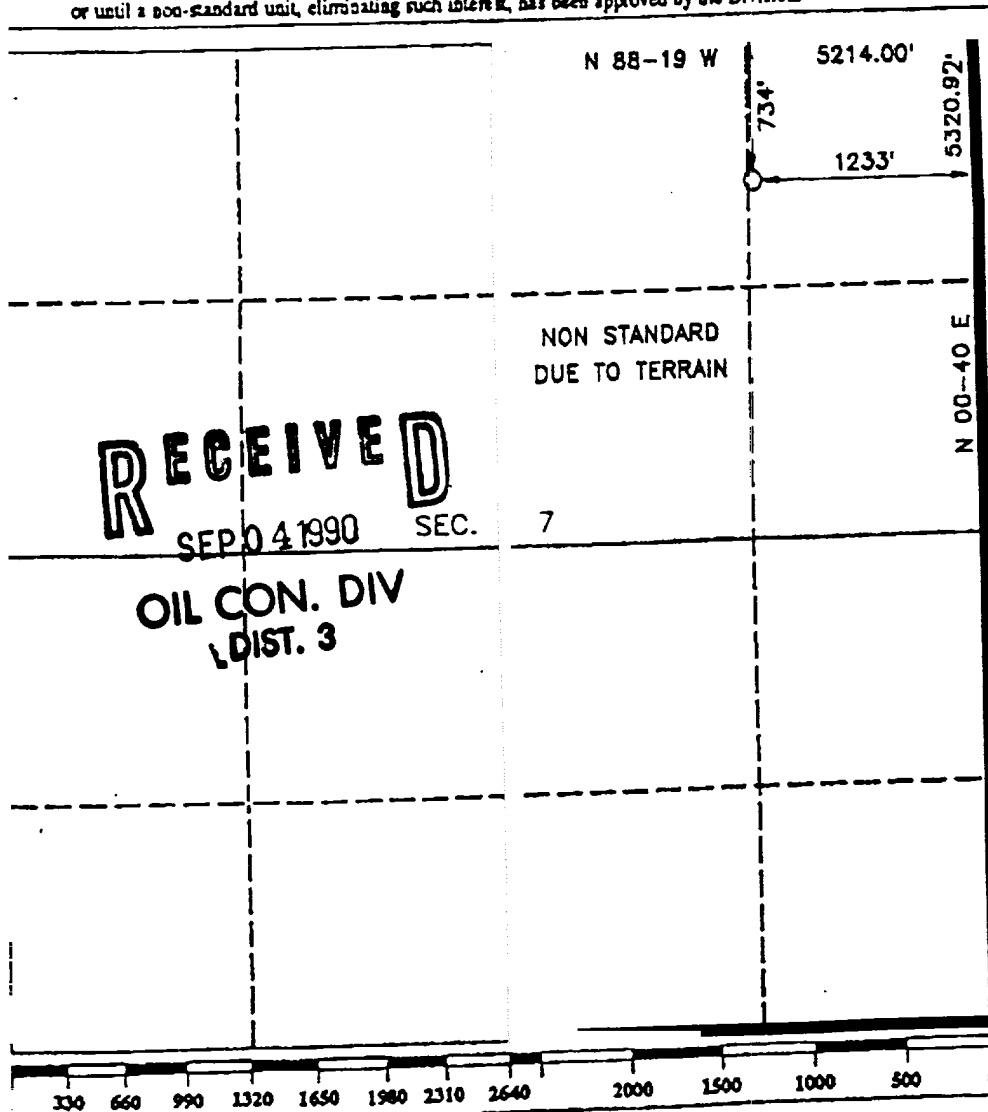

OPERATOR CERTIFICATION

I hereby certify that the information contained herein is true and complete to the best of my knowledge and belief.

Signature

William Hering

Printed Name

William Hering

Position

Dist. Petroleum Engineer

Company

Union Oil Co. of California

Date

5-14-90

SURVEYOR CERTIFICATION

I hereby certify that the well location shown on this plat was plotted from field notes of actual surveys made by me or under my supervision, and that the same is true and correct to the best of my knowledge and belief.

Date Surveyed

APR 10 1990

Signature of Professional Surveyor

R. HOWARD DAGGETT

R. Howard Daggett

Certificate No.

9870

Registered Professional  
Land Surveyor