

UNITED STATES
DEPARTMENT OF THE INTERIOR
BUREAU OF LAND MANAGEMENT

RECEIVED
BLM

FORM APPROVED
Budget Bureau No. 1004-0135
Expires: March 31, 1993

SUNDRY NOTICES AND REPORTS ON WELLS

Do not use this form for proposals to drill or to deepen or reentry to a different reservoir.
Use "APPLICATION FOR PERMIT—" for such proposals.

SUBMIT IN TRIPLICATE

1. Type of Well

☐ Oil Well ☒ Gas Well ☐ Other

2. Name of Operator

Great Western Drilling Co.

3. Address and Telephone No.

2550 La Plata Hwy, Farmington, NM 87401

4. Location of Well (Footage, Sec., T., R., M., or Survey Description)

2165' FEL & 2195' FSL Sec. 13, T-26N, R-8W

5. Lease Designation and Serial No.

SF-078622

6. If Indian, Allottee or Tribe Name

7. If Unit or CA, Agreement Designation

8. Well Name and No.

Federal Bond

9. API Well No.

1-E

10. Field and Pool, or Exploratory Area

Basin Dakota

Ballard P.C.

11. County or Parish, State

San Juan, NM

12. CHECK APPROPRIATE BOX(S) TO INDICATE NATURE OF NOTICE, REPORT, OR OTHER DATA

TYPE OF SUBMISSION

- ☐ Notice of Intent
☐ Subsequent Report
☐ Final Abandonment Notice

TYPE OF ACTION

- ☐ Abandonment
☐ Recompletion
☐ Plugging Back
☐ Casing Repair
☐ Altering Casing
☒ Other Correct Elevation

- ☐ Change of Plans
☐ New Construction
☐ Non-Routine Fracturing
☐ Water Shut-Off
☐ Conversion to Injection
☒ Dispose Water

(Note: Report results of multiple completion on Well Completion or Recompletion Report and Log form.)

13. Describe Proposed or Completed Operations (Clearly state all pertinent details, and give pertinent dates, including estimated date of starting any proposed work. If well is directionally drilled, give subsurface locations and measured and true vertical depths for all markers and zones pertinent to this work.)*

CORRECT ELEVATION FROM 6168 GR TO 6243' GR.

Name Change from Fed. #1E

RECEIVED
APR 15 1991
OIL CON. DIV.
DIST. 3

ACCEPTED FOR RECORD
APR 12 1991
FARMINGTON RESOURCE AREA

14. I hereby certify that the foregoing is true and correct

Signed D. E. Baister Title Div. Superintendent Date 3-13-91

(This space for Federal or State office use)

Approved by _____ Title _____ Date _____
Conditions of approval, if any: _____

Submit to Appropriate
District Office
State Lease - 4 copies
Fee Lease - 3 copies

State of New Mexico
Energy, Minerals and Natural Resources Department

OIL CONSERVATION DIVISION

DISTRICT I
P.O. Box 1980, Hobbs, NM 88240

P.O. Box 2088

Santa Fe, New Mexico 87504-2088

DISTRICT II
P.O. Drawer DD, Artesia, NM 88210

DISTRICT III
1000 Rio Brazos Rd., Aztec, NM 87410

WELL LOCATION AND ACREAGE DEDICATION PLAT

All Distances must be from the outer boundaries of the section.

Operator GREAT WESTERN DRILLING COMPANY			Lease BOND Federal		Well No. 1E
Unit Letter J	Section 13	Township 26 N	Range 8 W	County San Juan	
Actual Footage Location of Well: 2195 feet from the South line and 2165 feet from the East line					
Ground level Elev. 6243 Graded	Producing Formation PC/DK		Pool Ballard/Basin	Dedicated Acreage 860/360	
<p>1. Outline the acreage dedicated to the subject well by colored pencil or hatchure marks on the plat below.</p> <p>2. If more than one lease is dedicated to the well, outline each and identify the ownership thereof (both as to working interest and royalty).</p> <p>3. If more than one lease of different ownership is dedicated to the well, have the interest of all owners been consolidated by communitization, unitization, force-pooling, etc.? <input type="checkbox"/> Yes <input type="checkbox"/> No If answer is "yes" type of consolidation _____ If answer is "no" list the owners and tract descriptions which have actually been consolidated. (Use reverse side of this form if necessary.) _____ No allowable will be assigned to the well until all interests have been consolidated (by communitization, unitization, forced-pooling, or otherwise) or until a non-standard unit, eliminating such interest, has been approved by the Division.</p>					

0 330 660 990 1320 1650 1980 2310 2640 2970 3300 3630 3960 4290 4620 4950 5280 5610 5940 6270 6600 6930 7260 7590 7920 8250 8580 8910 9240 9570 9900

S 88°43'W

79.03 ch.

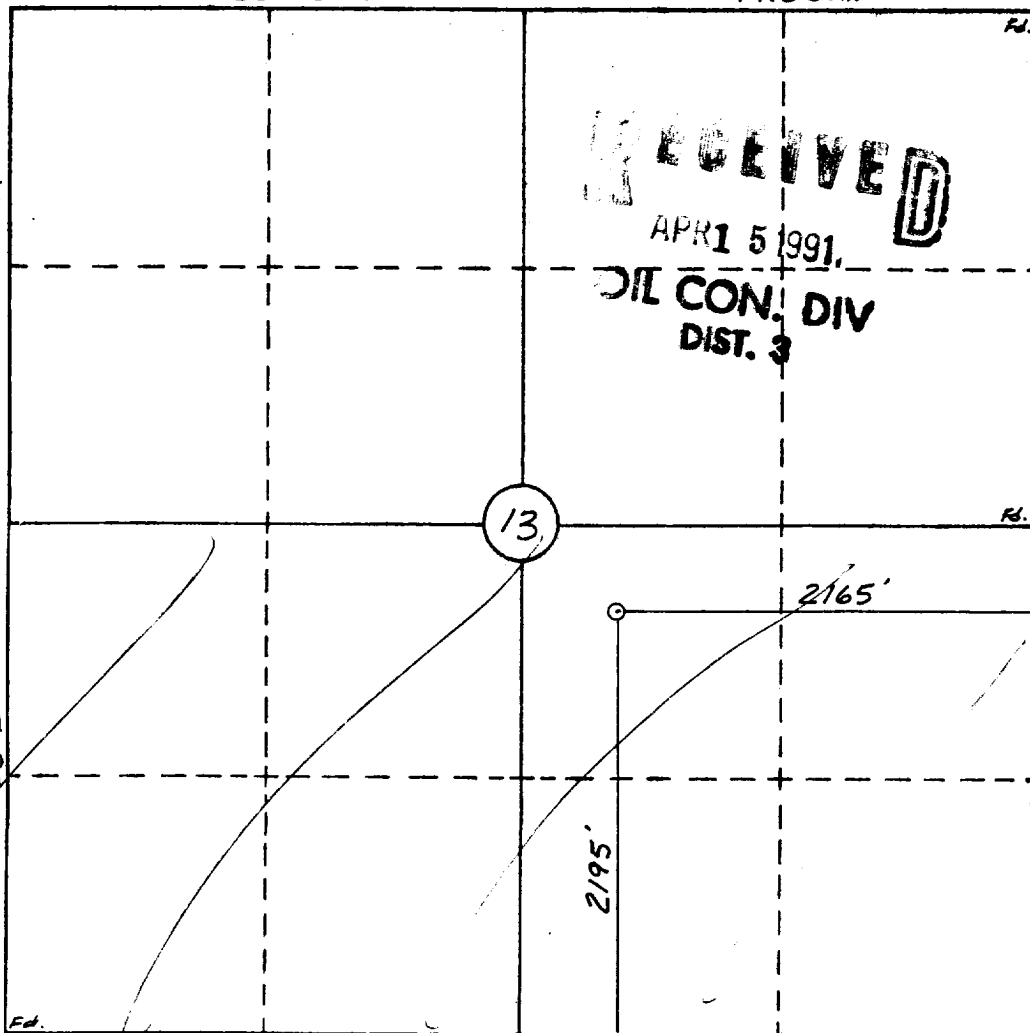

OPERATOR CERTIFICATION

I hereby certify that the information contained herein is true and complete to the best of my knowledge and belief.

Signature D. E. Baxter
Printed Name **D. E. Baxter**
Position **Div. Superintendent**
Company **Great Western Drilling Co.**
Date **March 13, 1991**

SURVEYOR CERTIFICATION

I hereby certify that the well location shown on this plat was plotted from field notes of actual surveys made by me or under my supervision, and that the same is true and correct to the best of my knowledge and belief. Re-issued 3-13-91

Date Surveyed **William E. Mahnke II**
Signature & Seal of Professional Surveyor **#8466**
Certificate No. **8466**