

UNITED STATES  
DEPARTMENT OF THE INTERIOR  
BUREAU OF LAND MANAGEMENT

SUBMIT IN TRIPLICATE\*  
(Other instructions on  
reverse side)

30-045-28368  
Form approved.  
Budget Bureau No. 1004-0136  
Expires August 31, 1985

APPLICATION FOR PERMIT TO DRILL, DEEPEN, OR PLUG BACK

1a. TYPE OF WORK

DRILL ☒

DEEPEN ☐

PLUG BACK ☐

b. TYPE OF WELL

OIL  
WELL ☐

GAS  
WELL ☒

OTHER

SINGLE  
ZONE ☒

MULTIPLE  
ZONE ☐

2. NAME OF OPERATOR

NASSAU RESOURCES, INC. 15515

3. ADDRESS OF OPERATOR

P O BOX 809, Farmington, N.M. 87499

4. LOCATION OF WELL (Report location clearly and in accordance with any State requirements.)\*

At surface

1550' FSL - 940' FWL

At proposed prod. zone

14. DISTANCE IN MILES AND DIRECTION FROM NEAREST TOWN OR POST OFFICE\*

±19 miles S SW of Bloomfield, NM

16. DISTANCE FROM PROPOSED\*

LOCATION TO NEAREST  
PROPERTY OR LEASE LINE, FT.

(Also to nearest drig. unit line, if any) 940'

18. DISTANCE FROM PROPOSED LOCATION\*

TO NEAREST WELL, DRILLING, COMPLETED,  
OR APPLIED FOR, ON THIS LEASE, FT.

±1000'

16. NO. OF ACRES IN LEASE

160.0

19. PROPOSED DEPTH

1360'

17. NO. OF ACRES ASSIGNED  
TO THIS WELL

111/320.0

20. ROTARY OR CABLE TOOLS

Rotary

21. ELEVATIONS (Show whether DE, RT, GR, etc.)

5955' GL

This action is subject to technical and  
procedural review pursuant to 43 CFR 3165.3

23. and appeal pursuant to 43 CFR 3165.4.

PROPOSED CASING AND CEMENTING PROGRAM

DRILLING OPERATIONS AUTHORIZED ARE

SUBJECT QUANTITY OF CEMENT WITH ATTACHED

SIZE OF HOLE	SIZE OF CASING	WEIGHT PER FOOT	SETTING DEPTH	
8-3/4"	7"	23#	120'	36 cu.ft. circ. to surf.
6-1/4"	4-1/2"	9.5#	1360'	216 cu.ft. circ. to surf.

Plan to drill with spud mud to set 120' of surface casing. Will then drill with water and gel-chem. mud to test the Fruitland coal zone at ±1360'. Will run DIL-GR-SP and FDC-CNL-GR Caliper logs. If well appears productive, will set 4-1/2" casing at TD, cement in 1 stage, selectively perforate, frac, clean out after frac and complete with 2-3/8" tubing.

Gas is not dedicated.

RECEIVED  
NOV 06 1990  
OIL CON. DIV.  
DIST. 3

IN ABOVE SPACE DESCRIBE PROPOSED PROGRAM: If proposal is to deepen or plug back, give data on present productive zone and proposed new productive zone. If proposal is to drill or deepen directionally, give pertinent data on subsurface locations and measured and true vertical depths. Give blowout preventer program, if any.

24.

SIGNED

Fran Perrin  
Fran Perrin

TITLE

Admin. Asst.

DATE

7-20-90

(This space for Federal or State office use)

PERMIT NO.

APPROVAL DATE

APPROVED BY

CONDITIONS OF APPROVAL, IF ANY:

TITLE

Hold C-10X for C/A + pool Charge  
ALLEN #1 + NAVAJO G #1 wells  
See Instructions On Reverse Side

Title 18 U.S.C. Section 1001, makes it a crime for any person knowingly and willfully to make to any department or agency of the United States any false, fictitious or fraudulent statements or representations as to any matter within its jurisdiction.

Submit to Appropriate  
District Office  
State Lease - 4 copies  
Fee Lease - 3 copies

State of New Mexico  
Energy, Minerals and Natural Resources Department

Form C-102  
Revised 1-1-89

OIL CONSERVATION DIVISION

P.O. Box 2088

Santa Fe, New Mexico 87504-2088

DISTRICT I

P.O. Box 1980, Hobbs, NM 88240

DISTRICT II

P.O. Drawer DD, Artesia, NM 88210

DISTRICT III

1000 Rio Brazos Rd., Aztec, NM 87410

WELL LOCATION AND ACREAGE DEDICATION PLAT

All Distances must be from the outer boundaries of the section

Operator Nassau Resources, Inc.			Lease Nassau Texaco 12		Well No. 12
Unit Letter L	Section 12	Township 26 North	Range 12 West	County San Juan	
Actual Footage Location of Well: 1550 feet from the South line and 940 feet from the West line					
Ground level Elev. 5955		Producing Formation Fruitland Coal		Pool Basin Fruitland Coal	
Dedicated Acreage: 320.					Acres

- Outline the acreage dedicated to the subject well by colored pencil or hatchure marks on the plat below.
- If more than one lease is dedicated to the well, outline each and identify the ownership thereof (both as to working interest and royalty).
- If more than one lease of different ownership is dedicated to the well, have the interest of all owners been consolidated by communitization, unitization, force-pooling, etc.?  
☐ Yes ☐ No If answer is "yes" type of consolidation Will be communitized  
If answer is "no" list the owners and tract descriptions which have actually been consolidated. (Use reverse side of this form if necessary.)  
No allowable will be assigned to the well until all interests have been consolidated (by communitization, unitization, forced-pooling, or otherwise) or until a non-standard unit, eliminating such interest, has been approved by the Division.

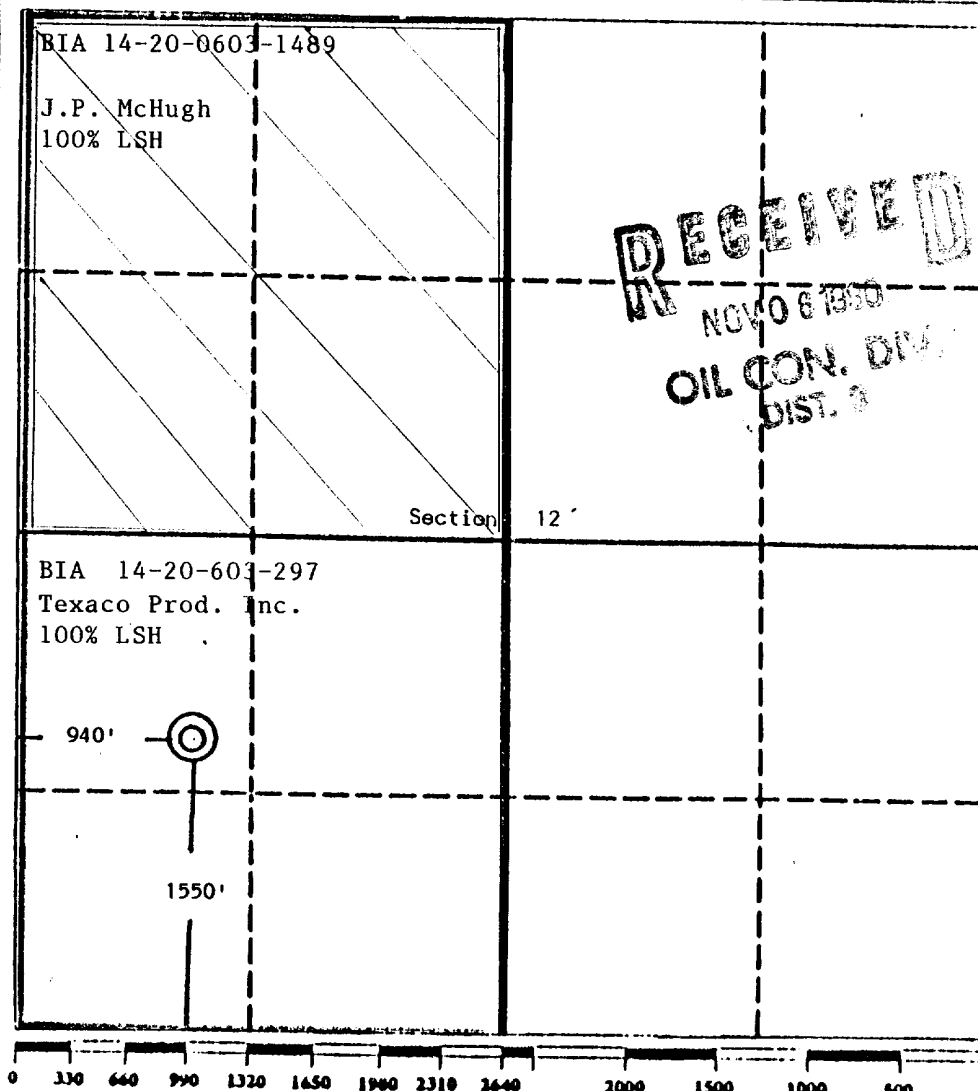

OPERATOR CERTIFICATION

I hereby certify that the information contained herein is true and complete to the best of my knowledge and belief.

Signature  
*Fran Perrin*  
Printed Name  
Fran Perrin  
Position  
Admin. Asst.  
Company  
Nassau Resources, Inc.  
Date  
7-20-90

SURVEYOR CERTIFICATION

I hereby certify that the well location shown on this plat was plotted from field notes of actual surveys made by me or under my supervision, and that the same is true and correct to the best of my knowledge and belief.

Date Surveyed  
July 10, 1990  
Signature & Seal  
Professional Surveyor  
*Edgar L. Risenhoover*  
EDGAR L. RISENHOOVER  
NEW MEXICO  
5979  
Edgar L. Risenhoover

Existing Rd.  
Access Rd.  
Water Haul Rt.

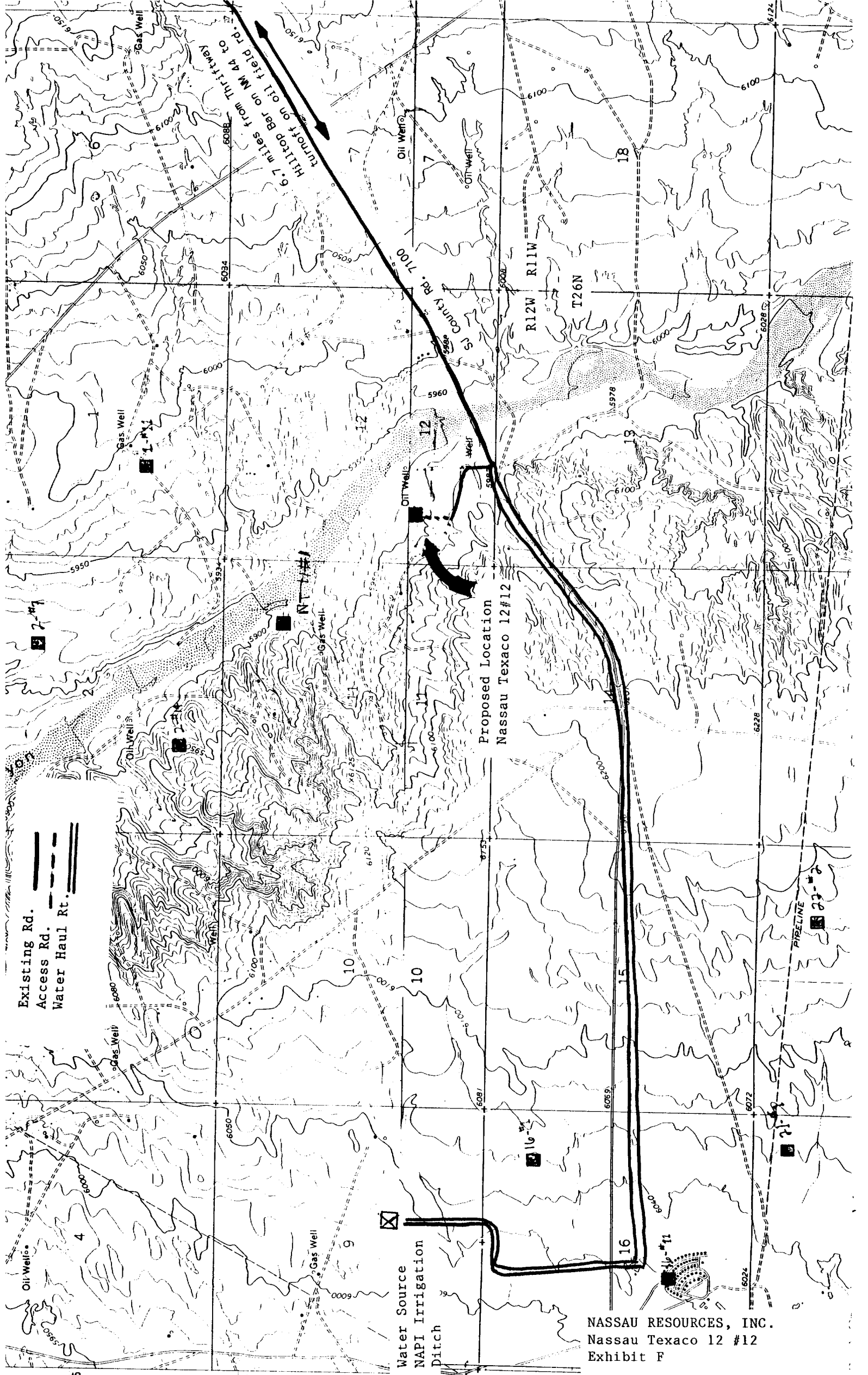

NASSAU RESOURCES, INC.  
Nassau Texaco 12 #12  
Exhibit F