

UNITED STATES
DEPARTMENT OF THE INTERIOR

BUREAU OF LAND MANAGEMENT *30-045-28504*

APPLICATION FOR PERMIT TO DRILL, DEEPEN, OR PLUG BACK

1a. TYPE OF WORK
DRILL ☒ DEEPEN ☐ PLUG BACK ☐

b. TYPE OF WELL
OIL WELL ☐ GAS WELL ☒ OTHER ☐ SINGLE ZONE ☒ MULTIPLE ZONE ☐

2. NAME OF OPERATOR
Maralex Resources, Inc.

3. ADDRESS OF OPERATOR
518 17th Street, Suite 1030, Denver, CO 80202

4. LOCATION OF WELL (Report location clearly and in accordance with any State requirements.)
At surface 1375 FSL and 1075 FWL (Unit Letter L)
At proposed prod. zone Same

14. DISTANCE IN MILES AND DIRECTION FROM NEAREST TOWN OR POST OFFICE*
Approximately 18 miles southeast of Blanco, NM

10. DISTANCE FROM PROPOSED* LOCATION TO NEAREST PROPERTY OR LEASE LINE, FT. (Also to nearest drlg. unit line, if any) 1075'

18. DISTANCE FROM PROPOSED LOCATION* TO NEAREST WELL, DRILLING, COMPLETED, OR APPLIED FOR, ON THIS LEASE, FT. 350'

21. ELEVATIONS (Show whether DF, RT, GR, etc.) *This action is subject to technical and procedural review pursuant to 43 CFR 3105.3 and appeal pursuant to 43 CFR 3105.4.*
6075' GR, 6088' KB

23. PROPOSED CASING AND CEMENTING PROGRAM

SIZE OF HOLE	SIZE OF CASING	WEIGHT PER FOOT	SETTING DEPTH
12-1/4"	8-5/8"	23# J-55	300'
7-7/8"	5-1/2"	23# J-55	2450'

5. LEASE DESIGNATION AND SERIAL NO.
~~SE 078476~~ Nm 03606
6. IF INDIAN, ALLOTTEE OR TRIBE NAME
None
7. UNIT AGREEMENT NAME

8. FARM OR LEASE NAME
Oxnard "B" Com
9. WELL NO.
10
10. FIELD AND POOL, OR WILDCAT
Basin Fruitland Coal
11. SEC., T., R., M., OR BLK. AND SURVEY OR AREA
L Sec. 14, T27N, R8W
12. COUNTY OR PARISH
San Juan
13. STATE
New Mexico

17. NO. OF ACRES ASSIGNED TO THIS WELL
W/320

20. ROTARY OR CABLE TOOLS
Rotary

22. APPROX. DATE WORK WILL START*
November 1, 1990

DRILLING OPERATIONS AUTHORIZED ARE
SUBJECT TO COMPLIANCE WITH ATTACHED
* GENERAL REQUIREMENTS
248 cuft/210 sx Class B w/2%
CaCl.
388 cuft/308 sx 50:50 POZ w/2%
gel
118 cuft/100 sx Class B neat
tail

Maralex Resources, Inc. proposes to drill a 12-1/4" hole to 300' using a native fresh water mud. The 8-5/8" surface string will be cemented back to surface. Casing will then be drilled out with a 7-7/8" bit using a low solids, non-dispersed fresh water mud. Upon reaching TD, a full suite of open hole logs will be run and 5-1/2" production casing will be set and cemented back to surface. In accordance with "On Shore Oil and Gas Order #1" attached is the Drilling Plan and Surface Use Plan that we will follow in drilling the subject well.

IN ABOVE SPACE DESCRIBE PROPOSED PROGRAM: If proposal is to deepen or plug back, give data on present productive zone and proposed new productive zone. If proposal is to drill or deepen directionally, give pertinent data on subsurface locations and measured and true vertical depths. Give blowout preventer program, if any.

24.
SIGNED *A. M. O'Hare* TITLE President DATE 10/5/90
(This space for additional signatures and dates)
PERMIT NO. **RECEIVED** APPROVAL DATE
APPROVED BY FEB 04 1991 TITLE
OIL CON. DIV. DIST. 3 NMOC
AREA MANAGER

*See Instructions On Reverse Side

Submit to Appropriate
District Office
State Lease - 4 copies
Fee Lease - 3 copies

State of New Mexico
Energy, Minerals and Natural Resources Department

Form C-102
Revised 1-1-89

OIL CONSERVATION DIVISION

P.O. Box 2088
Santa Fe, New Mexico 87504-2088

DISTRICT I
P.O. Box 1980, Hobbs, NM 88240

DISTRICT II
P.O. Drawer DD, Artesia, NM 88210

DISTRICT III
1000 Rio Brazos Rd., Aztec, NM 87410

WELL LOCATION AND ACREAGE DEDICATION PLAT

All Distances must be from the outer boundaries of the section

Operator MARALEX RESOURCES, INC.		Lease OXNARD "B" COM		Well No 10
Unit Letter L	Section 14	Township 27 N	Range 8 W	County San Juan
Actual Footage Location of Well: 1375 feet from the South line and 1075 feet from the West line				
Ground level Elev. 6075	Producing Formation Fruitland	Pool Basin Fruitland Coal Gas	Dedicated Acreage: 320 Acres	
<p>1. Outline the acreage dedicated to the subject well by colored pencil or hatchure marks on the plat below.</p> <p>2. If more than one lease is dedicated to the well, outline each and identify the ownership thereof (both as to working interest and royalty).</p> <p>3. If more than one lease of different ownership is dedicated to the well, have the interest of all owners been consolidated by communitization, unitization, force-pooling, etc.? <input checked="" type="checkbox"/> Yes <input type="checkbox"/> No If answer is "yes" type of consolidation <u>Communitization</u> If answer is "no" list the owners and tract descriptions which have actually been consolidated. (Use reverse side of this form if necessary.) No allowable will be assigned to the well until all interests have been consolidated (by communitization, unitization, forced-pooling, or otherwise) or until a non-standard unit, eliminating such interest, has been approved by the Division.</p>				

OPERATOR CERTIFICATION

I hereby certify that the information contained herein is true and complete to the best of my knowledge and belief.

Signature

A. M. O'Hare

Printed Name

A. M. O'Hare

Position

President

Company

Maralex Resources, Inc.

Date

10/5/90

SURVEYOR CERTIFICATION

I hereby certify that the well location shown on this plat was plotted from field notes of actual surveys made by me or under my supervision, and that the same is true and correct to the best of my knowledge and belief.

10-1-90

Date Surveyed

William E. Mahnke II

Signature and Seal of
Professional Surveyor

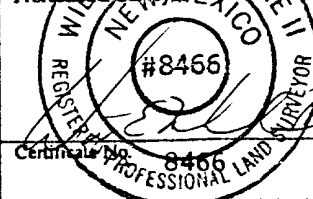

Certificate No. 8456

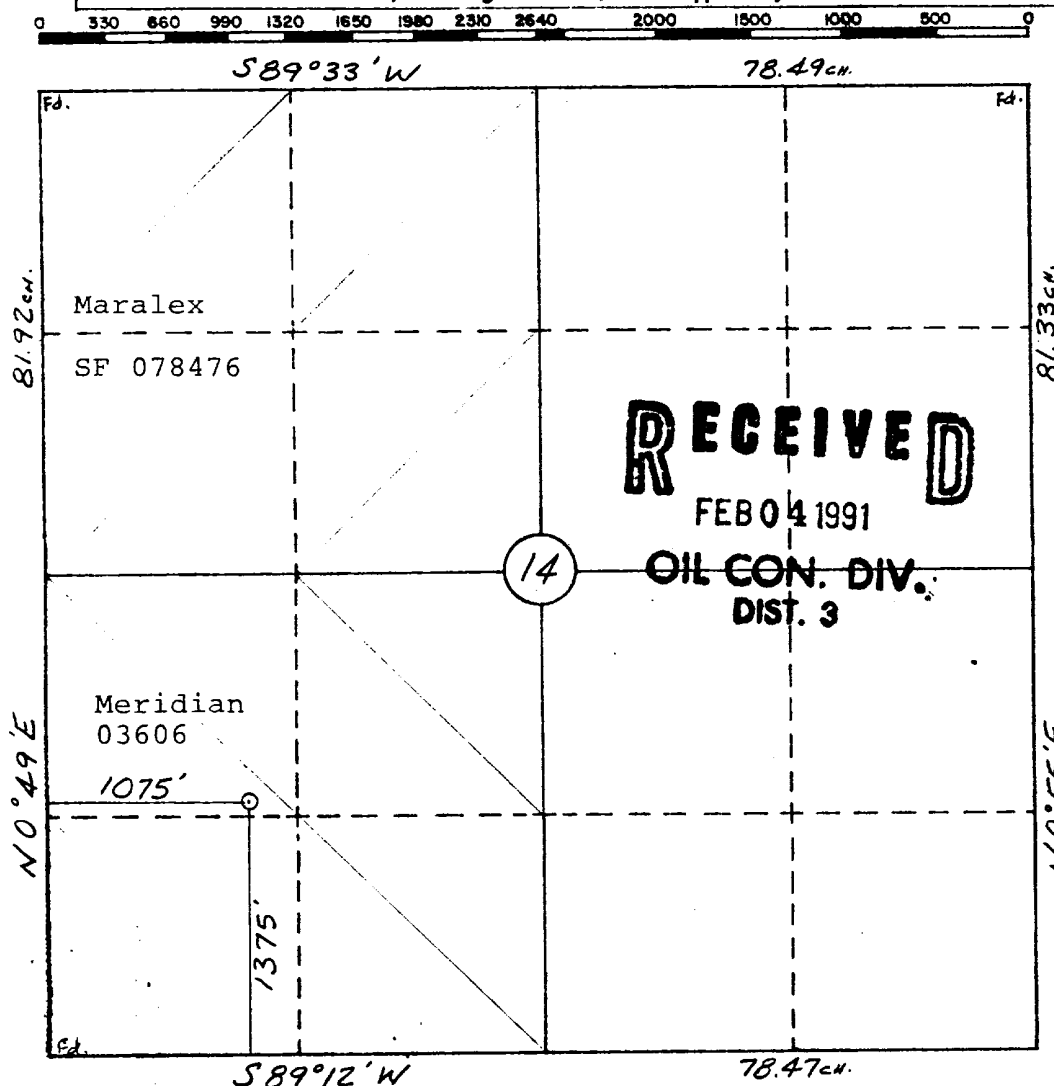

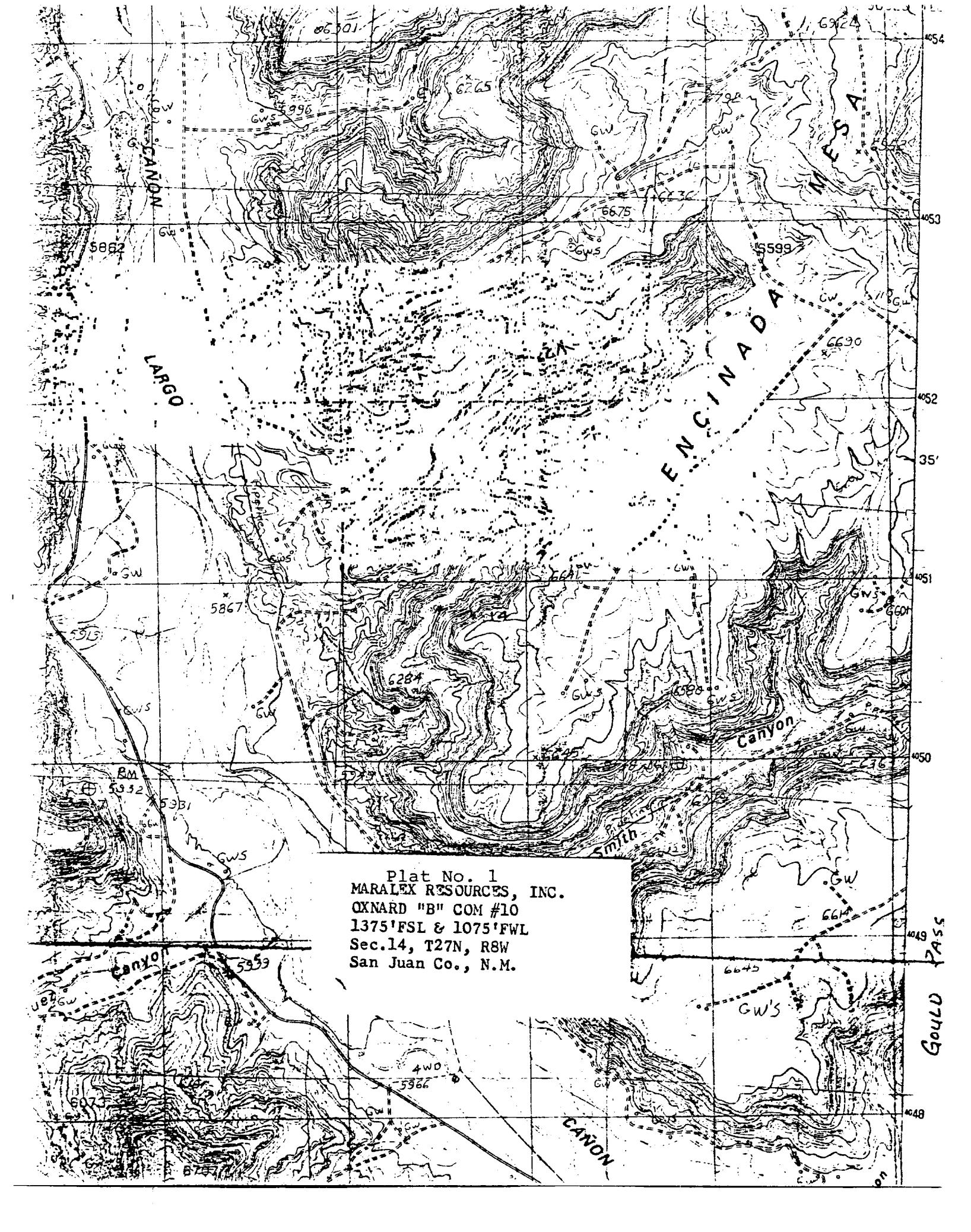

Plat No. 1
MARALEX RESOURCES, INC.
OXNARD "B" COM #10
1375' FSL & 1075' FWL
Sec. 14, T27N, R8W
San Juan Co., N.M.