

UNITED STATES
DEPARTMENT OF THE INTERIOR
BUREAU OF LAND MANAGEMENT

APPLICATION FOR PERMIT TO DRILL OR DEEPEN

1a. TYPE OF WORK

DRILL ☒DEEPEN ☐

b. TYPE OF WELL

OIL
WELL ☐GAS
WELL ☒OTHER ☐SINGLE
ZONE ☒MULTIPLE
ZONE ☐

2. NAME OF OPERATOR

MARALEX RESOURCES, INC.

Attn: A. M. O'Hare

3. ADDRESS AND TELEPHONE NO.

P. O. Box 421 Blanco, N.M. 87412-0421 (505) 325-5599

4. LOCATION OF WELL (Report location clearly and in accordance with any State requirements.)*

At surface

1719'FNL 1021'FEL

At proposed prod. zone Same

14. DISTANCE IN MILES AND DIRECTION FROM NEAREST TOWN OR POST OFFICE*

21 Miles South of Farmington, N.M.

16. DISTANCE FROM PROPOSED*

LOCATION TO NEAREST
PROPERTY OR LEASE LINE, FT.
(Also to nearest drlg. unit line, if any)

1021'

18. DISTANCE FROM PROPOSED LOCATION*
TO NEAREST WELL, DRILLING, COMPLETED,
OR APPLIED FOR, ON THIS LEASE, FT.

265'

16. NO. OF ACRES IN LEASE

2373.780

19. PROPOSED DEPTH

1355'

17. NO. OF ACRES ASSIGNED
TO THIS WELL

N/A 320

20. ROTARY OR CABLE TOOLS

Rotary

21. ELEVATIONS (Show whether DF, RT, GR, etc.)

6011'GR

22. APPROX. DATE WORK WILL START*

As Soon As Permitted

23.

PROPOSED CASING AND CEMENTING PROGRAM

DRILLING OPERATIONS AUTHORIZED ARE
SUBJECT TO COMPLIANCE WITH ATTACHED
GENERAL REQUIREMENTS

SIZE OF HOLE	GRADE, SIZE OF CASING	WEIGHT PER FOOT	SETTING DEPTH	QUANTITY OF CEMENT
8-3/4"	7"	20# J-55	120'	59 ft ³ Class B w/2% CaCl
6-1/4"	4-1/2"	10.5# J-55	1355'	154 ft ³ Class B w/2% Meta Silicate
				89 ft ³ Class B Neat Tail

Maralex Resources, Inc. proposes to drill a vertical well to develop the Fruitland Coal formation at the above described site in accordance with the attached drilling and surface use programs.

As part of the NAPI Project, this location has already been archaeologically surveyed. No additional archaeology reports will be submitted with this APD.

This APD also is serving as an application to obtain BLM road right-of-way. The right-of-way will be an existing road extending from County Road 7100 approximately 1/2 mile in length and 20' in width. The proposed right-of-way crosses NE/NW, NW/NW and SW/NW of Section 7, T26N, R12W; and the SE/NE of Section 12, T26N, R13W all of San Juan County.

IN ABOVE SPACE DESCRIBE PROPOSED PROGRAM: If proposal is to deepen, give data on present productive zone and proposed new productive zone. If proposal is to drill or deepen directionally, give pertinent data on subsurface locations and measured and true vertical depths. Give blowout preventer program, if any.

24.

A. M. O'Hare

SIGNED

TITLE President

DATE 12/1/92

(This space for Federal or State office use)

PERMIT NO.

APPROVAL DATE

Application approval does not warrant or certify that the applicant holds legal or equitable title to those rights in the subject lease which would entitle the applicant to compensation thereon.

CONDITIONS OF APPROVAL ANY:

APPROVED BY

TITLE

DATE

DIST. 3

*See Instructions On Reverse Side

Title 18 U.S.C. Section 1001, makes it a crime for any person knowingly and willfully to make to any department or agency of the United States any false, fictitious or fraudulent statements or representations as to any matter within its jurisdiction.

Submit to Appropriate
District Office
State Lease - 4 copies
Fee Lease - 3 copies

State of New Mexico
Energy, Minerals and Natural Resources Department

Form C-102
Revised 1-1-89

OIL CONSERVATION DIVISION

P.O. Box 2088
Santa Fe, New Mexico 7504-2088

DISTRICT I
P.O. Box 1980, Hobbs, NM 88240

DISTRICT II
P.O. Drawer DD, Artesia, NM 88210

DISTRICT III
1000 Rio Brazos Rd., Aztec, NM 87410

WELL LOCATION AND ACREAGE DEDICATION PLAT

All Distances must be from the outer boundaries of the section

Operator		MARALEX RESOURCES INC.		Lease		GALLEGOS FEDERAL 26-13-12		Well No. 1	
Unit Letter	H	Section	12	Township	T.26 N.	Range	R.13 W.	County	SAN JUAN
Actual Footage Location of Well:		1719		feet from the NORTH line and		1021		feet from the EAST line	
Ground level Elev.	6011	Producing Formation		Fruitland Coal		Pool		Basin Fruitland Coal	
Dedicated Acreage:		320		Acres					

- Outline the acreage dedicated to the subject well by colored pencil or hatchue marks on the plat below.
- If more than one lease is dedicated to the well, outline each and identify the ownership thereof (both as to working interest and royalty).
- If more than one lease of different ownership is dedicated to the well, have the interest of all owners been consolidated by communitization, unitization, force-pooling, etc.?
☐ Yes ☐ No If answer is "yes" type of consolidation _____
If answer is "no" list the owners and tract descriptions which have actually been consolidated. (Use reverse side of this form if necessary).
No allowable will be assigned to the well until all interests have been consolidated (by communitization, unitization, forced-pooling, or otherwise) or until a non-standard unit, eliminating such interest, has been approved by the Division.

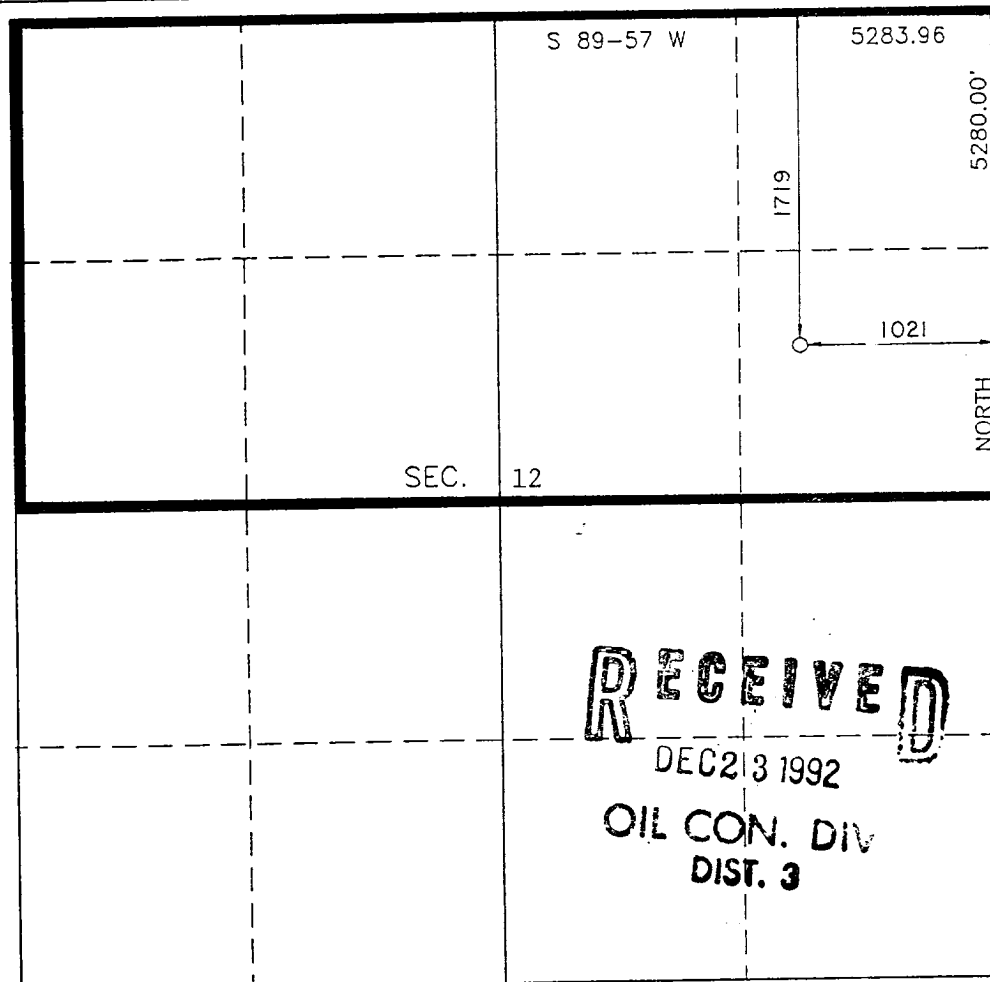

RECEIVED
DEC 23 1992
OIL CON. DIV
DIST. 3

OPERATOR CERTIFICATION

I hereby certify that the information contained herein is true and complete to the best of my knowledge and belief.

Signature *A. M. O'Fare*
Printed Name A. M. O'Fare
Position President
Company Maralex Resources Inc.
Date 12/1/92

SURVEYOR CERTIFICATION

I hereby certify that the well location shown on this plat was plotted from field notes of actual surveys made by me or under my supervision, and that the same is true and correct to the best of my knowledge and belief.

Date Surveyed NOVEMBER 24, 1992

Signature & Seal
Professional Surveyor
ROY A. RUSH
NEW MEXICO
8894
Certificate No. 8894
Professional Land Surveyor

MARALEX RESOURCES INC.

GALLEGOS FEDERAL 26-13-12 WELL NO. 1

SEC.12, T.26 N., R.13 W., N.M.P.M.,
SAN JUAN COUNTY, NEW MEXICO

BLM Road Right-of-Way Route

