

UNITED STATES
DEPARTMENT OF THE INTERIOR
BUREAU OF LAND MANAGEMENT

30-045-29005

APPLICATION FOR PERMIT TO DRILL, DEEPEN, OR PLUG BACK

1a. TYPE OF WORK DRILL <input checked="" type="checkbox"/> DEEPEN <input type="checkbox"/> PLUG BACK <input type="checkbox"/>		5. LEASE DESIGNATION AND SERIAL NO. NM 013492		
b. TYPE OF WELL OIL WELL <input type="checkbox"/> GAS WELL <input checked="" type="checkbox"/> OTHER <input type="checkbox"/>		6. IF INDIAN, ALLOTTEE OR TRIBE NAME N/A		
2. NAME OF OPERATOR 13998 SC INTERESTS MARALEX RESOURCES, INC.		7. UNIT AGREEMENT NAME N/A		
3. ADDRESS OF OPERATOR PO Box 421, Blanco, NM 87412-0421		8. FARM OR LEASE NAME 13252 W. BISTI 26-13-20		
4. LOCATION OF WELL (Report location clearly and in accordance with any State requirements.) At surface 1940' FNL, 885' FEL (SE NE) Sec 20-26N-13W At proposed prod. zone Same		9. WELL NO. #1		
14. DISTANCE IN MILES AND DIRECTION FROM NEAREST TOWN OR POST OFFICE* Approx 15 miles southeast of Farmington, NM		10. FIELD AND POOL, OR WILDCAT 71629 Basin Fruitland Coal		
15. DISTANCE FROM PROPOSED* LOCATION TO NEAREST PROPERTY OR LEASE LINE, FT. (Also to nearest drlg. unit line, if any) 885'		11. SEC., T., R., M., OR BLK. AND SURVEY OR AREA H Sec 20-26N-13W		
16. NO. OF ACRES IN LEASE 2320'		12. COUNTY OR PARISH San Juan		
17. NO. OF ACRES ASSIGNED TO THIS WELL E 320		13. STATE NM		
18. DISTANCE FROM PROPOSED* LOCATION TO NEAREST WELL, DRILLING, COMPLETED, OR APPLIED FOR, ON THIS LEASE, FT. 3700'		19. PROPOSED DEPTH 1750'		
20. ROTARY OR CABLE TOOLS Rotary		21. ELEVATIONS (Show whether DF, RT, GR, etc.) GL 6383		
22. APPROX. DATE WORK WILL START* Upon BLM approval		23. DRILLING OPERATIONS AUTHORIZED AND SUBJECT TO COMPLIANCE WITH ATTACHED GENERAL REQUIREMENTS		
SIZE OF HOLE	SIZE OF CASING	WEIGHT PER FOOT	SETTING DEPTH	QUANTITY OF CEMENT
8-3/4"	7"	20# J-55	120'	50 sx Class B
6-1/4"	4-1/2"	10.5# J-55	1750' TD	170 sx Class B

Maralex Resources, Inc. proposes to drill a vertical well to develop the Fruitland Coal Formation at the above described site in accordance with the attached drilling and surface use programs.

As part of the NAPI Project, this location has already been archaeologically surveyed. No additional archaeology reports will be submitted with this APD.

All of the access road for this well is located on this lease, so no right-of-way application is required.

cc: BIA

IN ABOVE SPACE DESCRIBE PROPOSED PROGRAM: If proposal is to deepen or plug back, give data on present production zone. If proposal is to drill or deepen directionally, give pertinent data on subsurface locations and measures to prevent blowout program, if any.

SIGNED A. M. O'Hare TITLE President DATE October 4, 1993
(This space for Federal or State office use)

PERMIT NO. _____ APPROVAL DATE _____
APPROVED BY _____ TITLE _____ DATE _____
CONDITIONS OF APPROVAL, IF ANY:

NMOCD

*See Instructions On Reverse Side

RECEIVED
OCT 27 1993

OIL CON. DIV.
DIST. 3

AS AMENDED

OCT 22 1993

DISTRICT MANAGER

Submit to Appropriate
District Office
State Lease - 4 copies
Fee Lease - 3 copies

State of New Mexico
Energy, Minerals and Natural Resources Department

Form C-102
Revised 1-1-89

OIL CONSERVATION DIVISION

P.O. Box 2088
Santa Fe, New Mexico 87504-2088

RECEIVED
SLM

93 OCT 12 AM 7:52

DISTRICT I
P.O. Box 1980, Hobbs, NM 88240

DISTRICT II
P.O. Drawer DD, Artesia, NM 88210

DISTRICT III
1000 Rio Brazos Rd., Aztec, NM 87410

WELL LOCATION AND ACREAGE DEDICATION PLAT

All Distances must be from the outer boundaries of the section

Operator MARALEX RESOURCES			Lease W. BISTI 26-13-20		Well No. 1
Unit Letter H	Section 20	Township 26 NORTH	Range 13 WEST	County NMPM	SAN JUAN
Actual Footage Location of Well: 1940 feet from the NORTH line and 885 feet from the EAST line					
Ground level Elev. 6383		Producing Formation Fruitland		Pool Basin Fruitland Coal Dedicated Acreage: 320 Acres	

- Outline the acreage dedicated to the subject well by colored pencil or hatchure marks on the plat below.
- If more than one lease is dedicated to the well, outline each and identify the ownership thereof (both as to working interest and royalty).
- If more than one lease of different ownership is dedicated to the well, have the interest of all owners been consolidated by communitization, unitization, force-pooling, etc?
☐ Yes ☐ No If answer is "yes" type of consolidation _____
If answer is "no" list the owners and tract descriptions which have actually been consolidated. (Use reverse side of this form if necessary.)
No allowable will be assigned to the well until all interests have been consolidated (by communitization, unitization, force-pooling, or otherwise) or until a non-standard unit, eliminating such interest, has been approved by the Division.

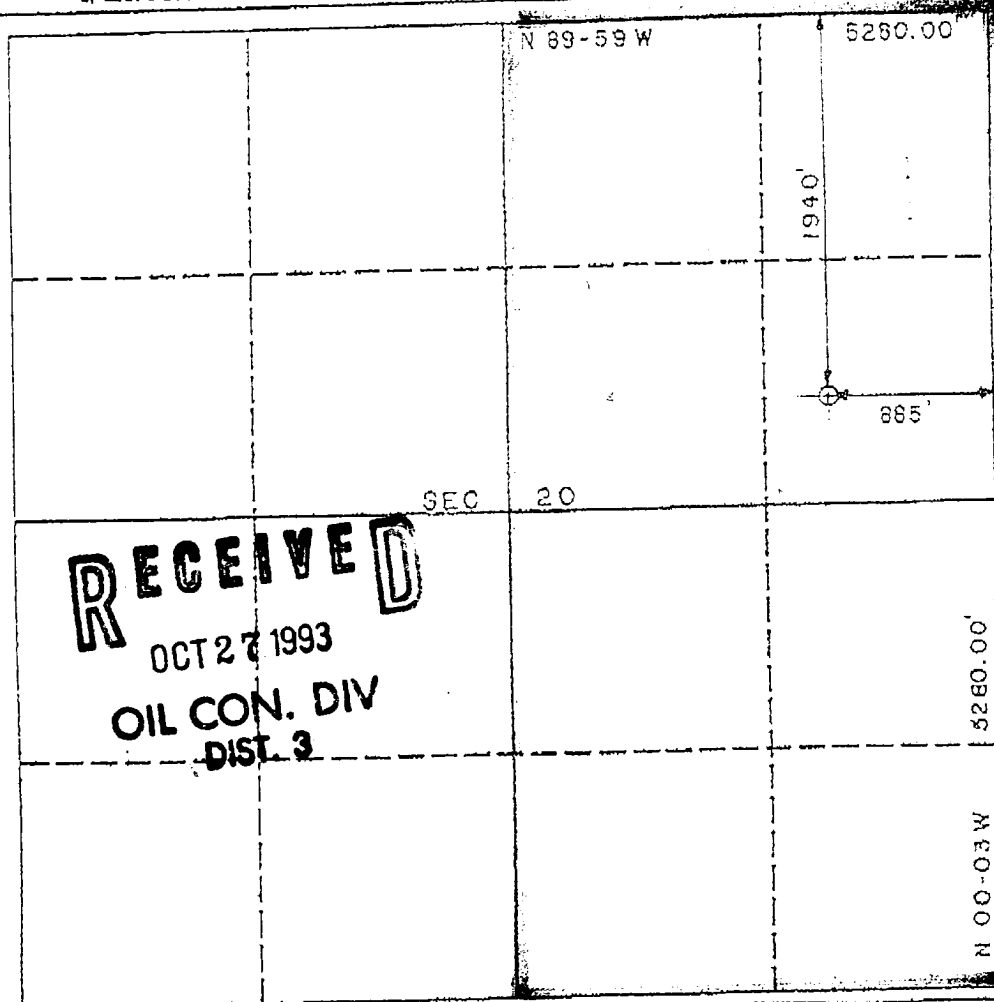

OPERATOR CERTIFICATION

I hereby certify that the information contained herein is true and complete to the best of my knowledge and belief.

Signature
A. M. O'Hare
Printed Name
A. M. O'Hare
Position
President
Company
Maralex Resources, Inc.
Date
October 4, 1993

SURVEYOR CERTIFICATION

I hereby certify that the well location shown on this plat was plotted from field notes of actual surveys made by me or under my supervision, and that the same is true and correct to the best of my knowledge and belief. **SEPTEMBER 29, 1993**

Date Surveyed

Signature & Seal
Professional Surveyor
A. RUSH

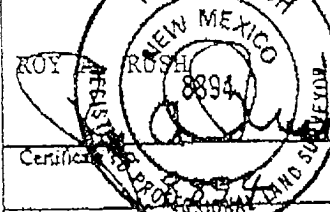

Certified by
SEP 29 1993



WEST BISTI 26-13-20 #1
1940' FNL, 885' FEL
SEC 20, T26N, R13W
SAN JUAN COUNTY, NEW MEXICO