

UNITED STATES
DEPARTMENT OF THE INTERIOR
BUREAU OF LAND MANAGEMENT

reverse side

Expires August 31, 1985

APPLICATION FOR PERMIT TO DRILL, DEEPEN, OR PLUG BACK

1a. TYPE OF WORK DRILL <input checked="" type="checkbox"/> DEEPEN <input type="checkbox"/> PLUG BACK <input type="checkbox"/>		5. LEASE DESIGNATION AND SERIAL NO. NM 013492	
b. TYPE OF WELL OIL WELL <input type="checkbox"/> GAS WELL <input checked="" type="checkbox"/> OTHER <input type="checkbox"/>		6. IF INDIAN, ALLOTTEE OR TRIBE NAME ---	
2. NAME OF OPERATOR 20572 SG INTERESTS I/MARALEX RESOURCES, INC. (505) 325-5599- (303) 563-4000		7. UNIT AGREEMENT NAME ---	
3. ADDRESS OF OPERATOR PO Box 338, IGAPACIO, CO 81137		8. FARM OR LEASE NAME W. BISTI 26-13-18	
4. LOCATION OF WELL (Report location clearly and in accordance with any State requirements.)* At surface 1077' FSL, 1454' FWL (SE SW) Sec 18-T26N-R13W At proposed prod. zone Same		9. WELL NO. 2	
14. DISTANCE IN MILES AND DIRECTION FROM NEAREST TOWN OR POST OFFICE* Approx 19-1/2 miles southeast of Farmington, NM		10. FIELD AND POOL, OR WILDCAT Basin Fruitland Coal	
15. DISTANCE FROM PROPOSED* LOCATION TO NEAREST PROPERTY OR LEASE LINE, FT. (Also to nearest drlg. unit line, if any) 1454'		11. SEC., T., R., M., OR BLK. AND SURVEY OR AREA N Sec 18-T26N-R13W	
16. NO. OF ACRES IN LEASE 2320		12. COUNTY OR PARISH San Juan	
17. NO. OF ACRES ASSIGNED TO THIS WELL 320 5/350.79		13. STATE NM	
18. DISTANCE FROM PROPOSED LOCATION* TO NEAREST WELL, DRILLING, COMPLETED, OR APPLIED FOR, ON THIS LEASE, FT. 1320'		20. ROTARY OR CABLE TOOLS Rotary	
21. ELEVATIONS (Show whether DF, RT, GR, etc.) GL 6514'		22. APPROX. DATE WORK WILL START* Upon BLM Approval	
23. PROPOSED CASING AND CEMENTING PROGRAM			
SIZE OF HOLE	SIZE OF CASING	WEIGHT PER FOOT	SETTING DEPTH
8-3/4"	7"	20# J-55	120'
6-1/4"	4-1/2"	10.5# J-55	TD
		QUANTITY OF CEMENT 50 sx Class B 250 sx Class B	

Maralex Resources, Inc. proposes to drill a vertical well to develop the Fruitland Coal Formation at the above described site in accordance with the attached drilling and surface use programs.

An Archaeological survey will be conducted to determine any potential sites.

All of the access road for this well is located on this lease, so no right-of-way application is required.

IN ABOVE SPACE DESCRIBE PROPOSED PROGRAM: If proposal is to deepen or plug back, give data on existing productive zone and proposed new productive zone. If proposal is to drill or deepen directionally, give pertinent data on subsurface geology and measured and true vertical depths. Give blowout preventer program, if any.

SIGNED D. R. Reimers TITLE Engineering Manager DATE October 14, 1993
(This space for Federal or State office use)

PERMIT NO. _____ APPROVAL DATE _____

APPROVED BY _____ TITLE _____
CONDITIONS OF APPROVAL, IF ANY:

APPROVED
AS AMENDED

*See Instructions On Reverse Side

Title 18 U.S.C. Section 1001, makes it a crime for any person knowingly and willfully to make to any department or agency of the United States any false, fictitious or fraudulent statements or representations as to any matter within its jurisdiction.

DISTRICT MANAGER

DISTRICT MANAGER

AS AMENDED
APPROVED

THE DISTRICT MANAGER OF THE DISTRICT OF COLUMBIA
DOES HEREBY CERTIFY THAT THE FOLLOWING IS A TRUE AND
CORRECT COPY OF THE RESOLUTION OF THE DISTRICT
COUNCIL AS AMENDED, AND THAT THE SAME HAS BEEN
FILED FOR RECORD IN THE OFFICE OF THE DISTRICT
MANAGER.

ATTEST:
DISTRICT MANAGER

DISTRICT MANAGER

DISTRICT MANAGER

Submit to Appropriate
District Office
State Lease - 4 copies
Fee Lease - 3 copies

State of New Mexico
Energy, Minerals and Natural Resources Department

Form C-102
Revised 1-1-89

OIL CONSERVATION DIVISION

P.O. Box 2088
Santa Fe, New Mexico 87504-2088

RECEIVED
BLM

93 OCT 18 PM 7:38

DISTRICT I
P.O. Box 1980, Hobbs, NM 88240

DISTRICT II
P.O. Drawer DD, Artesia, NM 88210

DISTRICT III
1000 Rio Brazos Rd., Aztec, NM 87410

WELL LOCATION AND ACREAGE DEDICATION PLAT

All Distances must be from the outer boundaries of the section

Operator MARALEX RESOURCES, INC.			Lease W. BISTI 26-13-18		Well No. 2
Unit Letter N	Section 18	Township 26 NORTH	Range 13 WEST	County SAN JUAN	
Actual Footage Location of Well: 1077 feet from the SOUTH line and 1454 feet from the WEST line					
Ground level Elev. 6514	Producing Formation Fruitland		Pool Basin Fruitland Coal		Dedicated Acreage: 5/320350.72 Acres

- Outline the acreage dedicated to the subject well by colored pencil or hatchure marks on the plat below.
- If more than one lease is dedicated to the well, outline each and identify the ownership thereof (both as to working interest and royalty).
- If more than one lease of different ownership is dedicated to the well, have the interest of all owners been consolidated by communization, unitization, force-pooling, etc.?
☐ Yes ☐ No If answer is "yes" type of consolidation _____
If answer is "no" list the owners and tract descriptions which have actually been consolidated. (Use reverse side of this form if necessary).
No allowable will be assigned to the well until all interests have been consolidated (by communization, unitization, forced-pooling, or otherwise) or until a non-standard unit, eliminating such interest, has been approved by the Division.

OPERATOR CERTIFICATION

I hereby certify that the information contained herein is true and complete to the best of my knowledge and belief.

Signature
D. R. Reimers
Printed Name
D. R. Reimers
Position
AGENT
Engineering Manager
Company
SC INTERESTS I, LTD
Maralex Resources, Inc.
Date
October 14, 1993

SURVEYOR CERTIFICATION

I hereby certify that the well location shown on this plat was plotted from field notes of actual surveys made by me or under my supervision, and that the same is true and correct to the best of my knowledge and belief.

Date Surveyed
OCTOBER 14, 1993
Signature & Seal of Professional Surveyor
Roy A. Rush
ROY A. RUSH
Certificate No.
8894

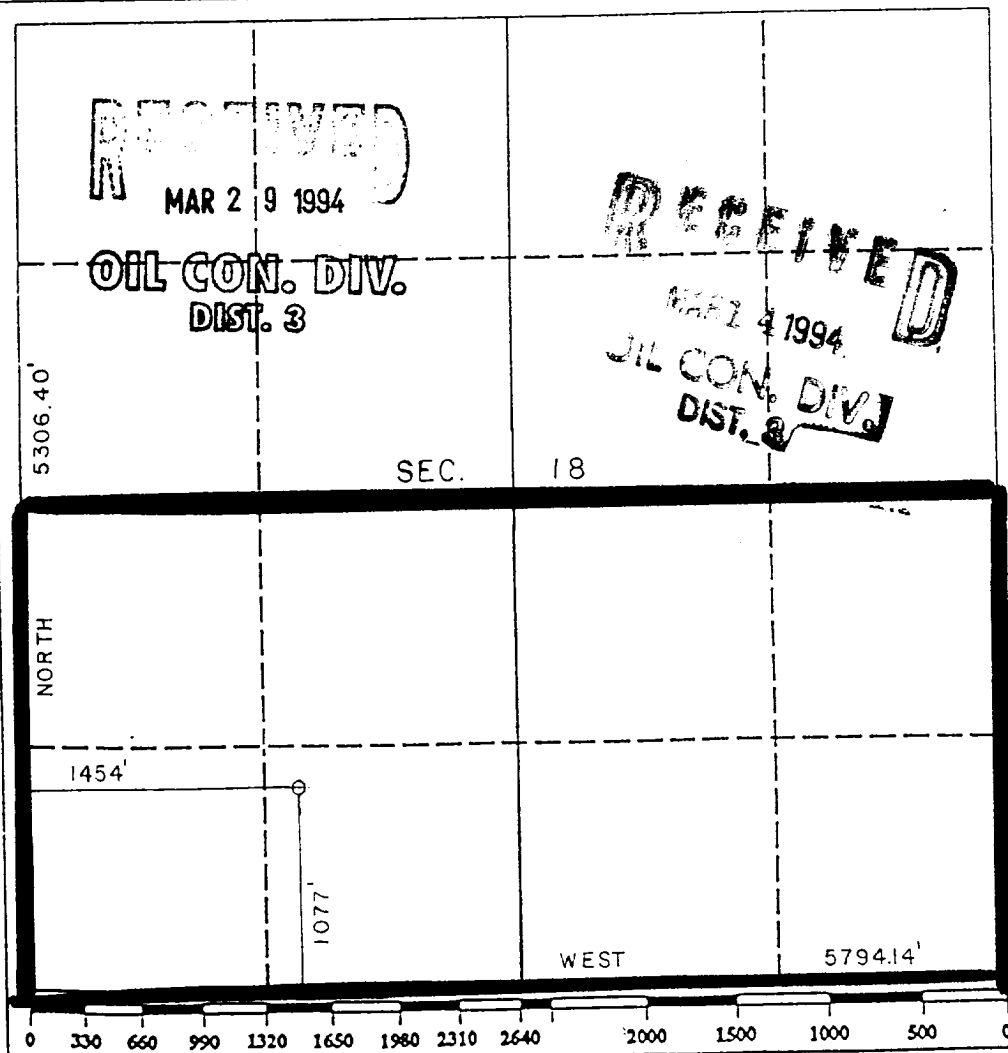

40

80

$$\begin{array}{r} 15.30 \\ 15.49 \\ \hline 30.79 \end{array}$$

$$\begin{array}{r} 80 \\ 30.79 \\ \hline 110.79 \end{array}$$

$$\begin{array}{r} 242.00 \\ 110.79 \\ \hline 352.79 \end{array}$$

742

17'30"

743

R 14 W 744 1370000 FEET

R 13 W

FARMINGTON TOWNSHIP

31

12

7

8

Well

6351

6273

6263

6339

2 C
FE

404

RECEIVED
MAR 29 1994**OIL CON. DIV.**
DIST. 3

18

14

13

6463

BISTI

W. BISTI
26-13-18 NO. 2

Arroyo

6485

Pinabete

6214

FIELD

6549

MONCISCO

6552

19

BM
6563

30 MI LONG ME X 44

RECEIVED
MAR 29 1994

6438

6439

MESA

26

25

30

6380

6447

ring

35

36

6364

SCIENTERESTS, LTD
MARALEX RESOURCES, INC.

WEST BISTI 26-13-18 No. 2

1077' FSL, 1454' FWL

SEC 18-T26N-R13W

SAN JUAN COUNTY, NEW MEXICO