

SUBMIT IN TRIPLICATE*
(Other instructions on reverse side)

Form approved.
Budget Bureau No. 1004-0136
Expires: December 31, 1991

UNITED STATES
DEPARTMENT OF THE INTERIOR
BUREAU OF LAND MANAGEMENT
DIST-8
APPLICATION FOR PERMIT TO DRILL OR DEEPEN

1. TYPE OF WORK <input checked="" type="checkbox"/> DRILL <input type="checkbox"/> DEEPEN			5. LEASE DESIGNATION AND SERIAL NO. NO-G-9602-1301	
2. NAME OF OPERATOR THOMPSON ENGINEERING & PRODUCTION CORPORATION 37581			6. IF INDIAN, ALLOTTEE OR TRIBE NAME Navajo	
3. ADDRESS AND TELEPHONE NO. 7415 E. Main Farmington, New Mexico 87402 (505)327-4892			7. UNIT AGREEMENT NAME	
4. LOCATION OF WELL (Report location clearly and in accordance with any State requirements.) At surface 1780' FNL & 1765' FEL At proposed prod. zone Same			8. FARM OR LEASE NAME WELL NO. Leslie #1 19363	
14. DISTANCE IN MILES AND DIRECTION FROM NEAREST TOWN OR POST OFFICE* 16 miles South of Farmington			9. AN WELL NO. 30-045-29397	
10. DISTANCE FROM PROPOSED* LOCATION TO NEAREST PROPERTY OR LEASE LINE, FT. (Also to nearest drig. unit line, if any) 842		16. NO. OF ACRES IN LEASE 160		17. NO. OF ACRES ASSIGNED TO THIS WELL 160
18. DISTANCE FROM PROPOSED LOCATION* TO NEAREST WELL, DRILLING, COMPLETED, OR APPLIED FOR, ON THIS LEASE, FT. No other Wells		19. PROPOSED DEPTH 1200		20. ROTARY OR CABLE TOOLS Rotary
21. ELEVATIONS (Show whether DF, RT, GR, etc.) 5944' GL			22. APPROX. DATE WORK WILL START* June 1996	

PROPOSED CASING AND CEMENTING PROGRAM

SIZE OF HOLE	GRADE, SIZE OF CASINO	WEIGHT PER FOOT	SETTING DEPTH	QUANTITY OF CEMENT
8 3/4	7" K-55	20	120	36 cu. ft.
6 1/4	4 1/2 K-55	10.5	1200	175 cu. ft. w/ 2% metasilicate & 89 cu. ft. cl "B"

This casing is to be installed and cemented in accordance to 43 CFR 3165.3 and appeal pursuant to 43 CFR 3165.4.

Thompson Engineering and Production Corporation proposes to drill a vertical well to test the Pictured Cliffs Formation at the above described location in accordance with the attached drilling and surface use plans.

This location is part of Block 9 of the NAPI Project and was included in previous archaeological and environment assessment reports. Department of Interior (INT-FES-76-52) 10/12/76.

This APD is also serving as an application to obtain BLM road and pipeline right-of-way. Approximately 800' of an existing two-track road will be improved to access this location. The two-track road crosses the SW/NE of Section 7, R26N, T12W where it joins County Road 7100. The pipeline route is approximately 200' long as indicated on Plat 1.

IN ABOVE SPACE DESCRIBE PROPOSED PROGRAM: If proposal is to deepen, give data on present productive zone and proposed new productive zone. If proposal is to drill or deepen directionally, give pertinent data on subsurface locations and measured and true vertical depths. Give blowout preventer program, if any.

SIGNED Paul C. Thompson TITLE President DATE 4/22/96

(This space for Federal or State office use)

PERMIT NO. _____ APPROVAL DATE _____
Application approval does not warrant or certify that the applicant holds legal or equitable title to those rights in the subject lease which would entitle the applicant to recover thereon.

CONDITIONS OF APPROVAL, IF ANY

APPROVED BY [Signature] TITLE NMOC DATE AUG 07 1996
DISTRICT MANAGER

*See Instructions On Reverse Side

District I
PO Box 1980, Hobbs, NM 88241-1980
District II
PO Drawer DD, Artesia, NM 88211-0719
District III
1000 Rio Brazos Rd., Aztec, NM 87410
District IV
PO Box 2088, Santa Fe, NM 87504-2088

State of New Mexico
Energy, Minerals & Natural Resources Department

OIL CONSERVATION DIVISION
PO Box 2088
Santa Fe, NM 87504-2088

Form C-102
Revised February 21, 1994
Instructions on back
Submit to Appropriate District Office
State Lease - 4 Copies
Fee Lease - 3 Copies

☐ AMENDED REPORT

WELL LOCATION AND ACREAGE DEDICATION PLAT

1 API Number 30-045-29397		2 Pool Code 87190		3 Pool Name WAW Fruitland Sand Pictured Cliffs EXT	
4 Property Code 19363		5 Property Name Leslie			6 Well Number 1
7 OGRID No. 037581		8 Operator Name Thompson Engineering Corp.			9 Elevation 5922'

10 Surface Location

UL or lot no.	Section	Township	Range	Lot Idn	Feet from the	North/South line	Feet from the	East/West line	County
G	7	26 N	12 W		1780	North	1765	East	S.J.

11 Bottom Hole Location If Different From Surface

UL or lot no.	Section	Township	Range	Lot Idn	Feet from the	North/South line	Feet from the	East/West line	County

12 Dedicated Acres 160	13 Joint or Infill N	14 Consolidation Code	15 Order No.
---------------------------	-------------------------	-----------------------	--------------

NO ALLOWABLE WILL BE ASSIGNED TO THIS COMPLETION UNTIL ALL INTERESTS HAVE BEEN CONSOLIDATED
OR A NON-STANDARD UNIT HAS BEEN APPROVED BY THE DIVISION

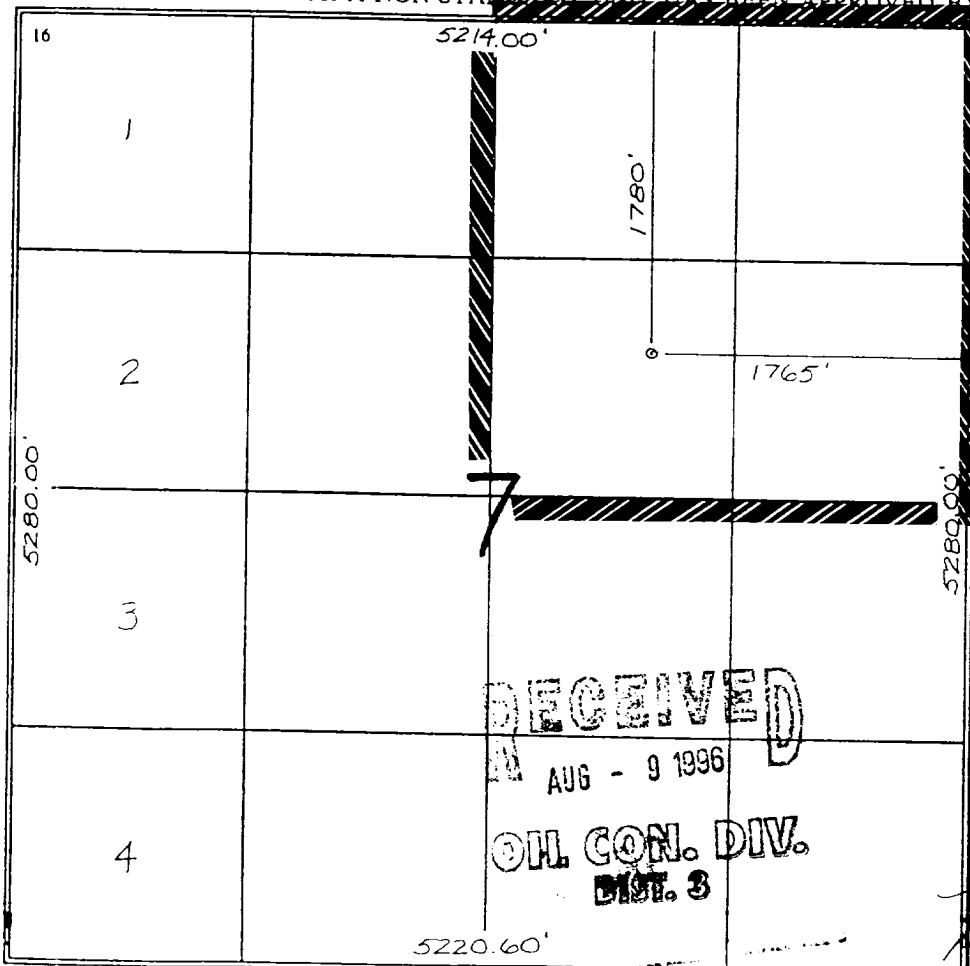

17 OPERATOR CERTIFICATION

I hereby certify that the information contained herein is true and complete to the best of my knowledge and belief

Signature
Paul C. Thompson

Printed Name
Paul C. Thompson
President

Title
President
Date
4/19/96

18 SURVEYOR CERTIFICATION

I hereby certify that the well location shown on this plat was plotted from field notes of actual surveys made by me or under my supervision, and that the same is true and correct to the best of my belief.

3-14-96

Date of Survey
Signature and Seal of Professional Surveyor

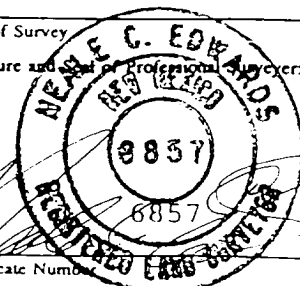

Certificate Number

