

SAN JUAN 27-8 B #5 DD

UNITED STATES  
DEPARTMENT OF THE INTERIOR  
BUREAU OF LAND MANAGEMENT

## APPLICATION FOR PERMIT TO DRILL, DEEPEN, OR PLUG BACK

1a. Type of Work DRILL	5. Lease Number NM-019402 Unit Reporting Number
1b. Type of Well GAS	6. If Indian, All. or Tribe
2. Operator <b>BURLINGTON RESOURCES</b> Oil & Gas Company	7. Unit Agreement Name
3. Address & Phone No. of Operator PO Box 4289, Farmington, NM 87499 (505) 326-9700	8. Farm or Lease Name San Juan 27-8 B 9. Well Number 5
4. Location of Well 1560' FNL, 955' FEL Bottom Hole Location: 1348' FNL, 1536' FEL, Sec. 13, T-27-N, R-8-W Latitude 36° 34.6, Longitude 107° 37.7	10. Field, Pool, Wildcat Basin Dakota 11. Sec., Twn, Rge, Mer. (NMPM) Sec. 13, T-27-N, R-8-W API# 30-045-29850
14. Distance in Miles from Nearest Town 15 miles from Blanco	12. County San Juan 13. State NM
15. Distance from Proposed Location to Nearest Property or Lease Line 955'	
16. Acres in Lease	17. Acres Assigned to Well 320 E/2
18. Distance from Proposed Location to Nearest Well, Drig, Compl, or Applied for on this Lease 350'	
19. Proposed Depth 750'	20. Rotary or Cable Tools Rotary
21. Elevations (DF, FT, GR, Etc.) 6564' GR	22. Approx. Date Work will Start
23. Proposed Casing and Cementing Program See Operations Plan attached	DRILLING OPERATIONS AUTHORIZED ARE SUBJECT TO COMPLIANCE WITH ATTACHED "GENERAL REQUIREMENTS"
24. Authorized by: <u>Regulatory/Compliance Administrator</u>	Date <u>7-16-99</u>

PERMIT NO. \_\_\_\_\_

APPROVAL DATE JUL 20 1999APPROVED BY /s/ Duane W. SpencerTITLE Team Lead, Petroleum Management

DATE \_\_\_\_\_

Archaeological Report to be submitted

Threatened and Endangered Species Report to be submitted

NOTE: This format is issued in lieu of U.S. BLM Form 3160-3

Title 18 U.S.C. Section 1001, makes it a crime for any person knowingly and willfully to make to any department or agency of the United States any false, fictitious or fraudulent statements or presentations as to any matter within its jurisdiction.

NMCCD

District I  
PO Box 1980, Hobbs, NM 88241-1980

State of New Mexico  
Energy, Minerals & Natural Resources Department

Form C-10  
Revised February 21, 1999

District II  
PO Drawer 00, Artesia, NM 88211-0719

OIL CONSERVATION DIVISION  
PO Box 2088  
Santa Fe, NM 87504-2088

Submit to Appropriate District Office  
State Lease - 4 Copies  
Fee Lease - 3 Copies

District III  
1000 Rio Brazos Rd., Aztec, NM 87410

District IV  
PO Box 2088, Santa Fe, NM 87504-2088

☐ AMENDED REPORT

### WELL LOCATION AND ACREAGE DEDICATION PLAT

*API Number 30-045-29850		*Pool Code 71599	*Pool Name Basin Dakota
*Property Code 7457	*Property Name SAN JUAN 27-8 B		*Well Number 5
*GRID No. 14538	*Operator Name BURLINGTON RESOURCES OIL & GAS COMPANY		*Elevation 6564'

#### 10 Surface Location

UL or lot no.	Section	Township	Range	Lot Idn	Feet from the	North/South line	Feet from the	East/West line	County
H	13	27N	8W		1560	NORTH	955	EAST	SAN JUAN

#### 11 Bottom Hole Location If Different From Surface

UL or lot no.	Section	Township	Range	Lot Idn	Feet from the	North/South line	Feet from the	East/West line	County
G	13	27N	8W		1348	NORTH	1536	EAST	SAN JUAN

12 Dedicated Acres E/320	13 Joint or Infill	14 Consolidation Code	15 Order No.
-----------------------------	--------------------	-----------------------	--------------

NO ALLOWABLE WILL BE ASSIGNED TO THIS COMPLETION UNTIL ALL INTERESTS HAVE BEEN CONSOLIDATED  
OR A NON-STANDARD UNIT HAS BEEN APPROVED BY THE DIVISION

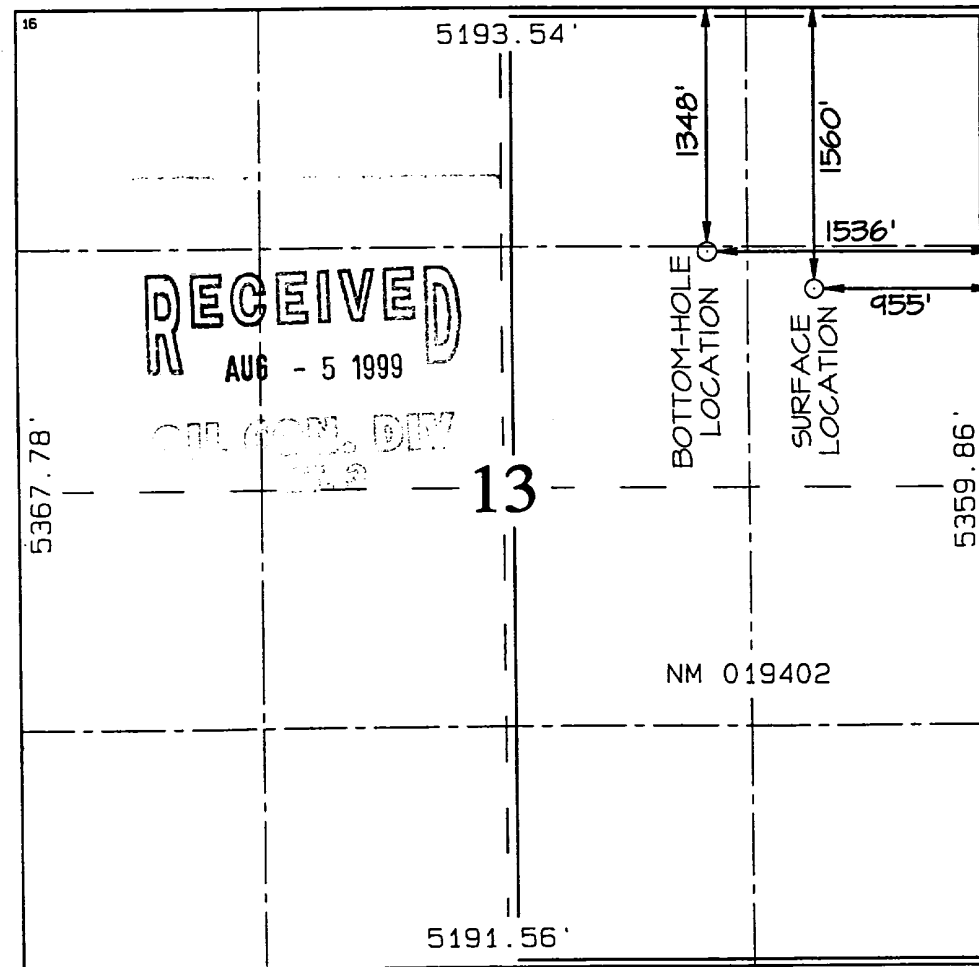

#### 17 OPERATOR CERTIFICATION

I hereby certify that the information contained herein is true and complete to the best of my knowledge and belief.

*Peggy Bradford*  
Signature

Peggy Bradford  
Printed Name

Regulatory Administrator  
Title

2-16-99  
Date

#### 18 SURVEYOR CERTIFICATION

I hereby certify that the well location shown on this plat was plotted from field notes of actual surveys made by me or under my supervision, and that the same is true and correct to the best of my belief.

REVISED: FEBRUARY 12, 1999  
NOVEMBER 19, 1998

Date of Survey  
Signature and Seal of Professional Surveyor

NEALE C. EDWARDS  
NEW MEXICO  
6857  
Professional Surveyor  
Certificate 6857

## OPERATIONS PLAN

**Well Name:** San Juan 27-8 B #5  
**Location:** 1560'FNL, 955'FEL, Section 13, T-27-N, R-8-W  
San Juan County, New Mexico  
Latitude 36° 34.6, Longitude 107° 37.7  
**Formation:** Basin Dakota  
**Elevation:** 6564'GL

<u>Formation Tops:</u>	<u>Top</u>	<u>Bottom</u>	<u>Contents</u>
Surface	San Jose	2134'	
Ojo Alamo	2134'	2184'	aquifer
Kirtland	2184'	2619'	gas
Fruitland	2619'	2904'	gas
Pictured Cliffs	2904'	3064'	gas
Lewis	3064'	3712'	gas
Intermediate casing	3164'		
Cliff House	4570'	6352'	gas
Gallup	6352'	7124'	gas
Greenhorn	7124'	7187'	gas
Graneros	7187'	7308'	gas
Dakota	7308'		
<b>Total Depth</b>	<b>7450' TVD</b>	<b>7777' MD</b>	

**Logging Program:** Mud log from 7000' to Total Depth  
IEL-GR, CNL-CDL, ML, CMR from 3164' to Total Depth

**Mud Program:**

<u>Interval</u>	<u>Type</u>	<u>Weight</u>	<u>Vis.</u>	<u>Fluid Loss</u>
0- 200'	Spud	8.4-8.9	40-50	no control
0- 3164' MD	Non-dispersed	8.4-9.0	30-60	no control
3064- 7777' MD	air/mist	n/a	n/a	n/a

**Drilling:**

Surface/Intermediate Hole:

Drill to surface casing point of 200' and set 9 5/8" casing. Mud drill from 200' to intermediate total depth of 3164'. At this point 7", 20.0#, N-80/K-55 casing will be set (see wellbore schematic).

Production Hole:

Drill out cement/shoe of 7" casing, unload hole with air/mist. Drill (with air/mist) Vertically to kick off point @ 6857'. At this point, the well will be directionally drilled by building at 12 degrees per 100' to a maximum angel of 65 degree on a 290 degree azimuth. This angel will be held to total depth (7450' TVD, 7777' MD).

<u>TVD</u>	<u>MD</u>	<u>Vertical Section</u>	<u>Hole Size</u>	<u>Notes</u>
200'	200'	0'	12 1/4"	9 5/8" casing set
3164'	3164'	0'	8 3/4"	7" csg set, begin air drill
6857'	6857'	0'	6 1/4"	Kick off point
7290'	7399'	275'	6 1/4"	End of build
7450'	7777'	618.8'	6 1/4"	Total depth

BURLINGTON RESOURCES OIL & GAS COMPANY SAN JUAN 27-8 B #5

1560' FNL & 955' FEL, SECTION 13, T27N, R8W, N.M.P.M.  
SAN JUAN COUNTY, NEW MEXICO

APD MAP #1

150' NEW BLM CONSTRUCTION  
SE/NE SECTION 13, T27N, R8W.

