

UNITED STATES
DEPARTMENT OF THE INTERIOR
BUREAU OF LAND MANAGEMENTFORM APPROVED
Budget Bureau No. 1004-0136
Expires: February 28, 1995

APPLICATION FOR PERMIT TO DRILL OR DEEPEN

5. Lease Designation and Serial No.

NM-084781
NMSF 078641A

6. If Indian, Allottee or Tribe Name

7. If Unit or CA, Agreement Designation

22957

8. Well Name and No.

Mead Com-B #1R

9. API Well No.

30-045-29872

10. Field and Pool, or Exploratory Area

Basin Fruitland

W KUTZ PC

11. Sec., T., R., M., or BLK.

and Survey or Area

Section 3, T26N, R11W

1a. Type of Work

DRILL ☒DEEPEN ☐

b. Type of Well

Oil Well ☐Gas Well ☒Other ☐Single Well ☒Multiple Zone ☐

2. Name of Operator

Merrion Oil & Gas Corporation

3. Address and Telephone No.

610 Reilly Ave Farmington NM 87401
ph: (505) 327-9801

4. Location of Well (Footages)

At Surface 820' fnl & 910' fel (ne ne)

At proposed prod. zone Same

14. Distance in Miles and Directions from Nearest Town or Post Office

±14 miles south of Bloomfield, NM near Hilltop Thriftway

12. County or Parish

San Juan

13. State

NM

15. Distance from Proposed Location to Nearest Property or Lease Line, Ft

820'

16. No. of Acres in Lease

320 acres

17. No. of Acres Assigned to This Well

319.63 159.43
320 acres

18. Distance from Proposed Location to Nearest Well Drilling, Completed, or Applied for, on this Lease, FT

~100'

19. Proposed Depth

1960'

20. Rotary or Cable Tools

Rotary

21. Elevations (Show whether DF, RT, GR, etc)

6327' GR, 6332' RKB
This action is subject to technical and procedural review pursuant to 43 CFR 3165.3 and appeal pursuant to 43 CFR 3165.4.

22. Approximate Date Work will Start

As soon as permitted

PROPOSED CASING AND CEMENTING PROGRAM

SIZE OF HOLE	SIZE & GRADE OF CASING	WEIGHT PER FOOT	SETTING DEPTH	QUANTITY OF CEMENT
8-3/4"	7" J55	23 ppf	~120' KB	~30 sx (35 cuft)
6-1/4"	4-1/2" J55	10.5 ppf	~1960' KB	~143 sx (249 cuft)

Merrion proposes to drill 8-3/4" hole with native mud to approx 120' and set 7" 23# J55 surface casing, cement to surface with ~30 sx 'B' w/ 2% CaCl₂ (36 cuft). Will drill 6-1/4" hole to TD @ approx 1960' KB with low solids non-dispersed mud system. Run open hole surveys. Will set 4-1/2" 10.5 ppf J55 production casing from TD to surface. Will cement with 91 sx 'B' (188 cuft) lead slurry and tail in with 52 sx 'B' (62 cuft) cement to fill from total depth to surface. A cementing chronology will be recorded and submitted to the BLM after completion of the job. Top of Cement should circulate to surface (will adjust volumes based upon caliper log).

A ~5 bbl water spacer will be pumped ahead of the lead slurry to prevent mud contamination of the cement. If cement does not reach surface, a temperature log or cement bond log will be run to determine top of cement.

The production casing will be centralized through the Pictured Cliffs and Fruitland intervals and through any usable water zones. Turbo-centralizers will be placed just below and into the base of the lowest usable water zone.

Will test Fruitland and Pictured Cliffs through perforated casing. Will fracture stimulate and put on for production test. Drilling operations below surface casing will be conducted with a Bag type BOP in place, minimum working pressure 1000 psig. Additional drilling technical details attached.

The well will be drilled on the existing Mead B #1 pad. The road and pipeline for the Mead B #1 will also be utilized. There will be no additional surface disturbance for any of the drilling, completion or production operations.

DRILLING OPERATIONS AUTHORIZED ARE
SUBJECT TO COMPLIANCE WITH ATTACHED
"GENERAL REQUIREMENTS"

COPIES: BLM+4, WELL FILE+1

IN ABOVE SPACE DESCRIBE PROPOSED PROGRAM: If proposal to deepen, give present productive zone and proposed new productive zone.

24. I hereby certify that the foregoing is true and correct

Signed

Connie S. Dinning Title Engineer

Date

3/10/99

(This space for Federal or State office use)

Permit No.

Approval Date

Application approval does not warrant or certify that applicant holds legal or equitable title to those rights in the subject lease which would entitle the applicant to conduct operations thereon.
Conditions of approval, if any:

APPROVED BY:

/s/ Joe Hewitt

TITLE

Team Lead, Petroleum Management

DATE

HOLD C104 FOR P+A MEAD COM B #1

District I
PO Box 1980, Hobbs, NM 88241-1980
District II
PO Drawer DD, Artesia, NM 88211-0719
District III
1000 Rio Brazos Rd., Aztec, NM 87410
District IV
PO Box 2088, Santa Fe, NM 87504-2088

State of New Mexico
Energy, Minerals & Natural Resources Department

OIL CONSERVATION DIVISION

PO Box 2088
Santa Fe, NM 87504-2088

RECEIVED

BLM

MAR 12 PM 12:51

Form C-102
Revised February 21, 1994
Instructions on back
Submit to Appropriate District Office
State Lease - 4 Copies
Fee Lease - 3 Copies

070 FARMINGTON, NM ☐ AMENDED REPORT

WELL LOCATION AND ACREAGE DEDICATION PLAT

API Number 30-045-29872		Pool Code 71629	Pool Name Basin Fruitland
Property Code 22957	Property Name Mead Com B		Well Number 1 R
OGRID No. 014634	Operator Name MERRION OIL & GAS		Elevation 6327'

10 Surface Location

UL or lot no. A	Section 3	Township 26 N	Range 11 W	Lot Idn NENE	Feet from the 820	North/South line North	Feet from the 910	East/West line East	County San Juan
--------------------	--------------	------------------	---------------	-----------------	----------------------	---------------------------	----------------------	------------------------	--------------------

11 Bottom Hole Location If Different From Surface

UL or lot no.	Section	Township	Range	Lot Idn	Feet from the	North/South line	Feet from the	East/West line	County
Dedicated Acres 320319.63		Joint or Infill		Consolidation Code		Order No.			

NO ALLOWABLE WILL BE ASSIGNED TO THIS COMPLETION UNTIL ALL INTERESTS HAVE BEEN CONSOLIDATED
OR A NON-STANDARD UNIT HAS BEEN APPROVED BY THE DIVISION

16		XXXXXXXXXXXXXXXXXXXXXXXXXXXXXXXXXXXX		17 OPERATOR CERTIFICATION	
		820'		I hereby certify that the information contained herein is true and complete to the best of my knowledge and belief	
		910'		Signature CONNIE DINNING	
				Printed Name Engineer	
				Title 3/10/99	
				Date	
Section 3		RECEIVED NOV - 1 1999 OIL CON. DIV. BTL 3		18 SURVEYOR CERTIFICATION	
				I hereby certify that the well location shown on this plat was plotted from field notes of actual surveys made by me or under my supervision and that the same is true and correct to the best of my knowledge and belief	
				Date of Survey 3/10/99	
				Signature G. Huddleston	
				Seal of Professional Surveyor 6844	
				6844	
				Certificate Number	

District I
PO Box 1988, Hobbs, NM 88241-1988
District II
811 South First, Artesia, NM 88210
District III
1000 Rio Branos Rd., Aztec, NM 87410
District IV
2040 South Pacheco, Santa Fe, NM 87505

State of New Mexico
Energy, Minerals & Natural Resources Department

OIL CONSERVATION DIVISION
2040 South Pacheco
Santa Fe, NM 87505

Form C-102

Revised October 18, 1994

Instructions on back

Submit to Appropriate District Office

State Lease - 4 Copies

Fee Lease - 3 Copies

☒ AMENDED REPORT

WELL LOCATION AND ACREAGE DEDICATION PLAT

API Number 30-045-06078 29872		Pool Code 79680	Pool Name West Kutz Pictured Cliffs
Property Code 22957	Property Name MEAD B		Well Number 001R
OGRID No. 014634	Operator Name MERRION OIL & GAS CORPORATION		Elevation 6333'

10 Surface Location

UL or lot no. A	Section 03	Township 26N	Range 11W	Lot Idn NENE	Feet from the 820	North/South line NORTH	Feet from the 910	East/West line EAST	County SAN JUAN
--------------------	---------------	-----------------	--------------	-----------------	----------------------	---------------------------	----------------------	------------------------	--------------------

11 Bottom Hole Location If Different From Surface

UL or lot no.	Section	Township	Range	Lot Idn	Feet from the	North/South line	Feet from the	East/West line	County
---------------	---------	----------	-------	---------	---------------	------------------	---------------	----------------	--------

Dedicated Acres 160 159.63	Joint or Infill 63	Consolidation Code	Order No.
-------------------------------	-----------------------	--------------------	-----------

NO ALLOWABLE WILL BE ASSIGNED TO THIS COMPLETION UNTIL ALL INTERESTS HAVE BEEN CONSOLIDATED OR A NON-STANDARD UNIT HAS BEEN APPROVED BY THE DIVISION

16		XXXXXXXXXXXXXXXXXXXX	XXXXXXXXXXXX	820'	910'	17 OPERATOR CERTIFICATION I hereby certify that the information contained herein is true and complete to the best of my knowledge and belief
						Signature <i>George Sharpe</i> Printed Name George F. Sharpe Title Engineer Date 3/26/99
						18 SURVEYOR CERTIFICATION I hereby certify that the well location shown on this plat was plotted from field notes of actual surveys made by me or under
						Date of Survey Signature and Seal of Professional Surveyer:
						Certificate Number

RECEIVED
APR - 2 1999
OIL CON. DIV.
DIST. 3

HOLD C104 FOR *PEA MEAD B #1* (E)

MERRION OIL & GAS CORPORATION

TOPO LOCATOR MAP

MEAD COM B No. 1R

920' fml & 990' fel (ne ne)
Sec 3, T26N, R11W, NMPM
San Juan County, New Mexico

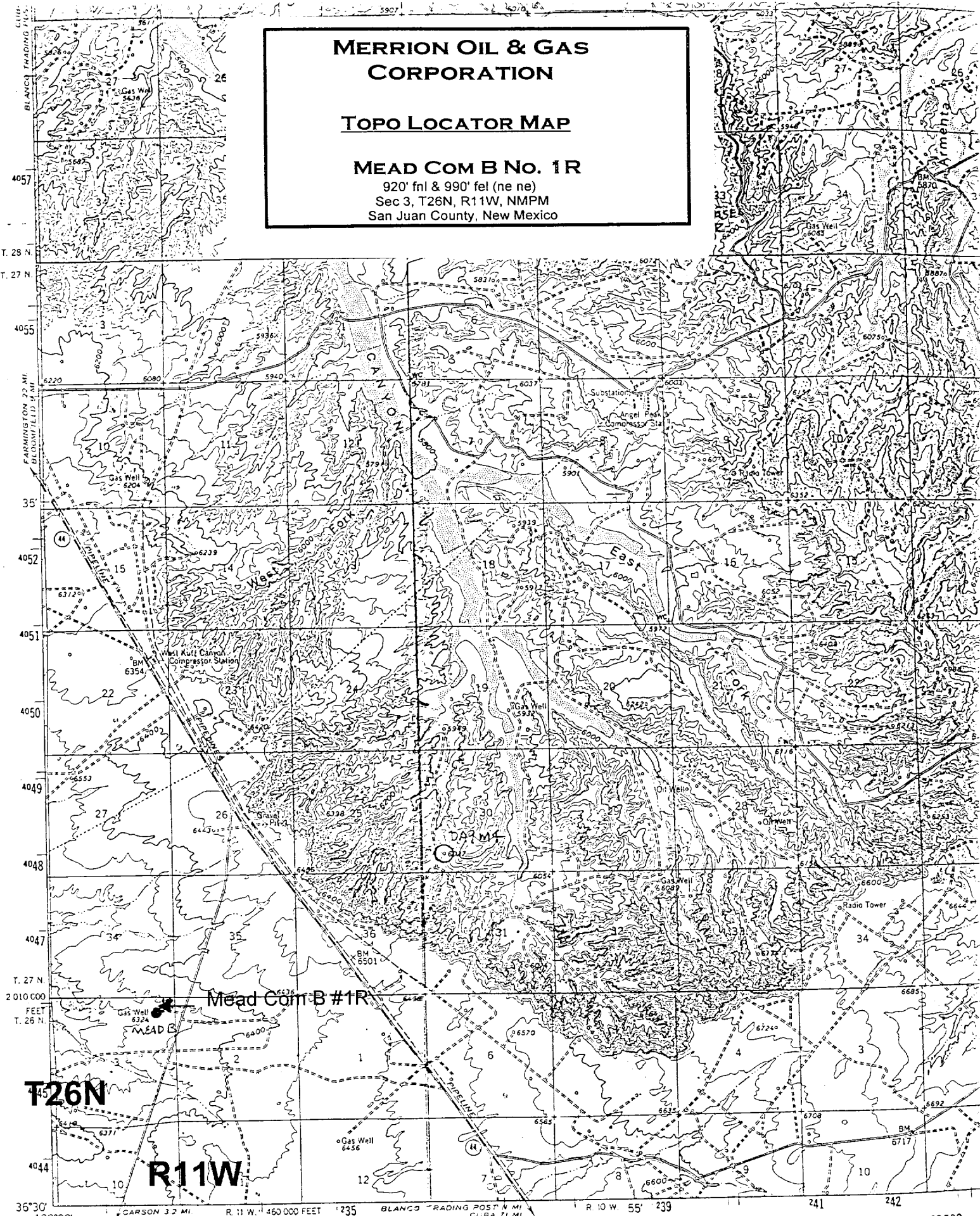

Mapped, edited, and published by the Geological Survey

Control by USGS and USC&GS

Topography by photogrammetric methods from aerial
photographs taken 1955. Field checked 1960

