

UNITED STATES
DEPARTMENT OF THE INTERIOR
BUREAU OF LAND MANAGEMENT

APPLICATION FOR PERMIT TO DRILL, DEEPEN, OR PLUG BACK

11

RT

149052

RECEIVED
JUL 2001
OILCON DIV
DIST. 3

1a. Type of Work
DRILL

1B. TYPE OF WELL
GAS

2. Operator
ELM RIDGE RESOURCES, INC. 505-632-3476

3. Address & Phone No. of Operator
PO Box 189 Farmington, NM 87401

4. Location of Well
990' FWL, 1350' FNL

5. Lease Number
NO-G-9601-1296
Unit Reporting Number

6. If Indian, All. or Tribe
INDIAN ALLOTTED

7. Unit Agreement Name
28407

8. Farm or Lease Name
BARTRYLEY NAVAJO.

9. Well Number
#1

10. Field, Pool Wildcat
San/ PICTURED CLIFFS WNW Fruitland Gas Pool

11. Sec., Twn, Rge, Mer. (NMPM)
2 NW SEC. 24, T27N, R13W
API # 30045-3053 726N

12. County
SAN JUAN,

13. State
N.M.

14. Distance in Miles from Nearest Town
13 MILES SOUTH OF FARMINGTON

15. Distance from Proposed Location to Nearest Property or Lease Line
900'

16. Acres in Lease
160

17. Acres Assigned to Well
160 NW/4

18. Distance from Proposed Location to Nearest Well, Drig, Compl or Applied for on this Lease
2000'

19. Proposed Depth
1340'

20. Rotary or Cable Tools
ROTARY

21. Elevations (DF, FT, GR, Etc.)
6024' GL

22. Approx. Date Work will Start
JUNE

23. Proposed Casing and Cementing Program
SEE OPERATIONS PLAN ATTACHED

24. Authorized by: Patrick Hegarty
PATRICK HEGARTY, Agent Date 01-06-01

PERMIT NO. _____ APPROVAL DATE 7/3/01

APPROVED BY /s/ Lee Otteri TITLE _____ DATE JUL - 3

Archaeological Report to be submitted

Threatened and Endangered Species Report to be submitted

NOTE: This format is issued in lieu of U.S. BLM Form 3160--3

Title 1 U.S.C. Section 1001, makes it a crime for any person knowingly and willfully to make to any department or agency of the United States any false, fictitious or fraudulent statements or presentations as to any matter within its jurisdiction.

BLM

District I
1401 Box 1980, Hobbs, NM 88241-1980
District II
111 South First, Artesia, NM 88210
District III
1000 Rio Brazos Rd., Aztec, NM 87410
District IV
2040 South Pacheco, Santa Fe, NM 87505

State of New Mexico
Energy, Minerals & Natural Resources Department

OIL CONSERVATION DIVISION
2040 South Pacheco
Santa Fe, NM 87505

Form C-102
Revised October 18, 1994
Instructions on back
Submit to Appropriate District Office
State Lease - 4 Copies
Fee Lease - 3 Copies

☒ AMENDED REPORT

WELL LOCATION AND ACREAGE DEDICATION PLAT

1 API Number 30-045-30539		2 Pool Code 87190		3 Pool Name WAW FRUITLAND SAND PICTURED CLIFFS	
4 Property Code 28407		5 Property Name BARTLEY NAVAJO			6 Well Number 1
7 GRID No. 149052		8 Operator Name ELM RIDGE RESOURCES, INC.			9 Elevation 6037'

10 Surface Location

UL or lot no.	Section	Township	Range	Lot Idn	Feet from the	North/South line	Feet from the	East/West line	County
E	24	26N	13W		1350'	NORTH	990'	WEST	SAN JUAN

11 Bottom Hole Location If Different From Surface

UL or lot no.	Section	Township	Range	Lot Idn	Feet from the	North/South line	Feet from the	East/West line	County
---------------	---------	----------	-------	---------	---------------	------------------	---------------	----------------	--------

12 Dedicated Acres	13 Joint or Infill	14 Consolidation Code	15 Order No.
--------------------	--------------------	-----------------------	--------------

NO ALLOWABLE WILL BE ASSIGNED TO THIS COMPLETION UNTIL ALL INTERESTS HAVE BEEN CONSOLIDATED OR A NON-STANDARD UNIT HAS BEEN APPROVED BY THE DIVISION

		17 OPERATOR CERTIFICATION I hereby certify that the information contained herein is true and complete to the best of my knowledge and belief	
		Signature: Patrick HEGARTY Printed Name: PATRICK HEGARTY Title: Agent Date: 01-06-01	
		18 SURVEYOR CERTIFICATION I hereby certify that the well location shown on this plat was plotted from field notes of actual surveys made by me or under my supervision, and that the same is true and correct to the best of my belief.	
		Date of Survey: 01/04/01 Signature and Seal of Professional Surveyer: [Signature] Certification Number: 1393	

ELM RIDGE RESOURCES, INC.
BARTRYLEY NAVAJO #1

1350' FNL, 990' FWL
NW/4 SEC.24, T-26-N, R-13-W, N.M.P.M.,
SAN JUAN COUNTY, NEW MEXICO
GROUND LEVEL ELEVATION: 6037

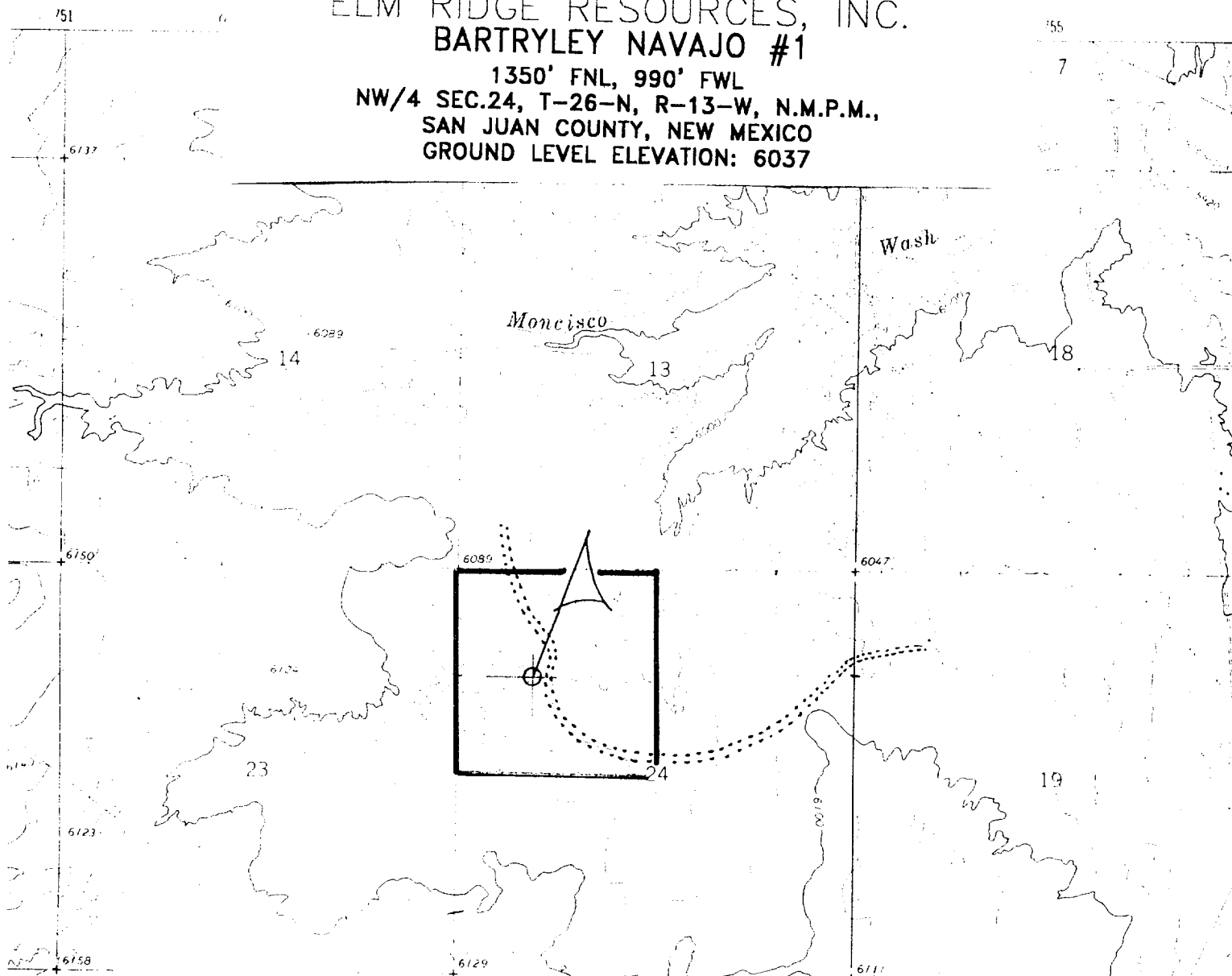

EXHIBIT "E"

Existing Roads

Vicinity of nearest town or reference pt.

Approx. 6.5 mi NW of Chaco Plant

Type of surface dirt

Conditions good

Other _____

Reference map: USGS map

Planned Access Road(s)

Width -- Maximum grades --

Drainage design as required

Cuts & Fills as required

Surfacing material none

Turnouts

Culverts

Gates

Cattleguards

Fence cuts

Waterbars

Access Road &
Pipeline

Access road(s) ☒ do not cross Fed. land.

EXHIBIT "B"
OPERATIONS PLAN
Bartryley Navajo #1

APPROXIMATE FORMATION TOPS:

Ojo Alamo	Surface
Kirtland	<100'
Farmington	320'
Fruitland	630'
Pictured Cliffs	1115'
Total Depth	1340'

LOGGING PROGRAM: Run IES & CDL logs.

Catch samples every 30 feet from 915' to total depth.

CASING PROGRAM:

<u>Hole</u> <u>Size</u>	<u>Casing</u> <u>Size</u>	<u>Wt./Ft.</u>	<u>Setting</u> <u>Depth</u>	<u>Grade and</u> <u>Condition</u>
9-7/8"	7"	20#	±120'	J-55
6-1/4"	4-1/2"	10.5#	1340'	J-55

The hole size is not smaller than 1-1/2" larger diameter than the casing O.D. across usable water zones.

Plan to drill a 9-7/8" hole and set 120' of 7" OD, 20#, J-55 surface casing; then plan to drill a 6-1/4" hole to total depth with gel-water-mud program to test Pictured Cliffs Formation. Plan to run IES and CDL logs. If determined productive, will run 4-1/2". 10.5#, J-55 casing, selectively perforate, frac, clean out after frac and complete well.

CEMENTING PROGRAM: All volumes are contingent upon Caliper logs.

Surface- Cement with 60 sx (71 cu. ft.) Class "G" neat.
Circulate to surface.

Production Stage- Cement with 105 sx (215 cu. ft.) Class "G" with 2% Lodense and 1/4# cello flake/sk followed by 60 sx (71 cu. ft.) class "G" with 1/4# cello flake/sk.

Total cement slurry for production stage is 286 cu. ft. Circulate to surface.

An adequate spacer will be pumped ahead of the cement slurry to help prevent mud contamination of the cement. An adequate number of casing centralizers will be run through usable water zones to ensure that casing is centralized through these zones. The adequate number of centralizers will be determined based on API standards. Centralizers to impart a swirling action around the casing will be used just below and into the base of the lowest usable water zone. These devices will assist mud displacement, increase cement bonding potential and create an effective hydraulic seal. A chronological log will be kept which records the pump rate, pump pressure, slurry density, and slurry volume for the cement job. The log will be sent to the BLM after completion of the job.

WELLHEAD EQUIPMENT - PRESSURE CONTROL: See Exhibit "D"

Huber 7" X 4-1/2" casing head, 1000#WP, tested to 2000#
Huber 4-1/2" X 2-7/8" tubing head, 1000#WP, tested to 2000#

BOP and Related Equipment will include for a 2000 psi system;

No abnormal pressures or hazardous zones are anticipated.

WELLHEAD EQUIPMENT (cont.):

Annual preventer, double ram, or 2 rams with one being blind and one being a pipe ram
Kill line (2" minimum)
1 kill line valve (2" minimum)
1 choke line valve
2 chokes
Upper kelly cock valve with handle available
Safety valve and subs to fit all drill string connections in use
Pressure gauge on choke manifold
2" minimum choke line
Fill-up line above the uppermost preventer

BOP equipment will be tested as required in Section III A.1 of Onshore Order 2, plus a 30% safety factor.

The anticipated bottom hole pressure for this well is estimated to be approximately 380 psi.

The average mud weight is anticipated to be in the range of 8.6 to 9.5 lb/gal.

ATTACHMENTS

Exhibit "A" - Development Plan
Exhibit "B" - Operations Plan
Figure #1 - Anticipated Production Facilities
Figure #2 - Cut & Fill Diagram
Exhibit "C" - Typical Location Plat
Exhibit "D" - Pressure Control Equipment
Exhibit "E" - Existing & Planned Access Roads
Exhibit "F" - Location of Existing Wells & Facilities
Exhibit "G" - Vicinity Map