

Form 9-331a
(Feb. 1961)

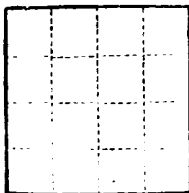

(SUBMIT IN TRIPLICATE)

UNITED STATES
DEPARTMENT OF THE INTERIOR
GEOLOGICAL SURVEY

Budget Bureau No. 42-R358.4.
Form Approved.

Land Office Santa Fe
Lease No. 079491
Unit San Juan 27-5 Unit

SUNDRY NOTICES AND REPORTS ON WELLS

NOTICE OF INTENTION TO DRILL.....	XX	SUBSEQUENT REPORT OF WATER SHUT-OFF.....
NOTICE OF INTENTION TO CHANGE PLANS.....		SUBSEQUENT REPORT OF SHOOTING OR ACIDIZING.....
NOTICE OF INTENTION TO TEST WATER SHUT-OFF.....		SUBSEQUENT REPORT OF ALTERING CASING.....
NOTICE OF INTENTION TO RE-DRILL OR REPAIR WELL.....		SUBSEQUENT REPORT OF RE-DRILLING OR REPAIR.....
NOTICE OF INTENTION TO SHOOT OR ACIDIZE.....		SUBSEQUENT REPORT OF ABANDONMENT.....
NOTICE OF INTENTION TO PULL OR ALTER CASING.....		SUPPLEMENTARY WELL HISTORY.....
NOTICE OF INTENTION TO ABANDON WELL.....		

RECEIVED

SEP 19 1962

(INDICATE ABOVE BY CHECK MARK NATURE OF REPORT, NOTICE, OR OTHER DATA)

U. S. GEOLOGICAL SURVEY
SANTA FE, N. M.

September 19, 1962

Well No. 88 is located 1190 ft. from ~~xxx~~ ^(N) line and 800 ft. from ~~xxx~~ ^(E) line of sec. 12

NE/4 Sec. 12 27N 5W N.M.P.M.
(1/4 Section, Sec. No.) (Twp.) (Range) (Meridian)

Blanco Mesa Verde
(Field)

Rio Arriba
(County or Subdivision)

New Mexico
(State or Territory)

The elevation of the derrick floor above sea level is 6853 ft.

DETAILS OF WORK

(State names of and expected depths of objective sands; show sizes, weights, and lengths of proposed casings; indicate casing points, and all other important proposed work)

It is intended to mud drill a well with rotary tools thru the Mesa Verde formation. Mud circulation will be used thru the Pictured Cliffs and set intermediate casing. Gas circulation will be used thru the Mesa Verde and production liner will be set. Possible productive intervals will be perforated and fractured. Est. T. D. 6056'.

Casing Program:

- 10 3/4" @ 120' w/95 sacks cement circulated to surface.
- 7 5/8" @ 3975' w/162 sks. cement to cover Ojo Alamo.
- 5 1/2" @ 6056' w/180 sks. cement to cover top of liner.

The E/2 of Section 12 is dedicated to this well.

I understand that this plan of work must receive approval in writing by the Geological Survey before operations may be commenced.

Company El Paso Natural Gas Company

Address Box 990
Farmington, New Mexico

By H. E. McAnally
Title Petroleum Engineer

NEW MEXICO OIL CONSERVATION COMMISSION

Well Location and Acreage Dedication Plat

Section A.

Date **SEPTEMBER 18, 1962**

Operator **EL PASO NATURAL GAS COMPANY** Lease **SAN JUAN 27-5 UNIT** **SF079491**
 Well No. **88** Unit Letter **A** Section **12** Township **27-N** Range **5-W** NMPM
 Located **1190** Feet From **NORTH** Line, **800** Feet From **EAST** Line
 County **RIO ARRIBA** G. L. Elevation **6843** Dedicated Acreage **320** Acres
 Name of Producing Formation **MESA VERDE** Pool **BLANCO M.V.**

1. Is the Operator the only owner in the dedicated acreage outlined on the plat below?
 Yes **XX** No
2. If the answer to question one is "no", have the interests of all the owners been consolidated by communitization agreement or otherwise? Yes No If answer is "yes", Type of Consolidation.
3. If the answer to question two is "no", list all the owners and their respective interests below:

Owner

Land Description

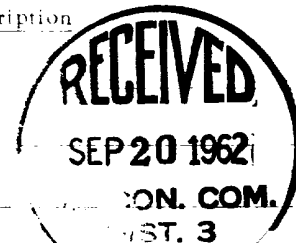

Section B.

Note: All distances must be from outer boundary of section.

This is to certify that the information in Section A above is true and complete to the best of my knowledge and belief.

El Paso Natural Gas Company
 (Operator)

ORIGINAL SIGNED H.E. McANALLY
 (Representative)

Box 990
 (Address)

Farmington, New Mexico

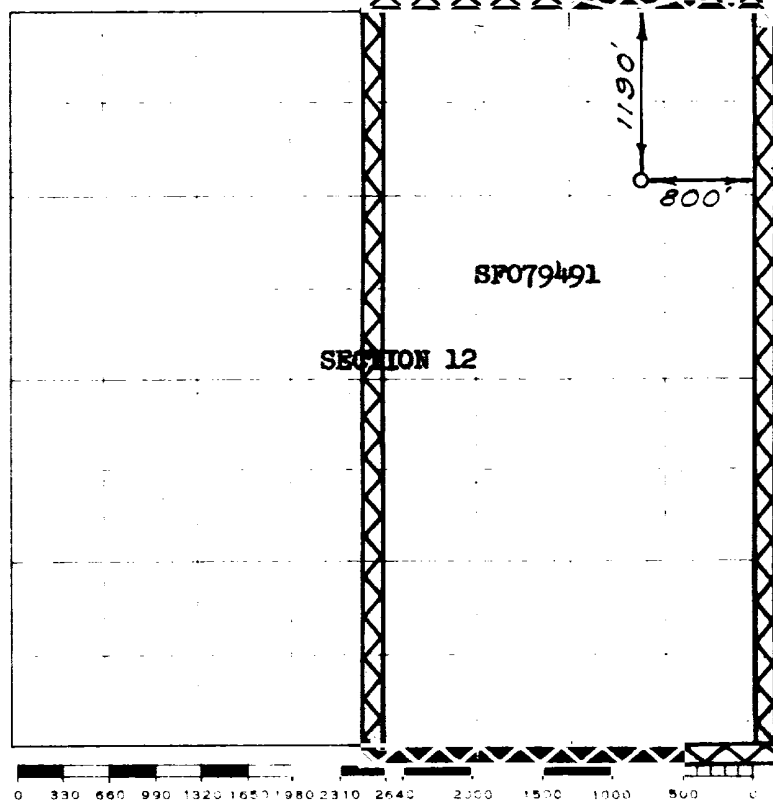

Scale 1 inch equals 1 mile

This is to certify that the above plat was prepared from field notes of actual surveys made by me or under my supervision and that the same are true and correct to the best of my knowledge and belief.

(Seal)

Date Surveyed **AUGUST 30, 1962**

Farmington, New Mexico

Registered Professional Engineer and/or Land Surveyor