

NEW MEXICO OIL CONSERVATION COMMISSION
Santa Fe, New Mexico

Form C-101
Revised (12/1/55)

NOTICE OF INTENTION TO DRILL

Notice must be given to the District Office of the Oil Conservation Commission and approval obtained before drilling or recompletion begins. If changes in the proposed plan are considered advisable, a copy of this notice showing such changes will be returned to the sender. Submit this notice in **QUINTUPLICATE**. One copy will be returned following approval. See additional instructions in Rules and Regulations of the Commission. If State Land submit 6 Copies Attach Form C- 128 in triplicate to first 3 copies of form C-101

1220 Hamilton Building, Wichita Falls, Texas

September 22, 1959

(Place)

(Date)

OIL CONSERVATION COMMISSION
SANTA FE, NEW MEXICO

Gentlemen:

You are hereby notified that it is our intention to commence the Drilling of a well to be known as

Hamilton Investment Company

(Company or Operator)

Spill Brothers

(Lease)

Well No. **1**, in **D** The well is

(Unit)

located **560** feet from the **North** line and **760** feet from the

West line of Section **33**, T. **28-N**, R. **4-E**, NMPM.

(GIVE LOCATION FROM SECTION LINE) **Wildcat** Pool, **Rio Arriba** County

If State Land the Oil and Gas Lease is No.

If patented land the owner is **Spill Bros., Tierra Amarilla, N.M.**

Address **Penn Building Co., Minneapolis, Minn.**

We propose to drill well with drilling equipment as follows:

Rotary rig

The status of plugging bond is

Drilling Contractor **S. S. Reames Well Servicing, Ry: S. S. Reames, Bloomfield, New Mexico**

We intend to complete this well in the **Entrada** formation at an approximate depth of **3500** feet.

CASING PROGRAM

We propose to use the following strings of Casing and to cement them as indicated:

Size of Hole	Size of Casing	Weight per Foot	New or Second Hand	Depth	Sacks Cement
12"	9-5/8"	32#	New	90'	70 sx
7-7/8"	4-1/2"	9.5#	"	To test any shows encountered in drilling of well.	

If changes in the above plans become advisable we will notify you immediately.

ADDITIONAL INFORMATION (If recompletion give full details of proposed plan of work.)

Approved 10-22, 1959
Except as follows:

Sincerely yours,

HAMILTON INVESTMENT COMPANY

(Company or Operator)

By **W.B. Hamilton**

Position **President**

Send Communications regarding well to

Name **Hamilton Investment Company**

Address **1220 Hamilton Building**

Wichita Falls, Texas

OIL CONSERVATION COMMISSION

By **Ernest C. Chavez**

OIL CONSERVATION COMMISSION

AZTEC DISTRICT OFFICE

No. Copies Received 5

DISTRIBUTION

	1	
	1	
	2	
	1	✓

NEW MEXICO OIL CONSERVATION COMMISSION

Well Location and Acreage Dedication Plat

Section A.

Date September 22nd, 1959

Operator Hamilton Investment Company Lease Spill Brothers
Well No. _____ Unit Letter _____ Section 33 Township 22 North Range 8 East NMPN
Located 540' Feet From North Line, 760' Feet From West Line
County Red Apache G. L. Elevation 7573 Dedicated Acreage 40 Acres
Name of Producing Formation _____ Pool _____

1. Is the Operator the only owner* in the dedicated acreage outlined on the plat below?
Yes _____ No _____
2. If the answer to question one is "no," have the interests of all the owners been consolidated by communitization agreement or otherwise? Yes _____ No _____. If answer is "yes,"
Type of Consolidation _____
3. If the answer to question two is "no," list all the owners and their respective interests below:

Owner

Land Description

Section B

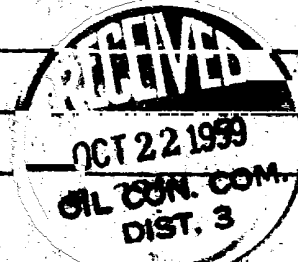
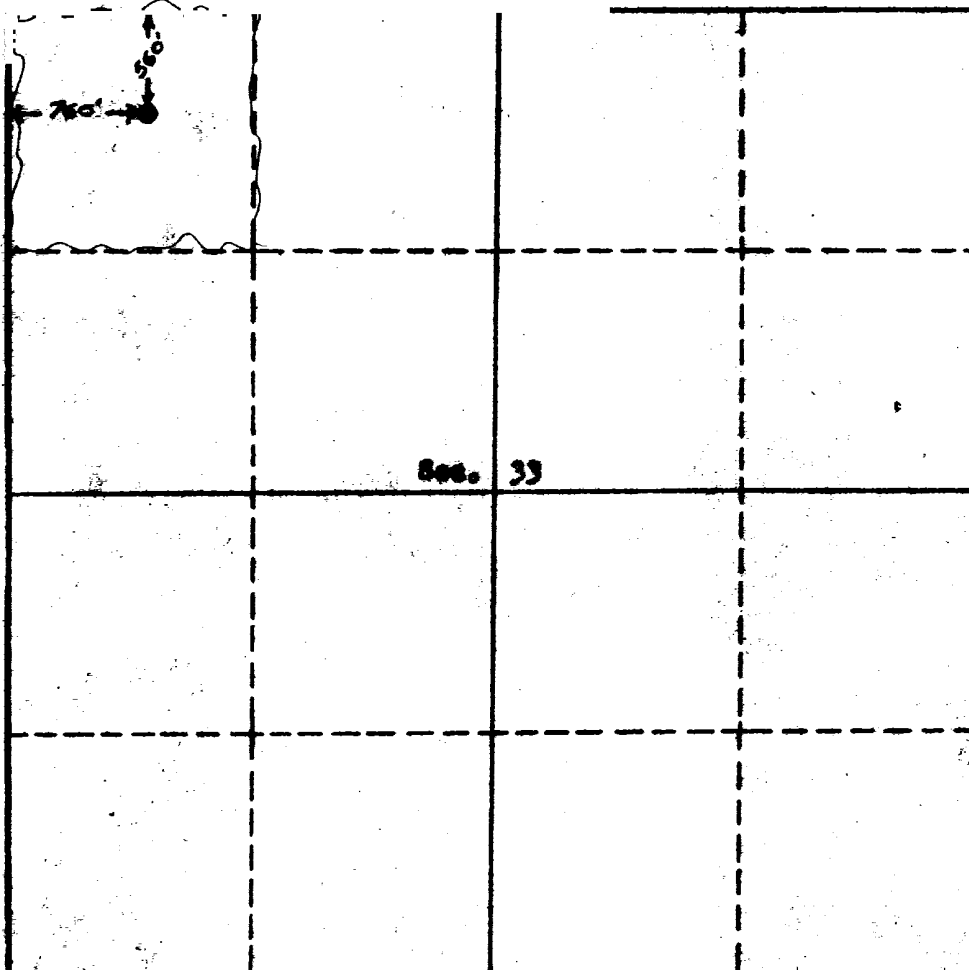

This is to certify, that the information in Section A above is true and complete to the best of my knowledge and belief.

Hamilton Investment Co.

(Operator)

H. B. Hamilton

(Representative)

1220 Hamilton Bldg.
Wichita Falls, Texas.

Address

This is to certify, that the information in Section A above is true and complete to the best of my knowledge and belief.

Date Surveyed Sept. 22, 1959

Ernest V. Echobawk

Ernest V. Echobawk
Registered Land Surveyor.

Certificate No. 1545



NEW MEXICO OIL CONSERVATION COMMISSION

Well Location and Acreage Dedication Plat

Section A.

Date September 22nd, 1959

Operator Hamilton Investment Company Lease Spill Brothers
Well No. 1 Unit Letter Section 33 Township 23 North Range 4 East NMPN
Located 560' Feet From North Line, 760' Feet From West Line
County Rio Arriba G. L. Elevation 7573 Dedicated Acreage Acres
Name of Producing Formation Pool

1. Is the Operator the only owner* in the dedicated acreage outlined on the plat below?
Yes X No
2. If the answer to question one is "no," have the interests of all the owners been consolidated by communitization agreement or otherwise? Yes No . If answer is "yes,"
Type of Consolidation
3. If the answer to question two is "no," list all the owners and their respective interests below:

Owner

Land Description

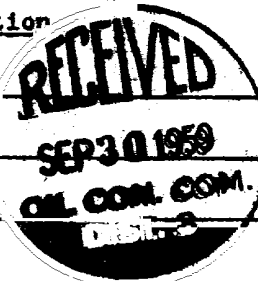

Section B

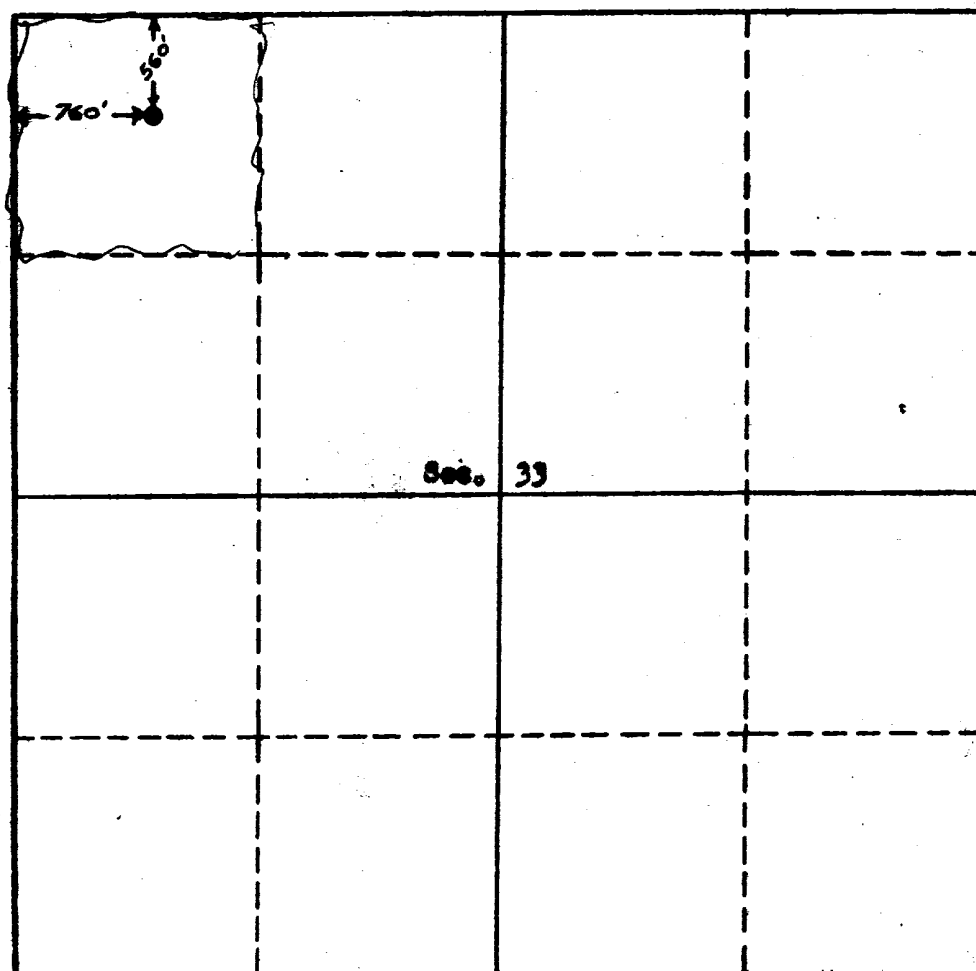

This is to certify that the information in Section A above is true and complete to the best of my knowledge and belief.

Hamilton Investment Co.
(Operator)

(Representative)
1220 Hamilton Bldg
Wichita Falls, Texas
Address

This is to certify that the well location shown on the plat is true and complete to the best of my knowledge and belief.

Date Surveyed Sept. 21, 1959

Ernest V. Echolaw
Ernest V. Echolaw
Registered Land Surveyor.

Certificate No. 1513



THE
LIBRARY

OF THE
UNIVERSITY

OF THE STATE OF NEW YORK

ALBANY, N. Y.